

JVC DVD PLAYER

XV-N340B XV-N342S

INSTRUCTIONS

MPEG-1 Multichannel
DVD VIDEO (Not available for Central and South America)



GNT0069-020A[AG/AH/AX/AS/AA/UM]
EN 0306KTC-MW-SC
©2006 Victor Company of Japan, Limited

Region code of DVD VIDEO
This player can play back DVD VIDEO discs whose region code numbers include the player's Region Code, which is indicated on the region code symbol on the rear panel.
Examples of playable DVD VIDEO discs:



The player's region code is printed on the rear of the player.
Note of Color system format
This player is compatible with the PAL and NTSC systems. Select the correct color system for your TV (see "Initial settings").

Supplied accessories
If anything is missing, consult your dealer immediately.
• Audio/video cable (Yellow/White/Red) (x 1)
• Remote control (x 1)
• R6(SUM-3)/AA(15F) battery (x 2)
• AC power plug adapter (x 1) (Not supplied for HongKong, Saudi Arabia, Australia, New Zealand)

CAUTION
To reduce the risk of electrical shocks, fire, etc.:
1. Do not remove screws, covers or cabinet.
2. Do not expose this appliance to rain or moisture.
3. The mains plug shall remain readily operable.

Caution — Standby/ON button!
Disconnect the mains plug to shut the power off completely. The Standby/ON button in any position does not disconnect the mains line. The power can be remote controlled.

IMPORTANT FOR LASER PRODUCTS
1. **CLASS 1 LASER PRODUCT**
2. **CAUTION:** Do not open the top cover. There are no user serviceable parts inside the unit; leave all servicing to qualified service personnel.
3. **CAUTION:** Visible and/or invisible class 1M laser radiation when open. Do not stare into beam or view directly with optical instruments.
4. **REPRODUCTION OF LABEL: CAUTION LABEL, PLACED INSIDE THE UNIT.**

CAUTION Hazardous Laser Radiation	ATTENTION Rayonnement Laser Dangereux	ADWARSEL Gevaarlijk Laserstraling	ADWARSEL Gevaarlijk Laserstraling	WARO Gevaarlijk Laserstraling	WARNING Hazardous Laser Radiation
Do not stare into the beam or view directly with optical instruments.	Ne regardez pas dans le faisceau laser ni directement avec des instruments optiques.	Ne regardez pas dans le faisceau laser ni directement avec des instruments optiques.	Ne regardez pas dans le faisceau laser ni directement avec des instruments optiques.	Do not stare into the beam or view directly with optical instruments.	Do not stare into the beam or view directly with optical instruments.

5. This unit applies to the standard "IEC 60825-1:2001" for laser products.
CAUTION:
• Do not block the ventilation openings or holes. (If the ventilation openings or holes are blocked by a newspaper or cloth, etc., the heat may not be able to get out.)
• Do not place any open flame sources, such as lighted candles, on the apparatus.
• When discarding batteries, environmental problems must be considered and local rules or laws governing the disposal of these batteries must be followed strictly.
• Do not expose this apparatus to rain, moisture, dripping or splashing and that no objects filled with liquids, such as vases, shall be placed on the apparatus.

Caution: Proper Ventilation
To avoid risk of electric shock and fire and to protect from damage, locate the apparatus as follows:
Front: No obstructions and open spacing.
Sides: No obstructions in 3 cm from the sides.
Top: No obstructions in 5 cm from the top.
Back: No obstructions in 15 cm from the back.
Bottom: No obstructions, place on the level surface.

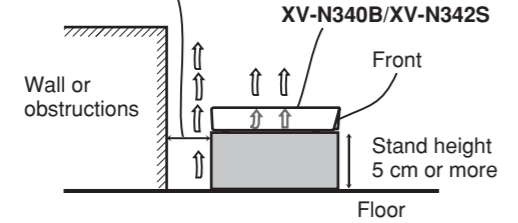

Turning on the power

Inserting the AC power plug
After all other connections have been made, insert the AC power plug to the wall outlet firmly.

Installing the batteries in the remote control
Open the compartment cover, and place the two supplied R6(SUM-3)/AA(15F) batteries in the remote control according to the polarity markings ("+" and "-") inside the compartment. Then replace the cover.

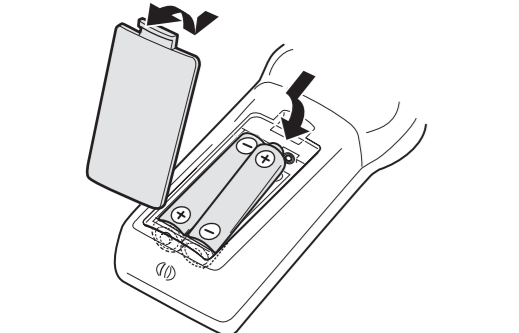

The batteries will last about six months with normal use. If the functions of the remote control become erratic, replace the batteries.

Precautions of the safe use of batteries
Observe the following precautions for the safe use of batteries. If they are used improperly their lives will be shortened, they may burst or their contents may leak.
• Remove the batteries from the remote control if it is not going to be used for a long period of time.
• Remove dead batteries and dispose of them properly.
• Never leave dead batteries lying around, take them apart, mix them with other refuse, or throw them into an incinerator.
• Never touch liquid that has leaked out of a battery.
• Do not mix new and old batteries, or batteries of different types, when placing them.

Turning on and off the player
Press Standby/ON.

Initial setup

When you turn on the player for the first time after purchase, the following message appears on the TV screen.

EXECUTE DVD PLAYER SETUP? - BASIC PICTURE/AUDIO SETTING
YES - PRESS ENTER NO - PRESS CANCEL

Before enjoying this player, make the initial settings as follows:

1 Press ENTER.

DVD PLAYER SETUP	
MENU LANGUAGE	ENGLISH
AUDIO LANGUAGE	ENGLISH
SUBTITLE	ENGLISH
ON SCREEN LANGUAGE	ENGLISH
	CHINESE
	SPANISH

2 Press ▲/▼ to select the on-screen language for the preference displays, etc., then press ENTER.

DVD PLAYER SETUP	
MONITOR TYPE	16:9
PICTURE SOURCE	4:3 LB
SCREEN SAVER	4:3 PS
COLOR SYSTEM	PAL
BACKGROUND	STANDARD

3 Press ▲/▼ to select the monitor type, then press ENTER.

- For a normal (conventional) TV, select "4:3 LB" or "4:3 PS." (See "MONITOR TYPE" in "Initial settings.")
- For a wide-screen TV, select "16:9."

DVD PLAYER SETUP	
DIGITAL AUDIO OUTPUT	PCM ONLY
ANALOG DOWNMIX	DOLBY DIGITAL/PCM
D RANGE CONTROL	STREAM/PCM
OUTPUT LEVEL	STANDARD

4 Press ▲/▼ to select a desired digital output signal type, then press ENTER.

Set this item correctly according to the logo on your receiver or decoder.
(If you do not connect the player to such a device, press ENTER to finish the setting.)
• Receiver/decoder bearing Dolby Digital logo and no DTS, select "DOLBY DIGITAL/PCM."
• Receiver/decoder bearing both Dolby Digital and DTS logos, select "STREAM/PCM."
• Receiver/decoder bearing neither Dolby Digital nor DTS logo, or digital recorder, select "PCM ONLY."

To bring up the DVD PLAYER SETUP display later
Press SET UP for a few seconds until the DVD PLAYER SETUP display appears.

Precautions

Notes on the power cord
• When you are away on travel or otherwise for an extended period of time, remove the plug from the wall outlet. A small amount of power (1.0 W) is always consumed while the power cord is connected to the wall outlet.
• When unplugging the player from the wall outlet, always pull the plug, not the power cord.
• Do not handle the power cord with wet hands.
• Disconnect the power cord before cleaning the player or moving the player.
• Do not alter, twist or pull the power cord, or put anything heavy on it, which may cause fire, electric shock, or other accidents.
• If the cord is damaged, consult a dealer and have the power cord replaced with a new one.
• If the wall outlet does not match the AC plug, use the supplied AC power plug adapter (not for HongKong, Saudi Arabia, Australia, New Zealand).

Avoid moisture, water, dust, and high temperatures
• Do not place the player in moist or dusty places.
• If water gets inside the player, turn off the power and remove the plug from the wall outlet, then consult your dealer. Using the player in this state may cause a fire or electrical shock.
• Do not expose the player to direct sunlight or place it near a heating device.

Notes on installation
• Select a place which is level, dry and neither too hot nor too cold between 5°C and 35°C.
• Leave sufficient distance between the player and the TV.
• Do not install the player in a place subject to vibrations.
• Do not put heavy objects on the player.

To prevent malfunction of the player
• There are no user-serviceable parts inside. If anything goes wrong, unplug the power cord and consult your dealer.
• Do not insert any metallic objects, such as wires, hairpins, coins, etc. into the player.
• Do not block the vents. Blocking the vents may damage the player.

To clean the cabinet
• Use a soft cloth. Follow the relevant instructions on the use of chemically-coated cloths.
• Do not use benzene, thinner or other organic solvents and disinfectants. These may cause deformation or discoloring.

Playable discs

• DVD VIDEO, Audio CD, Video CD, SVCD
• DVD-R/-RW, +R/+RW written and finalized in the DVD VIDEO format
• CD-R/RW written in the SVCD, Video CD or Audio CD format
• DivX files on DVD-R/-RW written in the UDF format
• MP3/JPEG/DivX files on CD-R/RW written in the ISO 9660 format

Supported Digital audio formats:
Linear PCM, MPEG Multichannel, Dolby Digital, DTS (Digital Theater Systems)*
NOTES
• If a disc gets dirty, scratched or warped, or due to the disc characteristics or recording conditions, the player may not be able to play back such discs.
• The player can play back audio signals recorded in MIX-MODE CD, CD-G, CD-EXTRA and CD TEXT.
• With some discs, operations may not be possible.
• To play back DTS-encoded DVD VIDEO or DTS-encoded Audio CD discs correctly, connect the player to an amplifier with a built-in DTS decoder. Otherwise, playback sound will be distorted.

Unplayable discs
If you try to play back discs listed below, noise may be generated and causes damage to speakers.
• DVD-R/-RW written in the VR format
• DVD-ROM, DVD-RAM, DVD AUDIO, CD-ROM, PHOTO CD, SACD
• Unfinalized discs
• Discs of irregular shape or discs with tape, seals or paste on either the label side or playback side.
Playing back these discs may damage the player.

The Non-DVD side of a "DualDisc" does not comply with the "Compact Disc Digital Audio" standard. Therefore, the use of Non-DVD side of a DualDisc on this product may not be recommended.

Connections

Before making connections:
• Do not connect the AC power cord until all other connections have been made.
• Connect VIDEO OUT of the player directly to the video input of your TV. Connecting VIDEO OUT of the player to a TV via a VCR/an integrated TV/Video system may cause a monitor problem.

Basic Connection

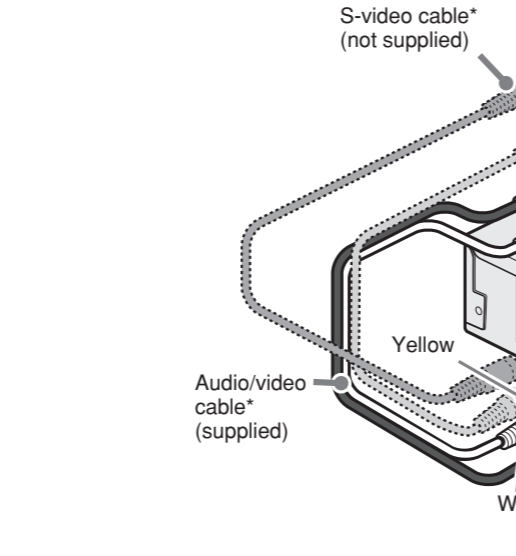

NOTES
• Set the correct color system according to the color system your TV supports. (See "COLOUR SYSTEM" in "Initial settings.")
• If your TV has a monaural audio input instead of stereo, use an optional audio cable which converts stereo audio output to monaural.
• If your TV is a HDTV or HD-ready TV, you can connect with component (Y, Pb, Pr) jacks. By connecting with component (Y, Pb, Pr) jacks, you can select the progressive scanning mode which provides the best picture quality.
* The S-VIDEO jack and the component (Y, Pb, Pr) jacks cannot be used at the same time. When using the S-VIDEO jack, do not connect the component (Y, Pb, Pr) jacks with the player.

Connecting to a TV with component jacks

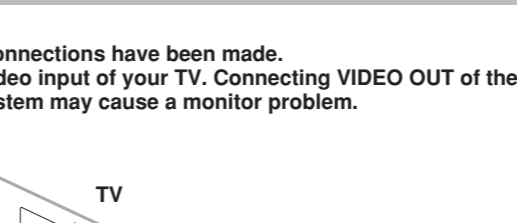

To switch the scanning mode between Progressive and Interlace, press and hold VFP-I/P on the remote control for a few seconds.

NOTES
• Connect "Y" to "Y," "Pb" to "Pb(Cb)," "Pr" to "Pr(Cr)" correctly.
• When using the component (Y, Pb, Pr) jacks, do not connect the S-VIDEO jack with the player.

About the scanning mode indicator

[PICTURE SOURCE] of the PICTURE menu	Source type of DVD VIDEO	Video source
AUTO	[DDP]	[P]
FILM	[DDP]	[DDP]
VIDEO(NORMAL)/(ACTIVE)	[P]	[P]

NOTE
Some progressive TV and High-Definition TV sets are not fully compatible with the player. To check the compatibility of your TV, contact your local JVC customer service center.

Connecting to a stereo audio amplifier (receiver)

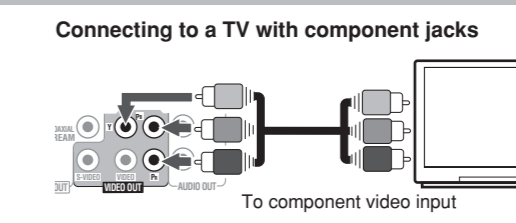

To switch the scanning mode between Progressive and Interlace, press and hold VFP-I/P on the remote control for a few seconds.

NOTES
• Connect "Y" to "Y," "Pb" to "Pb(Cb)," "Pr" to "Pr(Cr)" correctly.
• When using the component (Y, Pb, Pr) jacks, do not connect the S-VIDEO jack with the player.

About the scanning mode indicator

[PICTURE SOURCE] of the PICTURE menu	Source type of DVD VIDEO	Video source
AUTO	[DDP]	[P]
FILM	[DDP]	[DDP]
VIDEO(NORMAL)/(ACTIVE)	[P]	[P]

NOTE
Some progressive TV and High-Definition TV sets are not fully compatible with the player. To check the compatibility of your TV, contact your local JVC customer service center.

Connecting to a digital audio device

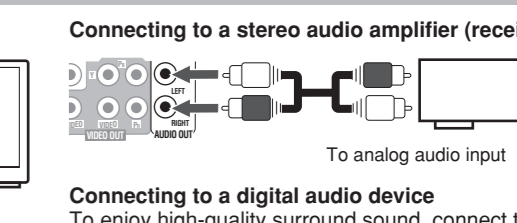

To switch the scanning mode between Progressive and Interlace, press and hold VFP-I/P on the remote control for a few seconds.

NOTES
• Connect "Y" to "Y," "Pb" to "Pb(Cb)," "Pr" to "Pr(Cr)" correctly.
• When using the component (Y, Pb, Pr) jacks, do not connect the S-VIDEO jack with the player.

About the scanning mode indicator

[PICTURE SOURCE] of the PICTURE menu	Source type of DVD VIDEO	Video source
AUTO	[DDP]	[P]
FILM	[DDP]	[DDP]
VIDEO(NORMAL)/(ACTIVE)	[P]	[P]

NOTE
Some progressive TV and High-Definition TV sets are not fully compatible with the player. To check the compatibility of your TV, contact your local JVC customer service center.

Basic Operations

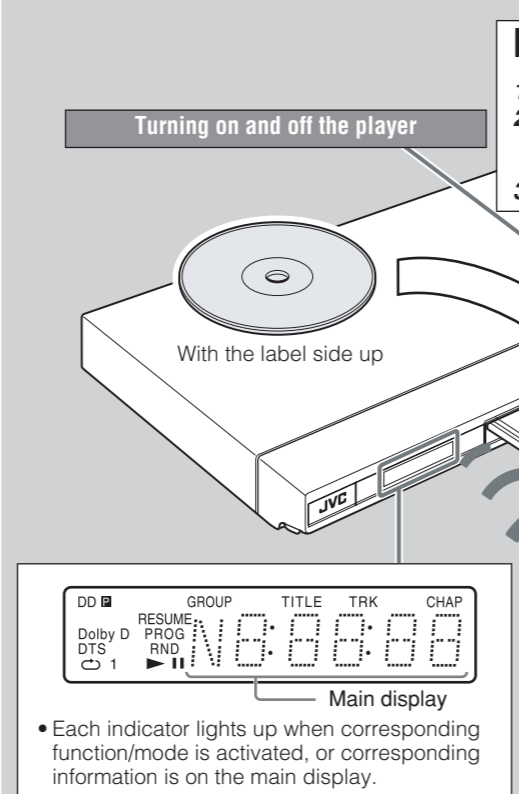

• Each indicator lights up when corresponding function/mode is activated, or corresponding information is on the main display.

About On-screen guide icons
▶ : Playback.
|| : Pause.
▶ ◀ : Slow-motion playback with the current speed.
▶ ◀ ◀ : Fast forward/backward playback with the current speed.
◀ ◀ : At the beginning of a scene containing multi-angle views.
◓ : At the beginning of a scene containing multi-audio sounds.
◓◓ : At the beginning of a scene containing multi-subtitles.
You can change the setting so that the on-screen guide icons do not appear on the TV screen. (See "ON SCREEN GUIDE" in "Initial settings.")

Insert a disc
1 Press ▲ to open the disc tray.
2 Place a disc in the disc tray.
3 Press ▲ to close the disc tray.

Turning on and off the player
Press Standby/ON.

Open/close the disc tray
Press ▲/▼.

Basic playback
▶ Start/resume normal Playback
■ Stop
• When RESUME is ON or DISC RESUME, this player memorizes the position on the disc where you interrupted playback.
- To resume playback, press ▶.
- To stop playback completely, press ■ again.
|| Pause
• Each time you press the button, the still picture advances to the next frame.
▶▶/◀◀ Fast forward/backward (While paused)
Slow-motion playback
• Each time you press the button, the playback speed changes.
▶▶||/◀◀|| Skip chapter/track
• If you press and hold the button during playback, playback is advanced/reversed at 5 times normal speed.

VARIABLE PLAYBACK/VARI-PLAY
(For DVD Video)
You can change the playback speed with the sound (except for DTS) and subtitles.
To playback 1.2 or 1.5 times faster, press VARIABLE PLAYBACK/VARI-PLAY on the player or ▶▶ on the remote control.
To playback 0.8 or 0.6 times slower, press ▶▶|| on the remote control while playback is paused.
(For SVCD/VCD)
The disc is played back at about 2 times faster than normal.
(Only for DVD Video)
The playback position moves back 10 seconds before the current position (only within the same title).
* || on the player starts/pauses playback.

When playing a disc with low quality recording conditions or scratches
If the disc is poorly recorded or the disc is of poor quality, there may be problems with playback or discs cannot be played back at all. TRACK ADJUST function allows you to play back such discs with better quality. Each time you press TRACK ADJUST, the mode of the function appears on the TV screen and changes as follows:
TRACK ADJUST OFF → TRACK ADJUST MODE 1 → TRACK ADJUST MODE 2
Select TRACK ADJUST MODE 1 or MODE 2 which gives you better results.
To return to the normal playback mode, select TRACK ADJUST OFF.
• Opening the disc tray will set the function to off.
• This function is not available for some discs.
• If the disc cannot be played back, try to set the TRACK ADJUST mode before you close the tray.

Turning on and off the player

Open/close the disc tray

Basic playback

▶ Start/resume normal Playback
■ Stop
• When RESUME is ON or DISC RESUME, this player memorizes the position on the disc where you interrupted playback.
- To resume playback, press ▶.
- To stop playback completely, press ■ again.
|| Pause
• Each time you press the button, the still picture advances to the next frame.
▶▶/◀◀ Fast forward/backward (While paused)
Slow-motion playback
• Each time you press the button, the playback speed changes.
▶▶||/◀◀|| Skip chapter/track
• If you press and hold the button during playback, playback is advanced/reversed at 5 times normal speed.

VARIABLE PLAYBACK/VARI-PLAY

(For DVD Video)
You can change the playback speed with the sound (except for DTS) and subtitles.
To playback 1.2 or 1.5 times faster, press VARIABLE PLAYBACK/VARI-PLAY on the player or ▶▶ on the remote control.
To playback 0.8 or 0.6 times slower, press ▶▶|| on the remote control while playback is paused.
(For SVCD/VCD)
The disc is played back at about 2 times faster than normal.
(Only for DVD Video)
The playback position moves back 10 seconds before the current position (only within the same title).
* || on the player starts/pauses playback.

Changing the display brightness

Press DIMMER to change the brightness of the display window.

Changing the display window contents

Each time you press DISPLAY, the display window contents changes.

Locating the beginning of a scene or song

You can select a title/chapter/track directly and start playback.
For DVD Video: (While stopped) select title. (While playing/vcd) select chapter.
For SVCD/VCD/CD: Select track.
To select 5: press 5.
To select 23: press 2, then 3.
To select 40: press 4, then 0.
• If you press TITLE/GROUP before entering the number, you can select the title instead of the chapter.

Using the disc menu

You can operate a disc—SVCD/VCD with Playback Control* (PBC)—using the disc menu shown on the TV screen.
* A method of controlling disc play for SVCD/VCD by using the disc menu.

■ For DVD
1 Press TOP MENU or MENU to show the disc menu.
2 Press ▲/▼/◀/▶ to select a desired item, then press ENTER or ► (SELECT).
• With some discs, you can also select items by entering the number using the numeric buttons.
■ For SVCD/VCD
1 While stopped, press TOP MENU or ► (SELECT) to show the menu.
2 Press the numeric buttons to select a desired item.
To select 5: press 5.
To select 23: press 2, then 3.
To select 40: press 4, then 0.
• To move to the next or previous page of the current menu, press ▶▶| or ◀◀|.
• To return to the previous menu, press RETURN.
To play back without PBC
While stopped, press the numeric buttons instead of ► (SELECT) to start playback.
To reactivate PBC
• Press TOP MENU or MENU.
• Press ■ to stop playback, then ► (SELECT).

Advanced Operations

Changing the language, sound and scene angle

1 Press the button.
2 Press the button repeatedly or ▲/▼ to select the desired item.
3 Press ENTER to finish the setting.
Buttons To do
AUDIO For DVD Video: select audio languages. For SVCD/VCD: select the audio channel.
SUBTITLE select the subtitle.
ANGLE select the view-angle.

Changing the Sound Field

Each time you press SOUND EFFECT, the Sound Effect mode changes.
• As the value becomes bigger, the Sound Effect works stronger.

Zooming the picture

Each time you press ZOOM, the magnification changes.
• You can use ▲/▼/◀/▶ button to move the zoomed position.
To return to the normal playback, select the normal size by pressing ZOOM repeatedly.

Changing the picture tone (VFP)

The VFP (Video Fine Processor) function allows you to adjust the picture character according to the type of programming, picture tone or personal preferences.
1 Press VFP-I/P.
2 Press ◀/▶ to select the desired preset.

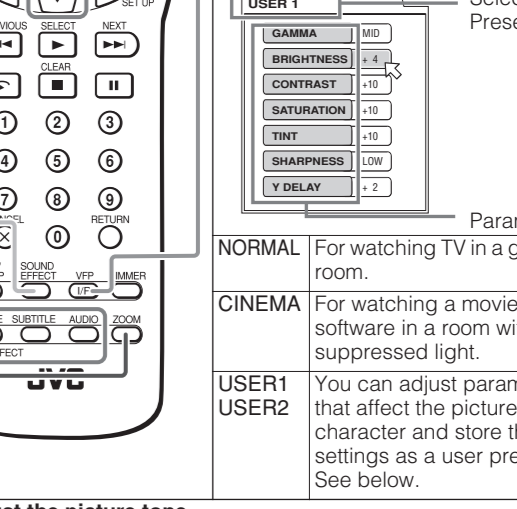

To adjust the picture tone

1 Select "USER1" or "USER2."	2 Press ▲/▼ to select a parameter, then press ENTER.
GAMMA	Adjust this if the neutral color is bright or dark. The brightness of dark and bright portion is maintained (LOW/MID/HIGH).
BRIGHTNESS	Adjust this if the picture is bright or dark on the whole (-16 (darkest) to +16 (brightest)).
CONTRAST	Adjust this if the far and near position is unnatural (-12 to +12).
SATURATION	Adjust this if the picture is whitish or blackish (-16 (blackest) to +16 (whitest)).
TINT*	Adjust this if the appearance of flesh tone is unnatural (-16 to +16).
SHARPNESS	Adjust this if the picture is indistinct (LOW/HIGH).
Y DELAY	Adjust this if the picture looks separately/overlapped (-2 to +2).

3 Press ▲/▼ to adjust the parameter, then press ENTER.
4 Repeat step 2 and 3 to adjust other parameters.
5 Press VFP-I/P to finish the setting.

* If you set "COLOUR SYSTEM" in the initial setting to "PAL," you cannot select this item.

Menu bar functions

You can use various functions from the menu bar.

To bring up the menu bar

When a disc is inserted, press ON SCREEN twice.

A menu bar for the type of disc inserted will appear under the status bar.

Ex.: Menu bar for DVD VIDEO



To dismiss the menu bar and the status bar, press ON SCREEN.

Basic operation procedure

1 Press ◀▶ to select the icon you want to work with. **2** Press ENTER.

After pressing ENTER:

- When a pull-down menu appears, press ▲/▼ to select the setting you want, then press ENTER.
- When a number-entry box appears, use the numeric buttons to enter the number you want, then press ENTER.

- When changing **TIME** setting, press ENTER repeatedly to select the setting you want.

NOTES

- The selected item on the menu bar is shown in green.
- The available functions differ depending on the player status. Refer to the explanation below to check when you can use a certain function.

Menu bar functions

TIME selects the time mode shown in the display window and the status bar.

- TOTAL**: Elapsed time of current title (DVD) or a disc (CD/VCD/SVCD)
- T.REM**: Remaining time of current title (DVD) or a disc (CD/VCD/SVCD) (Except for DVD: while stopped, disc total time)
- TIME**: Elapsed time of current chapter (DVD) or track (CD/VCD/SVCD)
- REM**: Remaining time of current chapter (DVD) or track (CD/VCD/SVCD) (while stopped, current track total time)

↺ selects repeat mode.

DVD: During playback
CD: In any condition
VCD/SVCD: In any condition except PBC playback

- CHAPTER**: Current chapter repeat (DVD)
- TITLE**: Current title repeat (DVD)
- TRACK**: Current track repeat (CD/VCD/SVCD)
- ALL**: All track repeat (CD/VCD/SVCD)
- A-B**: A-B repeat (During playback). After selecting A-B, press ENTER at the beginning point of repeat, then press ENTER again at the end point.

- OFF**: Repeat mode deactivated. Select this to quit repeat mode.

⏮ specifies beginning point of a title (DVD) or a disc (CD/VCD/SVCD) by the time.

DVD: In any condition
CD: In any condition except program or random playback

VCD/SVCD: In any condition except PBC or program or random playback

CHAP.▶ specifies a chapter to play back from (DVD only).

Audio

Ⓓ selects the audio language (DVD), sound track (DVD), or audio channel (VCD/SVCD) during playback.

Ⓜ selects the subtitle language (DVD) or subtitle (SVCD) during playback.

Ⓜ selects a desired scene angle in a multi-angle part (DVD only).

PROG. specifies the playback order of tracks while stopped (unavailable for DVD). You can program up to 99 tracks.

- After selecting **PROG.** icon, press the numeric buttons to specify tracks in the desired order.
 - To correct the program, press ▲/▼ to move ⏮ to the track to be corrected, then press CANCEL. The track is erased and the subsequent programmed tracks move up.
 - Pressing **■** clears all the programmed tracks.
- Press ▶(SELECT) to start program playback.
 - During program playback, you cannot edit the program contents.
- To exit the program mode, press ON SCREEN after clearing the program.

RND. activates random playback while stopped (unavailable for DVD).

After selecting **RND.** icon, press ENTER.

The player starts random playback.

Audio/Video files playback

You can play back MP3/JPEG files on a CD/CD-R/RW and DivX files recorded on CD-R/RW, DVD-R/RW.

Precautions

- Use "ISO 9660" as the disc format.
- The player does not support MP3/JPEG discs recorded with "packet writing" (UDF files).
- The player supports discs recorded with up to five multiple sessions.
- The player may be unable to play back a disc due to the characteristics or recording conditions.
- The player recognizes up to the fifth layer of groups, 999 files per group (including unplayable files), and up to 250 groups per disc.
- Add the appropriate extension (Ex: ".mp3," ".jpg," ".avi," and ".divx") to the file name.
- MP3i and MP3 Pro are not available.
- The player cannot play back a picture of more than 5120 x 3413 pixels (baseline JPEG) or 2048 x 1536 pixels (progressive JPEG).
- The player supports the DivX files whose resolution is 720 x 480 pixels or less (30 fps), and 720 x 576 pixels or less (25 fps).

Selecting a specific file or group

You can select files or folders (groups) using the Control display on the TV screen.

Control display

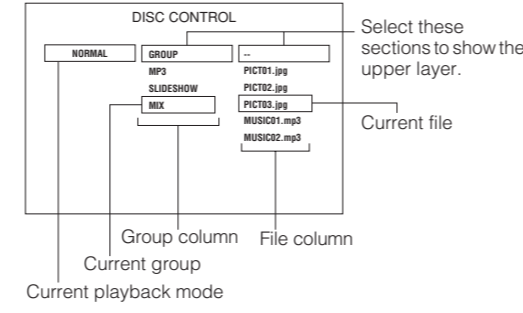

Press ▲/▼/◀▶ to move the cursor bar to a desired file, then press ▶(SELECT).

- For JPEG files, only the selected file is played back when you press ENTER.

Various playback mode

- To play back a disc continuously, select NORMAL.

Repeat playback

- While stopped, press ▲/▼/◀▶ to move the cursor bar to playback mode.
- Press ENTER repeatedly to select the desired repeat mode.
 - REPEAT 1: Repeats the current file.
 - REPEAT GROUP: Repeats all files in the current group.
 - REPEAT ALL: Repeats all files on the disc.
- Press ▶ to move the cursor bar to the file column, then press ▶(SELECT).

Random playback

- While stopped, press ▲/▼/◀▶ to move the cursor bar to playback mode.
- Press ENTER repeatedly to select RANDOM.
- Press ▶ to move the cursor bar to the file column, then press ▶(SELECT).

Program playback

- While stopped, press ▲/▼/◀▶ to move the cursor bar to playback mode.
- Press ENTER repeatedly to select PROGRAM.
- Press ▲/▼/◀▶ to select the desired file, then press ENTER.
- Repeat step 3 until all the desired files are selected.
 - To erase the last programmed file, press ◀ to move the cursor bar to the programmed files column, then press CANCEL.
- Press ▶(SELECT).

To zoom in a picture

Press ZOOM.

Each time you press ZOOM, the magnification is changed—

- x1.5/x2 for JPEG files
- x2 for DivX files

NOTE

This function is not available for some JPEG files depending on their resolution size and JPEG format.

To rotate/reflect a still picture

While a still picture is played back:

- Pressing ◀▶ rotates the picture by 90°.
- Pressing ▲ reflects the picture vertically.
- Pressing ▼ reflects the picture horizontally.

Troubleshooting

Power

Power does not come on.

- Power plug is not inserted securely. Plug in securely.

Operation

“REGION CODE ERROR!” is shown on the TV.

- Region code of the inserted disc does not match the player. Check the region code of the disc printed on the disc jacket.

Operation is not possible.

- Microcomputer malfunction due to lightning or static electricity. Turn off the power and unplug the power cord, then connect the power cord again.
- Moisture condensation caused by a sudden change of temperature or humidity. Turn off the power, then turn it on a few hours later.
- The disc does not allow the operation, or an unplayable disc is inserted. Check and replace the disc.

[LOCK] is displayed on the display window and the disc tray does not open.

- When you press ▲ while pressing down **■** on the player in standby mode, the tray lock function is activated. The disc tray cannot be opened or closed in this status. To release this status, press ▲ while pressing down **■** on the player in standby mode.

Picture

Picture is noisy.

- The player is connected to a VCR directly and the copyguard function is activated. Connect the player so that the picture signal flows directly to the TV. With some discs, the picture may be blurred when [PICTURE SOURCE] is set to [FILM] or [AUTO]. Set [PICTURE SOURCE] to [VIDEO (NORMAL)] or [VIDEO (ACTIVE)].
- The disc may be poorly recorded or scratched. Try to use the **TRACK ADJUST** function to play back with better quality.

Picture is distorted when using

component (Y, Pb, Pr) or S-VIDEO jack(s).

- Both the component connection and S-video connection are made. Disconnect the unused one.

Initial settings

You can change the settings of this player according to your preferences and playing environment.

How to set the Initial settings

1 Press SET UP.

2 Press ▶▶ to select the menu.

3 Press ▲/▼ to move to select the item.

4 Press ENTER.

5 Press ▲/▼ to select the options, then press ENTER.

To dismiss a preference display

Press SET UP.

9

Initial settings

You can change the settings of this player according to your preferences and playing environment.

How to set the Initial settings

1 Press SET UP.

2 Press ▶▶ to select the menu.

3 Press ▲/▼ to move to select the item.

4 Press ENTER.

5 Press ▲/▼ to select the options, then press ENTER.

To dismiss a preference display

Press SET UP.

LANGUAGE menu

Item	Contents
MENU LANGUAGE	You can select the default menu language of DVD VIDEO.
AUDIO LANGUAGE	You can select the default audio language of DVD VIDEO.
SUBTITLE	You can select the default subtitle language of DVD VIDEO.
ON SCREEN LANGUAGE	You can select "ENGLISH," "CHINESE," or "SPANISH" as the on-screen language.

PICTURE menu

Item	Contents
MONITOR TYPE	You can select the monitor type to match your TV when you play back DVD VIDEO discs recorded for wide-screen televisions. <p>[16:9] (Wide television screen): For a wide-screen (16:9) TV.</p> <p>[4:3 LB] (Letter Box conversion): For a normal (4:3) TV. Displays a wide-screen picture to fit the width of the TV screen keeping the aspect ratio.</p> <p>[4:3 PS] (Pan Scan conversion): For a normal (4:3) TV. The picture is zoomed up to filling the screen vertically and the left and right sides of the picture are cut off.</p>
PICTURE SOURCE	You can obtain optimal picture quality by selecting the source type of the disc contents. <p>[AUTO]: Normally, select this option. The player recognizes the picture type (film or video source) of the current disc according to the disc information.</p> <p>[FILM]: For a film source disc.</p> <p>[VIDEO (NORMAL)]: For a video source disc with relatively a few movements.</p> <p>[VIDEO (ACTIVE)]: For a video source disc with relatively a lot of movements.</p>
SCREEN SAVER	You can set the screen saver function to ON or OFF.
COLOUR SYSTEM	You need to select the color system format according to your TV. <p>[PAL]: A TV supporting PAL system.</p> <p>[NTSC]: A TV supporting NTSC system.</p> <p>[MULTI]: A TV supporting both PAL and NTSC systems. The player outputs a PAL or NTSC video signal according to the disc.</p>
BACKGROUND	You can use your favorite image as the opening display. <p>[STANDARD]: Display the JVC original image.</p> <p>[USER]: Display your favorite image as the opening display when a JPEG image is registered.</p> <p>[SAVE AS BACKGROUND]: To register a new image, select this while a JPEG image is displayed on the TV.</p>

AUDIO menu

Item	Contents
DIGITAL AUDIO OUTPUT	Set this item correctly according to the logo on your receiver or decoder. <p>[PCM ONLY]: Receiver/decoder bearing neither Dolby Digital nor DTS logo, or digital recorder.</p> <p>[DOLBY DIGITAL/PCM]: Receiver/decoder bearing Dolby Digital logo and no DTS.</p> <p>[STREAM/PCM]: Receiver/decoder bearing both Dolby Digital and DTS logos.</p>
ANALOG DOWNMIX	Set this item properly according to your analog audio connection to play the sound of the surround multichannel audio on a DVD VIDEO. <p>[DOLBY SURROUND]: Select this when connecting to a surround decoder.</p> <p>[STEREO]: Select this when connecting to a stereo amplifier or TV, or in case you want to record from a DVD VIDEO to a MiniDisc, cassette, etc.</p>
D.RANGE CONTROL	Set this item to listen to DVD VIDEO recorded in Dolby Digital format at low or middle volume. <p>[WIDE RANGE]: You can enjoy powerful playback sound.</p> <p>[NORMAL]: Normally, select this.</p> <p>[TV MODE]: Select this if the sound level of DVD VIDEO is lower than the one of TV program to make the sound at a lower volume clear.</p>
OUTPUT LEVEL	Set this item to attenuate the level of the signal output from the analog AUDIO OUT terminals. If the sound from the speaker is distorted, select [LOW].

OTHERS menu

Item	Contents
RESUME	You can select the resume playback mode. <p>[ON]: The player resumes playback from the position where playback has been stopped if the disc is still in the disc tray.</p> <p>[OFF]: This function is deactivated.</p> <p>[DISC RESUME]: The player resumes playback of the last 30 discs played. The player retains a memory of the stopped position of each disc even if the disc is removed from the disc tray. The TRACK ADJUST MODE selected for the disc will be resumed as well.</p>
ON SCREEN GUIDE	Activate or deactivate the on-screen guide.
AUTO STANDBY	Set the time until the player turns off (into standby) automatically if playback is stopped for more than 30 minutes or 60 minutes.
DivX REGISTRATION	You can confirm of your player's Registration Code for DivX playback. Once you played back a disc created by using the Registration Code, the player's code is overwritten by a totally different new one for copyright protection purpose.

10

11

Language codes list for the LANGUAGE menu

AA Afar	EL Greek	IS Icelandic	MN Mongolian	RO Rumanian	TH Thai
AB Abkhazian	EO Esperanto	IW Hebrew	MO Moldavian	RU Russian	TI Tigrinya
AF Afrikaans	ET Estonian	JJ Yiddish	MR Marathi	RW Kinyarwanda	TK Turkmen
AM Ameharic	EU Basque	JW Javanese	MS Malay (MAY)	SA Sanskrit	TL Tagalog
AR Arabic	FA Persian	KA Georgian	MT Maltese	SG Sangho	TN Setswana
AS Assamese	FI Finnish	KK Kazakh	MY Burmese	SH Serbo-Croatian	TO Tongan
AY Aymara	FJ Fiji	KL Greenlandic	NA Nauru	SI Singhalese	TR Turkish
AZ Azerbaijani	FO Faroese	KM Cambodian	NE Nepali	NL Dutch	TS Tsonga
BA Bashkir	FY Frisian	KN Kannada	NO Norwegian	SK Slovak	TW Twi
BE Byelorussian	GA Irish	KO Korean (KOR)	OC Occitan	SL Slovenian	UK Ukrainian
BG Bulgarian	GD Scots Gaelic	KS Kashmiri	OM (Afan) Oromo	SM Samoan	UR Urdu
BH Bihari	GL Galician	KU Kurdish	OR Oriya	SN Shona	UZ Uzbek
BI Bislama	GN Guarani	KY Kirghiz	SQ Albanian	SO Somali	VI Vietnamese
BN Bengali, Bangla	GU Gujarati	LA Latin	SR Serbian	SQ Albanian	VO Volapuk
BO Tibetan	HA Hausa	LN Lingala	PL Polish	SR Serbian	WO Wolof
BR Breton	HI Hindi	LO Laothian	PS Pashhto, Pushto	SS Siswati	XH Xhosa
CA Catalan	HR Croatian	LT Lithuanian	PT Portuguese	SU Sundanese	YO Yoruba
CO Corsican	HU Hungarian	LV Latvian, Lettish	QU Quechua	SV Swedish	ZU Zulu
CS Czech	HY Armenian	MG Malagasy	RM Rhaeto-Romance	SW Swahili	
CY Welsh	IA Interlingua	MI Maori	RN Kirundi	TA Tamil	
DA Danish	IE Interlingue	MK Macedonian		TE Telugu	
DZ Bhutani	IK Inupiak	ML Malayalam		TG Tajik	
	IN Indonesian				

No picture is displayed on the TV screen or the screen is blurred or divided into two parts.

- The player is in the progressive scanning mode though it is connected to a TV via the VIDEO or S-VIDEO jack. Observe the display window. If [P] is turned on, the player is in the progressive scanning mode.

Make the Progressive scanning mode inactive by using the VFP - I/P button.

Audio

DVD VIDEO disc playback sound level is lower than TV broadcast sound level.

- Set the [D.RANGE CONTROL] preference to [TV MODE].

Analog audio output is distorted.

- Set the [OUTPUT LEVEL] preference to [LOW].

MP3/JPEG/DivX

No sound and/or no picture comes out.

- MP3/JPEG disc is recorded with the "packet writing (UDF file)." It cannot be played. Check the files you want to play back.

Files (tracks) are not played in the recorded order.

- This player plays the files in the alphabetic order. So, the playback order can vary.

DivX files are played back without sound.

- This player can play back the MP3 sound for the audio part of the DivX files. Select the proper audio CODEC when making DivX files.