



Ariens Company  
 655 W. Ryan St.  
 Brillion, WI 54110  
 www.ariens.com

# Service Bulletin

**Product Family: 915 Series Riding Mowers with EZT Transaxles**

**Subject: 51520800 Hydro-Gear Axle Nut Replacement**

**Dealer Action: Replace Nuts When Setting Up or Servicing the Unit**

Model	Serial Number Range		Model	Serial Number Range
915100	001138 – 001390		915130	000101 – 010212
915102	000929 – 001568		915131	000101 – 010015
915103	000583 – 000590		915132	000101 – 001026
915104	000631 – 000793		915133	000102 – 000352
915106	001244 – 001464		915135	000101 – 000421
915107	000898 – 000911		915319	000170 – 000233
915108	000594 – 000805		915320	000176 – 000285

Hydro-Gear has notified Ariens Company that it has found increased incidents of stripped hub splines on EZT transaxles used on the above-listed consumer riding products built during the 2009 model year. To reduce the likelihood of stripping the hub splines, Hydro-Gear recommends replacing the axle nut p/n 08621100 (HG p/n 50863) with a new style pin lock nut p/n 21544033 (HG p/n 53711) according to the instructions provided on page 2.

Ariens has created EZT Transaxle Nut Replacement Kit p/n 51520800 to supply the new pin lock nut to dealers. Each kit contains two nuts, enough to service one riding mower.

For any of the above-listed models in inventory, or when servicing one of the above-listed models, inspect the transaxles for the old style axle nut. If the nuts need to be replaced, order and install EZT Transaxle Nut Replacement Kit p/n 51520800. The instructions on page 2 provide the inspection procedure.

Installation of the kits is covered under warranty while the unit is within its standard warranty period. Dealers will be reimbursed for 0.25 hours of labor at their standard posted shop labor rate for each kit they install.

### Inspection

Inspect the transaxles for the following Hydro-Gear model numbers ZC-\*C\*\*-\*<sup>\*\*\*\*</sup> or ZC-\*H\*\*-\*<sup>\*\*\*\*</sup> in Hydro-Gear serial number range 8306B<sup>\*\*\*\*</sup> through 9256B<sup>\*\*\*\*</sup>.

Transaxles in these model and serial number ranges that do not have the pin lock nuts installed will need to have the axle nuts replaced. Dealers should order and install EZT Transaxle Nut Replacement Kit p/n 51520800. If the transaxles are outside these model and serial number ranges, no replacement is needed.

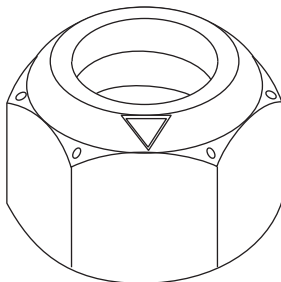
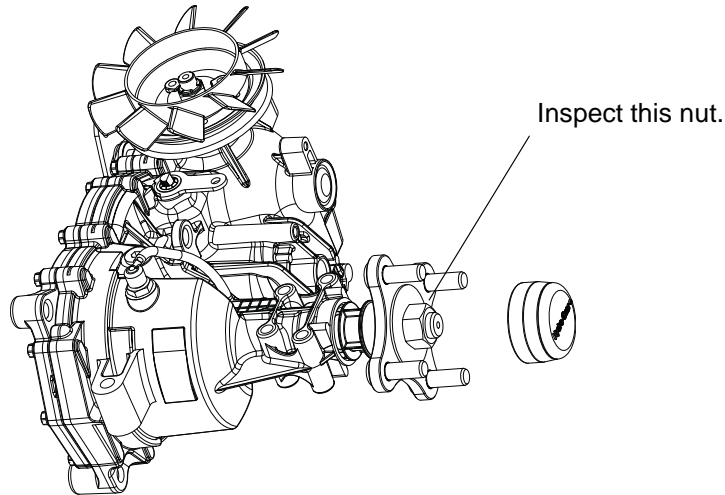

08621100 (HG p/n 50863)  
Remove and replace this  
nut.

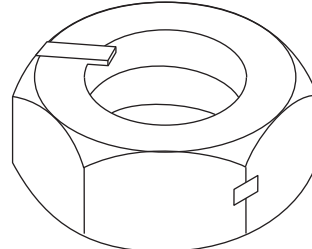

21544033 (HG p/n 53711)  
Install this style pin lock  
nut.

## Replacement

If you have a torque wrench capable of 250 lbf-ft, you can use a torque wrench to install the new pin lock nuts.

1. Record machine model and serial number.
2. Record both transaxle model and serial numbers.
3. Engage the parking brake.
4. Remove the nut cover.
5. Remove the existing 08621100 (HG p/n 50863) axle nut.
6. Install the pin lock nut p/n 21544033 (HG p/n 53711) supplied in the 51520800 kit and tighten to 250 lbf-ft (338 N•m). **Do not overtighten and do not use an impact or pneumatic wrench on the pin lock nuts.**
7. Reinstall the nut cover.
8. Replace the nut on the opposite transaxle.
9. After installing the pin lock nuts, always follow the instructions for removing pin lock nuts in Hydro-Gear's service manuals. The pins can damage the axle if the nuts are removed improperly.

If you do not have a torque wrench capable of 250 lbf-ft, use the nut flats method to install the new pin lock nuts.

1. Record machine model and serial number.
2. Record both transaxle model and serial numbers.
3. Engage the parking brake.
4. Remove the nut cover.
5. Remove the existing 08621100 (HG p/n 50863) axle nut.
6. Install pin lock nut 21544033 (HG p/n 53711) supplied in the 51520800 kit and tighten to 50 lbf-ft (68 N•m). **Do not use an impact or pneumatic wrench on the pin lock nuts.**
7. Mark a point on the nut and hub (Mark A) and then mark a point two nut flats (120 degrees) over in a clockwise direction (Mark B). Turn the nut clockwise until Mark A aligns with Mark B.
8. Reinstall the nut cover.
9. Replace the nut on the opposite transaxle.
10. After installing the pin lock nuts, always follow the instructions for removing pin lock nuts in Hydro-Gear's service manuals. The pins can damage the axle if the nuts are removed improperly.

