

**CENTRAL PNEUMATIC®**

# ***DUST RECLAIMER KIT***

(FOR USE WITH MODEL 94274 INDUSTRIAL BLAST CABINET)

**Model 94275**

## **INSTALLATION AND OPERATING INSTRUCTIONS**



Due to continuing improvements, actual product may differ slightly from the product described herein.



3491 Mission Oaks Blvd., Camarillo, CA 93011

Visit our Web site at: <http://www.harborfreight.com>

**TO PREVENT SERIOUS INJURY,  
READ AND UNDERSTAND ALL WARNINGS  
AND INSTRUCTIONS BEFORE USE.**

Copyright© 2007 by Harbor Freight Tools®. All rights reserved. No portion of this manual or any artwork contained herein may be reproduced in any shape or form without the express written consent of Harbor Freight Tools.

**For technical questions, please call 1-800-444-3353.**

## PRODUCT SPECIFICATIONS

| Item                                | Description   |
|-------------------------------------|---|
| Product Compatibility               | For Use with Model 94274 Industrial Blast Cabinet           |
| Electrical Requirements             | 115 VAC / 60 Hz / 12.0 Amps / 18,900 Motor RPM / 1380 Watts |
| Power Cord Type: Ft. Long           |   |
| Power Plug Type: 3-Prong / Grounded |   |
| Holding Capacity                    | Approximately 1-3/4 Gallons                                 |
| Hose Size/Type                      | 2" Diameter x 3 Ft. Long / Wire Mesh Reinforced             |
| Overall Dimensions                  | 28-1/2" High x 10" Diameter x 6-1/2" Diameter (at bottom)   |

## SAVE THIS MANUAL

You will need this manual for the safety warnings and precautions, assembly, operating, inspection, maintenance and cleaning procedures, parts list and assembly diagram. Keep your invoice with this manual. Write the invoice number on the inside of the front cover. Keep this manual and invoice in a safe and dry place for future reference.

## GENERAL SAFETY RULES

 **WARNING!**  
**READ AND UNDERSTAND ALL INSTRUCTIONS**  
Failure to follow all instructions listed below may result in electric shock, fire, and/or serious injury.  
**SAVE THESE INSTRUCTIONS**

### WORK AREA

1. **Keep your work area clean and well lit.** Cluttered benches and dark areas invite accidents.
2. **Do not operate power tools in explosive atmospheres, such as in the presence of flammable liquids, gases, or dust.** Power tools create sparks which may ignite the dust or fumes.
3. **Keep bystanders, children, and visitors away while operating a power tool.** Distractions can cause you to lose control. Protect others in the work area from debris such as chips and sparks. Provide barriers or shields as needed.

## ELECTRICAL SAFETY

4. **Grounded tools must be plugged into an outlet properly installed and grounded in accordance with all codes and ordinances. Never remove the grounding prong or modify the plug in any way. Do not use any adapter plugs. Check with a qualified electrician if you are in doubt as to whether the outlet is properly grounded.** If the tools should electrically malfunction or break down, grounding provides a low resistance path to carry electricity away from the user.
5. **Double insulated tools are equipped with a polarized plug (one blade is wider than the other). This plug will fit in a polarized outlet only one way. If the plug does not fit fully in the outlet, reverse the plug. If it still does not fit, contact a qualified electrician to install a polarized outlet. Do not change the plug in any way.** Double insulation  eliminates the need for the three wire grounded power cord and grounded power supply system.
6. **Avoid body contact with grounded surfaces such as pipes, radiators, ranges, and refrigerators.** There is an increased risk of electric shock if your body is grounded.
7. **Do not expose power tools to rain or wet conditions.** Water entering a power tool will increase the risk of electric shock.
8. **Do not abuse the Power Cord (12). Never use the Power Cord to pull the Plug from an outlet. Keep the Power Cord away from heat, oil, sharp edges, or moving parts. Replace damaged Power Cords immediately.** Damaged Power Cords increase the risk of electric shock.
9. **When operating a power tool outside, use an outdoor extension cord marked “W-A” or “W”.** These extension cords are rated for outdoor use, and reduce the risk of electric shock.

## PERSONAL SAFETY

10. **Stay alert. Watch what you are doing, and use common sense when operating a power tool. Do not use a power tool while tired or under the influence of drugs, alcohol, or medication.** A moment of inattention while operating power tools may result in serious personal injury.
11. **Dress properly. Do not wear loose clothing or jewelry. Contain long hair. Keep your hair, clothing, and gloves away from moving parts.** Loose clothes, jewelry, or long hair can be caught in moving parts.

12. **Avoid accidental starting. Be sure the Power Switch is off before plugging in.** Plugging in power tools with the Power Switch on, invites accidents.
13. **Remove adjusting keys or wrenches before turning the power tool on.** A wrench or a key that is left attached to a rotating part of the power tool may result in personal injury.
14. **Do not overreach. Keep proper footing and balance at all times.** Proper footing and balance enables better control of the power tool in unexpected Situations.
15. **Use safety equipment. Always wear eye protection.** Dust mask, non-skid safety shoes, hard hat, or hearing protection must be used for appropriate conditions.

#### TOOL USE AND CARE

16. **Do not force the tool. Use the correct tool for your application.** The correct tool will do the job better and safer at the rate for which it is designed.
17. **Do not use the power tool if the Power Switch does not turn it on or off.** Any tool that cannot be controlled with the Power Switch is dangerous and must be replaced.
18. **Disconnect the Power Cord Plug from the power source before making any adjustments, changing accessories, or storing the tool.** Such preventive safety measures reduce the risk of starting the tool accidentally.
19. **Store idle tools out of reach of children and other untrained persons.** Tools are dangerous in the hands of untrained users.
20. **Maintain tools with care. Keep this product clean.** Properly maintained tools are less likely to malfunction and are easier to control. Do not use a damaged tool. Tag damaged tools “**Do not use**” until repaired.
21. **Check for misalignment or binding of moving parts, breakage of parts, and any other condition that may affect the tool’s operation. If damaged, have the tool serviced before using.** Many accidents are caused by poorly maintained tools.
22. **Use only accessories that are recommended by the manufacturer for your model.** Accessories that may be suitable for one tool may become hazardous when used on another tool.



## SERVICE

23. **Tool service must be performed only by qualified repair personnel.** Service or maintenance performed by unqualified personnel could result in a risk of injury.
24. **When servicing a tool, use only identical replacement parts. Follow instructions in the “*Inspection, Maintenance, And Cleaning*” section of this manual.** Use of unauthorized parts or failure to follow maintenance instructions may create a risk of electric shock or injury.

## SPECIFIC SAFETY RULES

1. **This Dust Reclaimer Kit is designed for use only with Model 94274.**
2. **Use the right product for the job.** Do not attempt to force small tools and equipment to do the work of larger tools and equipment. There are certain applications for which this Dust Reclaimer was designed. It will do the job better and more safely at the rate and speed for which it was intended. Do not modify this Dust Reclaimer, and do not use this product for a purpose for which it was not intended.
3. **Maintain labels and nameplates on the Dust Reclaimer.** These carry important information. If unreadable or missing, contact Harbor Freight Tools for a replacement.
4. Always wear safety impact eye goggles when assembling and using the Dust Reclaimer. Also, use dust masks or a respirator when using the Dust Reclaimer. Using personal safety devices reduce the risk for injury.
5. **Maintain a safe working environment.** Keep the work area well lit. Make sure there is adequate surrounding workspace. Always keep the work area free of obstructions, grease, oil, trash, and other debris. Do not use a power tool in areas near flammable chemicals, dusts, and vapors. Do not use this product in a damp or wet location.
6.  **WARNING:** Some dust created by power sanding, sawing, grinding, drilling, and other construction activities, contains chemicals known [to the State of California] to cause cancer, birth defects or other reproductive harm. Some examples of these chemicals are: Lead from lead-based paints Crystalline silica from bricks and cement or other masonry products Arsenic and chromium from chemically treated lumber Your risk from these exposures varies, depending on how often you do this type of work. To reduce your exposure to these chemicals: work in a well ventilated area, and work with approved safety equipment, such as those dust masks that are specially designed to filter out microscopic particles. (California Health & Safety Code § 25249.5, *et seq.*)

REV 07J

8. **Never leave the Dust Reclaimer unattended when it is plugged into an electrical outlet.** Turn off the tool, and unplug it from its electrical outlet before leaving.
9. **Industrial applications must follow OSHA guidelines.**
10. **Do not allow children to handle or play with this product.**
11. **Always unplug the Dust Reclaimer from its electrical outlet before performing any maintenance or changing accessories.**
12. **Do not use the Dust Reclaimer with any openings blocked.** Keep free of anything that may reduce air flow or hinder motor operation.
13. **Do not use the Reclaimer without its Filter (18) in place.** Before each use, make sure the Filter is cleaned of excess debris.
14. **This product is designed only to pick up dry debris. Do not use the Dust Reclaimer to pick up water (or any other liquid) from the floor or containers such as sinks, tubs, barrels, etc.**
15. **When mounting the Dust Reclaimer to a wall surface, make sure the wall and the mounting hardware used (not included) are capable of supporting the weight of the Dust Reclaimer and its contents.**
16. **Prior to drilling mounting holes in a wall surface, check to make sure there are no hidden electrical cables, gas or plumbing pipes in the drilling path.**
17. ** WARNING! This Dust Reclaimer is not intended for use with silica based abrasives.** Silica based abrasives have been linked to severe respiratory disease such as silicosis. Always use silica substitutes such as aluminum oxide, glass bead, walnut shell, or brass bead.
18. ** WARNING!** People with pacemakers should consult their physician(s) before using this product. Operation of electrical equipment in close proximity to a heart pacemaker could cause interference or failure of the pacemaker.
19. ** WARNING!** The warnings and cautions discussed in this manual cannot cover all possible conditions and situations that may occur. It must be understood by the operator that common sense and caution are factors which cannot be built into this product, but must be supplied by the operator.
20. **Do not handle the Power Cord Plug (12) with wet hands. Never plug the Power Cord of this product into an electrical outlet while standing on a wet or damp surface.**

## GROUNDING

### WARNING!

Improperly connecting the grounding wire can result in the risk of electric shock. Check with a qualified electrician if you are in doubt as to whether the outlet is properly grounded. Do not modify the power cord plug provided with the tool. Never remove the grounding prong from the plug. Do not use the tool if the power cord or plug is damaged. If damaged, have it repaired by a service facility before use. If the plug will not fit the outlet, have a proper outlet installed by a qualified electrician.

### GROUNDING TOOLS: TOOLS WITH THREE PRONG PLUGS

1. Tools marked with “Grounding Required” have a three wire cord and three prong grounding plug. The plug must be connected to a properly grounded outlet. If the tool should electrically malfunction or break down, grounding provides a low resistance path to carry electricity away from the user, reducing the risk of electric shock. **(See Figure A.)**
2. The grounding prong in the plug is connected through the green wire inside the cord to the grounding system in the tool. The green wire in the cord must be the only wire connected to the tool’s grounding system and must never be attached to an electrically “live” terminal. **(See Figure A.)**
3. Your tool must be plugged into an appropriate outlet, properly installed and grounded in accordance with all codes and ordinances. The plug and outlet should look like those in the following illustration. **(See Figure A.)**

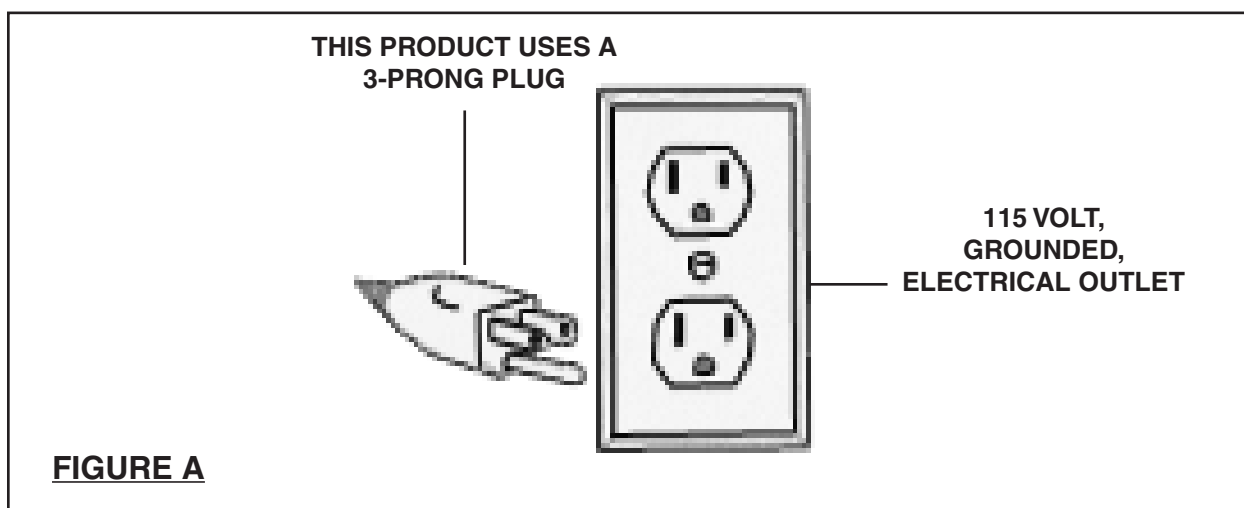

## DOUBLE INSULATED TOOLS: TOOLS WITH TWO PRONG PLUGS

1. Tools marked “Double Insulated” do not require grounding. They have a special double insulation system which satisfies OSHA requirements and complies with the applicable standards of Underwriters Laboratories, Inc., the Canadian Standard Association, and the National Electrical Code. **(See Figure B.)**
2. Double insulated tools may be used in either of the 120 volt outlets shown in the following illustration. **(See Figure B.)**

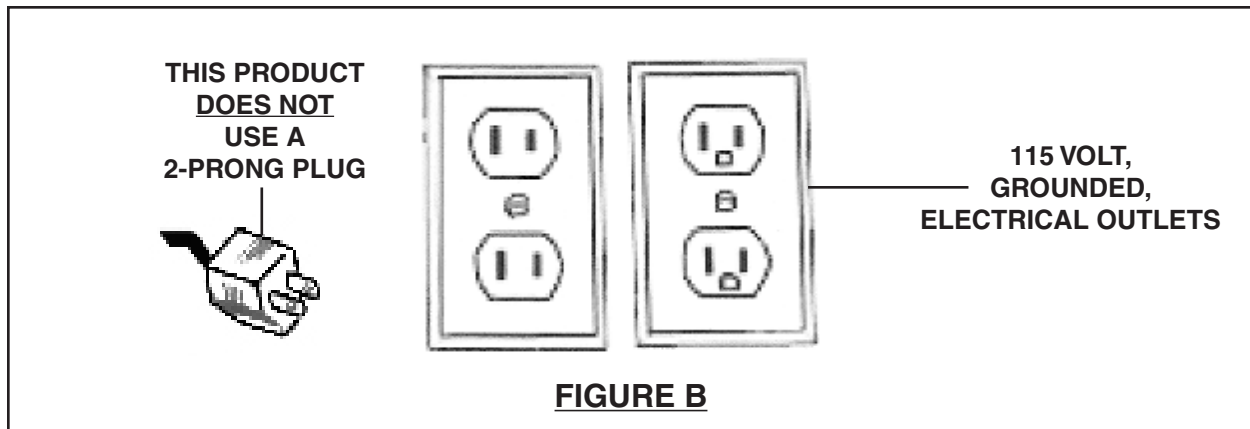

## EXTENSION CORDS

1. Grounded tools require a three wire extension cord. Double Insulated tools can use either a two or three wire extension cord.
2. As the distance from the supply outlet increases, you must use a heavier gauge extension cord. Using extension cords with inadequately sized wire causes a serious drop in voltage, resulting in loss of power and possible tool damage. (See Table A.)
3. The smaller the gauge number of the wire, the greater the capacity of the cord. For example, a 14 gauge cord can carry a higher current than a 16 gauge cord. (See Table A.)
4. When using more than one extension cord to make up the total length, make sure each cord contains at least the minimum wire size required. (See Table A.)
5. If you are using one extension cord for more than one tool, add the nameplate amperes and use the sum to determine the required minimum cord size. (See Table A.)
6. If you are using an extension cord outdoors, make sure it is marked with the suffix “W-A” (“W” in Canada) to indicate it is acceptable for outdoor use.





7. Make sure your extension cord is properly wired and in good electrical condition. Always replace a damaged extension cord or have it repaired by a qualified electrician before using it.
8. Protect your extension cords from sharp objects, excessive heat, and damp or wet areas.

| <b>RECOMMENDED MINIMUM WIRE GAUGE FOR EXTENSION CORDS*</b><br><b>(120 OR 240 VOLT)</b> |                              |                |                |                 |                 |
|--|------------------------------|----------------|----------------|-----------------|-----------------|
| <b>NAMEPLATE<br/>AMPERES<br/>(at full load)</b>  | <b>EXTENSION CORD LENGTH</b> |                |                |                 |                 |
|  | <b>25 Feet</b>               | <b>50 Feet</b> | <b>75 Feet</b> | <b>100 Feet</b> | <b>150 Feet</b> |
| 0 – 2.0  | 18                           | 18             | 18             | 18              | 16              |
| 2.1 – 3.4  | 18                           | 18             | 18             | 16              | 14              |
| 3.5 – 5.0  | 18                           | 18             | 16             | 14              | 12              |
| 5.1 – 7.0  | 18                           | 16             | 14             | 12              | 12              |
| 7.1 – 12.0   | 18                           | 14             | 12             | 10              | -               |
| 12.1 – 16.0  | 14                           | 12             | 10             | -               | -               |
| 16.1 – 20.0  | 12                           | 10             | -              | -               | -               |

**TABLE A** \* Based on limiting the line voltage drop to five volts at 150% of the rated amperes.

### SYMBOLOLOGY

|   |                                      |
|---|--------------------------------------|
|  | Double Insulated                     |
|  | Canadian Standards Association       |
|  | Underwriters Laboratories, Inc.      |
| V~  | Volts Alternating Current            |
| A   | Amperes                              |
| n <sub>0</sub> xxxx/min.  | No Load Revolutions per Minute (RPM) |

### UNPACKING

When unpacking, check to make sure all the parts shown on the Parts List on page 19 are included. If any parts are missing or broken, please call Harbor Freight Tools at: 1-800-444-3353 as soon as possible.

## ASSEMBLY INSTRUCTIONS

The Dust Reclaimer Kit can be attached to a wall surface (see instructions below), or it can be mounted to the back of SKU 94274 Blast Cabinet. See page 14.

### How To Install The Dust Reclaimer To A Wall

**IMPORTANT:** The Wire Mesh Reinforced Hose (16B) supplied with the Dust Reclaimer is **3 feet long**. When determining a permanent location for the Model 94274 Blast Cabinet, make sure the Blast Cabinet is **within 3 feet** of the wall surface on which the Dust Reclaimer will be mounted. **(See Figure 7, page 13).**

**NOTE:** You may wish to connect a *longer* Wire Mesh Reinforced Hose (not included between the Blast Cabinet and Dust Reclaimer. If so, make sure the longer Hose has a **2" diameter**, and use a proper extension cord to connect the Power Cord Plug (12) of the Dust Reclaimer to the Lamp Housing on the Blast Cabinet.

1. Open the right side door of the blast cabinet. Remove the four screws on the exhaust board. Take out the exhaust board (see Figure 1).
2. Install the Hose Connector (48) using four M5x12 bolts (47) as shown in Figure 2 below.
3. Re-install the Exhaust Board over the Hose Connector (48) (see Figure 1).

Figure 1

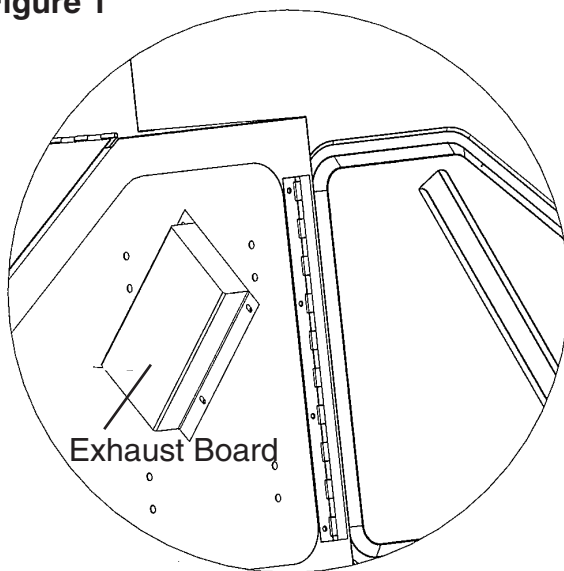
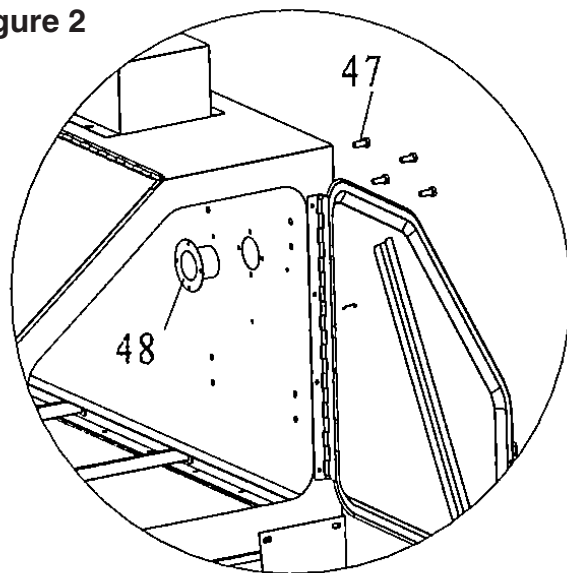

Figure 2



4. Use the pattern in Figure 3 as a reference, or hold the assembled Dust Reclaimer against the wall where you intend to mount it, and mark the drill hole positions through the mounting holes.
5. Drill holes in the wall to except the Wall Anchors (33). Use a concrete drill bit that is 5/16" diameter.

NOTE: The Wall Anchors (33) are intended for concrete walls. If you are attaching the Dust Reclaimer Kit to drywall or wood you will need different fasteners (not included).

**CAUTION!** When mounting the Dust Reclaimer to a wall surface, make sure that the wall and the mounting hardware used are capable of supporting the weight of the Dust Reclaimer and its contents. Prior to drilling mounting holes in a wall surface, check to make sure there are no hidden electrical cables, gas or plumbing pipes in the drilling path.

Figure 3

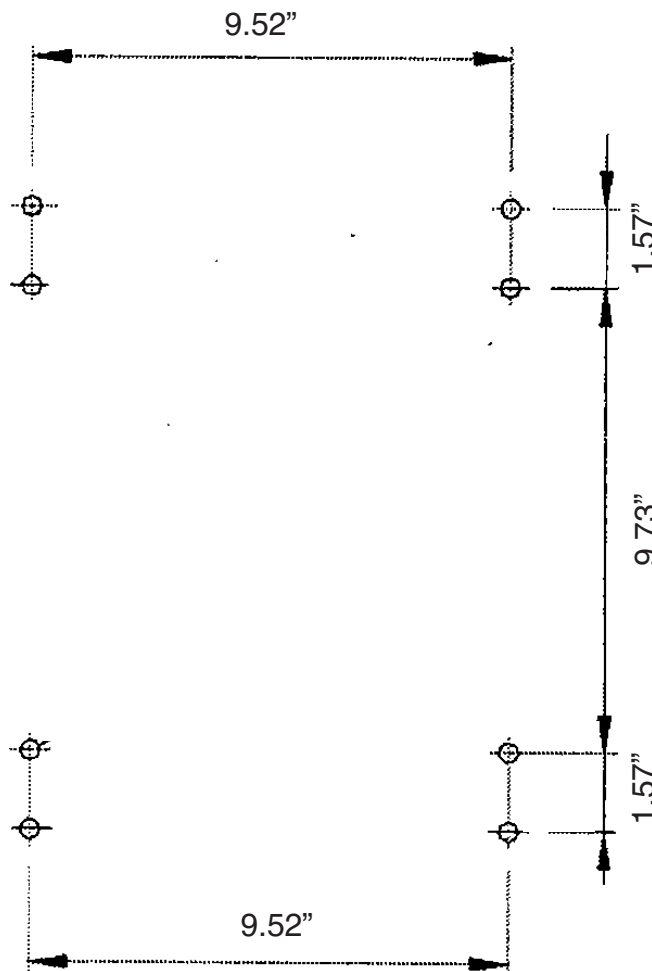

6. Tap the Wall Anchors (33) into the wall using a hammer. They will expand inside the wall when you thread a nut onto them. See Figure 4 below.

**Figure 4**

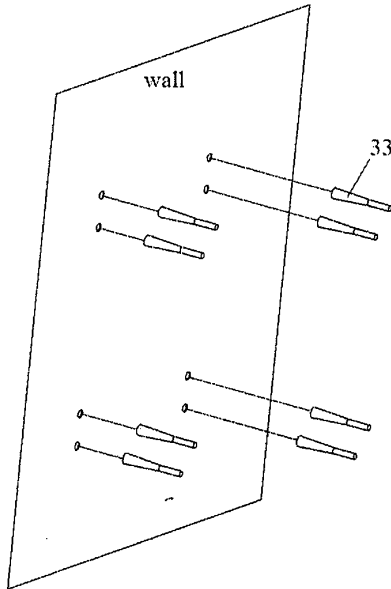

7. Attach the dust reclaimer to the wall using Flat Washers (35), Spring Washers (36) and Hex Nuts (46). See Figure 5 below.

**Figure 5**

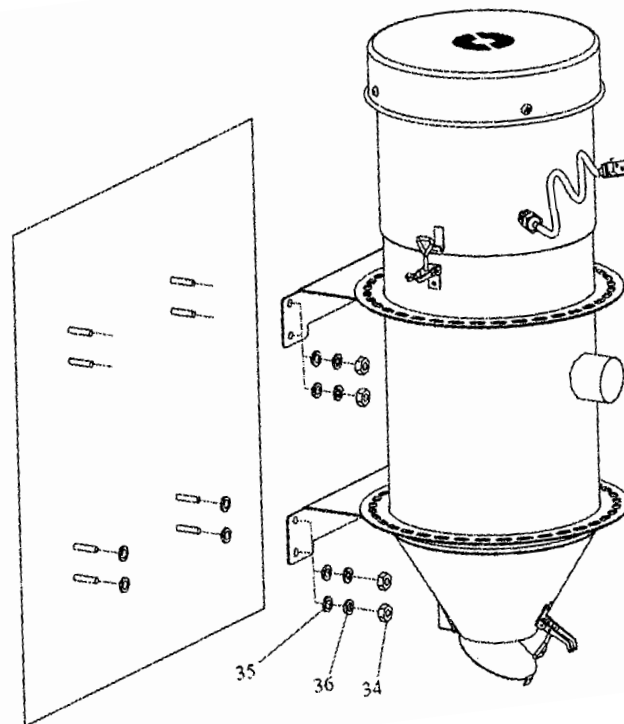

8. After attaching the Dust Reclaimer to the wall, it should look like it does in Figure 6 below.

Figure 6

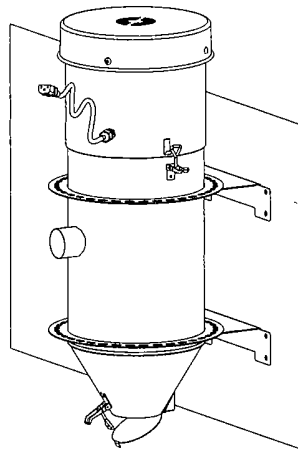

9. Attach the blast cabinet to the Dust Reclaimer as shown in Figure 7, then firmly tighten up the Hose Clamps (15).

Figure 7

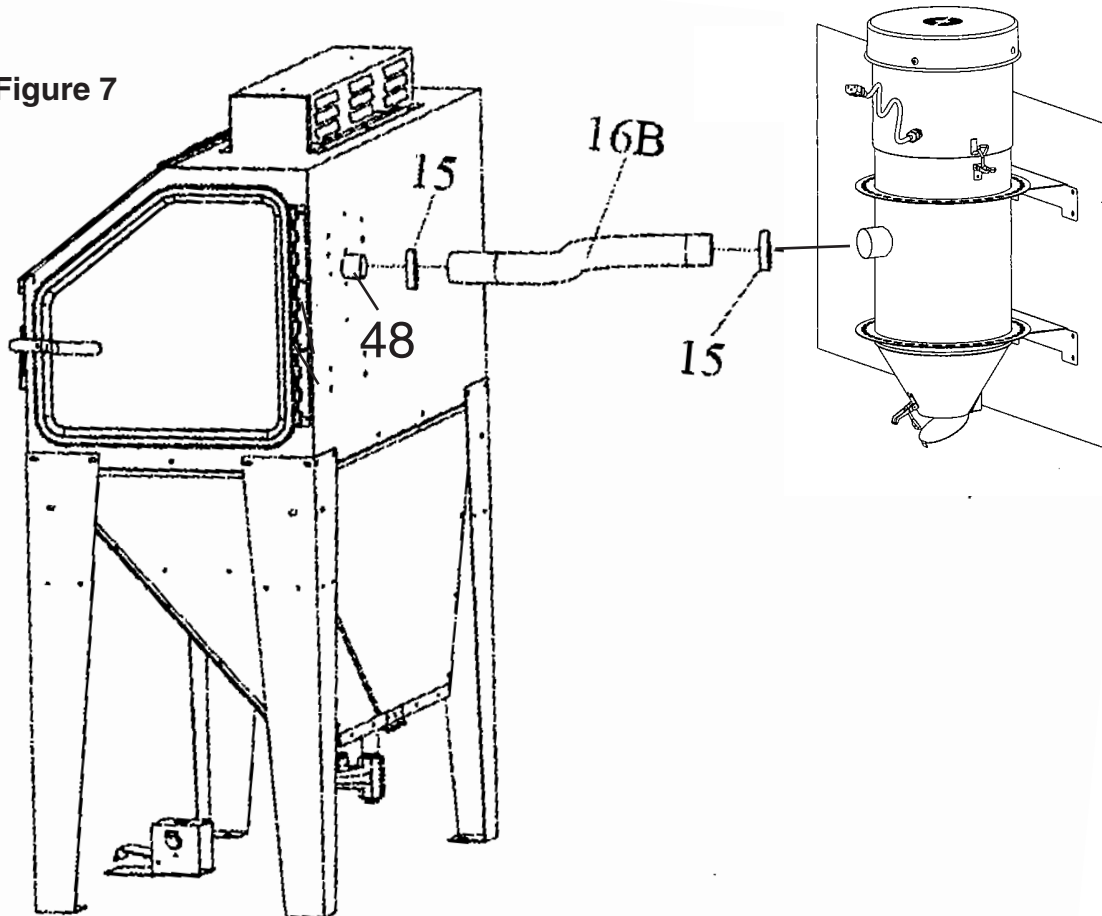

## How To Install The Dust Reclaimer To A Blast Cabinet (SKU # 94274)

1. Open the right side door of the blast cabinet. Remove the four screws on the exhaust board. Take out the Exhaust Board (see to Figure 8).
2. Install the Hose Connector (48) using four Bolts (47) as shown in Figure 9.

**Figure 8**

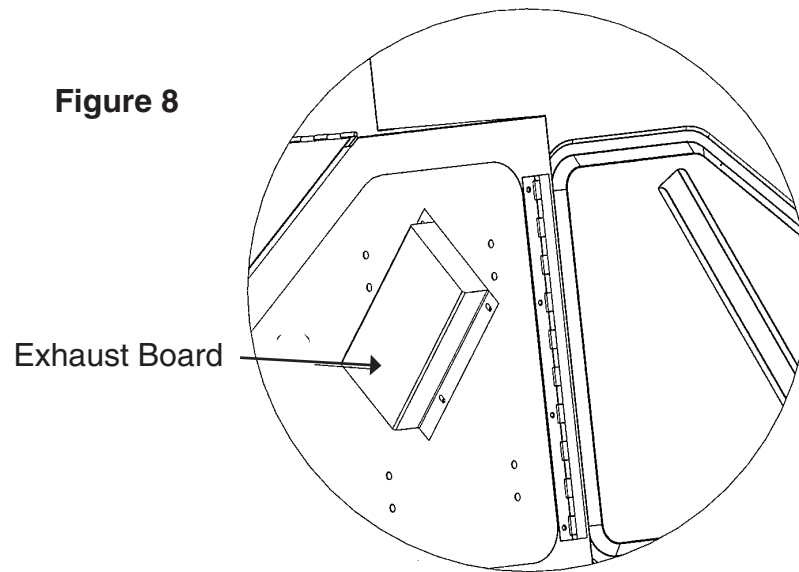

3. Re-install the Exhaust Board as shown in Figure 8

**Figure 9**

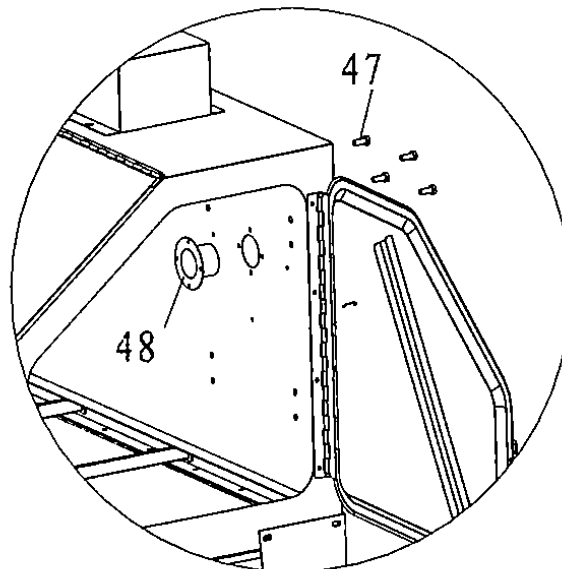

4. Assemble the two Support Brackets (32) to the Dust Reclaimer Housing (22A) using parts 28, 29, 30, and 31. Do not tighten up the Nuts (31) completely at this point. See Figure 10 below.
5. Place the Support Brackets (32) on a flat surface. Adjust the position of the support brackets and the Dust Reclaimer hose nozzle until it looks like it does in Figure 10 below. Make sure the Support Brackets are parallel with the dust collector hose nozzle. After ensuring the support brackets center line is in line with that of the dust collector hose, firmly tighten up the Hex Nuts (31). See Figure 10 Below.

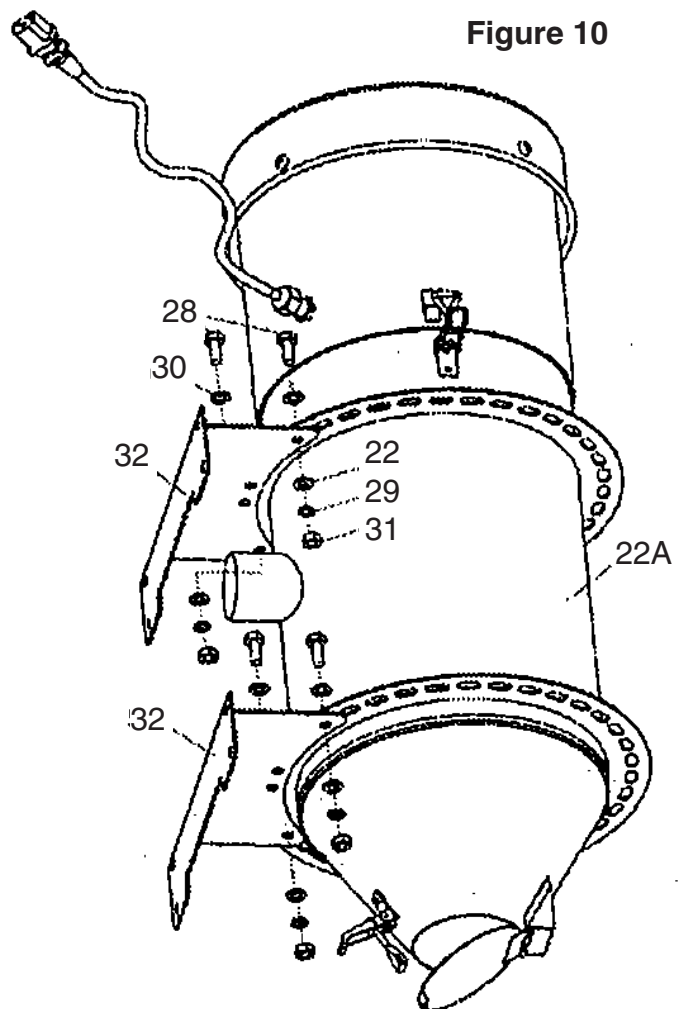

6. Some versions of SKU 94274 Blast Cabinet do not have the eight pre-drilled mounting holes drilled into the back of the Blast Cabinet (holes are needed to mount the Dust Reclaimer Kit). If you have one of those blast cabinets you will need to have the eight mounting holes drilled as described in Step 7 below.
7. Have someone hold the Dust Reclaimer against the back of the cabinet while you attach the short 2" Hose (16A) to the Hose connector (48). Next press the other end of the Hose (16A) over the 2" port of the Dust Reclaimer. Press the Dust Reclaimer all the way up against the back of the Blast Cabinet. Mark the drilling hole locations through the mounting holes of part 32 while it is against the back of the blast cabinet.
8. If you have a newer version of blast cabinet SKU 94275, there will be bolts and nuts already in the holes where the Dust Reclaimer will be attached to the Blast Cabinet. Remove the eight bolts and nuts.
9. Attach the Dust Reclaimer to Blast Cabinet (SKU 94275) using the Bolts (51), Flat Washers (44), Spring Washers (45) and Nuts (46). Parts 45 and 48 attach to the bolts from inside the cabinet. See Figures 11 and 12 below.

**Figure 11**

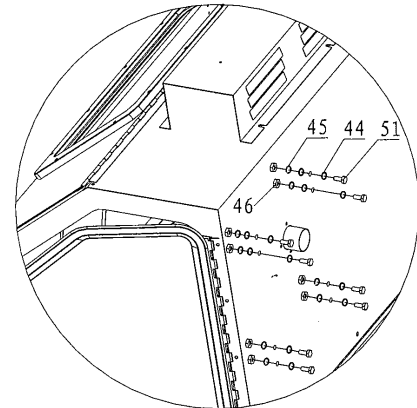
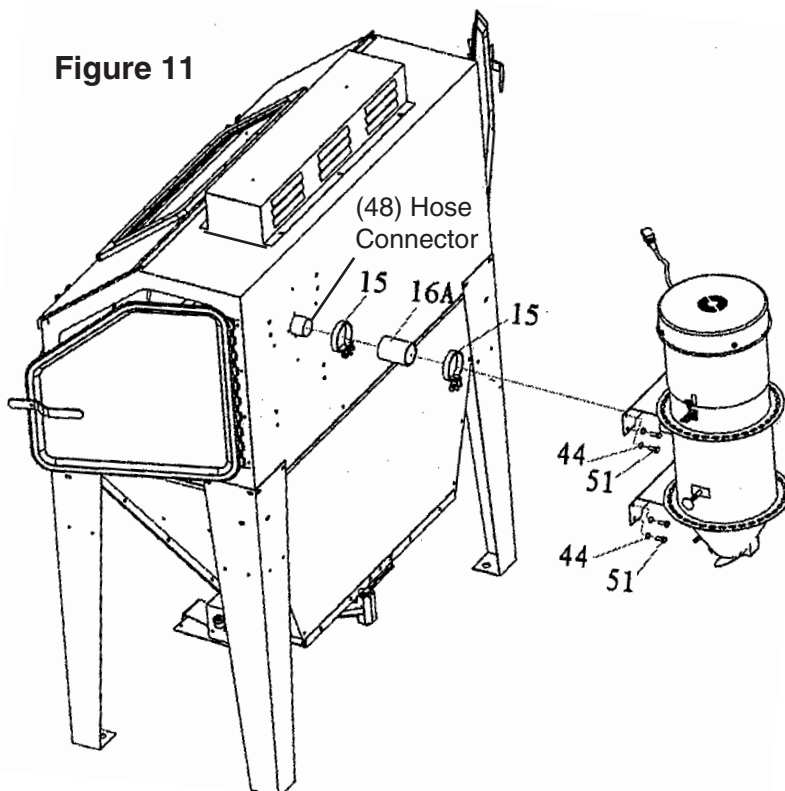

**Figure 12**



## OPERATING INSTRUCTIONS

1. Turn on the Dust Reclaimer using the Power Switch (25). Make sure the Dust Collector Cap (26) is closed and latched. The Dust Reclaimer will immediately activate, drawing airborne particles out of the Blast Cabinet and into the Filter (18) and Dust Housing (22A) of the Dust Reclaimer. Use the Power Switch (25) to turn off the Dust Reclaimer when you are finished using it. (See Assy. Diagram.)

## INSPECTION, MAINTENANCE, AND CLEANING

1.  **WARNING!** Make sure the Power Cord Plug (12) of the Dust Reclaimer is unplugged from its electrical outlet before performing any inspection, maintenance, or cleaning procedures.
2. **Before each use:** Inspect the general condition of the Dust Reclaimer. Check for misalignment or binding of moving parts, cracked or broken parts, damaged electrical wiring, plugged hose or suction port, and any other condition that may affect safe operation. If abnormal noise or vibration occurs, have the problem corrected before further use. **Do not use damaged equipment.**
3. Inadequate Blast Cabinet ventilation will result in reduced cleaning power as well as diminished view of the work in progress. Empty the Dust Reclaimer after every 20 to 30 minutes of Blast Cabinet use (more often in more dusty conditions). (See Assy. Diagram.)
  - A. Make sure the Power Cord Plug (12) of the Dust Reclaimer is unplugged from its electrical outlet. (See Assy. Diagram.)
  - B. Release the Latch (27), and open the Dust Collector Cap (26) at the bottom of the Dust Reclaimer. Then, allow the dust and debris to pour out into a proper waste container. (See Assy. Diagram.)
  - C. Push in and out on the Pull Rod (24) several times to help shake out any remaining dust and debris from the Dust Reclaimer. (See Assy. Diagram.)
  - D. Close the Dust Collector Cap (26), and refasten the Latch (27).  
**(See Assy. Diagram.)**
4. When necessary: Remove the Filter (18) and use compressed air to blow out the dust and debris from the Filter to keep the Dust Reclaimer working efficiently. Replace the Filter as needed. (See Assy. Diagram.)

A. Make sure the Power Cord Plug (12) of the Dust Reclaimer is unplugged from its electrical outlet. (See Assy. Diagram.)

B. Remove the Radiating Guard (1) from the top of the Dust Reclaimer. (See Assy. Diagram.)

C. Remove the Filter (18), and clean with compressed air. (See Assy. Diagram.)

D. Replace the Filter (18) and Radiating Guard (1). (See Assy. Diagram.)

### TROUBLESHOOTING

| Problem                                   | Possible Solution   |
|---|---|
| Dust Reclaimer does not turn on.          | <ol style="list-style-type: none"> <li>1. Make sure the Power Switch (25) on is in its "ON" position.</li> <li>2. Make sure the Power Cord Plug of the Dust Reclaimer is properly connected to a working, 115 volt, grounded, electrical outlet.</li> <li>3. Have a qualified service technician check out the Dust Reclaimer and Blast Cabinet.</li> </ol>   |
| Poor visibility within the Blast Cabinet. | <ol style="list-style-type: none"> <li>1. Check to make sure Dust Reclaimer is on.</li> <li>2. Dust Reclaimer is filled. Empty and clean out Dust Reclaimer.</li> <li>3. Filter in Dust Reclaimer needs to be cleaned or replaced.</li> <li>4. Check to make sure there is no clogging in the Wire Mesh Reinforced Hose.</li> <li>5. Have a qualified service technician check out the Dust Reclaimer and Blast Cabinet.</li> </ol> |

# ASSEMBLY DIAGRAM

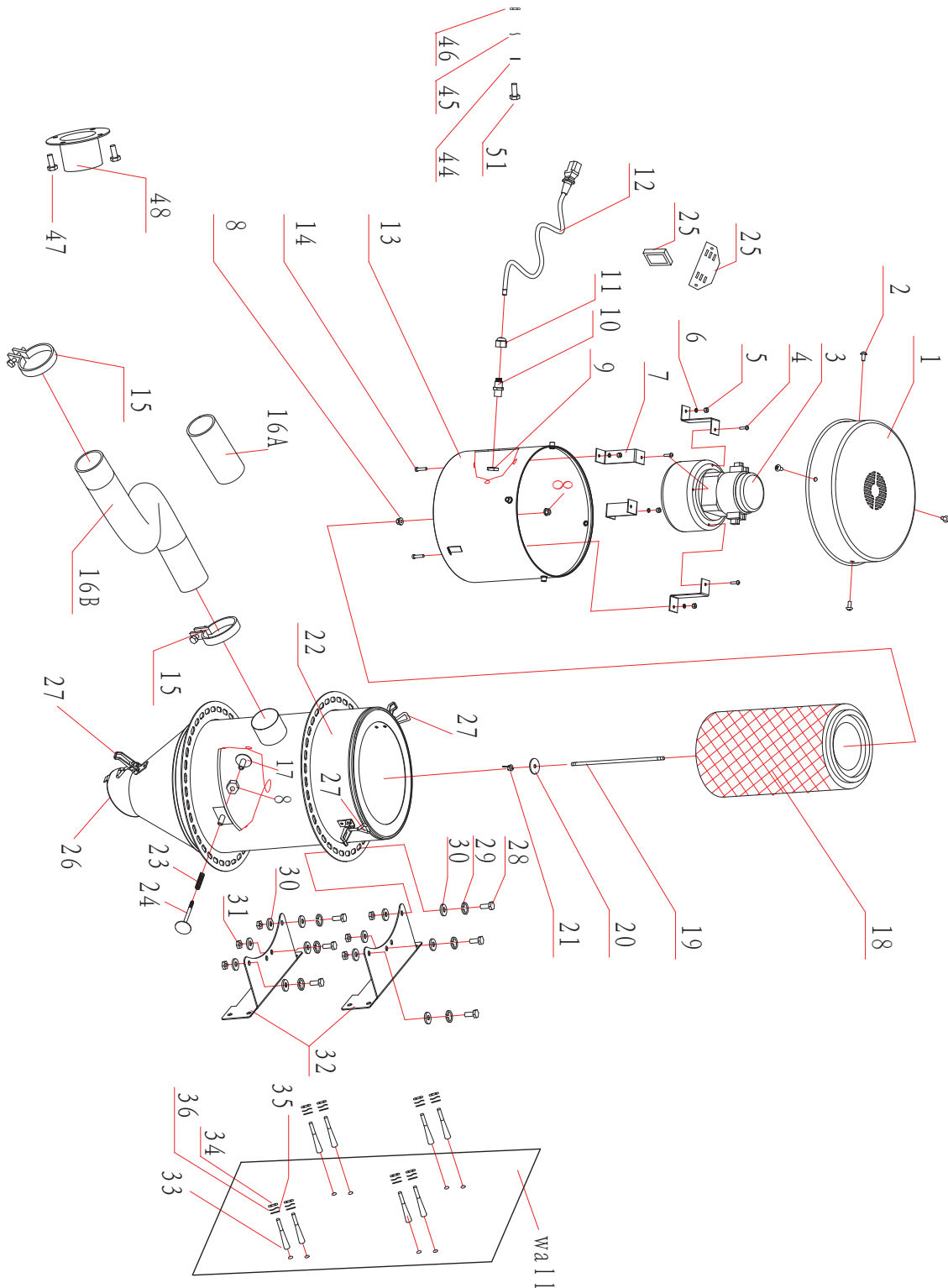

**NOTE:** Some parts are listed and shown for illustration purposes only, and are not available individually as replacement parts.

## PARTS LIST

| Part# | Description                | Qty | Part# | Description        | Qty |
|-------|----------------------------|-----|-------|--------------------|-----|
| 1     | Radiating Guard            | 1   | 22A   | Dust Housing       | 1   |
| 2     | Screw (M6x12)              | 4   | 23    | Spring             | 1   |
| 3     | Motor                      | 1   | 24    | Pull Rod           | 1   |
| 4     | Tapping Screw (M5x15)      | 4   | 25    | Power Switch       | 1   |
| 5     | Nut (M5)                   | 4   | 26    | Dust Collector Cap | 1   |
| 6     | Spring Washer              | 4   | 27    | Latch              | 3   |
| 7     | Motor Fixed Plate          | 4   | 28    | Hex Screw (M8x20)  | 6   |
| 8     | Hex Nut (M6)               | 3   | 29    | Spring Washer      | 6   |
| 9     | Hex Nut                    | 1   | 30    | Flat Washer        | 12  |
| 10    | Double Head Retaining Bolt | 1   | 31    | Hex Nut (M8)       | 6   |
| 11    | Retaining Nut              | 1   | 32    | Support Brackets   | 2   |
| 12    | Power Cord/Plug            | 1   | 33    | Wall Anchor        | 8   |
| 13    | Protective Guard           | 1   | 34    | Hex Nut            | 8   |
| 14    | Bolt (M5x20)               | 4   | 35    | Flat Washer        | 8   |
| 15    | 2" Hose Clamp              | 2   | 36    | Spring Washer      | 8   |
| 16A   | Wire Mesh Reinforced Hose  | 1   | 44    | Flat Washer        | 8   |
| 16B   | Wire Mesh Reinforced Hose  | 1   | 45    | Spring Washer      | 8   |
| 17    | Mounting Base              | 1   | 46    | Hex Nut M8         | 8   |
| 18    | Filter                     | 1   | 47    | M5 x12 Bolt        | 4   |
| 19    | Double Head Screw Rod      | 1   | 48    | Hose Connector     | 1   |
| 20    | Flat Washer                | 1   | 51    | M8 x20 Hex Bolt    | 8   |
| 21    | Wing Nut (M6)              | 1   |       |                    |     |

### **PLEASE READ THE FOLLOWING CAREFULLY**

THE MANUFACTURER AND/OR DISTRIBUTOR HAS PROVIDED THE PARTS LIST AND ASSEMBLY DIAGRAM IN THIS MANUAL AS A REFERENCE TOOL ONLY. NEITHER THE MANUFACTURER OR DISTRIBUTOR MAKES ANY REPRESENTATION OR WARRANTY OF ANY KIND TO THE BUYER THAT HE OR SHE IS QUALIFIED TO MAKE ANY REPAIRS TO THE PRODUCT, OR THAT HE OR SHE IS QUALIFIED TO REPLACE ANY PARTS OF THE PRODUCT. IN FACT, THE MANUFACTURER AND/OR DISTRIBUTOR EXPRESSLY STATES THAT ALL REPAIRS AND PARTS REPLACEMENTS SHOULD BE UNDERTAKEN BY CERTIFIED AND LICENSED TECHNICIANS, AND NOT BY THE BUYER. THE BUYER ASSUMES ALL RISK AND LIABILITY ARISING OUT OF HIS OR HER REPAIRS TO THE ORIGINAL PRODUCT OR REPLACEMENT PARTS THERETO, OR ARISING OUT OF HIS OR HER INSTALLATION OF REPLACEMENT PARTS THERETO.

---

## LIMITED 1 YEAR / 90 DAY WARRANTY

---

Harbor Freight Tools Co. makes every effort to assure that its products meet high quality and durability standards, and warrants to the original purchaser that for a period of one year from date of purchase that the tank is free of defects in materials and workmanship (90 days if used by a professional contractor or if used as rental equipment). Harbor Freight Tools also warrants to the original purchaser, for a period of ninety days from date of purchase, that all other parts and components of the product are free from defects in materials and workmanship. This warranty does not apply to damage due directly or indirectly to misuse, abuse, negligence or accidents, repairs or alterations outside our facilities, normal wear and tear, or to lack of maintenance. We shall in no event be liable for death, injuries to persons or property, or for incidental, contingent, special or consequential damages arising from the use of our product. Some states do not allow the exclusion or limitation of incidental or consequential damages, so the above limitation of exclusion may not apply to you. THIS WARRANTY IS EXPRESSLY IN LIEU OF ALL OTHER WARRANTIES, EXPRESS OR IMPLIED, INCLUDING THE WARRANTIES OF MERCHANTABILITY AND FITNESS.

To take advantage of this warranty, the product or part must be returned to us with transportation charges prepaid. Proof of purchase date and an explanation of the complaint must accompany the merchandise. If our inspection verifies the defect, we will either repair or replace the product at our election or we may elect to refund the purchase price if we cannot readily and quickly provide you with a replacement. We will return repaired products at our expense, but if we determine there is no defect, or that the defect resulted from causes not within the scope of our warranty, then you must bear the cost of returning the product.

This warranty gives you specific legal rights and you may also have other rights which vary from state to state.

3491 Mission Oaks Blvd. • PO Box 6009 • Camarillo, CA 93011 • (800) 444-3353