

INSTRUCTION BOOKLET

ZANUSSI

DISHWASHER
DW 911

CONTENTS

Warnings	page	3
Installation	page	4
Positioning, levelling, adjusting the worktop	page	4
Installing and securing the machine under a kitchen unit	page	4
Water outlet connection, water supply connections	page	5
Electrical connections	page	6
Use	page	7
Control panel	page	7
The water softener, filling with salt	page	8
Use of rinse aid, use of detergent	page	9
Loading the machine, use of the lower basket	page	10
Use of the upper basket, adjusting the height of the upper basket	page	11
Helpful hints	page	12
Washing programmes	page	13
Operating sequence	page	14
Maintenance and cleaning	page	15
Cleaning the central filters, cleaning the large filter, internal and external cleaning	page	15
Prolonged periods of Non-Operation	page	15
Something not working, Service and Spare Parts	page	16
Peace of mind for twelve months	page	17

TECHNICAL SPECIFICATIONS

DIMENSIONS	Width	60 cm
	Height with worktop	85 cm
	Height without worktop	82 cm
	Max depth	60 cm
	Max depth with door open	120 cm
<hr/>		
ELECTRICAL CONNECTION	Voltage	220 - 240 V/50Hz
MOTOR RATING DURING WASHING		200 W
POWER OF HEATING ELEMENT		2570 W
OVERALL POWER		2770 W
<hr/>		
WATER SUPPLY PRESSURE	minimum	5 N/cm ²
	maximum	80 N/cm ²
<hr/>		
CAPACITY (STANDARD IEC PLACE SETTINGS)		12
<hr/>		
CONSUMPTION:	Water	27 lt
	Electricity	1.6 kW/h

CE This appliance complies with the following E.E.C. Directives:
- 73/23 of 19.2.73 (Low Voltage Directive) and subsequent modifications;
- 89/336 of 3.5.89 (Electromagnetic Compatibility Directive) and subsequent modifications.

WARNINGS

It is most important that this instruction book should be retained with the appliance for future reference. Should the appliance be sold or transferred to another owner, or should you move house and leave the appliance, always ensure that the book is left with the appliance in order that the new owner can get to know the functioning of the appliance and the relevant warnings.

These warnings are provided in the interest of safety. You **MUST** read them carefully before installing or using the appliance.

Installation

- This appliance is heavy. Care should be taken when moving it.
- It is dangerous to alter the specifications or attempt to modify this product in any way.
- Care must be taken to ensure that the appliance does not stand on the electrical supply cable.
- Any electrical work required to install this appliance should be carried out by a qualified electrician or competent person.
- Any plumbing work required to install this appliances should be carried out by a qualified plumber or competent person.
- Built-in dishwashers only: The appliance must be secured to the underside of the worktop using the brackets provided. Failure to do this could result in an unstable appliance which may cause damage or injury.

Child Safety

- This appliance is designed to be operated by adults. Children should not be allowed to tamper with the controls or play with the product.

During Use

- Zanussi dishwashers are designed to be used for washing normal household utensils. Items that are contaminated by petrol, paint, steel or iron debris, corrosive, acidic or alkaline chemicals are not to be washed in a dishwasher.
- Under no circumstances should you open the door whilst the appliance is in operation. Always turn off the appliance before opening the door.
- When finishing loading or unloading close the door, as an open door can be a hazard.
- Unplug the appliance and turn off the water after use.
- If your house is fitted with a water softening unit or if you live in a soft water area, it is not necessary to add salt to the water softening unit in the dishwasher.

- Do not put in your dishwasher; cutlery with wooden or horn handles or glued parts, bronze cutlery, saucepans with wooden handles, unless they are sold as dishwasher proof, aluminium ware, crystal ware, leaded glass, plastic articles unless sold as dishwasher proof, antique china or fine decorated china unless sold as dishwasher proof. Always check with the manufacturer of the item if in any doubt.
- A chemical reaction can occur between silver cutlery and stainless steel cutlery. As a precaution, do not wash together.
- Care should be taken when cleaning the bottom door seal and hinge area as any exposed metal edges may cut if care is not taken.
- This product should be serviced by an authorised Zanussi engineer, and only genuine Zanussi spare parts should be used.
- Under no circumstances should you attempt to repair the machine yourself. Repairs carried out by inexperienced persons may cause injury or serious malfunctioning. Contact your local Zanussi Service Force Centre. Always insist on genuine Zanussi Spare Parts.

Conservation

In the interests of the Environment:

When disposing of your old appliance:

- Help to keep your country tidy - use authorised disposal sites for your old appliances.
- The materials used on this appliance marked with the symbol  are recyclable.
- Check with your local Council or Environmental Health Office to see if there are facilities in your area for re-cycling this appliance.
- If you are discarding an old appliance that has a lock or catch on the door, you must ensure that it is made unusable to prevent young children being trapped inside.

INSTALLATION

Remove all packaging before positioning the machine.

Positioning

If possible, position the machine next to a water tap and a drain.

The dishwasher features fill and drain hoses which can be turned either to the left or the right to suit the installation .

Levelling

Good levelling is essential for correct closure and sealing of the door.

When the appliance is correctly levelled, the door will not catch on the spacers on either side of the cabinet.

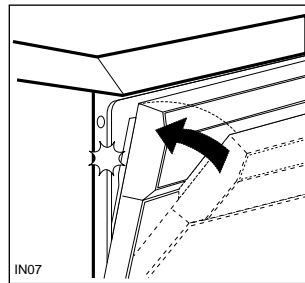
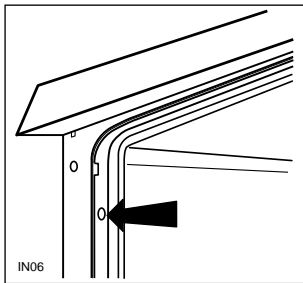

If the door does not close correctly, loosen or tighten the adjustable support feet, until the machine is perfectly level.

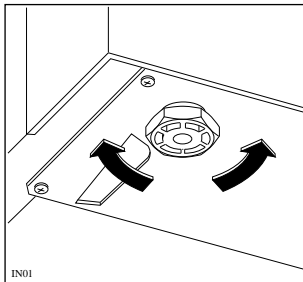

Adjusting the Worktop

You can move the worktop forward or backward by 25 mm in order to align the machine with other kitchen units.

Simply unscrew the two front retaining screws, move the top to the required position and then retighten the screws.

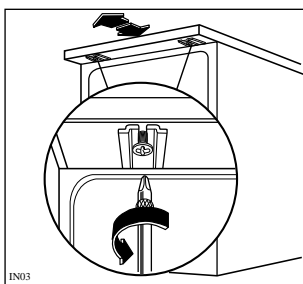

Installing and Securing the Machine Under a Kitchen Unit (Sink-Worktop Unit)

By removing the machine's worktop, you can install it under a close fitting sink unit or a pre-existing top, if the dimensions of the recess correspond to those shown in the picture.

Then proceed as follows:

Remove the machine worktop by unscrewing the two rear retaining screws, pull from the front and slide out the rear slots, lifting the worktop.

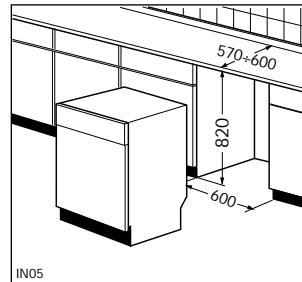

Insert the machine after adjusting the height and levelling with the adjustable feet. When inserting the machine, ensure that the water inlet and drain hoses are not kinked or squashed.

Caution

Once the machine has been installed, ensure that it is easily accessible for servicing.

Water Outlet Connection

The end of the drain hose can be connected as follows:

to the sink outlet siphon, securing it if necessary with a clip;

to a wall outlet provided with vent-hole, minimum internal diameter 4 cm;

hooked over the edge of the sink using the special curved plastic guide provided.

The waste connection must be at a height of between 30 cm (minimum) and 100 cm (maximum) from the floor.

It makes no difference which way the drain hose faces, either to the right or left of the dishwasher.

Avoid bending or kinking the hose as this could prevent or slow down the discharge of water.

If you use a drain hose extension it must be no longer than 2 metres and its internal diameter must be no smaller than the diameter of the hose provided.

Likewise the internal diameter of the couplings used for connection to the waste outlet must be no smaller than the diameter of the drain hose.

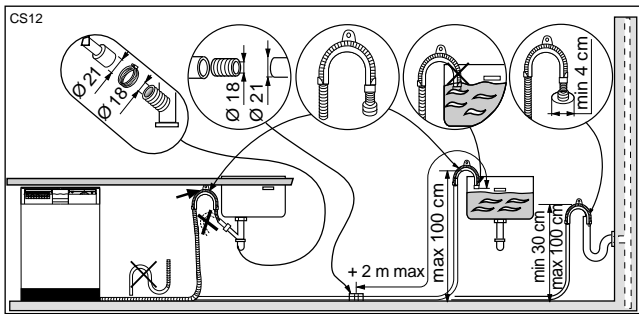

Water Supply Connections

This dishwasher must be permanently plumbed into a cold water supply.

The water pressure must be within the limits given in the technical specifications, as it will not function correctly if pressure is outside these specifications.

Your local Water Authority will advise you on the average mains pressure in your area.

Where the water is supplied via a cold water storage cistern, you can work out the pressure yourself by measuring the vertical distance (or «head») between the machine's inlet hose and the outlet from the cold water storage cistern, allowing roughly 1 psi for every 2 feet.

For making the connection itself, the coupling nut fitted to the machine's supply hose is designed to screw onto either a 3/4 inch gas thread spout, or to a purpose made quick-coupling tap such as the Press Block.

To make this easier, the hose itself may be turned to the left or the right. In either case, be sure to incorporate the strainer (A) supplied with the machine into the joint. See picture.

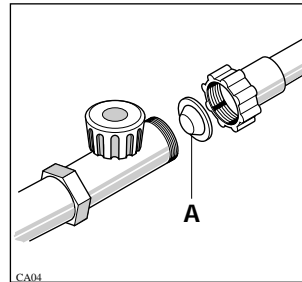

Caution: the retaining ring must be correctly fitted to avoid water leaks.

Note: the end of the hose connected to the machine can be positioned as required, by simply slackening the retaining ring.

Re-tighten the ring securely to avoid water leaks. Avoid bends or kinks in the hose which could prevent or slow down the flow of water.

If the machine is connected to new pipes or pipes which have not been used for a long time, you are advised to run the water for a few minutes before connecting the inlet hose. This will prevent deposits of sand or rust clogging the inlet hose filter.

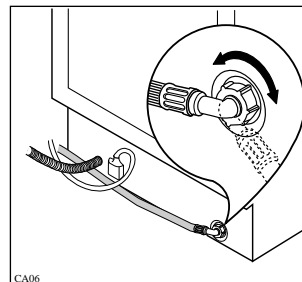

Electrical connection

Any electrical work required to install this appliance should be carried out by a qualified electrician or competent person.

WARNING: THIS APPLIANCE MUST BE EARTHED.

The manufacturer declines any liability should this safety measure not be observed.

Before switching on, make sure the electricity supply voltage is the same as that indicated on the appliance rating plate.

The appliance is supplied with a 13amp plug fitted.

In the event of having to change the fuse in the plug supplied, a 13amp ASTA approved (BS1362) fuse must be used.

Should the plug need to be replaced for any reason. The wires in the mains lead are coloured in accordance with the following code:

Green and Yellow : Earth

Blue : Neutral

Brown : Live

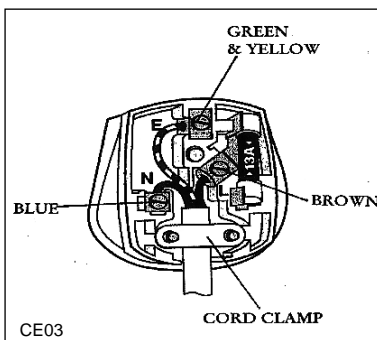

The wire coloured green and yellow must be connected to the terminal marked with the letter "E" or by the earth symbol \oplus or coloured green and yellow.

The wire coloured blue must be connected to the terminal marked "N" or coloured black.

The wire coloured brown must be connected to the terminal marked "L" or coloured red.

Upon completion there must be no cut, or stray strands of wire present and the cord clamp must be secure over the outer sheath.

WARNING: A cut off plug inserted into a 13amp socket is a serious safety (shock) hazard.

Ensure that the cut off plug is disposed of safely.

Permanent connection

In the case of a permanent connection it is necessary that you install a double pole switch between the appliance and the electricity supply (mains), with a minimum gap of 3mm between the switch contacts and a type suitable for the required load in compliance with the current electrical regulations.

The switch must not break the yellow and green earth cable at any point.

Control panel

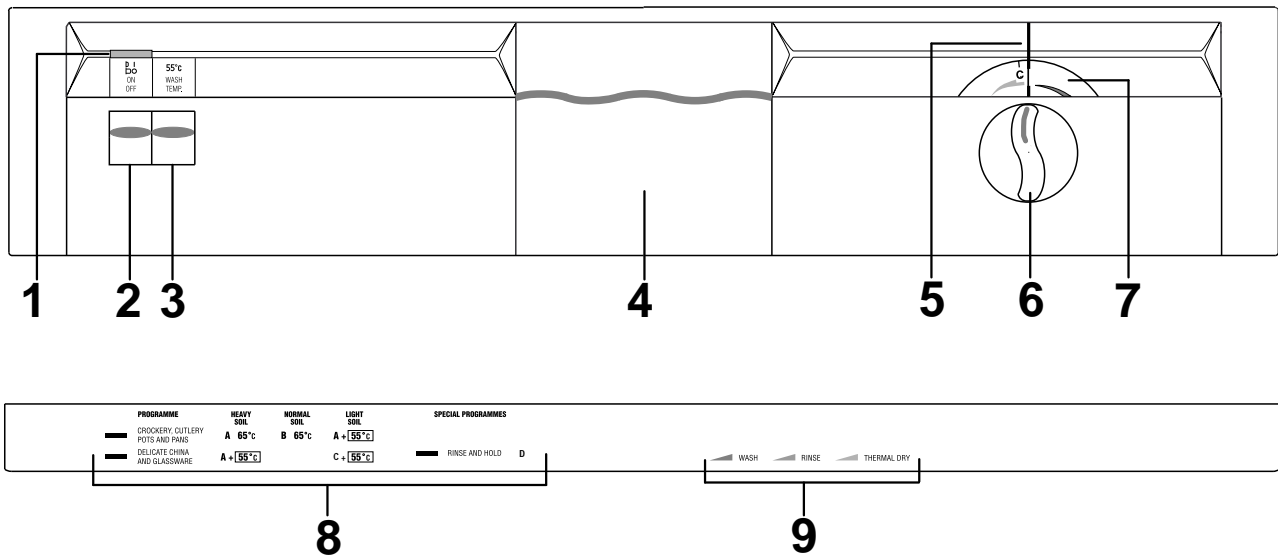

1. Indicator light

This comes on when the ON/OFF button is depressed, indicating that the machine is on.

2. ON/OFF button

ON

By depressing this button the machine starts operating, at the same time, the pilot light (1) comes on.

OFF

When the washing programme has finished, the machine stops automatically and the pilot light remains on. To switch the pilot light (1) off or to stop the machine at any time, press the same button again.

3. Wash temperature pushbutton «55°C»

If this button is depressed the water temperature is reduced.

When depressed the water will heat up to 55°C.

If the button is not depressed the water will heat up to 65°C.

You must depress this button when selecting “Economy programmes”.

me.

4. Door handle

To open the door press the catch in the top of the recess and pull the door towards you at the same time.

5. Programme marker

6. Programme selector dial

To select a programme, turn the “programme selector dial” clockwise, making sure that the programme letter of the programme you wish to select corresponds with the “programme marker” (5).

7. Wash programme phase indicator

During the washing programme the “programme selector dial” turns, indicating the functions being performed (see “phase indicator guide”).

When the programme has finished, the marker on the programme selector dial will correspond with the programme marker (5).

8. Programme guide

This is a summary of the “washing programmes chart” to help you to select the correct program

9. Phase indicator guide

The Water Softener

Water contains varying amounts of lime and mineral salts depending on the area in which you live: these are deposited on the dishes leaving white marks.

The higher the content of these salts, the harder your water will be. The «hardness» level is measured on 2 equivalent scales: French Degrees or Clarke Degrees.

Contact your local Water Authority to find the exact water hardness level for your area.

The dishwasher is equipped with a softener which uses special dishwasher salt to provide lime-free (softened) water. The softener can treat water hardness up to 90 French degrees via 5 adjustment levels.

Find on the table below the level corresponding to the

Level	French Degrees (°TH)	Clarke Degrees (°dH)	Use of salt
1	0-18	0-10	** NO
*2	15-39	11-27	YES
3	40-50	28-35	YES
4	51-70	36-49	YES
5	71-90	50-63	YES

hardness of your water and the required adjustments:

*The water softener is factory set at level 2 as this suits most users.

** If you use phosphate free detergents containing enzymes, use salt starting from 6 Clarke degrees (7 French degrees).

Level 1

If your water is level 1 it is already soft and therefore there is no need to use salt.

Levels 3 and 5 (water softener adjustment)

If your water is level 3 or 5, proceed as follows:

Slide out the lower basket and unscrew the cap of the salt container; turn the two-position selector anticlockwise from position – to position + with the aid of a

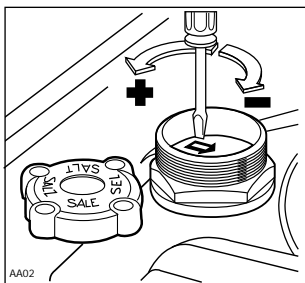

knife or a screwdriver.

Levels 4 and 5 (adjustment on the machine)

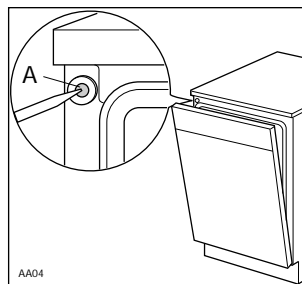

If your water level is 4 or 5, open the door and drill membrane (A) on the upper left-hand corner of the machine.

Filling with Salt

Only use salt designed specifically for use in dishwashers. To fill with salt, unscrew the cap of the salt container.

Pour about one litre of water inside the container, or until it is full (this is necessary only before filling with salt for the first time).

Then, using the funnel provided, pour in the salt until the container is full (approx. 1,5 - 1,8 kg). Do not worry if water over flows from the unit when filling with salt this is quite normal.

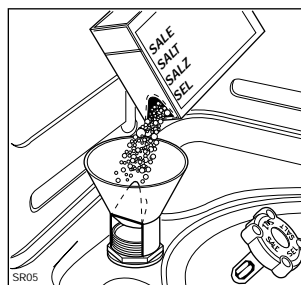

Replace the cap making sure that there is no trace of salt on the screw thread or on the gasket.

Screw the cap on tightly.

If you have inadvertently spilled salt select a wash programme immediately after.

All that is then required is to periodically top up the container with salt. You are reminded of this by a **green** refill indicator on the cap of the salt container. When the green indicator disappears, the water softener needs refilling with salt.

The salt container always has some water inside which will normally overflow when refilling with salt.

Caution: Only fill with salt just before starting one of the complete washing programmes (not the Rinse and Hold programme). This will prevent any grains of salt or salty water, which may have been spilled, remaining on the bottom of the machine for any period of time. This could cause corrosion.

Rinse Aid

The use of this liquid ensures thorough rinsing, spot and streak free drying, making the water run quickly off the dishes for sparkling results. It is automatically added during the hot rinse. The dispenser, which is positioned inside the door, holds about 110 ml of rinse aid, which is sufficient for 16-40 dishwashing programmes, depending upon the dosage setting.

Filling with Rinse Aid

Open the container by turning the lid (A) anticlockwise. Add rinse aid until the container is completely full (approx. 110 ml). The indicator (B) will be completely dark.

Top up with rinse aid when the indicator (B) becomes clear.

Remember to CLOSE the lid after every refill.

Caution

Clean up any rinse aid spilt during filling with an absorbent cloth to avoid excess foaming during the next wash.

Adjusting the Dose

According to the finish and drying results obtained, adjust the dose of rinse aid by means of the 6 position selector (C) (position 1 - minimum dose, position 6 maximum dose). (Start from position 3). Gradually increase the dose if there are drops of water or lime spots on the dishes after washing. Reduce it if there are sticky whitish streaks on the dishes.

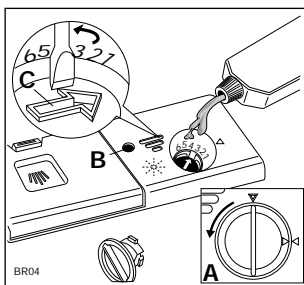

Caution: Do not put liquid detergent into the rinse aid compartment

Use of Detergent

Before starting any of the dishwashing programmes, except for the rinse and hold programme, load the detergent in the dispenser.

! Only use detergents specifically designed for use in dishwasher.

We recommend the use of Finish detergents which are available in the following options.

Finish Double Action Tablets. Each tablet has the exact amount of detergent required, simply place in the dispenser.

Finish Powder recommended for every day use.

Finish Liquid Gel ideal for every day use. As the gel is extra gentle it is recommended for fine bone china.

To open the dispenser lid, pull the catch (D). This will open it.

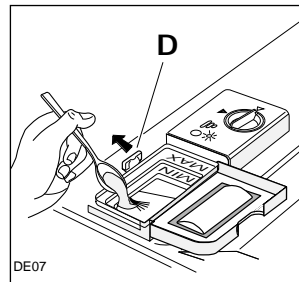

To help you to correctly dose the right amount of detergent, inside the container there are two reference marks:

- MIN = 15 ml
- MAX = 30 ml

The amount of detergent to be used varies depending on how soiled the dishes are and the type of dishes being washed. We recommend the amounts shown in the programme chart on the next pages.

After filling the dispenser with detergent, close the lid.

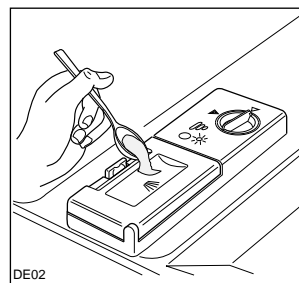

The programme with pre-wash requires a small extra amount of detergent of approximately 5g to be poured over the lid of the dispenser, as shown on the picture.

At the end of any washing programme the lid is always open, ready for the next wash.

Since not all detergents are the same, you should also consult the instructions on the packet.

Remember that insufficient quantities of detergent will produce poor washing results whereas an excessive amount of detergent does not improve washing results and is also wasteful.

Using no more than the correct amount of detergent also contributes to reducing pollution.

Phosphate free detergents with enzymes

These new compact powders are generally phosphate-free. As phosphates have water softening properties, we suggest you add salt to the salt container even if the hardness of your water is as low as 6 Clarke degrees. This will avoid lime deposits on crockery and the inner tub.

Loading your Machine

Before placing dishes in the machine, remove any scraps of food from the plates (small bones, toothpicks, fish bones, scraps of meat and vegetables, fruit skins etc.) to avoid clogging the filters and consequently reducing performance.

Open the door and slide out the baskets to load the dishes.

Use of the Lower Basket

The lower basket is designed to take saucepans, lids, plates (up to 27 cm in diameter), salad bowls, cutlery etc.

Serving dishes and large lids should be arranged around the edge of the basket, ensuring that the upper spray arm can turn freely.

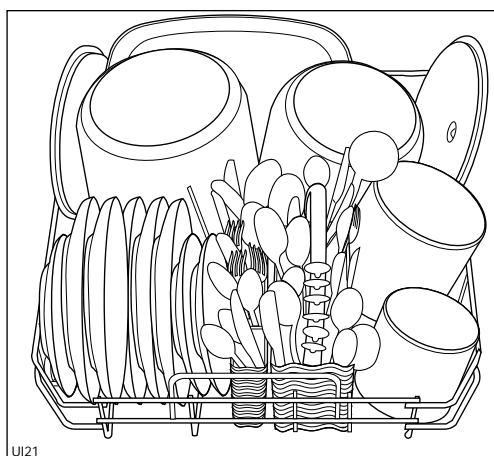
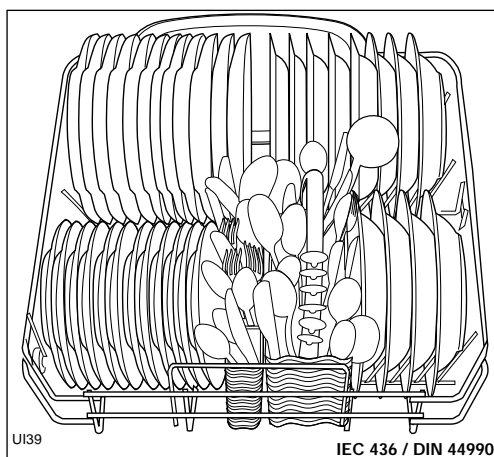

Cutlery should be placed in the removable cutlery basket with the handles facing downwards. If the handles protrude from the bottom of the basket, obstructing the lower spray arm, load the cutlery with the handles facing upward.

Mix spoons with the other cutlery to prevent them sticking together.

Teaspoons may be loaded into the special slots provided in the cutlery basket handle.



Long bladed knives stored in an upright position are a potential hazard.

Long and/or sharp items of cutlery such as carving knives must be positioned horizontally in the upper basket.



Take care when loading or unloading sharp items such as knives.

The cutlery basket is in two parts which can be separated to give greater loading flexibility. To separate the two parts, slide them horizontally in opposite directions and pull them apart. To reassemble, reverse the procedure.

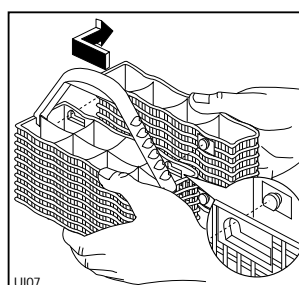

The two rear rows of prongs on the lower basket can be easily lowered to allow you to load pots, pans and bowls.

To lower the prongs:

slightly pull them upward and let them drop down (see picture); to bring them back to the standing position, just pull them up again.

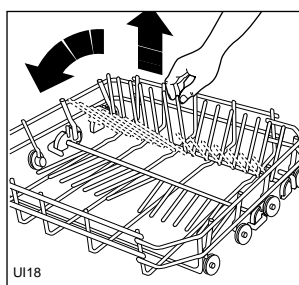

After loading your machine always close the door, as an open door can be a hazard.

Use of the Upper Basket

The upper basket is designed for plates (dessert plates, saucers, dinner plates up to 24 cm in diameter), salad bowls, cups and glasses; these should be arranged as shown in the pictures. Glasses with long stems can be placed upside-down in the raised cup-racks.

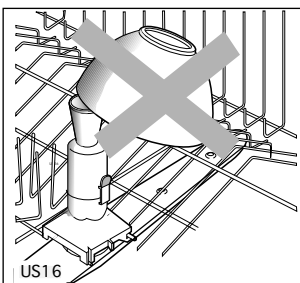
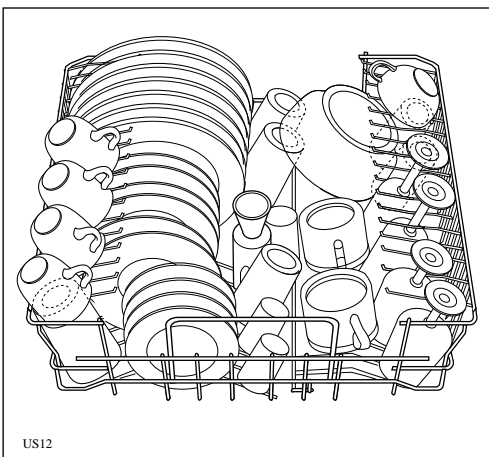
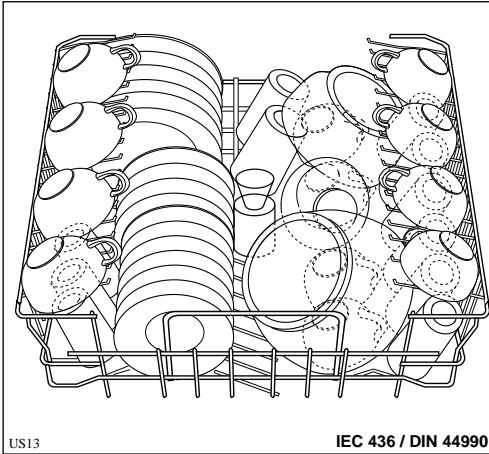

Caution

When loading the dishes, ensure that you do not cover the water inlet funnel in the middle of the upper basket.

Before closing the door, ensure that the spray arms can rotate freely.

Adjusting the Height of the Upper Basket

If washing very large plates (over 27 cm and up to 31 cm in diameter) you can load them in the lower basket after moving the upper basket to the higher position as follows:

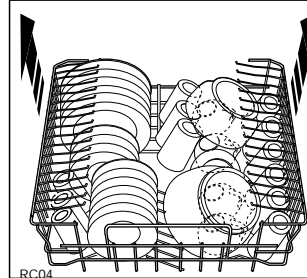

- pull out the basket;
- grasp it on the two sides and pull it upwards until the mechanism is engaged and the basket is stable.

When the top basket is in the higher position it will only take plates up to 20 cm in diameter and you will not be able to use the raised cup-racks.

To put the basket back in the lower position, grasp the two sides, pull upwards again, then allow the basket to drop back down slowly, keeping hold of it.

Warning: never lift or lower the basket on one side only.



After loading your machine always close the door, as an open door can be a hazard.

HELPFUL HINTS

To save energy

Do not prewash dishes under running water.

Place dishes in the machine immediately after every meal and wait until the dishwasher is full before washing.

If necessary run the Rinse and Hold programme (see Programme Chart on the following pages), so that any food scraps do not become caked on the dishes while you are waiting to run the complete wash programme. Select an economic programme when the baskets are not very full and/or when the dishes are not very soiled, following the instructions given in the «Washing programmes» chart.

For best washing results:

Before loading, remove all scraps of food and soak very heavily soiled pots and pans.

Always arrange saucepans, cups and glasses etc. up side-down.

Tilt items with convex or concave surfaces so that the water drains off easily.

Avoid contact between the dishes as far as possible; correct arrangement of the items will give better washing results.

Light items (plastic bowls etc.) should be loaded in the upper basket and arranged so that they do not move during washing.

You will improve drying results by leaving the dishwasher door ajar for at least 15-30 minutes as soon as the programme finishes.

Care must be taken when opening the door, as steam will escape.

Items not Suitable for Dishwashers

The following should not be washed in the dishwasher:

Cutlery or dishes with wooden or horn handles or glued parts.

Handmade items, wooden objects, antiques or hand painted china.

Certain types of decoration can discolour when washed in a dishwasher.

Crystal-ware and plastic objects, if not guaranteed dishwasher-proof, should be washed by hand. You are advised to place them in the upper basket and to select a delicate programme.

Certain types of glass can also become opaque after being washed several times in a dishwasher.

Silver cutlery tends to go black if mixed with steel cutlery. Place it in the cutlery basket separate from the others.

Iron and cast iron objects can rust and stain other items.

Aluminium tends to go black; copper, pewter and brass tend to stain.

Caution: You are advised not to load very small or plastic items which can fall through the baskets.

Note: When buying new dishes, ensure that they are dishwasher-proof.

For best results we recommend the use of Finish detergents, rinse aid and salt.



WASHING PROGRAMMES

Programme	Type of load and degree of soil	Programme knob setting	Required pushbuttons	Recommended quantity of detergent		Cycle description
				in the dispenser	on the dispenser lid	
*NORMAL WITH PREWASH 65°C	Heavy soil. Crockery, cutlery, pots and pans.,	A	<input type="checkbox"/> ON <input type="checkbox"/> OFF	20 g	5 g	Cold prewash Main wash at 65°C 2 cold rinses 1 hot rinse at 65°C Hot air drying
NORMAL NO PREWASH 65°C	Normal soil. Crockery, cutlery, pots and pans.	B	<input type="checkbox"/> ON <input type="checkbox"/> OFF	25 g	—	Main wash at 65°C 2 cold rinses 1 hot rinse at 65°C Hot air drying
ECONOMY WITH PREWASH 55°C	Light soil. Crockery, cutlery, pots and pans. Delicate china and glassware	A	<input type="checkbox"/> ON <input type="checkbox"/> OFF <input type="checkbox"/> 55°C	20 g	5 g	Cold prewash Main wash at 55°C 2 cold rinses 1 hot rinse at 65°C Hot air drying
**ECONOMY NO PREWASH 55°C	Light soil. Crockery, cutlery, pots and pans. Delicate china and glassware	C	<input type="checkbox"/> ON <input type="checkbox"/> OFF <input type="checkbox"/> 55°C	15 g	—	Main wash at 55°C 1 cold rinse 1 hot rinse at 55°C
RINSE & HOLD		D	<input type="checkbox"/> ON <input type="checkbox"/> OFF	—	—	Cold rinse to prevent food scraps from drying up and sticking to the dishes

* This programme is equivalent to IEC436 standard.

** This is a special programme to wash in a short time (approx. 36 minutes) a full load of lightly soiled dishes, glasses and crockery (except pots) so that you may re-use them promptly. Due to the shortness of this programme, no drying phase is provided.

Operating Sequence

1. Check that the filters are clean

(see cleaning instructions)

2. Check that there is salt and rinse aid

3. Load the dishes

Remove any scraps of food.

Pull the lower basket out and arrange the saucepans, plates and cutlery in it.

Pull the upper basket out and arrange the plates, saucers, glasses and cups etc. in it.

Slide the baskets back into the machine.

Ensure that the spray arms can rotate freely.

4. Measure out detergent

Pour the required amount of detergent into the dispenser according to the indications in the «Washing programmes chart» and close the lid.

Close the dishwasher door.

5. Set the programme

Turn the «programme selector dial» clockwise until the letter of the programme you wish to select corresponds with the «programme marker».

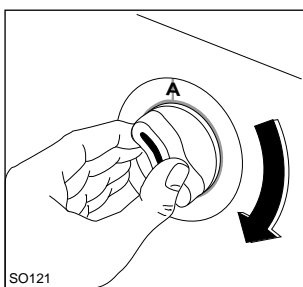

6. Select the temperature

Select the temperature according to the instructions in the «Washing programmes chart» (see «Required pushbuttons»).

When the «55°C» button is depressed, the main wash is at 55°C.

If the «55°C» temperature button is not depressed, the main wash will always be at 65°C.

7. Start the programme

Depress the ON/OFF pushbutton.

The indicator light will come on and the machine will start. If you wish to interrupt the wash at any time press the button again.

To restart the machine, depress the same button again and the programme will continue from the point where it was interrupted.

8. At the end of the washing programme

At the end of the washing programme the dishwasher will stop automatically.

The indicator light remains on until the ON/OFF button is depressed.

When the programme has finished you are advised to unplug the appliance and turn off the water tap.

Open the door and wait a few minutes before removing the dishes; in this way you will avoid burning your fingers and drying will be improved.

Empty the lower basket first and then the upper one; this will avoid water dripping from the upper basket onto the dishes in the lower one.

Caution

In general it is not advisable to open the door while the machine is working; if the door is opened however, a safety device ensures that the machine stops.

If you have to open the door while the machine is working, always switch off the appliance first by pressing the ON/OFF button.



Do not open the door during the hot phases: this may cause hot water escape.

MAINTENANCE AND CLEANING

Cleaning the central filters

(After each wash)

Inspect the central filters (B) and (C) and remove any scraps of food with a brush, under running water.

Filters (B) and (C) are both removed by lifting up the outer one (B) (pulling the central funnel upwards); the smaller filter (C) can then be removed by pressing the two tongues (D).

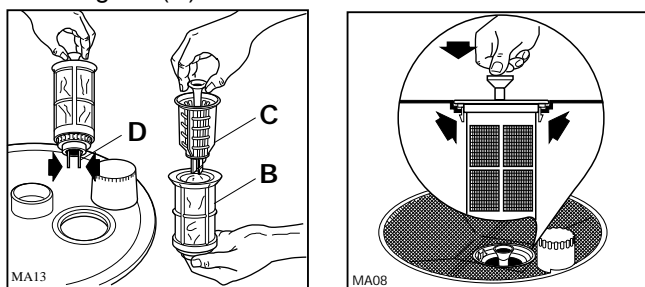

Once cleaned, refit the filters by pressing them down until they click into place.

Cleaning the large filter

(Once a month)

Clean the large filter (A) on both sides under running water, using a brush.

To take it out, remove the spray arm by pressing the two tongues (E), turn the ring (F) anticlockwise (towards the left) and then slide the whole part out. Refit the filter following the above instructions in reverse order.

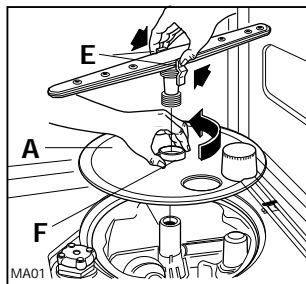

Caution: the dishwasher must not be used without filters.

Incorrect repositioning of the filters will produce poor washing results.

Cleaning of the filters is vital to ensure correct operation of the machine.

Internal and external cleaning

You must ensure that the seals around the door, the detergent and rinse aid dispensers are cleaned regularly with a damp cloth.

We recommend the use of Finish Dishwasher Cleaner every 3 months or run a 65°C wash programme without dishes using detergent. Regular use of Finish Dishwasher Cleaner cleans inaccessible parts, eliminates unpleasant food odours and helps prevent the build-up of limescale.

Check that the spray arm nozzles are not obstructed.

To remove the bottom spray arm, release it from its securing catches and pull it out.

To clean the nozzles of the top spray arm, slide out the top basket whereby the spray arm will become accessible. To remove it, withdraw the central funnel by pressing the two side tabs and unscrewing the retaining ring.

Wash the spray arms under running water and refit them in place.

Clean the external surfaces of the machine and control panel with a soft damp cloth. If necessary use only neutral detergents. Never use abrasive products, scouring pads or solvents (acetone, trichloroethylene etc...).

Prolonged periods of non-operation

If you are not using the machine for any period of time you are advised to:

unplug the appliance and turn off the water;

fill the rinse aid dispenser;

leave the door ajar to prevent the formation of unpleasant smells;

leave the inside of the machine clean.

Frost precautions

Avoid placing the machine in a location where the temperature is below 0°C.

If this is unavoidable, empty the machine, close the water inlet tap, disconnect the water inlet pipe and empty it.

Moving the machine

If you have to move the machine (you are moving house etc...):

unplug it;

turn off the water tap;

remove the water inlet and discharge hoses;

pull the machine out together with the hoses.

Caution: avoid over tilting the machine during transport.

SOMETHING NOT WORKING

Certain problems are due to lack of simple maintenance or oversights and can be solved easily without having to call out an engineer.

The machine will not start

- The door has not been properly closed.
- The plug is not properly inserted in the power socket.
- There is no current at the socket. Check the fuse.

The machine will not fill with water

- The water tap is shut.
- The water supply has been cut off.
- The inlet hose is kinked.
- The water inlet hose filter is clogged.

The machine will not drain

- The drain hose is kinked.
- The sink drain is blocked.
- The drain hose extension is not correct.
- There is no air vent in the end of the drain hose.

The dishes are not clean (poor wash)

- The baskets are too full.
- The dishes have not been arranged properly.
- The spray arms do not rotate.
- The spray arm holes are clogged.
- The water inlet funnel in the centre of the upper basket is covered by dishes.
- The end of the drain hose is submerged in waste water (in the sink).
- The filters are clogged.
- The filters are not in position.
- Not enough detergent has been used or it is unsuitable.
- The detergent is old or has gone hard.
- The salt container cap is not properly closed.
- The washing programme selected is too gentle.

Visible lime deposits or white film on the dishes

- There is no salt or the softener has not been adjusted to the hardness of the water.
- The rinse aid has run out or too little is being used.

The machine is noisy

- The dishes are rattling against each other.
- The spray arms are knocking against the dishes.

The dishes are not quite dry

- The dishes have been left too long inside the machine.

The door is difficult to close

- The dishwasher is not level or is not properly built-in.

SERVICE AND SPARE PARTS

If, after the above checks, the fault persists, call your nearest Service Centre by telephoning:

08705 929929

Please give details of the fault, the appliance model (Mod.), the product number (Prod. No.) and the serial number (Ser. No.). This information can be found on the rating plate located on the right-hand side of the dishwasher door (see picture).

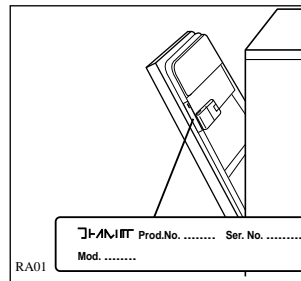

Original spare parts can be purchased from Zanussi Service Force Centres.

In-guarantee customers should ensure that the above checks have been made as the engineer will make a charge if the fault is not a mechanical or electrical breakdown.

Please note that proof of purchase is required for any in-guarantee service calls.

PEACE OF MIND FOR TWELVE MONTHS

Zanussi guarantee conditions

This guarantee is in addition to your statutory and other legal rights.

We, Zanussi Ltd., undertake that if, within twelve months of the date of the purchase, this ZANUSSI appliance or any part thereof is proved to be defective by reason only of faulty workmanship or materials, we will, at our option, repair or replace the same FREE OF ANY CHARGE for labour, materials or carriage on condition that:

- The appliance has been correctly installed and used only on the electricity supply stated on the rating plate.
- The appliance has been used for normal domestic purposes only, and in accordance with the manufacturer's operating and maintenance instructions.
- The appliance has not been serviced, maintained, repaired, taken apart or tampered with by any person not authorised by us.

All service work under this guarantee must be undertaken by a Zanussi Service Force Centre.

Home visits are made between **8.30 am** and **5.30 pm** Monday to Friday. Visits may be available outside these hours in which case a **premium** will be charged.

Any appliance or defective part replaced shall become our property.

Exclusions

This guarantee does not cover:

- Damage or calls resulting from transportation, improper use or neglect, the replacement of any light bulbs or removable parts of glass or plastic.
- Costs incurred for calls to put right machines improperly installed or calls to machines outside the UK and the Republic of Ireland.
- Appliances found to be in use within a commercial or similar environment, plus those which are the subject to rental agreements.
- Products of Zanussi manufacture which are NOT marketed by Zanussi Ltd.

This guarantee is in addition to your statutory and legal rights.

Zanussi European Guarantee

If you should move to another country within Europe then your guarantee moves with you to your new home subject to the following qualifications:

- The guarantee starts from the date you first purchased your product.
- The guarantee is for the same period and to the same extent for labour and parts as exists in the new country for this brand or range of products.
- This guarantee relates to you and cannot be transferred to another user.
- Your new home is within the European Community (EC) or European Free Trade Area.
- The product is installed and used in accordance with our instructions and is only used domestically, i.e. a normal household.

Before you move please contact your nearest Customer Care Centre, listed below, to give them details of your new home. They will then ensure that the local Service Organisation is aware of your move and able to look after you and your appliances.

France	Senlis	+33 (0)3 44 62 29 99
Germany	Nurnberg	+49 (0)911 323 2600
Italy	Pordenone	+39 (0)1 678 47053
Sweden	Stockholm	+46 (0)8 738 79 50
UK	Newbury	+44 (0)1 635 521313



Total Chlorine free

