

Service Manual

Dishwasher

ADP 2656 WHM

| Model Version | | Page |
|--------------------------|-----------------|-------------|
| | ADP 2656 WHM | |
| | 8542 656 10510 | |
| | Technical data | 2 - 4 |
| | Spare part list | 5 - 6 |
| | Exploded view | 7 - 8 |
| | Circuit diagram | 9 |
| | Program diagram | 10 |
| | Text/Legend | 11 - 16 |
| | Family | VBL - B6 |

Technical data**Dimension**

| | | |
|--------|------|----|
| Height | 85.0 | cm |
| Width | 59.7 | cm |
| Depth | 59.6 | cm |
| Weight | 61.3 | kg |

Electronic boards

| | |
|----------------|---------------------|
| Service boards | see spare part list |
| Serial boards | |
| DUB | 4619 724 06781 |
| CB | 411911 |
| Dataset | 411901 |

Succession of programs

| | |
|------------|---------------------|
| Programs | see program diagram |
| Succession | 1a-3b-4f-5a-6a-7a |

Alarms

| |
|------------------|
| Refill rinse aid |
| Refill salt |

Options

| |
|----------------|
| Zone washing |
| Delay function |

Datas Energy Label

| | |
|----------------------|----|
| Energy Performance | C |
| Cleaning Performance | A |
| Drying Performance | C |
| Reference program | 4f |

Program information

| |
|-----------------|
| Start indicator |
| Pre wash |
| Main wash |
| Drying |
| End |

Volume (normal program)

| Water | Volume | Level |
|---------------------------------------|--------|--------|
| Regeneration | 0.3 l | 15 mm |
| Back rinse 3x | 1.0 l | 68 mm |
| Prewash | 4.8 l | 122 mm |
| Prewash/Zone washing | 4.0 l | 120 mm |
| Main wash | 4.5 l | 121 mm |
| Main wash/Zone washing | 3.5 l | 117 mm |
| Intermediate rinse 1 | 4.0 l | 120 mm |
| Intermediate rinse 1/ Zone washing | 3.5 l | 117 mm |
| Intermediate rinse 2 | 4.0 l | 120 mm |
| Intermediate rinse 2/ Zone washing | 3.5 l | 117 mm |
| Clear rinse | 4.0 l | 120 mm |
| Clear rinse/Zone washing | 3.5 l | 117 mm |
| Safety / overflow | 8.5 l | 141 mm |

Measuring the level

Remove the coarse sieve, put in a measuring meter into the sump, measure the height of the water level.

Detergent max.

| | | |
|----------------|-------|-----------------|
| Pre-wash | 10 | cm ³ |
| Main-wash | 45 | cm ³ |
| Rinse aid | 125 | cm ³ |
| 6 Dosage steps | 1 - 6 | ml |

Water softener

| | | |
|---------------------|-----|-----------------|
| Saltcontainer | 2 | kg |
| Resin container | 900 | cm ³ |
| Regeneration dosage | 300 | cm ³ |

Water pressure

| | | |
|---------------------|--------|-----|
| Inlet pressure | 0.3-10 | bar |
| Spray pump pressure | 0.4 | bar |

Rotations

| | | |
|------------------|---------|-----|
| Spray pump motor | 2800 | RPM |
| Drain pump motor | 3000 | RPM |
| Spray arm lower | 20 - 40 | RPM |
| Spray arm upper | 25 - 35 | RPM |
| Ceiling rotor | 45 - 65 | RPM |

Technical data

Flow rates / Inlet volume

| | | |
|---|------|-------|
| Flow meter (at 0.3 bar = quantity 1.1 l/min) | 208 | lmp/l |
| Spray pump | ~ 70 | l/min |
| Drain pump | 16 | l/min |
| Pump height max. | 1.1 | m |
| Inlet valve | 4.5 | l/min |
| Valve for Zone washing | 30 | l/min |
| Spray arm lower | ~ 33 | l/min |
| Sprayarm upper | ~ 27 | l/min |
| Ceiling rotor | ~ 10 | l/min |

Electrical data

Base data

| | | |
|-------------|---------|----|
| Voltage | 220/230 | V |
| Frequency | 50 | Hz |
| Total power | 2.0-2.2 | kW |
| Fuse | 10 | A |

Motor

Spray pump motor

| | | |
|-------------------|---------|----------|
| Voltage | 220/230 | V |
| Power consumption | 160 | W |
| HI | 81 | Ω |
| HA | 44 | Ω |
| Capacitor | 4 | μ F |

Drain pump motor

| | | |
|-------------------|---------|----------|
| Voltage | 220/240 | V |
| Power consumption | 30 | W |
| Resistance | 146 | Ω |

Heating

1 Element system

| | | |
|---------------------------------|-----------|------------------|
| Voltage | 220/230 | V |
| Power consumption | 1.87/2.04 | kW |
| Resistance | 24.5 | Ω |
| Heating speed | ~ 2.0 | $^{\circ}$ C/min |
| Temperature on surface | ~ 115 | $^{\circ}$ C |
| Safety thermostat self reset | 85 | $^{\circ}$ C |

Potentiometer

| | |
|------------------------|-------------------------|
| Points of measurement: | 1 (black) to 2 (middle) |
| Position 0 | 0.0 k Ω |
| Position 1 | 0.5 k Ω |
| Position 2 | 1.0 k Ω |
| Position 3 | 1.4 k Ω |
| Position 4 | 1.8 k Ω |
| Position 5 | 2.3 k Ω |
| Position 6 | 2.6 k Ω |

Water valves

Single valve at inlet hose

| | | |
|------------|---------|------------|
| Voltage | 220/240 | V |
| Frequency | 50/60 | Hz |
| Resistance | 3.76 | k Ω |

Regenerating valve

| | | |
|------------|---------|------------|
| Voltage | 220/240 | V |
| Frequency | 50/60 | Hz |
| Resistance | 3.13 | k Ω |

Valve for zone washing

| | | |
|------------|---------|------------|
| Voltage | 220-240 | V |
| Frequency | 50/60 | Hz |
| Resistance | 4 | k Ω |

Coil of dispenser

| | | |
|------------|---------|------------|
| Voltage | 220/240 | V |
| Frequency | 50/60 | Hz |
| Resistance | 1.5 | k Ω |

Reedcontact

flow meter
salt control
rinse aid control

NTC

| | | |
|-----------------|------|------------|
| 20 $^{\circ}$ C | 58.1 | k Ω |
| 25 $^{\circ}$ C | 47.1 | k Ω |
| 30 $^{\circ}$ C | 38.2 | k Ω |
| 40 $^{\circ}$ C | 25.4 | k Ω |
| 50 $^{\circ}$ C | 17.2 | k Ω |
| 60 $^{\circ}$ C | 11.8 | k Ω |
| 70 $^{\circ}$ C | 8.3 | k Ω |
| 80 $^{\circ}$ C | 6 | k Ω |
| 85 $^{\circ}$ C | 4 | k Ω |

Technical data**Regeneration**

| | | |
|---|----------------------------------|----------------------|
| Volume | 300 | cm ³ |
| Position 0 after wash cycles water hardness | 10 0-5 0-0.9 0-9 | °dh mmol/l °Fh |
| Position 1 after wash cycles water hardness | 8 6-10 1-1.8 10-18 | °dh mmol/l °Fh |
| Position 2 after wash cycles water hardness | 6 11-15 1.9-2.7 19-27 | °dh mmol/l °Fh |
| Position 3 after wash cycles water hardness | 4 16-21 2.8-3.7 28.37 | °dh mmol/l °Fh |
| Position 4 after wash cycles water hardness | 3 22-28 3.8-5.0 38-50 | °dh mmol/l °Fh |
| Position 5 after wash cycles water hardness | 2 29-35 5.1-6.3 51-63 | °dh mmol/l °Fh |
| Position 6 after wash cycles water hardness | 1 36-60 6.4-10.7 64-107 | °dh mmol/l °Fh |
| Salt consumption for regeneration | 77 | g |
| Number of cycles with 2 kg salt | 26 | |

Accessory

If you need spare parts apart from the spare part list have a look in the Service Bulletin 4812 718 40084.

Spare part list

Model ADP 2556 WHM
Service No. 854265610510
Version 854265610510

| Pos. No. | 12NC Code | Description |
|----------|-----------------------|--------------------------|
| 003 0 | 4812 440 19594 | Traverse |
| 004 0 | 4812 440 18952 | Drip tray assy |
| 004 1 | 4812 401 18402 | Holder |
| 011 0 | 4812 505 18357 | Foot short |
| 022 0 | 4812 440 18951 | Side panel left |
| 022 1 | 4812 440 18949 | Side panel right |
| 024 0 | 4812 440 19463 | Panel, rear |
| 030 0 | 4812 440 19755 | Table top WH |
| 034 0 | 4812 404 78237 | Spacer |
| 034 1 | 4812 404 78242 | Fastener table top |
| 040 1 | 4812 417 18774 | Hinge left |
| 040 2 | 4812 417 18773 | Hinge right |
| 040 3 | 4812 417 18923 | Protector f.door (set) |
| 044 0 | 4812 492 38358 | Spring f.door |
| 047 0 | 4812 404 48591 | Brake f.door |
| 047 1 | 4812 401 18397 | Band,brake |
| 047 2 | 4812 404 68023 | Hook |
| 053 0 | 4812 440 88887 | Plinth WH |
| 053 4 | 4812 440 88928 | Plinth rounded WH |
| 103 0 | 4812 440 19833 | Door outer WH |
| 103 2 | 4812 440 19778 | Corner piece set |
| 120 0 | 4812 440 19456 | Door,inner |
| 120 1 | 4812 440 18969 | Batten |
| 130 0 | 4812 417 58361 | Tilt lock cpl. wh |
| 131 0 | 4812 401 18416 | Hook lock |
| 191 0 | 4812 466 68564 | Gasket door |
| 192 0 | 4812 466 68467 | Gasket, door lower |
| 241 0 | 4812 458 18912 | Basket upper straight |
| 241 1 | 4812 458 18324 | Holder cups right wh |
| 241 3 | 4812 528 88068 | Wheel,basket upper (set) |
| 241 4 | 4812 458 18984 | Holder dishes |
| 241 5 | 4812 535 78043 | Bearing |
| 241 6 | 4812 458 18979 | Holder glasses |
| 241 7 | 4812 404 48683 | Hoop |
| 241 8 | 4812 466 68553 | Spacer cap set |
| 242 0 | 4812 458 18974 | Basket lower cpl. |
| 242 1 | 4812 528 88069 | Wheel,basket lower |
| 242 4 | 4812 466 48059 | Fixation |
| 242 6 | 4812 458 18977 | Support plate left |
| 242 7 | 4812 458 18978 | Support plate right |
| 243 0 | 4812 458 18272 | Basket cutlery |
| 243 5 | 4819 310 39859 | Cutlery basket KIT |
| 243 6 | 4812 458 18996 | Grille |
| 261 0 | 4819 462 38271 | Rail telescope, inner |
| 261 1 | 4819 404 48819 | Cap rail |
| 261 2 | 4812 462 78995 | Cap rail ahead |
| 263 0 | 4819 520 18013 | Ball cage cpl. |
| 263 1 | 4812 520 48001 | Ball Niro 8 D |
| 265 0 | 4812 404 48637 | Basket adjustm. cpl. |
| 265 2 | 4812 404 48638 | Grip basket adjustment |
| 303 1 | 4812 460 38092 | Plate,handle WH |
| 322 0 | 4812 453 70978 | Insert panel |
| 331 0 | 4812 413 59028 | Knob program cpl. WH |
| 332 0 | 4812 410 28669 | Button WH |
| 332 1 | 4812 410 28735 | Button WH |

| Pos. No. | 12NC Code | Description |
|----------|-----------------------|----------------------------|
| 400 0 | 4812 361 58126 | Motor + spraypump cpl. |
| 405 0 | 4812 360 18371 | Spray pump |
| 405 1 | 4819 515 28158 | Gasket |
| 420 0 | 4812 121 18132 | Capacitor |
| 421 0 | 4812 121 18161 | Interf.filter |
| 430 0 | 4812 360 18357 | Pump,draining |
| 430 1 | 4812 466 68506 | Shaft seal |
| 450 0 | 4812 259 28684 | Heating element |
| 480 0 | 4812 321 28394 | Cable harness set |
| 480 1 | 4812 321 28371 | Cable |
| 480 3 | 4812 401 18418 | Protector f.wiring |
| 490 0 | 4819 321 18136 | Cable,mains 2m SA |
| 490 1 | 4812 321 28367 | Strain relief |
| 521 0 | 4812 214 78428 | Control board (CB) |
| 531 0 | 4812 273 18055 | Switch waterhardness |
| 531 1 | 4812 273 18056 | Wheel,fingertip |
| 571 3 | 4812 281 28363 | Valve f.zone-washing |
| 575 0 | 4812 281 28361 | Regen.valve |
| 583 0 | 4812 271 28407 | Switch diaphragm |
| 616 0 | 4812 281 18047 | Contact,reed salt |
| 616 1 | 4812 271 58161 | Contact,reed rinsing agent |
| 620 0 | 4812 218 38101 | User board (DUB) |
| 623 0 | 4812 271 38356 | Microswitch |
| 633 0 | 4812 271 38355 | Microswitch door |
| 680 0 | 4812 418 68155 | Combidosage |
| 680 1 | 4812 466 68495 | Gasket |
| 681 1 | 4812 466 68497 | Gasket |
| 681 2 | 4812 440 18975 | Flap |
| 682 0 | 4812 466 68496 | Gasket |
| 691 0 | 4812 282 68012 | Feeler NTC |
| 700 0 | 4812 530 28804 | Hose, inlet aqua stop 4,2m |
| 700 0 | 4812 530 28848 | Hose, inlet aqua stop 2m |
| 700 1 | 4812 480 48095 | Sieve |
| 700 2 | 4812 466 68628 | Gasket |
| 701 1 | 4812 310 18153 | Yoke clamp set |
| 710 0 | 4812 418 68151 | Monoblock |
| 710 2 | 4819 310 38536 | Threaded ring |
| 710 3 | 4819 466 69562 | Gasket set |
| 714 0 | 4812 462 78993 | Threaded cap |
| 714 2 | 4812 440 18963 | Cabinet non-return flap |
| 716 0 | 4812 418 68147 | Reg.dosage |
| 716 1 | 4812 466 68475 | Gasket |
| 716 2 | 4812 462 78994 | Cover |
| 721 1 | 4812 360 68061 | Spray arm lower. cpl. |
| 721 2 | 4812 466 68491 | Gasket 25x2,3B |
| 721 3 | 4812 466 68558 | Gasket 30x3,0 |
| 721 4 | 4812 440 19455 | Flange |
| 722 0 | 4812 360 68044 | Spray arm upper |
| 722 2 | 4812 360 68056 | Hub upper straight cpl. |
| 723 0 | 4812 360 68049 | Spray arm ceiling |
| 723 1 | 4819 310 39831 | Kit |
| 726 0 | 4812 530 28786 | Tube |
| 726 1 | 4812 530 28787 | Tube |
| 726 2 | 4812 505 18358 | Nut |
| 726 3 | 4812 466 68512 | Gasket |

Spare part list

Model ADP 2556 WHM
Service No. 854265610510
Version 854265610510

| Pos. No. | 12NC Code | Description |
|----------|-----------------------|-------------------------|
| 726 4 | 4812 462 79633 | Centering |
| 743 0 | 4812 511 48171 | Capacitor |
| 743 1 | 4812 530 28102 | Hose, inlet |
| 743 3 | 4812 505 18364 | Nut |
| 743 4 | 4812 530 28807 | Hose 9x1,5x270+10 |
| 743 7 | 4812 466 68514 | Gasket |
| 751 0 | 4812 418 18205 | Water collector |
| 751 1 | 4819 310 39826 | Water guide service kit |
| 755 0 | 4812 530 28849 | Bend |
| 755 2 | 4812 530 48148 | Tray,leak |
| 756 0 | 4812 360 58099 | Floater |
| 761 0 | 4812 480 58082 | Sieve fine |
| 761 2 | 4812 418 18204 | Cover sieve |
| 762 0 | 4812 480 58084 | Microfilter |
| 763 0 | 4812 480 58083 | Sieve coarse |
| 781 0 | 4812 530 28737 | Hose,draining |
| 781 1 | 4819 530 28286 | Sleeve hose |
| 781 2 | 4819 492 68405 | Clip f.non-return valve |
| 781 3 | 4812 281 28364 | Flap non-return |
| 783 1 | 4812 530 28806 | Hose connection |
| 783 5 | 4812 530 28851 | Distributor |
| 783 6 | 4812 530 28796 | Hose 10x3x180+10 |
| 791 0 | 4812 532 68067 | Gasket |
| 791 2 | 4812 530 58093 | Gasket |
| 791 4 | 4812 466 68503 | Gasket |
| 791 5 | 4812 466 68504 | Gasket |
| 794 1 | 4819 530 58032 | Gasket 20x2,5 |
| 901 0 | 4822 401 10492 | Clamp,hose 14-24 mm |
| 901 1 | 4812 401 18424 | Strap 050,0 |
| 901 2 | 4812 401 18157 | Strap 32-50/9 C61 |
| 901 7 | 4812 401 18427 | Strap 031,6 |
| 904 2 | 4812 462 79635 | Cover WH 3,5x5 |
| 910 0 | 4812 502 18384 | Screw 4x35-H |
| 910 1 | 4812 502 18394 | Screw 3,5x14-H |
| 910 2 | 4812 502 18363 | Screw 4,0x12-H |
| 910 3 | 4812 502 18389 | Screw NIRO A2 |
| 910 4 | 4812 502 18385 | Screw M3,5x8-T15M |
| 910 5 | 4812 502 18393 | Screw 3,5x9-1 Tx15 |
| 910 7 | 4812 502 18397 | Screw INOX A2 M 5X12 |
| 910 9 | 4812 502 18446 | Screw 3,5x16 |
| 964 0 | 4812 466 68536 | Gasket housing ri/le |
| 964 1 | 4812 466 68469 | Gasket housing upper |
| 993 0 | 4819 530 29028 | Bow |
| 993 5 | 4822 532 80216 | Funnel salt |

Exploded view

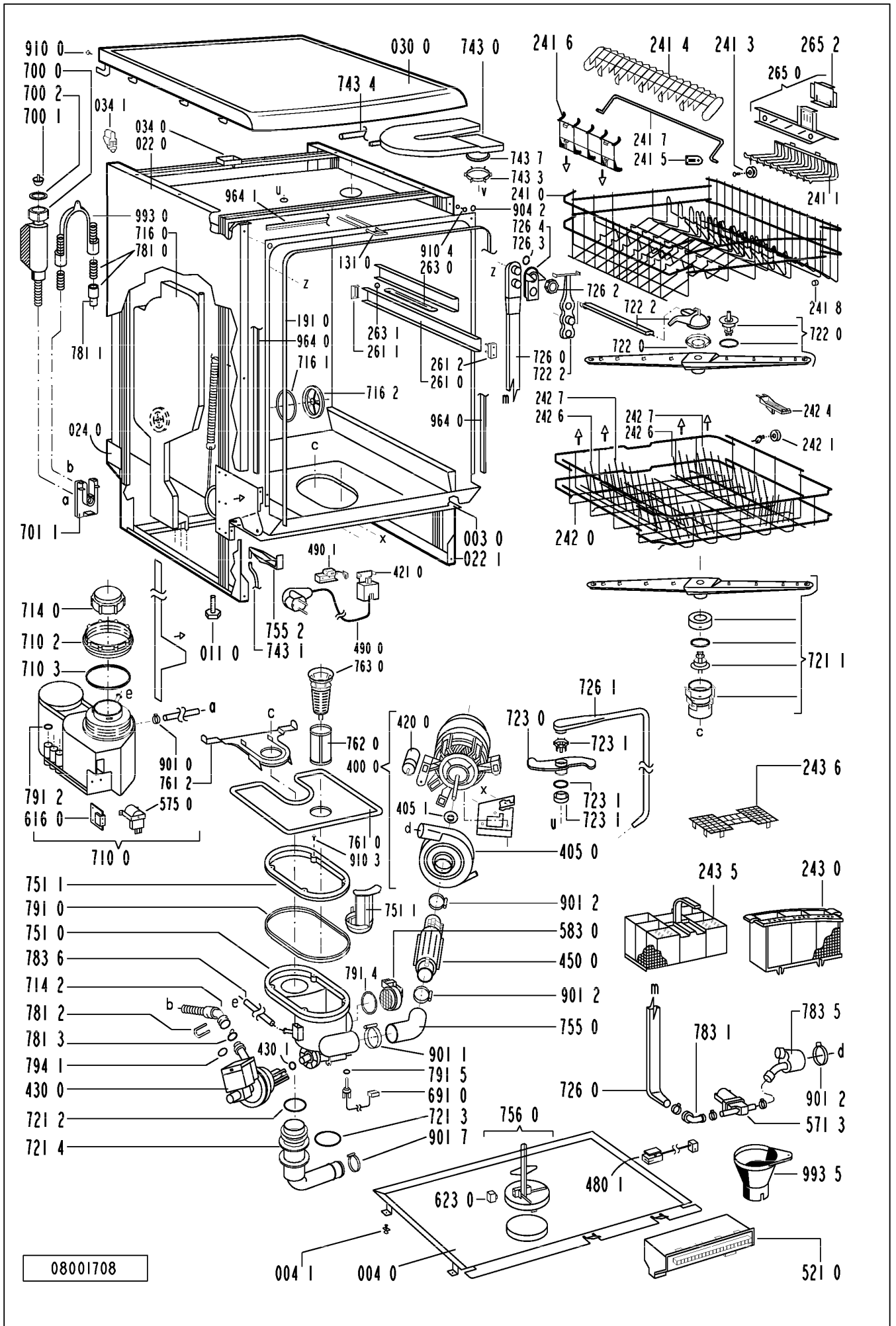

Exploded view

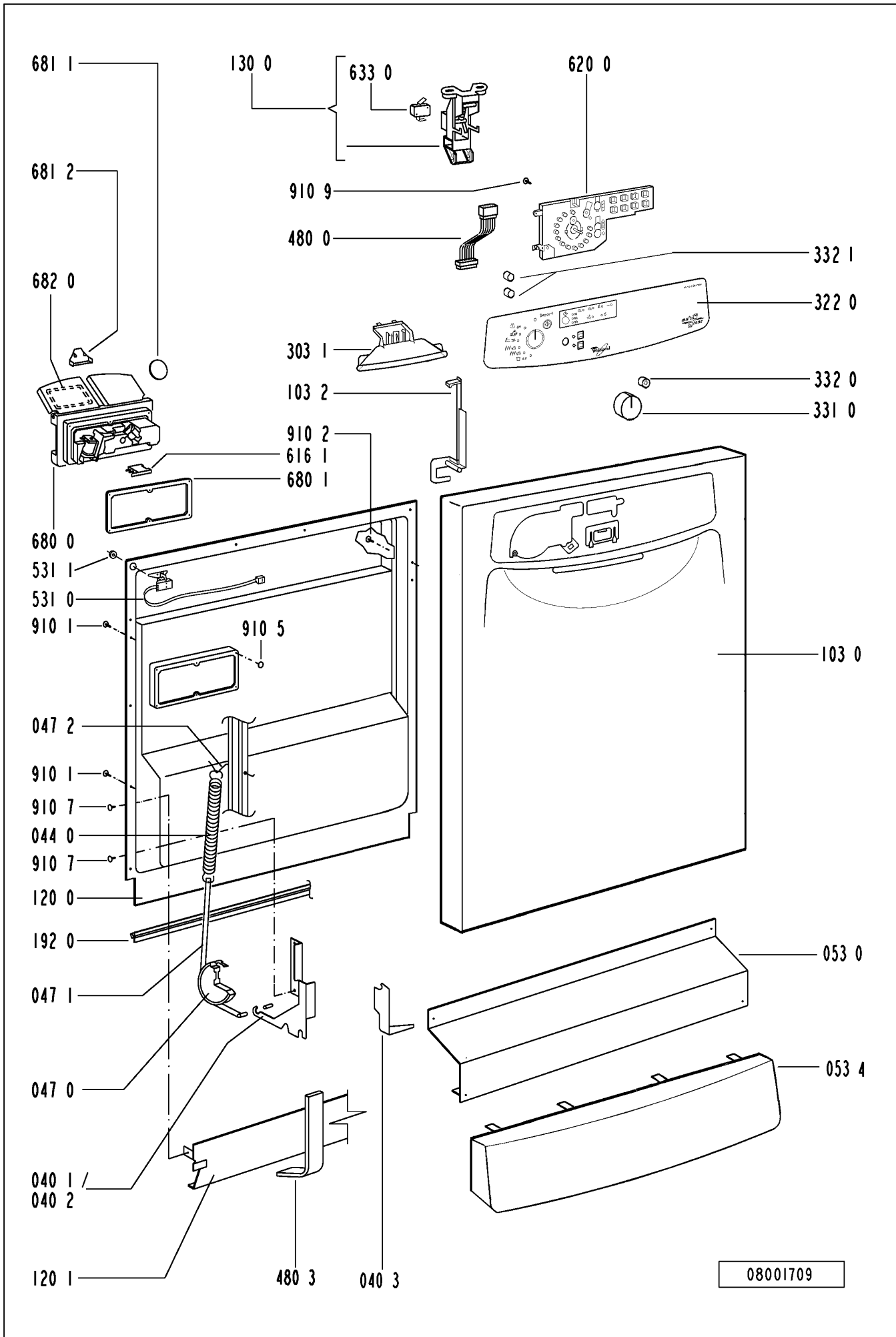

Circuit diagram

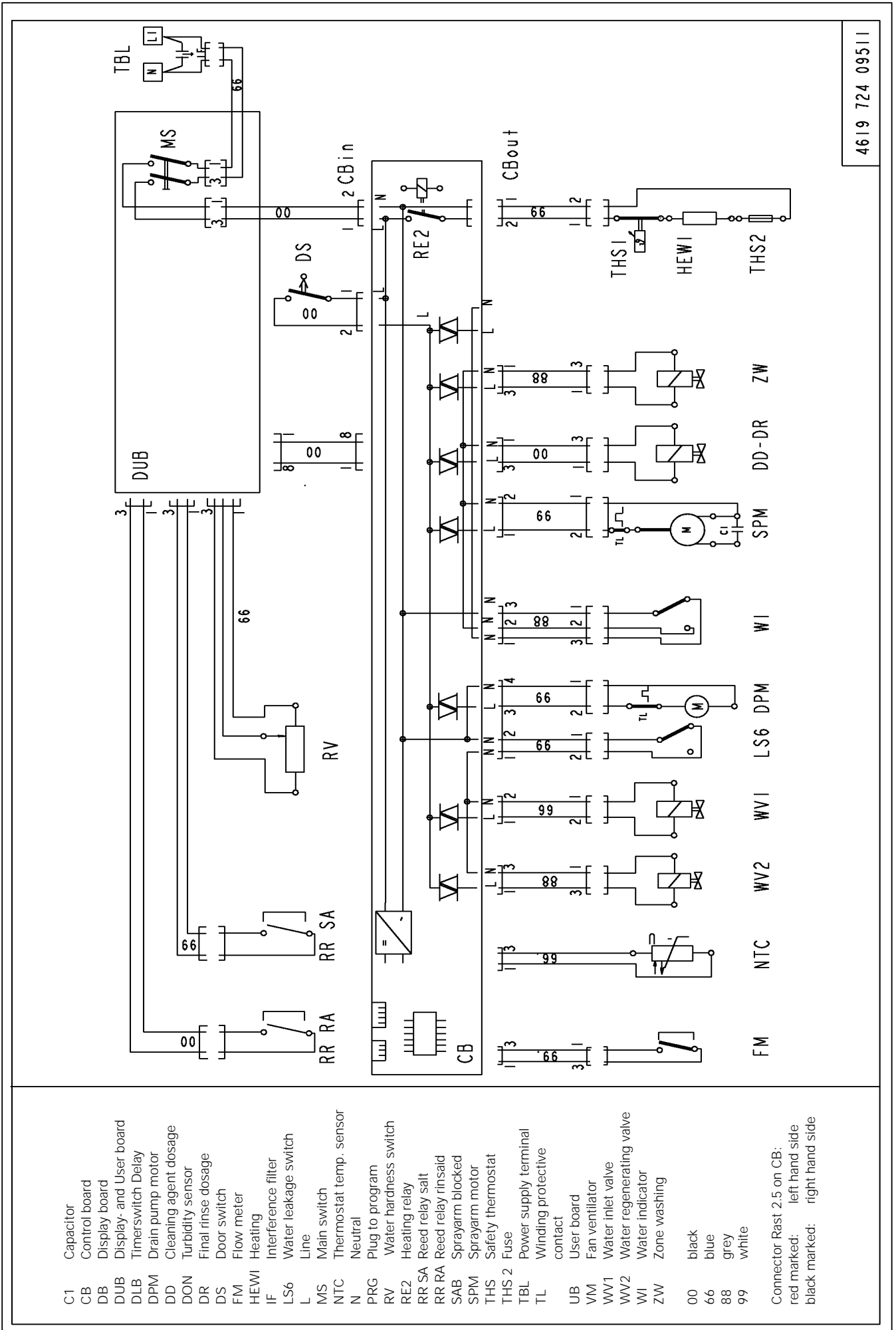

- C1 Capacitor
- CB Control board
- DB Display board
- DUB Display- and User board
- DLB Timerswitch Delay
- DPM Drain pump motor
- DD Cleaning agent dosage
- DON Turbidity sensor
- DR Final rinse dosage
- DS Door switch
- FM Flow meter
- HEWI Heating
- IF Interference filter
- LS6 Water leakage switch
- L Line
- MS Main switch
- NTC Thermostat temp. sensor
- N Neutral
- PRG Plug to program
- RV Water hardness switch
- RE2 Heating relay
- RR SA Reed relay salt
- RR RA Reed relay rinsaid
- SAB Sprayarm blocked
- SPM Sprayarm motor
- THS Safety thermostat
- THS 2 Fuse
- TBL Power supply terminal
- TL Winding protective contact
- UB User board
- VM Fan ventilator
- WV1 Water inlet valve
- WV2 Water regenerating valve
- WI Water indicator
- ZW Zone washing
- 00 black
- 66 blue
- 88 grey
- 99 white

Connector Rast 2.5 on CB:
 red marked: left hand side
 black marked: right hand side

Text/Legend

**Test procedure for SERVICE-TEST-PROGRAM DOLPHIN dishwashers
Whirlpool VBL without 2 digit 7 segment-display**

Switch on the appliance. If there is no failure indicated, than:

1. Start the passive test program.
If there is a defective component indicated, open the plinth and take out the control board (CB).
2. Check the component.
Unplug the indicated component from the control board (CB) and check it by using an Ohm-measure equipment.
If the ohms are not correct, check the cables to the component and check the component itself.
3. Check the control board (CB).
4. At the end of the repair start the appliance and delete the failure. After this, start the passive and active test program again to see that the failure is solved.

More details: s. following pages.

Attention:

First unplug the appliance, then set the connection clamps of the volt measurement on the test points.

Danger for short circuit. Short circuits on components can damage the control board (CB).

If electronic boards are wet, do not switch the appliance on.

For check the appliance, plug in the appliance.

Failures, which occurred during the program will store and indicate by flashing start LED.

Then start the test program without erase the failure before. The failure will indicate.

To erase the failures, you must push the start button longer than 3 seconds.

The failures

- F1 NTC break
- F2 water leakage
- F9 continuous water inlet

are checked and indicated immediately after start of the program.

Therefore these failures have to be solved before starting the active test program.

When these failures are not solved, the active test program does not run.

The electrical components get their voltage via triac from the control board (CB). For testing the volume of voltage the volt meter must be parallel to the component (the component must be connected). If the component is disconnected, then the outcomed voltage from the control board (CB) is reduced.

After starting a program this program is locked. That means neither by unplugging/switching of the appliance nor by setting an other program, the first setted program can be changed. Changing of the program is only possible by pushing the start button again for longer than 3 sec..

Attention: On new service control boards the first service test program is without back rinsing. Dangerous for overfilling the appliance, in case the appliance is not empty. By running the test program a second time the back rinsing will be carried out as usual.

Text/Legend

Handling of failures

F0 Sensor failure

Will not indicate for the customer. The programs will finish even there is a failure. The Failure is indicated only in the active test program after 10 – 30 second's. The active test program will finish as well, even there is a failure.

If the failure in a sensor program appear, the machine will always choose the highest consumption (best cleaning result).

- None or wrong output from the sensor
- Unlogical or unreal measurement results

Reason:

- Defective electronic of the sensor
- Optoelectrical parts in the sensor defect
- Case of the sensor is very dirty
- Connection between sensor and control board (CB) interrupted

Attention: The failure code will not store.

F1. NTC break

Temperature out of the normal value (-3°C till +85°C)

- temperature inside higher than +85°C
- NTC defective
- dishwasher is frozen, less than -3°C

Fill in the appliance a cup of warm water to warm it up before you start it, if the temperature is less than -3°C

F2. water leakage

- water is in the drip tray

float (LS6) switches off the WV1 and the electronic switches on the DPM till WI reports empty

F3. heating system defective

Indicated after app. 25 minutes (1. check after 5 min., after that follow 2 more checks, before the failure is indicate)

- too less heating speed (lower 1,5 °C in 10 min.)
- heating (HEW) defective
- relays (RE2) on control board (CB) is defective
- NTC - resistance fluctuation
- water indicator (WI) defective (is switched off) - spray pump (SPM) is not working

F4. draining failure

drain pump starts and after 4 min. the WI detects not empty

- drain pump (DPM) defective
- siphon closed
- control board (CB) defective
- water indicator (WI) defective (is switched on)

F6. water tap closed (only indicated after start of the active test program)

water valve (WV1) is switched on but flow meter (FM) sends no impulses (less than 10 imp. in 10 sec.) and the water indicator (WI) is off (empty)

- water tap closed
- water inlet hose blocked
- water inlet valve (WV1) defective
- flow meter (FM) defective (leads to FM failure)



















Text/Legend

- F7. flow meter failure
water inlet valve (WV1) is switched on and the water indicator (WI) is on (full).
- flow meter (FM) sends to less impulses (less than 10 imp. in 10 sec.)
- water tap closed
- water inlet hose blocked
- water inlet valve (WV1) defective
- flow meter (FM) defective
- F8. water level failure
failure monitored during spray pump is on and the water indicator switches back more than 20 times in 2 min.
- water indicator defective (should switch on after app. 1 litre)
- sieve blocked
- water strongly foams
- pot has turned off and is filled with spray water
- no stable spray pump (SPM) working
- F9. continuous water inlet
water inlet valve (WV1) is switched off, water indicator (WI) on, flow meter (FM) sends impulses (more than 10 imp. in 10 sec.)
- water inlet valve (WV1) mechanically not closed
- triac (CB) permanently switched on. (short circuit)
- reaction: interval 30 sec. draining / 20 sec. tracing

For salt, rinse aid, zone wash valve, sieve valve failure see active test program.

Text/Legend

FAILURECODES for Whirlpool VBL without 2 digit 7 segment display

| Alarm / Failures | Failurecode, which is indicated for the customer on the Start-LED and the Programsequence, directly after it's occurred | |
|------------------------------------|--|--|
| | Both indications parallel on appliances with Programsequence | |
| | Indication on appliances without Programsequence | |
| F0 Sensore failure | Indicated only in the active testprogram START  10 x flashing 1s break 10 x flashing..... |  PS1 PS2 PS3 PS4 |
| F1 NTC-break | START  1 x flashing 1s break 1 x flashing..... |  PS1 PS2 PS3 PS4 |
| F2 Water leakage | START  2 x flashing 1s break 2 x flashing..... |  PS1 PS2 PS3 PS4 |
| F3 Heating system defective | START  3 x flashing 1s break 3 x flashing..... |  PS1 PS2 PS3 PS4 |
| F4 Draining failure | START  4 x flashing 1s break 4 x flashing..... |  PS1 PS2 PS3 PS4 |
| F6 Water tap closed | START  6 x flashing 1s break 6 x flashing..... |  PS1 PS2 PS3 PS4 |
| F7 Flow meter failure | START  7 x flashing 1s break 7 x flashing..... |  PS1 PS2 PS3 PS4 |
| F8 Waterlevel failure | START  8 x flashing 1s break 8 x flashing..... |  PS1 PS2 PS3 PS4 |
| F9 Continous waterinlet | START  9 x flashing 1s break 9 x flashing..... |  PS1 PS2 PS3 PS4 |

 LED flashing
 LED off

PS 1 till PS 4: Programsequence

- The failurecode "Sprayarm blocked (F5)" is not present on the Whirlpool VBL Version
- On the 1 digit 7 segment-display the failure will shown with a "F" in the display and a flashing Start-LED.
- The failure F0 (Sensor failure) will only indicated in the active testprogram, that means, this failure is not visible for the customer.

Text/Legend

VBL

5

4619 724 14971-1

With the passive test program, you can check all LED's and buttons. If there is no failure the passive test program runs normal.

Attention:

If you can't start the active test program (Start button don't flash), normally there is one of the following failures detected: F1, F2 or F9

When these failures are not solved before, the passive and active test program will not run. After solving the failure you must "sign" (erase) the failure.

A present failure will be indicate directly after you switch on the appliance

Start procedure

Start the passive test program if there is no failure indicated

If there is no failure the passive test program runs normal.

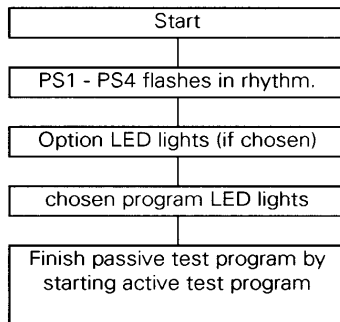

1. Switch off the appliance.
2. Push start button and hold it.
3. Choose programplace 1 (turn to the left side).
4. Finish pushing the start button when the start LED flashes.
5. Test all LEDs by operate the buttons and the programknob. After the check, turn the programknob on programplace 1
6. Start the active testprogram by pushing the start button again
7. Failure indication.
8. Repair the failure
9. Solve the failure by pushing the start button for longer than 3 sec.
10. Start the active testprogram again, to see, if the failure is really solved

Active test program starts (see next page)

Program sequence LED

| | | | |
|-----|--------|---|--|
| PS1 | 1. LED | prewash | |
| PS2 | 2. LED | mainwash intermediate rinse final rinse | |
| PS3 | 3. LED | drying (regeneration) | |
| PS4 | 4. LED | end | goes off if any button is pushed |
| | | | goes off after 30 min progr. is finished |

Text/Legend

Active test program

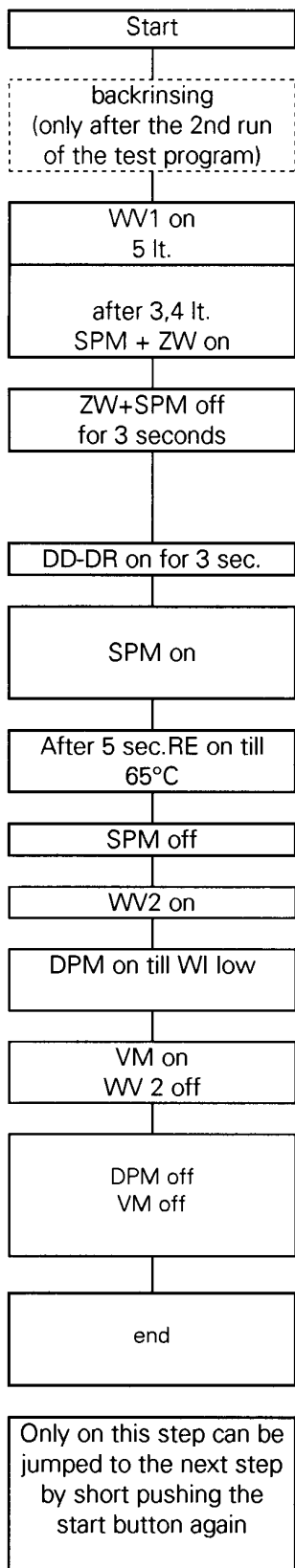

PS4
on

Remarks

The active test program runs to the failure position and stops or, if there is no failure, it runs to the end.

To leave the test program push the start button for longer than 3 second's.

Too less salt or too less rinse aid leads not to the stop of the appliance.

The function of the zone wash valve can only be checked optically.
 A defect leads to a not stable SPM pressure.

When the failure position is reached, the failure indication is like on the page "Failurecodes"

Attention:

If you can't start the active test program (Start button don't flash), normally there is one of the following failures detected: F1, F2 or F9

When these failures are not solved before, the active test program will not run. After solving the failure you must "sign" (erase) the failure.

Remarks:

ZW on: zone wash valve on = no water on the upper sprayarm.

ZW off: zone wash valve off = water on the upper sprayarm.