

**Thank you for choosing this Sony Trinitron Television.**

This step by step guide will help you to:

Connect an aerial to the TV,

Connect a video cassette recorder (VCR) to the TV,

Insert batteries into the remote control,

Switch on the TV,

Tune the TV,

Watch TV programmes,

Watch video tapes.



FD Trinitron  
**WEGA**

# 1

## Connecting an aerial and VCR to the TV

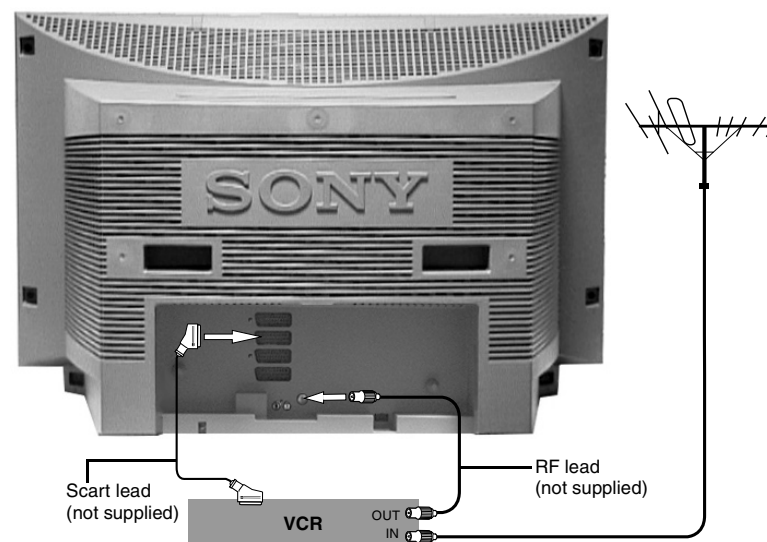

1. Connect your aerial lead to the IN\* socket on your VCR.
2. Connect an RF lead from the OUT\* socket on your VCR to the aerial socket labelled  $\Gamma$  on the rear of the TV.
3. Connect a fully wired 21-pin scart lead from the scart socket marked  $\rightarrow 3 / \rightarrow 3$  on the rear of the TV to a scart socket on your VCR\*\*

**Notes:** \*Socket names may vary depending on make and model of VCR. Refer to your VCR instruction manual for details.

\*\*If your VCR does not have a scart socket follow the connecting instructions above ignoring the scart lead connection. You will also need to manually tune the VCR to a spare TV channel (ideally channel 0, refer to the 'Manual Programme Preset menu' section of the main instruction manual).

### Connecting an aerial only

1. Connect your aerial lead to the aerial socket labelled  $\Gamma$  on the rear of the TV.

# 2

## Inserting batteries into the remote control

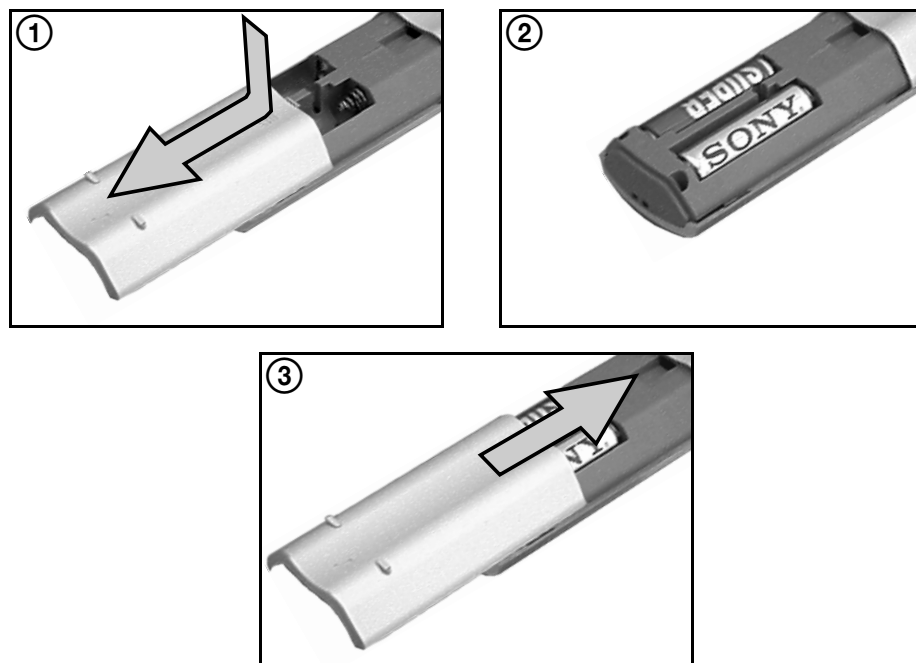

Always remember to:

- observe the correct polarity when inserting batteries,
- dispose of batteries in an environmentally friendly way.

# 3

## Switching on the TV



1. Connect the TV plug to your mains socket and switch on.
2. The TV is usually switched on. If not, push in the On/Off button ① on the front of the TV.

If the red standby mode indicator on the front of the TV is lit, press the TV I/O button on the remote control to switch on the TV set. Please be patient as the picture may take a few moments to appear on the TV screen.

# 4

## Automatically tuning the TV

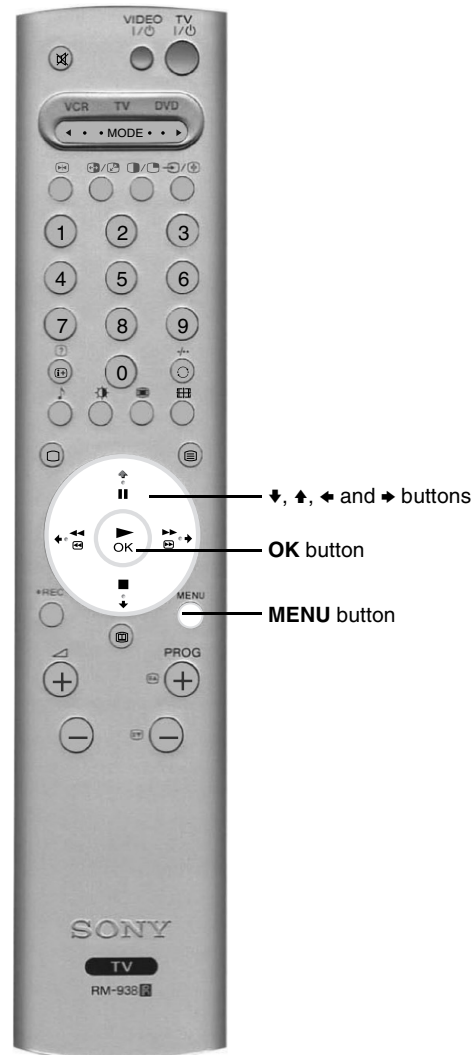

- When you switch on the TV for the first time the Sony logo appears on the TV screen, followed by the Language/Country menu with the word 'English' highlighted. Press the **▲** or **▼** buttons on the remote control to highlight your required language. Press the **OK** button to confirm your choice. From now on all menus appear in your chosen language.
- The word 'Country' is now highlighted. Press the **▲** or **▼** buttons on the remote control to highlight the country in which you are using the TV. It is important to select the correct country to ensure correct Teletext displays. Press the **OK** button to confirm your choice.
- The picture rotation prompt appears. Sometimes the Earth's natural magnetism can cause the screen to look tilted.
  - If no correction is required, press the **◀** button on the remote control.
  - If some correction is required, press the **OK** button on the remote control. Press the **▲** or **▼** buttons to rotate the picture over a range of -5 to +5. Press the **OK** button to store.
- The autotune prompt screen appears. Press the **OK** button to select **Yes**. The autotune procedure begins, tuning all the available channels.
 

A display appears on the TV screen to inform you of the tuning progress.

If no channels are found, a display appears on the TV screen asking you to confirm your aerial is connected. Check the aerial has been connected correctly then press the **OK** button to repeat the tuning process.
- Once all available channels have been tuned the 'Programme Sorting' menu appears. This menu allows you to rearrange the order of the channels on the TV.
  - If you do not wish to rearrange the order, press the **MENU** button to remove the 'Programme Sorting' menu from the TV screen.
  - If you wish to rearrange the order, press the **▲** or **▼** buttons to select the channel you wish to move, then press the **▶** button. Press the **▲** or **▼** buttons to select the new position for your selected channel. Press the **OK** button to confirm. The selected channel moves to its new position. Repeat this procedure if you wish to move other channels. Press the **MENU** button to remove the 'Programme Sorting' menu from the TV screen when you have finished rearranging the channel order.

**The TV has now tuned in all the available channels and is ready for use**

Selecting your language.



Selecting your country.



The picture rotation prompt.



The autotune prompt screen.



# 5

## Basic overview of the remote control

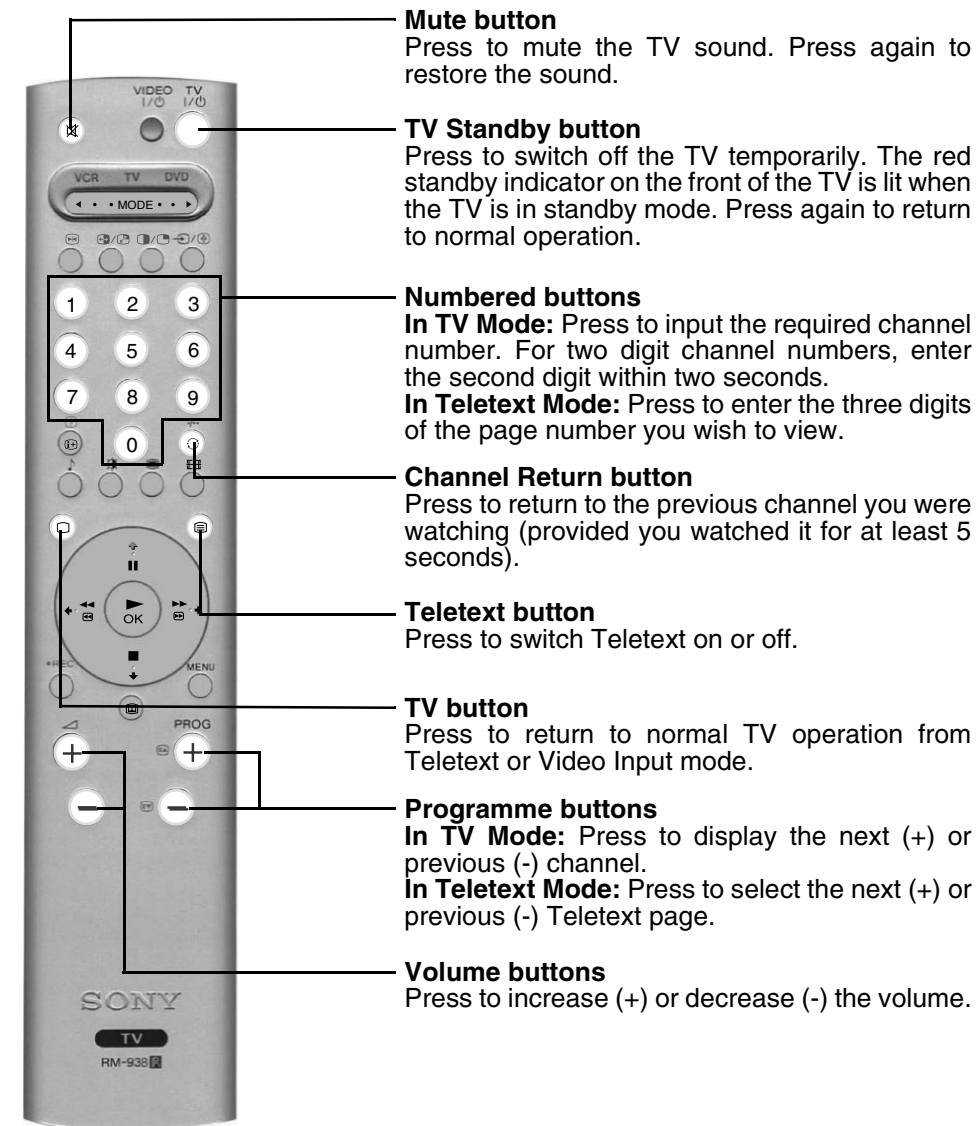

### Mute button

Press to mute the TV sound. Press again to restore the sound.

### TV Standby button

Press to switch off the TV temporarily. The red standby indicator on the front of the TV is lit when the TV is in standby mode. Press again to return to normal operation.

### Numbered buttons

**In TV Mode:** Press to input the required channel number. For two digit channel numbers, enter the second digit within two seconds.

**In Teletext Mode:** Press to enter the three digits of the page number you wish to view.

### Channel Return button

Press to return to the previous channel you were watching (provided you watched it for at least 5 seconds).

### Teletext button

Press to switch Teletext on or off.

### TV button

Press to return to normal TV operation from Teletext or Video Input mode.

### Programme buttons

**In TV Mode:** Press to display the next (+) or previous (-) channel.

**In Teletext Mode:** Press to select the next (+) or previous (-) Teletext page.

### Volume buttons

Press to increase (+) or decrease (-) the volume.

Please refer to the main instruction manual for a complete overview of the remote control.

# 6

## Watching a video tape

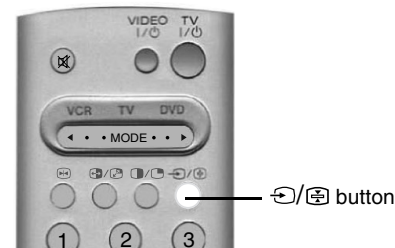

Providing that you have used a fully wired 21 pin scart lead to connect the VCR to the TV:

- With a video tape inserted into the VCR, press the 'PLAY' button on the VCR. The TV automatically displays the video picture.
 

If the video picture does not appear, press the **◀/▶** button on the remote control repeatedly until the video picture is displayed on the TV screen.
  - Press the **□** (TV) button on the remote control to return to normal viewing.
- Note:** If you have not used a scart lead to connect your VCR you must select the channel you have manually tuned the VCR to in order to view pictures from the VCR.

## Congratulations!

You can now use your TV for everyday viewing.

Additionally, your TV has many advanced features.

Please refer to the main instruction manual for full details.

