



DS72

Digital Spread Spectrum

provides the longest range,

the clearest sound

and the best privacy.

OWNER'S MANUAL

Uniden

CONTENTS

OF YOUR OWNERS MANUAL

CONTENTS

Precautions	2
Important Safety Instructions	3
Important Electrical Considerations	4
Introduction	
Welcome	6
Features	6
Included In Your Package	7
Installing and Adjusting your Phone	
Installation Considerations	8
Desk/Tabletop Installation	9
Wall Installation	10
Installing the Handset Battery Pack	14
Charging the Battery Pack	15
Cleaning the Battery Contacts	16
Adjusting the Volume Controls	17
Adjusting the Ringer Tone	17
Installing the Beltclip	18
Headset Installation	19
Automatic Digital Code Security	19
Using Your New Phone	
Making and Receiving Calls	20
Call Waiting	21
Hold	21
Mute	22
Intercom	22
Room Monitor	22
Call Transfer	22
Storing a Phone Number in Memory	23
Dialing a Number In Memory	24
Erasing a Stored Number from Memory	24
Chain Dialing	24
Travelling Out-Of-Range	25
PABX Connection	25
Troubleshooting	
Quick Reference Chart	26
Specifications	28
Warranty	29
Controls And Functions	30

Introduction

Installing and Adjusting

Using Your New Phone

Troubleshooting

Specifications

PRECAUTIONS

FOR YOUR PHONE

PRECAUTION

Before you read anything else, please observe the following:

Warning!

UNIDEN DOES NOT represent this unit to be waterproof.

To reduce risk of fire, electrical shock or damage to the unit, DO NOT expose this unit to rain or moisture.

Rechargeable Nickel-Metal Hydride Battery Warning

- This equipment contains a rechargeable Ni-MH battery.
- The rechargeable Ni-MH battery contained in this equipment may explode if disposed of in fire.
- Do not short-circuit the battery.
- Do not charge the rechargeable Ni-MH battery used in this equipment in any charger other than the one designed to charge this battery as specified in this the owner's manual. Using another charger may damage the battery or cause the battery to explode.



The exclamation point within an equilateral triangle is intended to alert the user of the presence of important operating and maintenance (servicing) instructions in the literature accompanying the appliance.

IMPORTANT SAFETY INSTRUCTIONS

When using your telephone equipment, these basic safety precautions should always be followed to reduced the risk of fire, electrical shock, and injury to persons:

1. Read and understand all instructions.
2. Follow all warnings and instructions marked on the product.
3. Unplug this product from the wall outlet before cleaning, and use a dry cloth, without liquid or aerosol cleaners.
4. Do not use this product near water; for example, near a bathtub, washbowl, kitchen sink or laundry tub, in a wet basement or near a swimming pool.
5. Do not place this product on an unstable cart, stand or table. The telephone may fall, causing serious damage to the unit.
6. This product should be operated only from the type of power source indicated on the marking label. If you are not sure of the type of power supply to your home, consult your dealer or local power company.
7. Do not allow anything to rest on the power cord. Do not locate this product where the cord will be damaged by persons walking on it.
8. Do not overload wall outlets and extension cords, as this can result in the risk of fire or electrical shock.
9. Never push objects of any kind into this product through cabinet slots, as they may touch dangerous voltage points or short out parts that could result in a risk of fire or electric shock. These slots and openings are provided for ventilation. Never spill liquid of any kind on the product.
10. To reduce the risk of electric shock, do not disassemble this product. Take it to qualified service personnel when service or repair work is required. Opening or removing covers may expose you to dangerous voltages or other risks. Incorrect reassembly can cause electric shock when the appliance is subsequently used.
11. Unplug this product from the wall outlet and refer servicing to qualified service personnel under the following conditions:
 - A. If the power supply cord is damaged or frayed.
 - B. If liquid has been spilled into the product.
 - C. If the product has been exposed to rain or water.
 - D. If the product does not operate normally when following the operating instructions. (Adjust only those controls that are covered by the operating

instructions. Improper adjustment of other controls may result in damage, and will often require extensive repair work by a qualified technician).

- E. If the product has been dropped, or the cabinet has been damaged.
 - F. If the product exhibits a distinct change in performance.
12. Do not use the telephone to report a gas leak in the vicinity of the leak.

Additional Battery Safety Precautions

Caution! To reduce the risk of fire or injury to persons by the battery, read and follow these instructions.

1. Use only the appropriate type and size battery pack specified in the owner's manual.
2. Do not dispose of the battery pack in a fire. The cell may explode.
3. Do not open or mutilate the battery pack. Release electrolyte is corrosive and may cause damage to the eyes or skin. It may be toxic if swallowed.
4. Exercise care in handling the battery in order not to short the battery with conducting materials such as rings, bracelets and keys.
5. Charge the battery pack provided with or identified for use with this product only in accordance with the instructions and limitations.
6. Observe proper polarity orientation between the battery pack and battery charger.

IMPORTANT ELECTRICAL CONSIDERATIONS

Unplug all electrical appliances when you know an electrical storm is approaching. Lighting can pass through your household wiring and damage any device connected to it. This phone is no exception.



Please do not attempt to unplug any appliance during an electrical storm.

Range

Your new phone is designed to achieve the maximum possible range by transmitting and receiving according to the highest specifications. We have rated this phone to operate at a maximum distance with the qualification that the range depends upon the environment in which the telephone is used. Many

factors limit range, and it would be impossible to include all the variables in our rating. The Maximum Range rating of this phone is meant to be used as a means of comparison against other range claims.

Telephone Line Problems

If you are having trouble with your telephone service, you must first disconnect your phone to determine if it is the cause of your problem. If you determine that it is the cause, you must leave it disconnected until the trouble has been corrected.



Under power failure, this telephone may not operate. Please ensure that a separate phone, not dependent on local power is available during emergencies.

Radio Interference

Radio interference may occasionally cause buzzing and humming in your cordless handset, or clicking noises in the base. This interference is caused by external sources such as TV, refrigerator, vacuum cleaner, fluorescent lighting or electrical storm. Your unit is NOT DEFECTIVE. If these noises continue and are too distracting, please check around your home to see what appliances may be causing the problem. In addition, we recommend that the base not be plugged into a circuit that also powers a major appliance because of the potential for interference. Be certain that the antenna on the unit is raised vertically.

Finally, it should be noted that some cordless telephones operate at frequencies that may cause interference to nearby TV's or VCR's. To minimise or prevent such interference, the base of the cordless telephone should not be placed near or on top of a TV or VCR. If interference is experienced, moving the cordless telephone farther away from the TV or VCR will often reduce or eliminate the interference.

More Than One Phone

Each telephone device that you connect draws power from the phone line. We refer to the power drawn as the device's Ringer Equivalence Number (REN). The REN is shown at the bottom part of your telephone. If you are using more than one phone or other device on the line, add up all the RENs. If the total is more than 3, your phones might not ring.

WELCOME

Congratulations on your purchase of the Uniden **DS72** cordless telephone. This phone is designed for reliability, long life, and outstanding performance utilising the latest in 900 MHz Digital Spread Spectrum Technology.

FEATURES

- 15 channels (Aust), 7 channels (NZ)
- 900 Digital MHz Spread Spectrum Technology
- Speakerphone
- Dual Keypad
- 40 Enhanced Memory Dial Locations (16 digits maximum per memory)
- 32 Digit Redial
- Redial, Flash, Pause, Mute and Hold
- Tone Dialing
- Call Waiting Compatible
- Page/Intercom system
- 14-Day Standby Battery Time
- 4-Hour Talk Time
- Handset Earpiece and Ringer Volume Control
- Hearing Aid Compatible
- Auto talk
- Auto Standby
- Any key Answer

Digital Spread Spectrum Technology utilises a digital transmission and a “wider frequency band” compared to a “single narrow band” 30/39 Standard Analogue transmission. The result is a more secure conversation with the clarity of digital sound, extended range, and minimal interference from other cordless phones.

Random Code™ digital security automatically selects one of over 16 million codes for the handset and base. This feature prevents unauthorised calls as a result of your phone being activated by other equipment.

INCLUDED IN YOUR PACKAGE

TIP

To get the most from your phone, please read this owner's manual thoroughly. Be sure to complete and mail the product registration form.

NOTE

If any of these items are missing or damaged, contact your place of purchase.



Handset

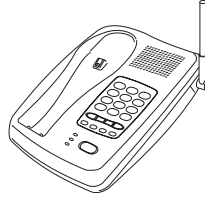

Base



Rechargeable Battery

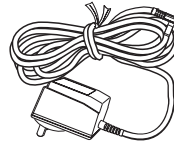

AAD 900S
AC Adaptor

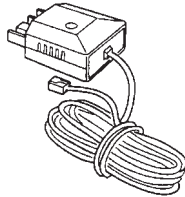

Long Telephone
Cord/Plug



Wall Mount Adaptor

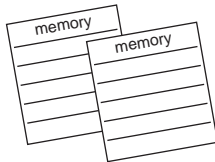

2 x Memory Stickers

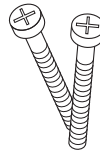

Wall Mounting Screws



Belt Clip

- This Owner's Manual
- Registration Card
- and other printed materials

INSTALLATION CONSIDERATIONS

▼ *Selecting a Location*

Before choosing a location for your new phone, here are some important guidelines you should consider:

- The location should be close to both a phone jack and a power outlet.
- Keep the base and handset away from sources of electrical noise such as motors and fluorescent lighting.
- Be sure there is sufficient space to rotate the base antenna fully vertical.
- The base can be placed on a desk, tabletop or mounted on a standard wall plate.
- You should charge the battery in your handset for 15-20 hours before connecting the phone line.
- Most phone equipment available now uses modular jacks. Phone cords are fitted with a molded plastic connector which plugs into this type of jack. If you do not have a modular phone jack, contact your local telephone company for information about their installation.



▼ *Connecting the Telephone Cords*

Consider these safety guidelines before connecting the telephone cord.

Caution!

- Never install telephone wiring during a lightning storm.
- Never touch uninsulated telephone wires or terminals unless the telephone line has been disconnected.
- Use caution when installing or modifying telephone lines.

NOTE

Before connecting your phone line, fully charge the Nickel- Metal Hydride battery pack for 15-20 hours.

DESK/TABLETOP INSTALLATION

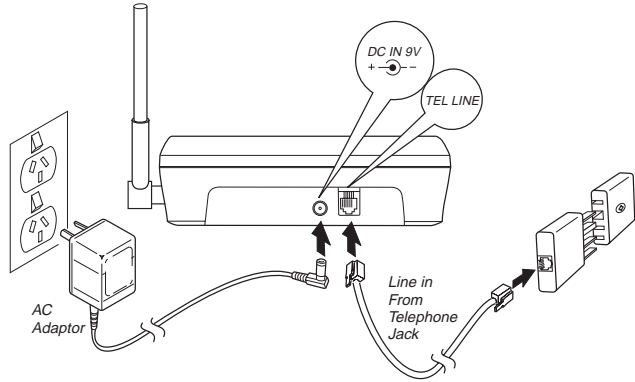

1. Plug the AC adaptor cord into the **9V DC** input jack on the back of the base.
2. Plug the AC adaptor into a standard 240V AC wall outlet.
3. Charge the battery (See **CHARGING THE BATTERY PACK**, page 15).
4. Plug one end of the telephone cord into the **TEL LINE** jack on the back of the base.
5. Plug the other end of the cord into the telephone jack on the wall.
6. Set the base on a desk or tabletop with the keypad facing up or down then place the handset into the base. Raise the antenna to a vertical position.

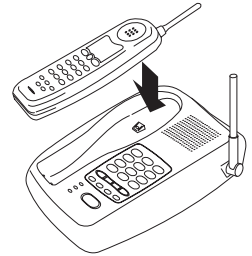

Place the power cord so that it does not create a trip hazard or where it could become chafed and create a fire or electrical hazard.



Use only the Uniden AC adaptor supplied with this phone plugged to uninterrupted power supply.

WALL INSTALLATION

▼ *Standard wall plate mounting*

This phone can be mounted on any standard wall plate.

1. Snap the wall mount adaptor into the bottom of the base as shown.
2. Plug the AC adaptor into the base.
3. Place the AC adaptor cord inside the wall mount adaptor slots.
4. Plug the AC adaptor into a standard 240V AC wall outlet.
5. Plug one end of the short telephone cord (not supplied) into the **TEL LINE** jack on the back of the base. Plug the other end into a standard telephone jack.

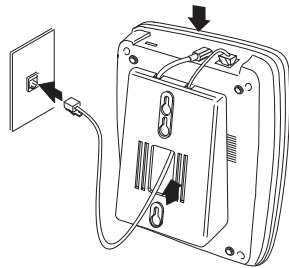
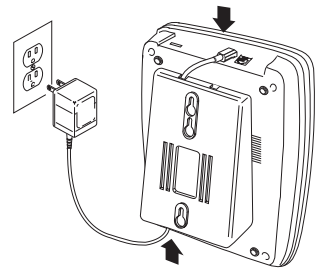
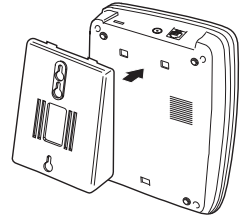

Place the power cord so that it does not create a trip hazard or where it could become chafed and create a fire or electrical hazard.



Use only the Uniden AC adaptor supplied with this phone plugged to uninterrupted power supply.



Before you plug the other end of the telephone cord into the modular jack on the wall, charge the battery (See CHARGING THE BATTERY PACK, page 15).

6. Align the mounting slots on the base with the mounting posts on the wall. Push in and down until the phone is firmly seated.

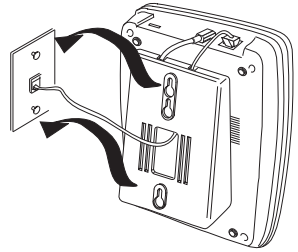

7. On the base, pull the handset retainer out of the slot. Rotate clockwise 180°.

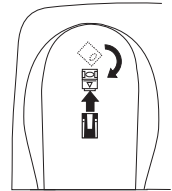

8. Flip the retainer from front to back. Slide it back into the slot so that the lip of the retainer is (arrow on the retainer must be pointing down). The retainer holds the handset in place.

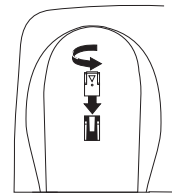

▼ *Direct wall mounting*

If you don't have a standard wall plate, you can mount your phone directly to the wall. Before doing this, consider the following:

- Select a location away from electrical cables, pipes, or other items behind the mounting location that could cause a hazard when inserting the screws into the wall.
- Mount your phone near a working phone jack to avoid excessive cord lengths
- Make sure the wall material is capable of supporting the weight of the base and the handset.



Be careful not to insert the mounting screws into possible electrical hazards such as cables, wiring, or pipes.

1. Insert two mounting screws (with their appropriate anchoring device) into the wall 100mm apart. Allow about 5mm between the wall and screw heads for mounting the phone.

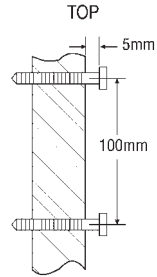

2. Snap the desktop/wall mount adaptor into the bottom of the base as shown.

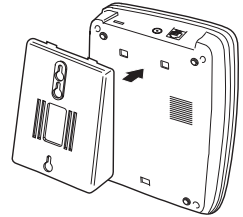

3. Plug the AC adaptor cord into the 9V DC input jack on the back of the base.

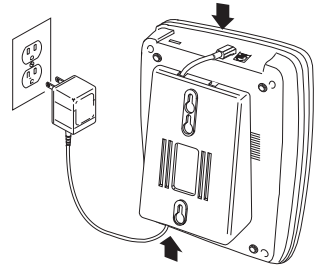

4. Put the AC adaptor cord inside the wall mount adaptor. Plug the AC adaptor into a standard 240V AC wall outlet.

5. Plug one end of the telephone cord into the **TEL LINE** jack on the back of the base. Plug the other end into a telephone jack.

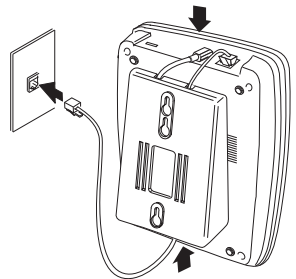

- Align the mounting slots on the base with the mounting screws on the wall. Push in and down until the phone is firmly seated.

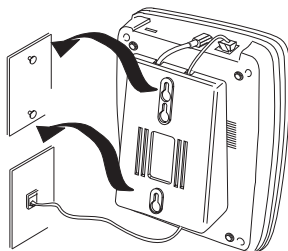

- On the base, pull the handset retainer out of the slot. Rotate clockwise 180°.

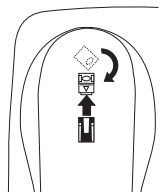

- Flip the retainer from front to back. Slide it back into the slot so that the lip of the retainer is up (arrow on the retainer clip must be pointing down). The retainer holds the handset in place.

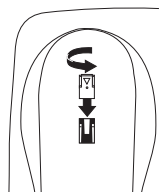

INSTALLING THE HANDSET BATTERY PACK



Use only Uniden Battery supplied with your phone.

1. Press battery cover release.
Slide cover off.

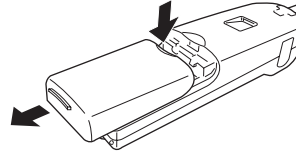

2. Align the plastic connector of the Nickel Metal Hydride battery with its socket and plug it in.

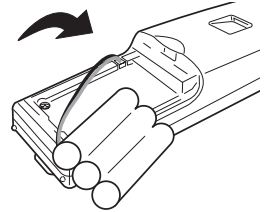

3. Place the battery pack inside.
Please observe how the lead is positioned.

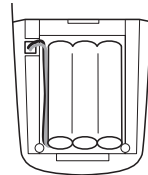

4. Slide the battery cover forward until it snaps into place

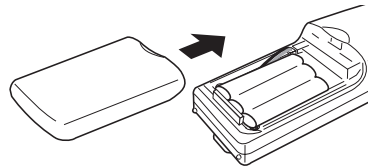

CHARGING THE BATTERY PACK

▼ *Initial battery charging*

Before connecting your the phone for the first time, fully charge the rechargeable battery pack for 15-20 hours without interruption.

1. Place the handset on the base (facing up or down).
2. Make sure that **charge** LED lights. If the LED doesn't light, be sure the AC adaptor is plugged in and the handset makes good contact with the base charging contacts.

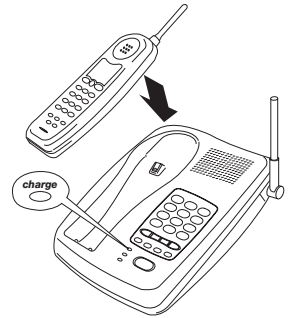

▼ *Low battery indicator*

The low battery indicator shows when the battery pack is very low and needs to be charged. If the phone is not in use, the **batt low** LED flashes every four seconds. If the phone is in use, the **batt low** LED flashes every four seconds and the handset beeps. Complete your conversation as quickly as possible and return the handset to the base for charging.

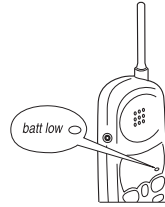

CLEANING THE BATTERY CONTACTS

To maintain a good charge, clean all charging contacts on the handset and base about once a month. Use a pencil eraser or other contact cleaner. DO NOT use liquids or solvents; you may damage your phone.

ADJUSTING THE VOLUME CONTROLS

▼ Handset ringer volume

Press the **vol ▲** or **▼** key on the handset to set the handset ringer volume. There are two ringer volume settings; high and low.

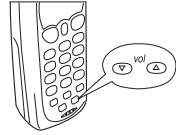

▼ Handset earpiece volume

There are four volume settings for the handset earpiece; max., high, low and min. **The handset earpiece volume can be adjusted only during a call.**

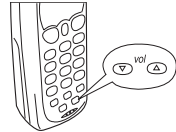

To lower the volume, press **vol ▼**. To raise the volume, press **vol ▲**.

The volume will remain on the same setting when you hang up.

ADJUSTING RINGER TONE

1. Press **flash** button.
2. Press **1, 2, 3** or **4** on the keypad to select ringer tone.

Note: The procedure is the same for both the handset and base unit.

INSTALLING THE BELTCLIP

▼ *To attach the beltclip.*

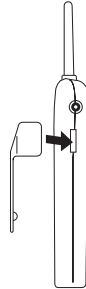

Insert the beltclip into the empty slot and press down until it clicks.



▼ *To remove the beltclip*

Pull back on the release tab and lift the beltclip up.



HEADSET INSTALLATION

Your phone may be used with an optional headset, the Uniden HS910/HS900. To use this feature, simply plug the headset into the headset jack. Your phone is ready for hands-free conversations.

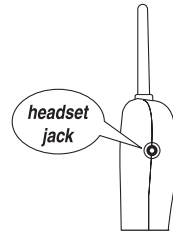

IMPORTANT

Use only the Uniden HS910/HS900 headset.



If you are using an optional headset, you must still use the handset keypad for phone operations.

NOTE

Keep the headset wire away from handset and base antennas.

AUTOMATIC DIGITAL CODE SECURITY

To prevent other parties from making unauthorised calls on your phone line, a digital code was added to the DS72. Your phone's handset and base share this code. This code is randomly set each time you place the handset in the base. If the phone experiences a power failure, you must reset the digital security code by placing the handset on the base.

▼ *To reset the digital security code*



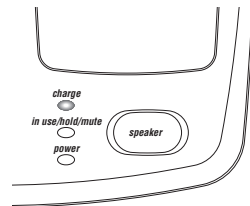



1. Restore power to the base.
2. Place the handset on the base.
talk (on the handset) and **in use/hold/mute** (on the base) LEDs momentarily blinks. The digital security code is reset.

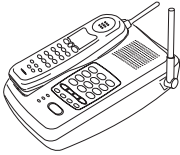

MAKING AND RECEIVING CALLS

▼ Basic phone operation

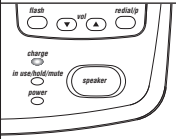
Refer to the CONTROLS & FUNCTIONS diagram at the back of this Owner's Manual.

	Handset On Base	Handset Off Base	Base Only
			
To answer a call	Pick up handset.	 <p>Press talk.</p>	 <p>Press speaker.</p>
To make a call	<ol style="list-style-type: none"> 1. Pick up the handset. 2. Press talk. 3. Listen for the dial tone. 4. Dial the number. 	<ol style="list-style-type: none"> 1. Press talk. 2. Listen for the dial tone. 3. Dial the number. 	<ol style="list-style-type: none"> 1. Press speaker. 2. Listen for the dial tone. 3. Dial the number.
To hang up	Press talk , or return the handset to the base (AutoStandby).		Press speaker .
To redial	<ol style="list-style-type: none"> 1. Pick up the handset. 2. Press talk. 3. Listen for the dial tone. 4. Press redial. <p>Note: If any key is pressed before redial, the last number dialed will not redial.</p>	 <ol style="list-style-type: none"> 1. Press talk. 2. Listen for the dial tone. 3. Press redial. 	<ol style="list-style-type: none"> 1. Press speaker. 2. Listen for the dial tone. 3. Press redial.



When using a headset on DS72, an ACA approved headset is required.

NOTE

The **c.wait** procedure toggles between the incoming and original call (vice versa). The **c.wait** procedure will drop the current call and pick up the incoming call or call on hold.

NOTE

The **flash + 2** call waiting procedure toggles between the incoming and original call (and visa versa).

The **flash + 1** procedure will drop the current call connection and pick up the incoming call on hold.

NOTE

In New Zealand you must subscribe to Telecom's Call Waiting Service before you can use this feature.

CALL WAITING

▼ For Australian Version

Using the c.wait feature

Please call your local telephone service provider to check the availability of this service in your area.

1. While talking you hear the Call Waiting signal.
2. Press **c.wait** button.
3. The existing call is placed on hold.
4. Talk to the second caller.
5. Press **talk** button to end the current call.
6. The phone will ring back indicating that the first caller is still on hold.
7. Press **talk** button to answer this call.
8. Press **talk** button to end the call.

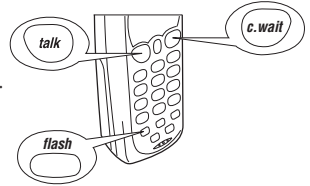

Using the Flash Key

To access Telstra's Call Waiting Service, you can either use the **c.wait** button or the **flash** key.

1. While talking you hear the Call Waiting signal.
2. Press **flash** then **2** to switch call and put the current call on hold.
3. To switch back to your original call, press **flash** then **1**.

▼ For New Zealand Version

Using the c.wait or flash key

1. While talking you hear the Call Waiting beep signal.
2. Press **c.wait** or the **flash** key. This feature sends a 600ms timed "hook-flash" on the telephone line for accessing services such as Call Waiting etc.

HOLD

To use the hold feature during a conversation, press **hold**. Both parties will not be able to hear. To disable the hold feature, press **hold** again.

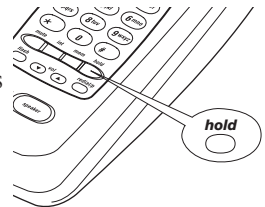

MUTE

To use the mute feature during a conversation, press **mute**. The other party will not be able to hear you although you can hear them. To disable the mute feature, press **mute** again.

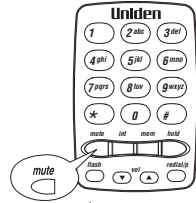

INTERCOM

▼ *Intercom from the Base Unit*

1. Press **int** on the base unit. (If there is no answer press **int** again to disconnect).
2. Press **int** on the handset to answer the intercom.
3. Speak into the mouthpiece.
4. To turn off the intercom, press **int** on the base unit.

-OR-

Press **int** on the handset.

ROOM MONITOR

You may use the **DS72** handset to monitor activity near the base unit without anyone present at the base unit.

To turn Room Monitoring on:

1. Press **int** on the handset.
2. There is a beep sound from the base unit then automatically two-way communications are now set up between the base unit and the handset.
3. To turn monitoring off, press **int** on the handset.

CALL TRANSFER

▼ *Transferring a call from the Handset to the Base Unit*

When a phone call is answered at the handset, you can transfer the call to the base unit.

1. During a call, press **int** on the handset, the call is placed on hold automatically and the base unit is paged. (If there is no answer press **int** again to return to the call).
2. At the base unit, press **int** to answer the page. An intercom link is now established between the handset and the base unit. Speak into the microphone.

3. Press **speaker** on the base unit to establish communications between the calling party.

▼ **Transferring a call from the Base Unit to the Handset**

1. During a call, press **int** on the base unit, the call is placed on hold automatically and the handset is paged. (If there is no answer press **int** again to return to the call on hold).
2. At the handset, press **int** to answer the page. An intercom link is now established between base unit the and the handset. Speak into the microphone.
3. Press **talk** on the handset to establish communications.

STORING A PHONE NUMBER IN MEMORY

▼ **Entering Handset Memory Numbers**

1. Remove the handset from the base.
2. Press **mem**. The **talk** LED blinks.
3. Enter the phone number, up to 16 digits.
If a pause is needed during dialing to access long distance service, press **redial/p** to insert a pause.
4. Press **mem** again.
5. Enter the memory location (01-20) on the keypad. A tone indicates that the number is stored.

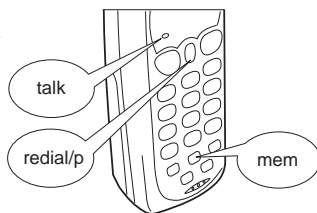

The pause button count as one digit. Pressing **redial/p** more than once increases the length of pause between numbers.

▼ **Entering Base Unit Memory Numbers**

1. Press **mem**. The **in use/hold/mute** LED blinks.
2. Enter the phone number, up to 16 digits.
If a pause is needed during dialing to access long distance service, press **redial/p** to insert a pause.
3. Press **mem** again.
4. Enter the memory location (01-20) on the keypad. A tone indicates that the number is stored.

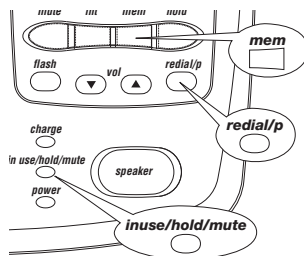

DIALING A NUMBER IN MEMORY

▼ *Using the memory location features*

1. Press **talk** on handset or **speaker** on the base Unit
2. Press **mem**.
3. Enter the memory location (01-20). The number automatically dials.

ERASING A STORED NUMBER FROM MEMORY

1. Remove the handset from the base unit.
2. Press **mem** button twice.
3. Press the memory location (01-20) to be erased.
A tone indicates that the stored number is erased from memory.

CHAIN DIALING

On certain occasions after dialing a number, you may be requested by the party or service you are calling to enter a special access code, such as when performing a banking transaction. To store this number, refer to “Storing Memory Dial Numbers” on page 22.

▼ *From the Handset*

For example, if your bank’s telephone number is stored in handset memory location 3, and your account number is stored in handset memory location 4:

1. Press **talk** on the handset.
2. Press **mem** on the handset and number **3** on the handset keypad.
3. At the appropriate time, press **mem** and number **4** on the handset keypad.
4. Your handset dials the number and you may proceed with your transaction.

▼ *From the Base Unit*

For example, if your bank’s telephone number is stored in base unit memory location 3, and your account number is stored in handset memory location 4:

1. Press **speaker** on the base unit.
2. Press **mem** on the base unit and number **3** on the base unit keypad.

3. At the appropriate time, press **mem** and number **4** on the base unit keypad.
4. Your base unit dials the number and you may proceed with your transaction.

TRAVELLING OUT-OF-RANGE

As you begin to move too far from the base, you will first hear a clicking sound. As you travel further, the noise increases. If you travel out-of-range, your call terminates.



NOTE

Check with your PABX supplier if you are not sure whether your PABX network uses Analogue or Digital interface.

PABX CONNECTION

The DS72 telephone may work with a 2-wire Analogue PABX network. However, with the DS72 hook-flash timing fixed at 100msec, some PABX equipment that uses a different hook flash timing may have its special feature (i.e. placing a call on hold or transferring a call) inaccessible.

QUICK REFERENCE CHART

If your phone is not performing to your expectations, please try these simple steps first before calling Uniden customer service.

PROBLEM	SUGGESTION
The charge light won't come on when the handset is placed on the base.	<ul style="list-style-type: none"> • Make sure the AC adaptor is plugged into the base and wall outlet. • Make sure the handset is properly seated in base. • Make sure the charging contacts on the handset and base are clean.
The audio sounds weak and/or scratchy	<ul style="list-style-type: none"> • Make sure that the base antenna is in a vertical position. • Move the handset and/or base to a different location away from metal objects or appliances and try again.
Can't make or receive calls.	<ul style="list-style-type: none"> • Check both ends of the base telephone line cord. • Make sure the AC adaptor is plugged into the base and wall outlet. • Disconnect the AC adaptor for a few minutes, then reconnect it. • Place the handset back on the charging cradle for a few seconds. The talk and in use/hold/mute LEDs blink momentarily indicating that the phone has been reset.
The handset doesn't ring or receive a page.	<ul style="list-style-type: none"> • The Ni-MH battery pack may be weak. Charge the battery for 15-20 hours. • Be sure the antenna is in a vertical position. • The handset may be too far away from the base. Place the base away from appliances or metal objects. • Place the handset back on the charging cradle for a few seconds. The in use LED lights indicating that the phone has been reset. • You may have exceeded the REN limit. See MORE THAN ONE PHONE on page 5.

PROBLEM	SUGGESTION
No dial tone.	<ul style="list-style-type: none"> • Check the telephone line cord connectors at both ends that they are pushed in firmly until they click. • If you had a power failure or had unplugged the base unit, replace the handset on the base unit for two to five second to reset the system.
Does not ring.	<ul style="list-style-type: none"> • You may have exceeded the Ringer Equivalence Number (REN) limit of how many phones can be connected to the same line. The REN total of all devices (printed on the label on the bottom of each unit) should not exceed three (3). Disconnect the appropriate units to lower the REN total.
No power on handset unit	<ul style="list-style-type: none"> • Check the Ni-MH battery pack connection inside the main battery compartment on the handset. • The handset rechargeable Ni-MH battery pack may need to be charged.
Does not charge	<ul style="list-style-type: none"> • Make sure the charging contacts on both the base unit and the handset are in contact during charging. • The charging contacts may need to be cleaned. Refer to page 4 or page 15. • The Ni-MH battery pack may need to be discharged first before a full charge.
Range is limited	<ul style="list-style-type: none"> • Raise or reposition the antenna on the base or handset. • Move the base unit so that it is centrally located in your residence or office and make sure that the base unit is not located near appliances.
Calls received flutters or fades	<ul style="list-style-type: none"> • The handset rechargeable Ni-MH battery pack may need charging. • You may be out of normal operating range. Move closer to the base unit.
Cannot store or recall phone numbers from memory	<ul style="list-style-type: none"> • When storing phone numbers, make sure that the handset is in the standby position. • When recalling stored phone numbers, check first for a dial tone. • Always use two digits when entering/recalling memory index numbers.

GENERAL

Australian Specification: The DS72 complies with TS001, TS002, TS004, AS/NZS 3260 and FCC Part 15 (as per ACA Radio Communications Class Licensing Requirements).

New Zealand Specification: The DS72 complies with PTC200, RFS 29.

Frequency control: PLL

Modulation: Direct Sequence Spread Spectrum; DBPSK

Operating temperature: 0° to +50° C

BASE UNIT

Frequency: 917.4 to 925.8 MHz (15 channels: Australia)

Frequency: 923.4 to 927.0 MHz (7 channels: New Zealand)

Power requirements: 9V 300mA (from AC adaptor)

Size: 152mm (W) x 183mm (H) x 53.5mm (D)

Weight: Approx. 400g

HANDSET

Frequency: 917.4 to 925.8 MHz (15 channels: Australia)

Frequency: 923.4 to 927.0 MHz (7 channels: New Zealand)

Power requirements: Rechargeable NiMH battery pack

Size (without antenna): 50mm (W) x 154mm (H) x 27.5mm (D)

Weight: Approx. 136g (including battery)

Battery: Capacity 550 mAh, 3.6V

Talk mode 4 hours

Standby mode 14 days

Specifications, features, and availability of optional accessories are all subject to change without prior notice.

WARRANTY

One Year Limited Warranty

Important: Evidence of original purchase is required for warranty service.

Warrantor: Uniden Australia Pty Limited ACN 001 865 498
Uniden New Zealand Limited

ELEMENT OF WARRANTY: Uniden warrants to the original retail owner for the duration of this warranty, its DS72 (herein after referred to as the Product), to be free from defects in materials and craftsmanship with only the limitations or exclusions set out below.

WARRANTY DURATION: This warranty to the original retail owner only, shall terminate and be of no further effect 12 months after the date of original retail sale. This warranty will be deemed invalid if the product is; (A) Damaged or not maintained as reasonable and necessary, (B) Modified, altered or used as part of any conversion kits, subassemblies, or any configurations not sold by Uniden, (C) Improperly installed, (D) Repaired by someone other than an authorised Uniden Repair Agent for a defect or malfunction covered by this warranty, (E) Used in conjunction with any equipment or parts or as part of a system not manufactured by Uniden.

PARTS COVERED: This warranty covers for one (1) year, the Base/Charging Unit and Handset only. All accessories (AC Adaptor, Wall mount bracket etc) are covered for 90 days only.

STATEMENT OF REMEDY: In the event that the product does not conform to this warranty at any time while this warranty is in effect, the warrantor at its discretion, will repair the defect or replace the product and return it to you without charge for parts or service. THIS WARRANTY DOES NOT COVER OR PROVIDE FOR THE REIMBURSEMENT OR PAYMENT OF INCIDENTAL OR CONSEQUENTIAL DAMAGES. THIS GUARANTEE IS IN ADDITION TO AND DOES NOT IN ANY WAY AFFECT YOUR RIGHTS UNDER THE CONSUMER GUARANTEE ACT.

WARRANTY CARD: If a warranty card has been included with this product then please fill it in and return to us within 14 days of purchase. Your name and the Serial number of the product will then be registered in our database and this will help us process your claim with greater speed and efficiency should you require warranty service.

PROCEDURE FOR OBTAINING PERFORMANCE OR WARRANTY: In the event that the product does not conform to this warranty, the Product should be shipped or delivered, freight pre-paid, with evidence of original purchase (eg. a copy of the sales docket), to the warrantor at:

UNIDEN AUSTRALIA PTY LIMITED
SERVICE DIVISION
345 Princes Highway,
Rockdale NSW 2216
Ph (02) 9599 3577 Ex (02) 9599 3278
Toll Free 1300 366 895

UNIDEN NEW ZEALAND LIMITED
SERVICE DIVISION
150 Harris Road,
East Tamaki, Auckland
Ph (9) 273 8383 Ex (9) 274 4253
Toll Free 0800 4 UNIDEN
4 864 336

Customers in other States should ship or deliver the Product freight pre-paid to their nearest Uniden Authorised Repair Centre (Contact Uniden for the nearest Warranty Agent to you)

WARRANTY

CONTROLS & FUNCTIONS

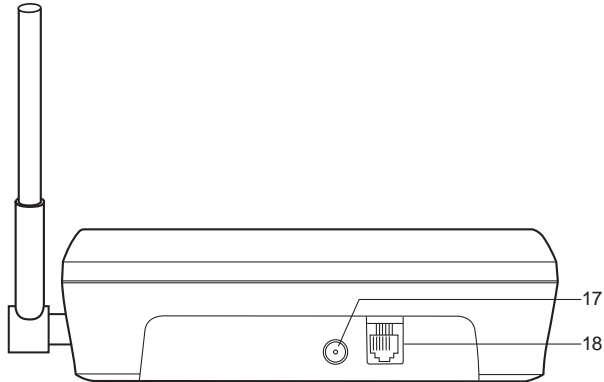

- | | |
|---------------------------|--------------------------|
| 1. Headset Jack | A. Speaker Button |
| 2. Battery Compartment | B. Base Microphone |
| 3. Handset Antenna | C. Power LED |
| 4. Talk Button | D. In use/Hold/Mute LED |
| 5. Redial/Pause Button | E. Charge LED |
| 6. Talk LED | F. Redial/Pause Button |
| 7. Battery Low LED | G. Volume Up/Down Button |
| 8. Call Waiting Button | H. Flash Button |
| 9. Numeric Keypad | I. Mute Button |
| 10. Flash Button | J. Int Button |
| 11. Int Button | K. Star Button |
| 12. Mem Button | L. Hold Button |
| 13. Volume Up/Down Button | M. Mem Button |
| 14. Handset Microphone | N. Hash Button |
| 15. Hash Button | O. Numeric Keypad |
| 16. Star Button | P. Speaker |
| 17. DC in 9V | Q. Handset Retainer |
| 18. Tel Line | |

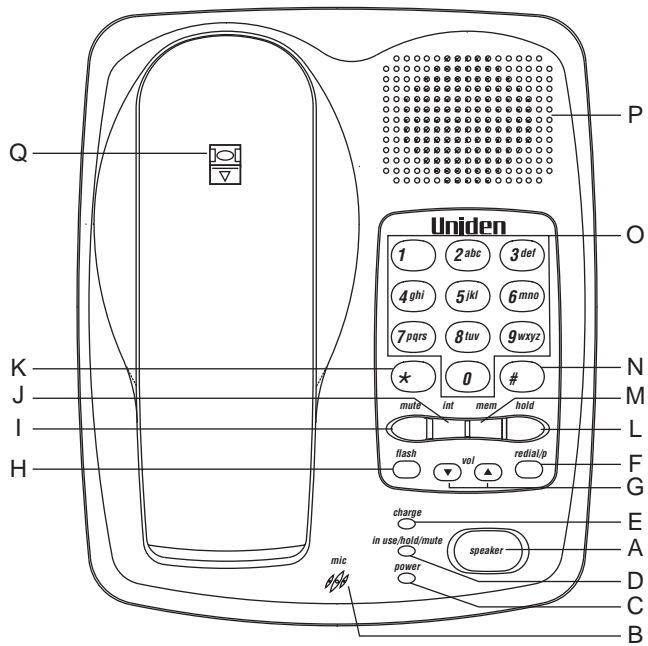
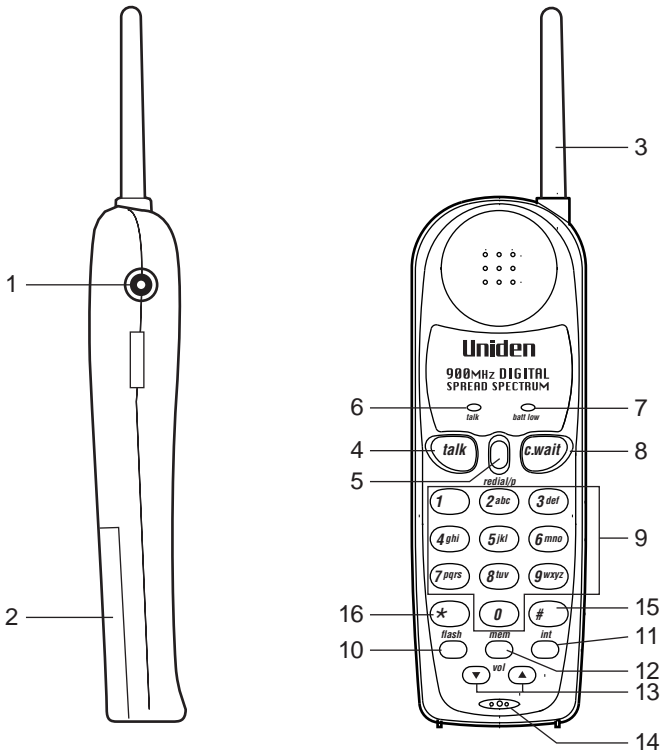

THANK YOU

FOR PURCHASING A UNIDEN PHONE!

Uniden

© 2000 Uniden Australia Pty Limited
Uniden New Zealand Limited