



MOTOROLA

intelligence everywhere™

SD4505

Wireless Cell Dock



User Guide

For a large-print version of this guide, or for product-related questions, visit us online at:

www.motorola.com/cordless

Or phone us at:

•1-800-353-2729 U.S.A.

•1-800-461-4575 Canada

•1-888-390-6456 TTY (Text Telephone)

Copyright © 2005 Motorola, Inc.

All rights reserved. No part of this publication may be reproduced in any form or by any means or used to make any derivative work (such as translation, transformation or adaptation) without written permission from Motorola, Inc.

Motorola reserves the right to revise this publication and to make changes in content from time to time without obligation on the part of Motorola to provide notification of such revision or change. Motorola provides this guide without warranty of any kind, either implied or expressed, including but not limited to, the implied warranties of merchantability and fitness for a particular purpose. Motorola may make improvements or changes in the product(s) described in this manual at any time.

MOTOROLA, and the Stylized M Logo, are registered in the U.S. Patent and Trademark Office. All other product or service names are the property of their respective owners.

Welcome

Congratulations on your purchase of a Motorola SD4505 Cell Dock accessory. Take a moment to ensure that your purchase includes each of the items pictured.

Product registration (US only) is an important step toward enjoying your new Motorola product. Registering helps us facilitate warranty service and permits us to contact you should your Motorola product require an update or other service. Registration is not required for warranty coverage. To register your product online, visit:

<https://broadbandregistration.motorola.com>

Product registration is not available in Canada.

Please retain your original dated sales receipt for your records. For warranty service of your Motorola Product, you will need to provide a copy of your dated sales receipt to confirm warranty status.

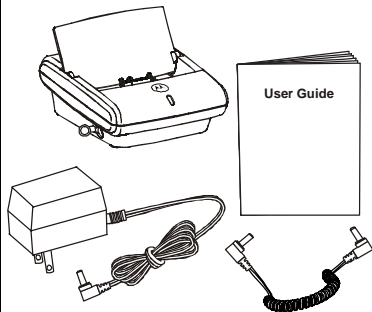

Cell Dock Overview

- 1 Dock Cover
- 2 Adjustable Seat
- 3 Page/Registration Button
- 4 Accessory Audio Port Cable
- 5 In Use/Charging LED
- 6 Power outlet

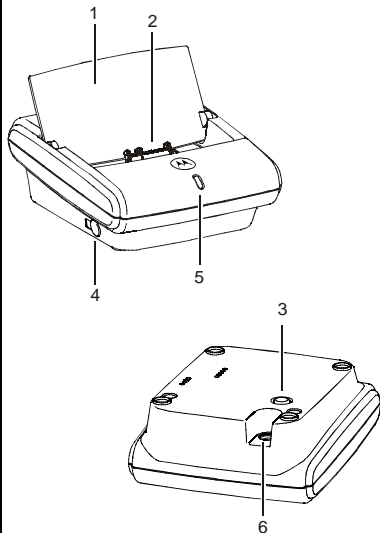

Table of Contents

Welcome	i
Cell Dock Overview	ii
Important Safety Instructions	v
Getting Started	1
Setting Up Your Cell Dock	1
Setting Up	3
Registering Your Cell Dock	3
Naming Your Cell Dock	5
Setting Ring Tones for Incoming Cell Calls	6
Using Your Cell Dock	7
Docking Your Cell Phone	7
Connecting to Your Cell Dock	7
Making a Call with Your Docked Cell Phone	8
Accessing Your Cell Phone's Contact List	9

Downloading Phonebook Entries	9
FCC Information	11
Industry Canada (IC) Information	15
Motorola Limited Warranty	20

Important Safety Instructions

Follow these safety precautions when using your cordless phone to reduce the risk of fire, electric shock and injury to persons or property:

To reduce the risk of fire and shock:

1. Keep all slits and openings of the phone unblocked. Do not set the phone on a heating register or over a radiator. Ensure that proper ventilation is provided at the installation site.
2. Do not use while wet or while standing in water.
3. Do not use this product near water (for example, near a bath tub, kitchen sink, or swimming pool).
4. Do not allow anything to rest on the power cord. Place the power cord so that it will not be walked on.
5. Never insert objects of any kind into the product slits as that may result in fire or shock.
6. Unplug this product from the wall outlet before cleaning. Do not use liquid cleaners or aerosol cleaners. Use a damp cloth for cleaning.

7. Do not disassemble this product. If service or repair work is required, contact the Motorola address found in the back of this user guide.
8. Do not overload wall outlets and extension cords.
9. Avoid using during an electrical storm. Use a surge protector to protect the equipment.
10. Do not use this cordless phone to report a gas leak, especially if you are in the vicinity of the gas line.

Unplug this cordless phone immediately from an outlet if:

- The power cord or plug is damaged or frayed.
- Liquid has been spilled into the product.
- The product has been exposed to rain or water. Do not retrieve the handset or base until after you have unplugged the power and phone from the wall. Then retrieve the unit by the unplugged cords.
- The product has been dropped or the cabinet has been damaged.
- The product exhibits a distinct change in performance.

Installation Guidelines

1. Read and understand all instructions and save them for future reference.
2. Follow all warnings and instructions marked on the product.
3. Do not install this product near a bath tub, sink, or shower.
4. Operate this phone using only the power source that is indicated on the marking label. If you are unsure of the power supply to your home, consult your dealer or local power company.
5. Do not place this product on an unstable cart, stand, or table. This product may fall, causing serious damage to the product.
6. Adjust only those controls that are covered by the operating instructions. Improper adjustment of other controls may result in damage and will often require extensive work to restore the product to normal operation.
7. Clean this product with a soft, damp cloth. Do not use chemicals or cleaning agents.

8. Use only the power supply that came with this unit. Using other power supplies may damage the unit.
9. Because cordless phones operate on electricity, you should have at least one phone in your home that isn't cordless, in case the power in your home goes out.
10. To avoid interference to nearby appliances, do not place the base of the cordless phone on or near a TV, microwave oven, refrigerator, or VCR.

Getting Started

Setting Up Your Cell Dock

- 1 Select a location for your cell dock where you can transmit and receive a clear signal on your cell phone.

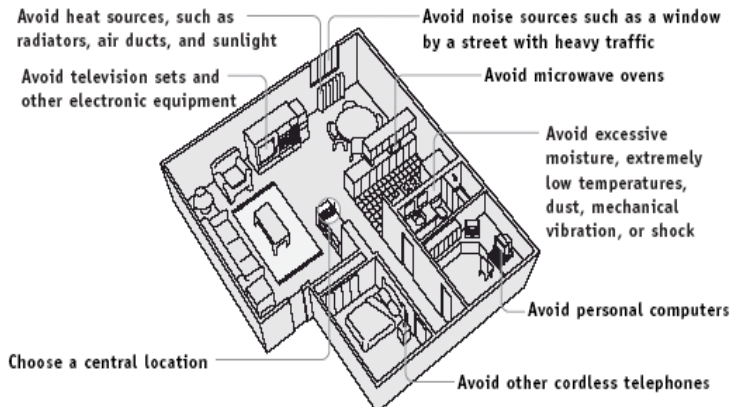

2 Insert the power cord into the base of the cell dock.

3 Plug power cord into power outlet. The In Use LED light on the front of the cell dock flashes red.

Note: Your cell dock does not require a phone cord or an active telephone line.

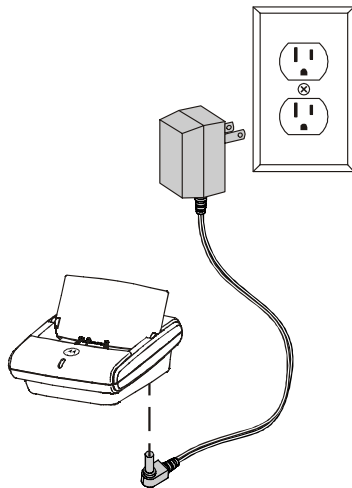

Setting Up

Registering Your Cell Dock

Before you can use your cell dock, you must register the device to your SD4500 series base unit.

You can register up to 8 devices (handsets, cameras, cell docks, etc.) to a base unit.

To register your cell dock:

- 1 Press and hold the **Page/Registration** button located on the bottom of the cell dock. Release the button when the cell dock's **In Use/Charging LED** light flashes red.
- 2 Press and hold the **Page** button on base unit. The **charge/page** and **In Use/Voice Mail** lights on the base unit flashes. The LED lights on the cell dock and base unit's stop flashing once the registration is complete.

To Check Registration:

- Press the **CONNECT TO** button on the handset.
- Scroll through the items listed to confirm that the device you registered is available.

Deregistering a Device

- 1 Listen to messages to clear the message waiting LED.
- 2 Press  on the base unit.
- 3 Press and hold down **PAGE** on the base unit until the **IN USE** indicator begins to flash slowly, and then release.
- 4 Press and hold down **PAGE** again until the **IN USE** indicator begins to flash quickly, and then release **PAGE**.
- 5 Quickly and fully press and release **PAGE** again.

Personalizing Your Cell Dock

Personalize your new cell dock by selecting a unique ring tone. Naming your cell dock helps you to distinguish it from other devices registered to your base unit.

Naming Your Cell Dock

When you register your cell dock, it is assigned a default name of **Cell Dock(X)**. The X represent the list of devices registered to the base unit (e.g., **Handset(1)**, **Camera(2)**, etc.). The number assigned at registration remains part of the name (e.g., **Kelly's Room(1)**).

- 1 Press **Menu**.
- 2 Scroll to and select **Setup Devices**.
- 3 Scroll to your cell dock and press softkey **SETUP**.
- 4 Scroll to and select **Name CellDock**.
- 5 Enter the new name using keypad (up to 14 characters). The flashing underline shows cursor position. Use **DELETE** to backspace and erase characters to left of cursor.

Setting Ring Tones for Incoming Cell Calls

If you are using your cell dock with your active landline telephone, you may wish to set a distinctive ring tone for incoming cell calls.

- 1 Press **MENU**.
- 2 Scroll to and select **Setup Devices**.
- 3 Scroll to **Cell Dock**, and press softkey **SETUP**.
- 4 Scroll to and select **Ringer Tone**.
- 5 Choose the desired ring tone.

Using Your Cell Dock

Docking Your Cell Phone

- 1 Place your Motorola Cell Phone in the seat of the cell dock.
- 2 Slide the adjustable seat to securely fit your cell phone. A solid red LED light indicates that your cell phone properly docked and charging. A solid green light indicates that your cell phone is connected to a call.

Notes: Some flip phones must remain open in order to use the cell dock.

Connecting to Your Cell Dock

- 1 Press the **CONNECT TO** button on the handset. All of the devices registered to your base unit are listed.
- 2 Scroll to and select the listing for your cell dock. The handset display screen reads, > **Cell Dock** <.

**** IMPORTANT ****

Turn on your cell phone if you wish to use it with your SD4500 Series Phone.

If your cell phone is turned off, it will only charge when placed in the cell dock.

Note: Use the “Default Device” setting in your SD4580 or SD4590 base unit, or any handset to make “Connect To Cell dock” permanent.

Making a Call with Your Docked Cell Phone

To make a call using your cordless handset while billing the call to your cell phone:

- 1 **CONNECT TO** your cell dock.
- 2 Enter the phone number.
- 3 Press  to dial the number.

Note: An active landline is not required to make a call using the cell dock.



Accessing Your Cell Phone's Contact List

You can access phone numbers stored in your cell phone with your Series 4500 handset.

- 1 **CONNECT TO** your cell dock.
- 2 Press **PHONEBK** using the left soft key.
- 3 Press **SHARED** using the right soft key.

Downloading Phonebook Entries

In addition to accessing phone numbers stored in your cell phone, you can also download the numbers to your cell dock. Your cell dock creates a new phonebook that you can access from your SD4580 or SD4590 base unit and/or any handset.

- 1 Press **Menu**.
- 2 Scroll to and select **Setup Devices**.
- 3 Scroll to your cell dock and press softkey **SETUP**.
- 4 Scroll to and select **Phonebk D/L**.

FCC Information

This equipment complies with Parts 15 and 68 of the FCC rules and the requirements adopted by the Administrative Council for Terminal Attachments (ACTA).

A plug and jack used to connect this equipment to the premises wiring and telephone network must comply with applicable FCC Part 68 rules and requirements adopted by the ACTA. A compliant telephone cord and modular plug is provided with this product. It is designed to be connected to a compatible modular jack that is also compliant. See installation instructions for details.

Notification of Local Telephone Company

On the bottom of this equipment is a label that contains, among other information, a product identifier in the form US:AAAEQ##TXXXX. You must, upon request, provide this information to your telephone company.

The digits represented by ## in the product identifier indicate the Ringer Equivalency Number (REN) for this equipment. The REN is useful in determining the number of devices you may connect to your telephone line and still have all of these devices ring when your telephone number is called. In most (but not all) areas, the sum of the RENs of all devices connected to one line should not exceed 5. To be certain of the number of devices you may connect to your line as determined by the REN, contact your local telephone company.

Note:

- This equipment may not be used on coin service provided by the telephone company.
- Connection to party line service is subject to state tariffs. Contact the state public utility commission, public service commission or corporation commission for information.
- If your home has specially wired alarm equipment connected to the telephone line, ensure the installation of this cordless phone does not disable your alarm equipment. If you have questions about what will disable alarm equipment, consult your telephone company or a qualified installer.
- Notice must be given to the telephone company upon permanent disconnection of your telephone from your line.
- The FCC requires that you connect your cordless telephone to the nationwide telephone network through a modular telephone jack (USOC RJ11C/RJ11W or RJ14C/RJ14W).

Rights of the Telephone Company

Should your equipment cause trouble on your line which may harm the telephone network, the telephone company shall, where practicable, notify you that temporary discontinuance of service may be required.

Where prior notice is not practical and the circumstances warrant such action, the telephone company may temporarily disconnect service immediately. In case of such temporary discontinuance, the telephone company must:

- Promptly notify you of such temporary discontinuance
- Afford you the opportunity to correct the situation

- Inform you of your right to bring a complaint to the Commission pursuant to procedures set forth in Subpart E of Part 68, FCC Rules and Regulations.

The telephone company may make changes in its facilities, equipment, operations, or procedures that could affect the operation of the equipment. If this happens, the telephone company will provide advance notice in order for you to make necessary modifications to maintain uninterrupted service.

Interference Information

This device complies with Part 15 of the FCC Rules. Operation is subject to the following two conditions:

This device may not cause harmful interference.

This device must accept any interference received, including interference that may cause undesired operation.

This equipment has been tested and found to comply with the limits for a Class B digital device, pursuant to Part 15 of the FCC Rules. These limits are designed to provide reasonable protection against harmful interference in a residential installation.

This equipment generates, uses, and can radiate radio frequency energy and, if not installed and used in accordance with the instructions, may cause harmful interference to radio communications. However, there is no guarantee that interference will not occur in a particular installation.

If this equipment does cause harmful interference to radio or television reception, which can be determined by turning the equipment on and off, the user is encouraged to try to correct the interference with one or more of the following measures:

- Reorient or relocate the receiving antenna (that is, the antenna for the radio or television that is "receiving" the interference).
- Reorient or relocate and increase the separation between the telecommunications equipment and the receiving antenna. Connect the telecommunications equipment into an outlet on a circuit different from that to which the receiving antenna is connected.

If these measures do not eliminate the interference, please consult your dealer or an experienced radio/television technician for additional suggestions. Also, the Federal Communications Commission has prepared a helpful booklet, "How to Identify and Resolve Radio/TV Interference Problems." This booklet is available from the U.S. Government Printing Office, Washington, D.C. 20402. Please specify stock number 004-000-00345-4 when ordering copies.

The FCC requires this product to be serviced only by Motorola or its authorized service agents.

CAUTION / WARNING: Changes or modifications not expressly approved by Motorola could void not only the user's authority to operate the equipment, but also the limited warranty.

Hearing Aid Compatibility

This telephone system meets the FCC standards for hearing aid compatibility.

Industry Canada (IC) Information

This equipment meets the applicable Industry Canada (IC) radio and terminal equipment technical specifications. This is confirmed by the certification/registration number found on the label on the bottom of the base unit. The abbreviation IC before the certification/registration number only signifies that registration was performed based on a Declaration of Conformity and that the Industry Canada technical specifications were met. It does not imply that Industry Canada approved the equipment. The term "IC:" before the certification/registration number only signifies that the Industry Canada technical specifications were met. The Ringer Equivalency Number (REN) for this equipment is located on the FCC/IC label on the telephone base unit. The REN is useful in determining the maximum number of devices you may connect to your telephone line and still have all of these devices ring when your telephone number is called. The sum of the RENs of all devices connected to one line may not exceed 5.

Before installing this cordless phone, you should make sure that it is permissible to be connected to the facilities of the local telecommunications company. The equipment must be installed using an acceptable method of connection. In some cases, the telecommunications company's inside wiring associated with a single line individual service may be extended by means of a certified connector assembly (telephone extension cord). You should be aware that compliance with the above conditions may not prevent degradation of service in some situations.

The plug and jack used to connect this equipment to the premises wiring and telephone network must comply with the rules and requirements in Industry Canada's CS-03. A compliant telephone cord and modular plug is provided with this product. It is designed to be connected to a compatible modular jack that is also compliant.

For your protection, ensure that the electrical ground connections of the power utility, telephone lines, and internal metallic water pipe system, if present, are connected together. This precaution may be particularly important in rural areas.

You should not attempt to make such connections yourself. Contact the appropriate electrical inspection authority or an electrician, as appropriate. If your home has specially wired alarm equipment connected to the telephone line, ensure the installation of this cordless phone does not disable your alarm equipment. If you have questions about what will disable alarm equipment, consult your telephone company or a qualified installer.

Repairs

Repairs to this equipment should be made by an authorized Canadian maintenance facility designated by Motorola. Any repairs or alterations made by the consumer, or any malfunctions of this equipment, may give the telecommunications company cause to request that you disconnect the equipment, and may void the limited warranty.

Privacy

Privacy of communications may not be ensured when using this telephone. Other devices, including other cordless telephones, may interfere with the operation of this cordless phone or cause noise during operation. Units without code access may be accessed by other radio communications devices.

Hearing Aid Compatibility

This telephone system meets Industry Canada standards for hearing aid compatibility.

Interference Information

This device complies with Industry Canada's RSS-210. Operation is subject to the following two conditions:

- (1) This device may not cause harmful interference; and
- (2) This device must accept any interference received, including interference that may cause undesired operation.

This equipment has been tested and found to comply with the limits for a Class B digital device, pursuant to Industry Canada's ICES-003. These limits are designed to provide reasonable protection against harmful interference in a residential installation.

This equipment generates, uses, and can radiate radio frequency energy and, if not installed and used in accordance with the instructions, may cause harmful interference to radio communications. However, there is no guarantee that interference will not occur in a particular installation.

If this equipment does cause harmful interference to radio or television reception, which can be determined by turning the equipment on and off, the user is encouraged to try to correct the interference with one or more of the following measures:

- Reorient or relocate the receiving antenna (that is, the antenna for radio or television that is "receiving" the interference).
- Reorient or relocate and increase the separation between the telecommunications equipment and the receiving antenna.
- Connect the telecommunications equipment into an outlet on a circuit different from that to which the receiving antenna is connected.

If these measures do not eliminate the interference, please consult your dealer or an experienced radio/television technician for additional suggestions.

Industry Canada publishes several publications to assist consumers with solving interference problems, which are available from its offices or from its web site (strategis.gc.ca).

Motorola Limited Warranty

Motorola Limited Warranty for Consumer Products, Accessories, and Software Purchased in the United States or Canada

What Does this Warranty Cover?

Subject to the exclusions contained below, Motorola, Inc. warrants its cordless telephones ("Products"), Motorola-branded or certified accessories sold for use with these Products ("Accessories"), and Motorola software contained on CD-ROMs or other tangible media and sold for use with these Products ("Software") to be free from defects in materials and workmanship under normal consumer usage for the period(s) outlined below. This limited warranty is a consumer's exclusive remedy, and applies as follows to new Motorola Products, Accessories and Software purchased by consumers in the United States or Canada, which are accompanied by this written warranty:

Products and Accessories as defined above, unless otherwise provided for below. Length of coverage: one (1) year from the date of purchase by the first consumer purchaser of the product unless otherwise provided for below.

- **Decorative Accessories and Cases.** Decorative covers, bezels, PhoneWrap® covers and cases. Length of coverage: limited lifetime warranty for the lifetime of ownership by the first consumer purchaser of the product.

- **Products and Accessories that are Repaired or Replaced.** Length of coverage: The balance of the original warranty or for ninety (90) days from the date returned to the consumer, whichever is longer.
- **Software.** Applies only to physical defects in the media that embodies the copy of the software (e.g. CD-ROM, or floppy disk). Length of coverage: ninety (90) days from the date of purchase.

Exclusions

Normal Wear and Tear. Periodic maintenance, repair and replacement of parts due to normal wear and tear are excluded from coverage.

Batteries. Only batteries whose fully charged capacity falls below 80% of their rated capacity and batteries that leak are covered by this limited warranty.

Abuse & Misuse. Defects or damage that result from: (a) improper operation, storage, misuse or abuse, accident or neglect, such as physical damage (cracks, scratches, etc.) to the surface of the product resulting from misuse; (b) contact with liquid, water, rain, extreme humidity or heavy perspiration, sand, dirt or the like, extreme heat, or food; (c) use of the Products or Accessories for commercial purposes or subjecting the Product or Accessory to abnormal usage or conditions; or (d) Acts of God or nature, or other acts which are not the fault of Motorola, are excluded from coverage.

Use of Non-Motorola Products and Accessories. Defects or damage that result from the use of Non-Motorola branded or certified Products, Accessories, Software or other peripheral equipment are excluded from coverage.

Unauthorized Service or Modification. Defects or damages resulting from service, testing, adjustment, installation, maintenance, alteration, or modification in any way by someone other than Motorola, or its authorized service centers, are excluded from coverage.

Altered Products. Products or Accessories with (a) serial numbers or date tags that have been removed, altered, or obliterated; (b) broken seals or that show evidence of tampering; (c) mismatched board serial numbers; or (d) nonconforming or non-Motorola housings, or parts, are excluded from coverage.

Communication Services. Defects, damages, or the failure of Products, Accessories or Software due to any communication service or signal you may subscribe to or use with the Products, Accessories or Software is excluded from coverage.

Software Embodied in Physical Media. No warranty is made that the software will meet your requirements or will work in combination with any hardware or software applications provided by third parties, that the operation of the software products will be uninterrupted or error free, or that all defects in the software products will be corrected.

Software NOT Embodied in Physical Media. Software that is not embodied in physical media (e.g. software that is downloaded from the internet), is provided "as is" and without warranty.

Who is Covered

This warranty extends to the first end-user purchaser, only.

What will Motorola Do?

Motorola, at its option, will at no charge repair, or replace any Products, Accessories or Software that does not conform to this warranty. We may use functionally equivalent reconditioned/refurbished/pre-owned or new Products, Accessories or parts. No data, software or applications added to your Product, Accessory or Software, including but not limited to personal contacts, games and ringer tones, will be reinstalled. To avoid losing such data, software and applications please create a back up prior to requesting service.

How to Get Warranty Service or Other Information

In the USA, call:

1-800-353-2729

TTY 1-888-390-6456

In Canada, call:

1-800-461-4575

TTY 1-888-390-6456

For accessories and software, please call the telephone number designated above for the product with which they are used. You will receive instructions on how to ship the Products, Accessories or Software, at your expense, to a Motorola Authorized Repair Center. To obtain service, you must include: (a) a copy of your receipt, bill of sale or other comparable proof of purchase; (b) a written description of the problem; (c) the name of your service provider, if applicable; (d) the name and location of the installation facility (if applicable), (e) your telephone number; and most importantly, your return mailing address on the outside of the returned unit.

What Other Limitations Are There?

ANY IMPLIED WARRANTIES, INCLUDING WITHOUT LIMITATION THE IMPLIED WARRANTIES OF MERCHANTABILITY AND FITNESS FOR A PARTICULAR PURPOSE, SHALL BE LIMITED TO THE DURATION OF THIS LIMITED WARRANTY, OTHERWISE THE REPAIR, OR REPLACEMENT AS PROVIDED UNDER THIS EXPRESS LIMITED WARRANTY IS THE EXCLUSIVE REMEDY OF THE CONSUMER, AND IS PROVIDED IN LIEU OF ALL OTHER WARRANTIES, EXPRESS OR IMPLIED. IN NO EVENT SHALL MOTOROLA BE LIABLE, WHETHER IN CONTRACT OR TORT (INCLUDING NEGLIGENCE) FOR DAMAGES IN EXCESS OF THE PURCHASE PRICE OF THE PRODUCT, ACCESSORY OR SOFTWARE, OR FOR ANY INDIRECT, INCIDENTAL, SPECIAL OR CONSEQUENTIAL DAMAGES OF ANY KIND, OR LOSS OF REVENUE OR

PROFITS, LOSS OF BUSINESS, LOSS OF INFORMATION OR DATA, SOFTWARE OR APPLICATIONS OR OTHER FINANCIAL LOSS ARISING OUT OF OR IN CONNECTION WITH THE ABILITY OR INABILITY TO USE THE PRODUCTS, ACCESSORIES OR SOFTWARE TO THE FULL EXTENT THESE DAMAGES MAY BE DISCLAIMED BY LAW. Some states and jurisdictions do not allow the limitation or exclusion of incidental or consequential damages, or limitation on the length of an implied warranty, so the above limitations or exclusions may not apply to you. This warranty gives you specific legal rights, and you may also have other rights that vary from state to state or from one jurisdiction to another. Laws in the United States and other countries preserve for Motorola certain exclusive rights for copyrighted Motorola software such as the exclusive rights to reproduce and distribute copies of the Motorola software. Motorola software may only be copied into, used in, and redistributed with, the Products associated with such Motorola software. No other use, including without limitation disassembly of such Motorola software or exercise of the exclusive rights reserved for Motorola, is permitted.



SD4505

Wireless Cell Dock

