



40-Channel 900 MHz Cordless Telephone/Answering System User's Guide

26992



We bring good things to life.

EQUIPMENT APPROVAL INFORMATION

Your telephone equipment is approved for connection to the Public Switched Telephone Network and is in compliance with parts 15 and 68, FCC Rules and Regulations and the Technical Requirements for Telephone Terminal Equipment published by ACTA.

1 Notification to the Local Telephone Company
On the bottom of this equipment is a label indicating, among other information, the US number and Ringer Equivalence Number (REN) for the equipment. You must, upon request, provide this information to your telephone company.

The REN is useful in determining the number of devices you may connect to your telephone line and still have all of these devices ring when your telephone number is called. In most (but not all) areas, the sum of the RENs of all devices connected to one line should not exceed 5. To be certain of the number of devices you may connect to your line as determined by the REN, you should contact your local telephone company.

A plug and jack used to connect this equipment to the premises wiring and telephone network must comply with the applicable FCC Part 68 rules and requirements adopted by the ACTA. A compliant telephone cord and modular plug is provided with this product. It is designed to be connected to a compatible modular jack that is also compliant. See installation instructions for details.

Notes
• This equipment may not be used on coin service provided by the telephone company.
• Party lines are subject to state tariffs, and therefore, you may not be able to use your own telephone equipment if you are on a party line. Check with your local telephone company.
• Notice must be given to the telephone company upon permanent disconnection of your telephone from your line.
• If your home has specially wired alarm equipment connected to the telephone line, ensure the installation of this product does not disable your alarm equipment. If you have questions about what will disable alarm equipment, consult your telephone company or a qualified installer.

2 Rights of the Telephone Company
Should your equipment cause trouble on your line which may harm the telephone network, the telephone company shall, where practicable, notify you that temporary discontinuance of service may be required. Where prior notice is not practicable and the circumstances warrant such action, the telephone company may temporarily discontinue service immediately. In case of such temporary discontinuance, the telephone company must: (1) promptly notify you of such temporary discontinuance; (2) afford you the opportunity to correct the situation; and (3) inform you of your right to bring a complaint to the Commission pursuant to procedures set forth in Subpart E of Part 68, FCC Rules and Regulations.

The telephone company may make changes in its communications facilities, equipment, operations or procedures where such action is required in the operation of its business and not inconsistent with FCC Rules and Regulations. If these changes are expected to affect the use or performance of your telephone equipment, the telephone company must give you adequate notice, in writing, to allow you to maintain uninterrupted service.

INTERFERENCE INFORMATION

This device complies with Part 15 of the FCC Rules. Operation is subject to the following two conditions: (1) This device may not cause harmful interference; and (2) This device must accept any interference received, including interference that may cause undesired operation.

This equipment has been tested and found to comply with the limits for a Class B digital device, pursuant to Part 15 of the FCC Rules. These limits are designed to provide reasonable protection against harmful interference in a residential installation. This equipment generates, uses, and can radiate radio frequency energy and, if not installed and used in accordance with the instructions, may cause harmful interference to radio communications. However, there is no guarantee that interference will not occur in a particular installation.

If this equipment does cause harmful interference to radio or television reception, which can be determined by turning the equipment off and on, the user is encouraged to try to correct the interference by one or more of the following measures:

ATLINKS USA, Inc.
101 West 103rd Street
Indianapolis, IN 46290
© 2004 ATLINKS USA, Inc.
Trademarks: © Registered
Marcals) Registradas)

Model 26992D
55516140 (Rev. 0 DOM E)
04-05
Printed in China

- Reorient or relocate the receiving antenna (that is, the antenna for radio or television that is "receiving" the interference).
 - Reorient or relocate and increase the separation between the telecommunications equipment and receiving antenna.
 - Connect the telecommunications equipment into an outlet on a circuit different from that to which the receiving antenna is connected.
- If these measures do not eliminate the interference, please consult your dealer or an experienced radio/television technician for additional suggestions. Also, the Federal Communications Commission has prepared a helpful booklet, "How To Identify and Resolve Radio/TV Interference Problems." This booklet is available from the U.S. Government Printing Office, Washington, D.C. 20402. Please specify stock number 094-000-00345-4 when ordering copies.

HEARING AID COMPATIBILITY

This telephone system meets FCC standards for Hearing Aid Compatibility.

US NUMBER IS LOCATED ON THE CABINET BOTTOM
REN NUMBER IS LOCATED ON THE CABINET BOTTOM

INTRODUCTION

Your cordless telephone/answering system is designed to give you flexibility in use and high quality performance. To get the most from your new cordless telephone/answering system, we suggest that you take a few minutes right now to read through this instruction manual.

IMPORTANT: Because cordless phones operate on electricity, you should have at least one phone in your home that isn't cordless, in case the power in your home goes out.

CAUTION: When using telephone equipment, there are basic safety instructions that should always be followed. Refer to the IMPORTANT SAFETY INSTRUCTIONS provided with this product and save them for future reference.

BEFORE YOU BEGIN

Make sure your package includes the items shown here.

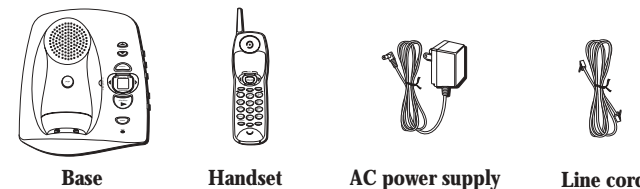

TELEPHONE JACK REQUIREMENTS

To use this phone, you need an RJ11C type modular telephone jack, which might look like the one pictured here, installed in your home. If you don't have a modular jack, call your local phone company to find out how to get one installed.

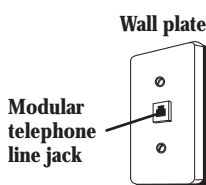

DIGITAL SECURITY SYSTEM

Your cordless phone uses a digital security system to protect against false ringing, unauthorized access, and charges to your phone line.

When you place the handset in the base, the unit verifies its security code. After a power outage or battery replacement, you should place the handset in the base for about 20 seconds to reset the code.

 WARNING: TO PREVENT FIRE OR ELECTRICAL SHOCK HAZARD, DO NOT EXPOSE THIS PRODUCT TO RAIN OR MOISTURE.	 CAUTION: RISK OF ELECTRIC SHOCK. DO NOT OPEN. <small>CAUTION: TO REDUCE THE RISK OF ELECTRIC SHOCK, DO NOT REMOVE COVER (OR BACK). NO USER SERVICEABLE PARTS INSIDE. REFER SERVICING TO QUALIFIED SERVICE PERSONNEL.</small>	 THE EXCLAMATION POINT WITHIN THE TRIANGLE IS A WARNING SIGN ALERTING YOU OF DANGEROUS VOLTAGE INSIDE THE PRODUCT.
SEE MARKING ON BOTTOM / BACK OF PRODUCT		

INSTALLATION AND SETUP

CAUTION: Always disconnect phone cords from the wall outlets before battery installation or replacement.

INSTALLATION NOTE: Some cordless telephones operate at frequencies that may cause interference to nearby TVs, microwave ovens, and VCRs. To minimize or prevent such interference, the base of the cordless telephone should not be placed near or on top of a TV, microwave oven, or VCR. If interference continues, moving the cordless telephone farther away from the TV or VCR will often reduce or eliminate the interference. Certain other communications devices may also use the 900 MHz frequency for communication, and if not properly set, these devices may interfere with each other and/or your new telephone. If you are concerned with interference, please refer to the owner's manual for these devices on how to properly set channels to avoid interference. Typical devices that may use the 900 MHz frequency for communication include wireless audio/video senders, wireless computer networks, multi-handset cordless telephone systems, and some long-range cordless telephone systems.

IMPORTANT INSTALLATION INFORMATION

- Never install telephone wiring during a lightning storm.
- Never install telephone jacks in wet locations unless the jack is specifically designed for wet locations.
- Never touch uninsulated telephone wires or terminals, unless the telephone line has been disconnected at the network interface.
- Use caution when installing or modifying telephone lines.
- Temporarily disconnect any equipment connected to the phone such as faxes, other phones, or modems.

INSTALLING THE PHONE

Your cordless telephone/answering system should be placed on a level surface such as a desk or table top, or you can mount it on a wall.

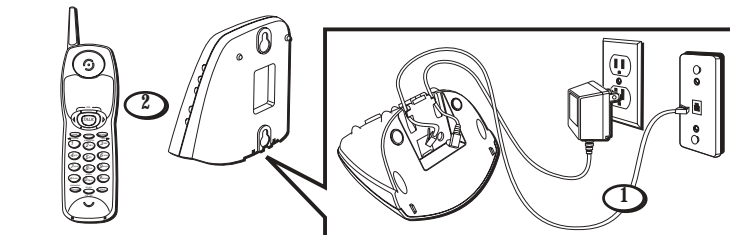

CONNECTING THE AC (ELECTRICAL) POWER

Plug the power supply cord into the power jack on the bottom of the base and the other end into an electrical outlet. The in use/charge indicator turns on to indicate the battery is charging.

CAUTION: Use only the ATLINKS USA, Inc. power supply 5-2618 (gray) or 5-2512 (black) that came with this unit. Using other power supplies may damage the unit.

CONNECTING THE TELEPHONE LINE

1. Plug the one end of the telephone line cord into the jack on the bottom of the base and the other end into a modular wall phone jack.
2. Set the ringer switch (on the handset) to ON, and place the handset in the cradle.

Allow the phone to charge for 12 hours prior to first use. If you don't properly charge the phone, battery performance is compromised.

NOTE: If the battery is not installed in the handset, or if the battery is not properly connected to the jack inside the battery compartment, the TALK button on the handset blinks when the handset is placed on the base cradle.

WALL MOUNTING

NOTE: For best results, leave the phone on a flat surface during initial charging before you hang the phone on the wall.

If you want to mount the phone on a wall, slip the mounting holes (on the back of the base) over the wall plate posts and slide the unit down into place. (Wall plate not included.)

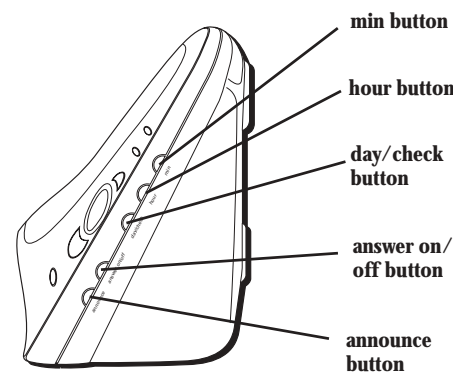
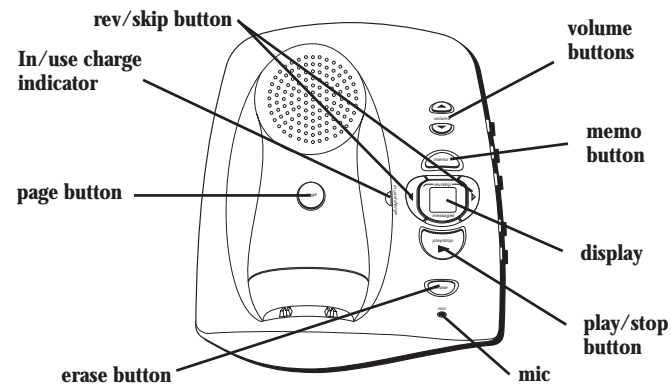

ANSWERING SYSTEM SET UP

This section shows you how to set up your answering system to receive incoming calls. Before you begin the setup, you must turn on the answering system.

- Press the answer on/off button to turn the answering system on and off. The messages indicator lights when the answering system is on. The indicator blinks when you have messages.

SETTING THE VOICE TIME/DAY STAMP

1. Press and hold the day/check button to scroll to desired day of the week and then release.
2. Press the hour button to set the hour (a.m. or p.m.).
3. Press the min button to set the minute. When you press and hold the min button, the time advances in 5-minute intervals.
4. Press and release the day/check button to review the day and time settings.

RECORDING THE OUTGOING ANNOUNCEMENT

For best results when recording, you should be about nine inches from the microphone, and try to eliminate as much background noise as possible.

1. Press and hold the announce button.
2. Begin speaking after you hear the beep.
3. Release the button when you finish your announcement.

If you choose not to record an outgoing announcement, or want to return to the default announcement after you have recorded your own outgoing announcement, press the announce button and release it when you hear the beep, or press erase while your announcement is playing.

Sample Outgoing Announcement

Hi, this is (use your name here), I can't answer the phone right now, so please leave your name, number and a brief message after the tone, and I'll get back to you. Thanks.

REVIEWING THE ANNOUNCEMENT

Press and release the announce button to review your outgoing announcement.

SETTING THE SPEAKER VOLUME

Use the volume up and down located on the base to adjust speaker volume to a comfortable level.

VOICE INSTRUCTIONS

If you need additional assistance, press the rev(-) button on the base after you first plug in the answering system and then follow the voice instructions.

SETTING THE RING SELECT

Set the RING SELECT switch on the back of the unit to choose the number of times you want the phone to ring before the machine answers the call. You can choose 3 or 5 rings.

ANSWERING MACHINE OPERATION

This section discusses the buttons and features on the answering system.

MESSAGES INDICATOR

The messages indicator blinks to show you there are unread messages stored in the unit. The number indicates the total number of messages stored in it. The answerer must be turned on for the messages indicator to work.

SCREENING CALLS FROM THE BASE

You can screen incoming calls by listening as the caller leaves a message, then pick up the handset, and press the TALK button to speak to the caller. The answering system automatically stops recording when you activate the handset or pick up an extension phone.

TIP: Make sure the volume on the base is set loud enough to hear incoming calls.

MESSAGE PLAYBACK

The messages indicator lets you know when you have messages. To play messages, press play/stop.

While a message is playing, you can do the following:

- Press play/stop to stop the message playback.
- Press the + or - arrow button to review messages or skip to the next message.
- Press the Vol button to adjust the playback volume.

MEMORY FULL

When memory is full, the system answers after 10 rings on an incoming call and announces, "Memory full." You should erase some messages so the answering system can record new messages.

ERASING MESSAGES

You can erase messages three ways: one message at a time using the erase button on the base; all messages using the erase button on the base; or one message at a time using the erase button (0) on the handset.

- **To erase a message,** press play/stop on the base and press and release erase button on the base to erase the message that is playing.
- **To erase all messages,** press and hold the erase button on the base when messages have been reviewed.
- **To erase a message from the handset:**

1. Press answerer button on the handset.
2. Press play/stop on the handset (the 2 button).
3. Press erase on the handset (the 0 button) to erase the message that is playing.

NOTE: Erased messages cannot be restored. Also, be careful you don't press the erase button as the next unheard message is playing because that message will also be erased.

LEAVING A MEMO

Use the Memo feature to leave a message.

1. Press and hold the memo button. You need to hold the button until you finish the message.
2. Begin talking after you hear the beep.
3. Release the memo button when you finish.

CORDLESS PHONE BASICS

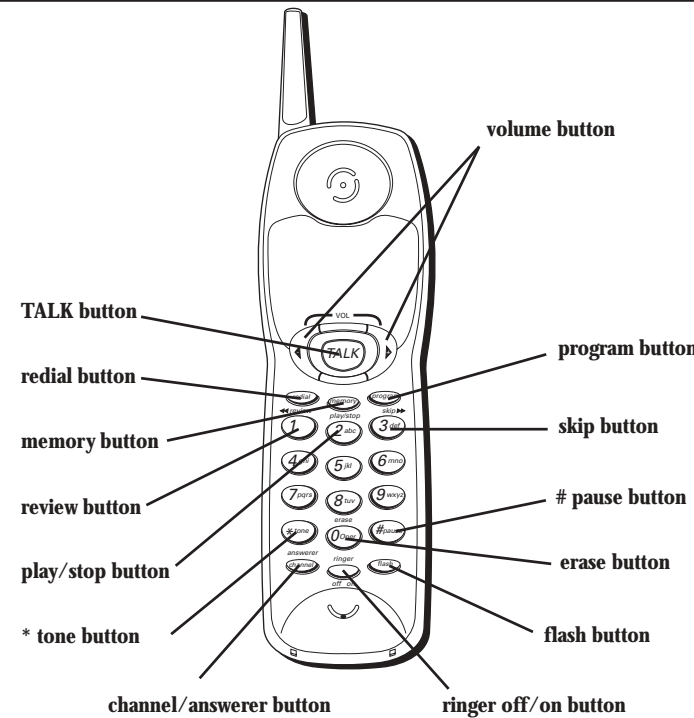

MAKING A CALL

Press the TALK button before you dial.

IN-USE INDICATOR

The phone is on when you see the In use/charge indicator on the base come on.

REDIAL

When the phone is on (in use), press the redial button to redial the last number called (up to 32 digits).

RECEIVING A CALL

To answer a call you must press the TALK button before you begin speaking.

FLASH BUTTON

Use the flash button to activate custom calling services such as call waiting or call transfer, which are available through your local phone company.

TIP: Don't use the TALK button to activate custom calling services such as call waiting, or you'll hang up the phone.

VOLUME BUTTON

Press the + or - button on the handset to adjust the volume of the handset's earpiece. There are four settings. Pressing + increases the volume, and pressing - decreases the volume.

RINGER SWITCH

The RINGER switch must be ON for the handset to ring during incoming calls.

TONE/PULSE SETTING

1. Make sure the phone is OFF.
2. Press and hold the program button until you hear a beep.
3. Press * tone button for tone dialing or # pause for pulse dialing.
4. Press the program button again. You will hear a confirmation tone.

PAGING THE HANDSET

If you misplace your handset press the page button on the base. The handset emits a continuous paging tone to help you find it. When you find the handset, press the TALK button to stop the tone.

NOTE: You can still page the handset with the ringer off.

ADVANCED FEATURES

CHANNEL BUTTON

While talking, you might need to manually change the channel in order get rid of static caused by baby monitors, garage door openers, or other cordless phones. Press and release the channel button to advance to the next clear channel.

MEMORY

Store up to 10 numbers in memory for quick dialing.

STORING A NUMBER IN MEMORY

The phone must be OFF when you store numbers.

1. Press the memory button.
2. Press a number key (0-9) to store the dialed number in that memory location.
3. Press the memory button.
4. Enter the number (up to 20 digits).
5. Press memory button to confirm. You will hear a confirmation tone.

IMPORTANT: If you make test calls to emergency numbers stored in memory, remain on the line and briefly explain the reason for the call to the dispatcher. Also, it's a good idea to make these calls in off-peak hours, such as early morning or late evening.

TIPS: You may also store the last number dialed in memory. Follow steps one through three above, press the redial button to call the last number dialed, and then press the memory button to confirm.

INSERTING A PAUSE IN THE DIALING SEQUENCE

Press the # pause button to insert a delay in the dialing sequence of a stored telephone number when a pause is needed to wait for a dial tone (for example, after you dial 9 for an outside line or when you need to wait for a computer access tone). Each pause counts as 1 digit.

CHANGING A STORED NUMBER

Use the same procedure for Storing a Number in Memory except replace the old phone number with a new one.

DIALING A STORED NUMBER

1. Make sure the phone is ON.
2. Press memory.
3. Press the number for that memory location.

