

Start Here

Kodak EasyShare 5300

All-in-One Printer

Print
Copy
Scan

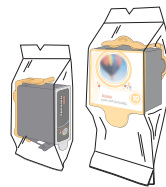

Note: A USB 2.0 cable is required to connect your Kodak All-in-One Printer to your Windows or Macintosh OS computer.

Identify Main Components

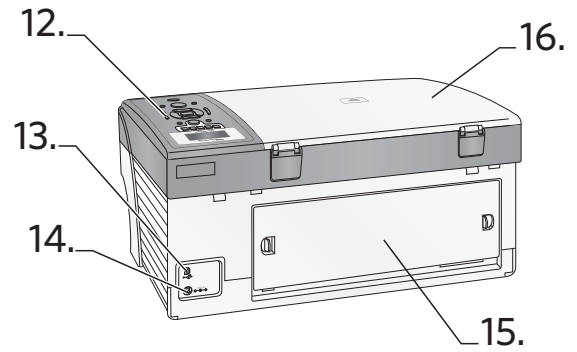
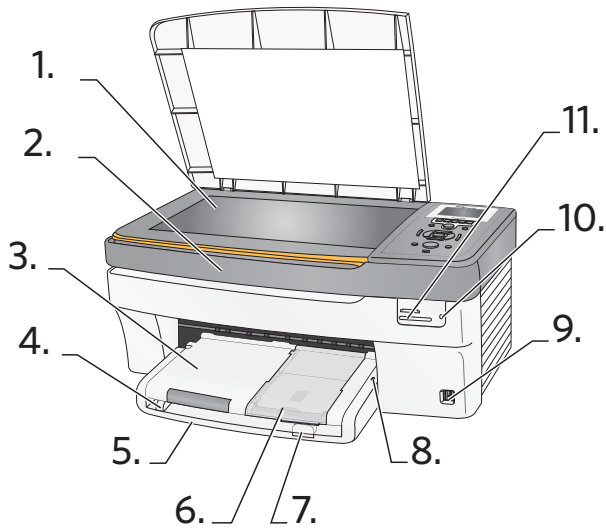

1. Scanner glass	9. USB drive/PictBridge port
2. Printer access door	10. Memory card light
3. Output tray	11. Memory card slots
4. Paper-width guide	12. Control panel
5. Main tray	13. USB port
6. Photo tray	14. Power connector
7. Paper-length guide	15. Rear access door
8. Photo tray light	16. Scanner lid

1

Unpack Printer and Install Control Panel

⚠ IMPORTANT: Do not connect the USB cable to the printer until instructed during software installation.

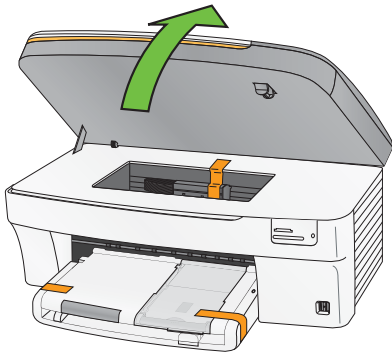

- a) See box flaps for unpacking instructions. Remove all orange shipping tape from the printer.

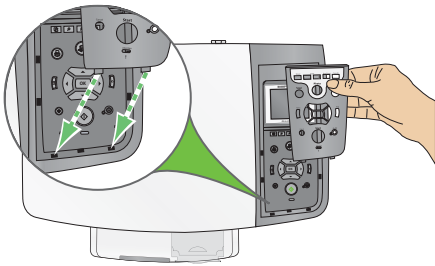

- b) If not preinstalled, insert the control panel overlay, bottom end first.

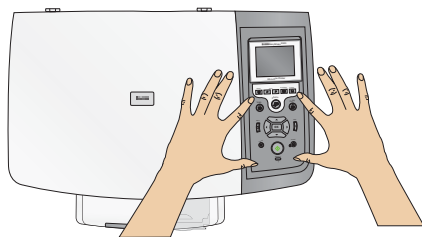

- c) Press down on all edges of the overlay until it snaps into position.

2

Load Paper

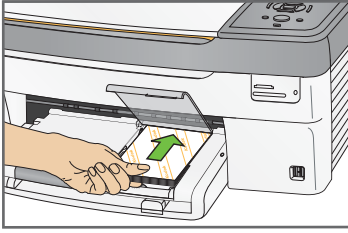

- a) Load photo paper into the photo tray.
Lift the photo tray lid until it remains standing without support. Insert the photo paper glossy side down.
⚠ IMPORTANT: Do not overload the photo tray.
Max 20 sheets.

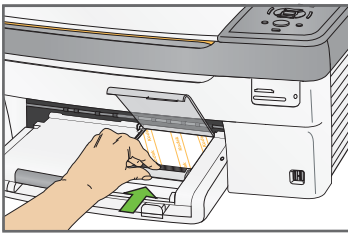

- b) Push the photo tray in until it clicks into place.
NOTE: You can only print to the photo tray when the photo tray is pushed in.
Lower the photo tray lid.

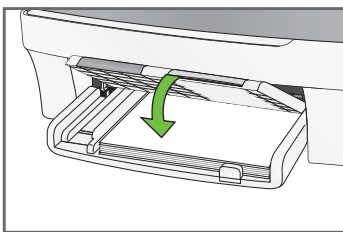
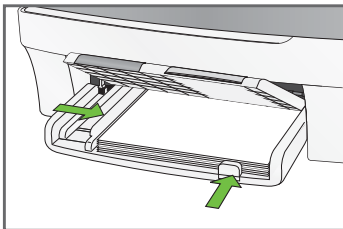
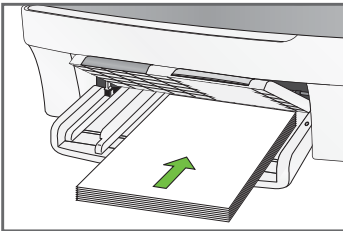
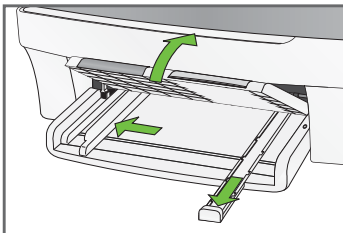

- c) Load plain white paper into the main tray.

3

Install Printhead

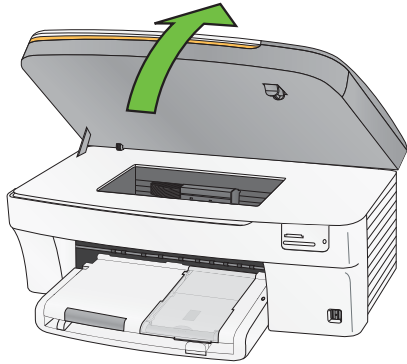

⚠ IMPORTANT: The printhead is fragile. Handle carefully.

- a) Lift the printer access door. Make sure the orange tape is removed from the carriage.

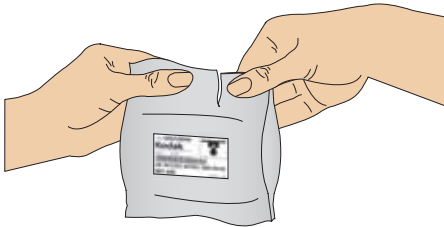

- b) Remove the printhead from its bag.

⚠ IMPORTANT: Insert the printhead immediately upon opening sealed bag.

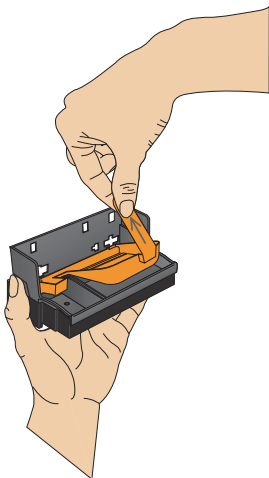

- c) Pull on the orange tab to remove the protective retainer.

Install Printhead

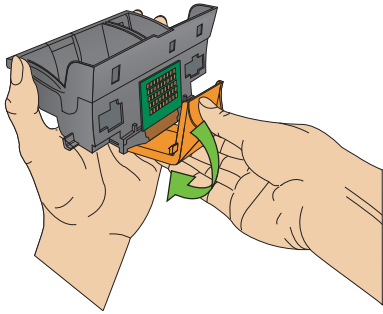

- d) Carefully remove and discard the black plastic shield and the orange protective cap.

⚠ IMPORTANT: Do not touch the copper-colored contacts.

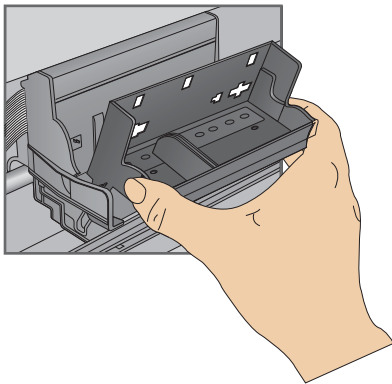

- e) Place the printhead into the carriage. Insert at the angle shown.

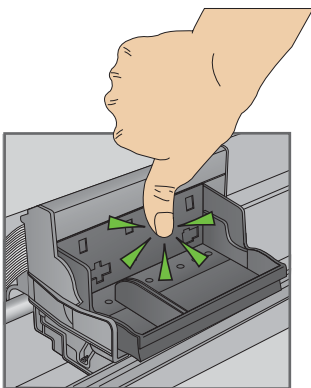

- f) Push firmly against the back wall of the printhead until it clicks into place.
Tip: The printhead requires a firm push and makes an audible click when locked into place.

4

Install Ink Cartridges

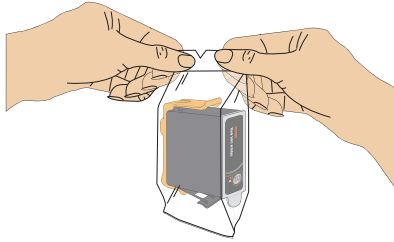

a) Remove the black ink cartridge from its bag.

⚠ IMPORTANT: Insert ink cartridges immediately upon opening sealed bag.

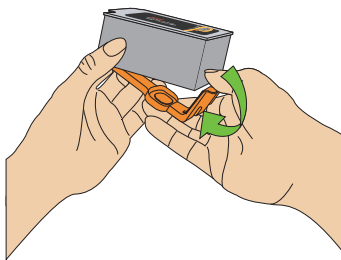

b) Carefully remove and discard the orange cap.
Handle ink cartridges carefully to avoid ink transfer.

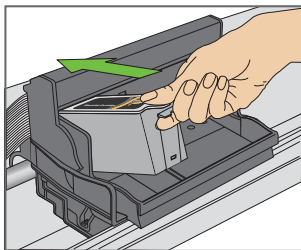

c) Insert the black ink cartridge into the printhead.

Install Ink Cartridges

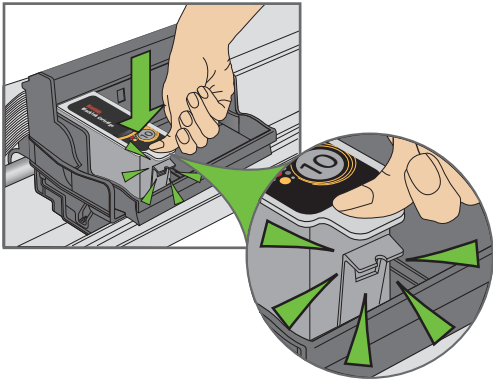

- d)** Press down on the ink cartridge until you hear it click into position.

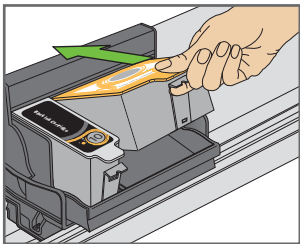

- e)** Open and uncap the color ink cartridge. Insert it into the printhead.

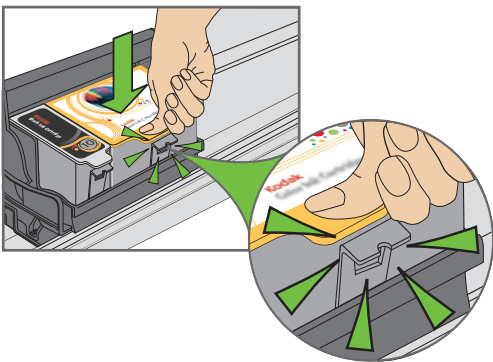

- f)** Press down firmly on the ink cartridge until you hear it click into position. It is normal for the printhead to flex when inserting the cartridge. You will not damage the printer.

Close the printer access door.

5

Connect Power

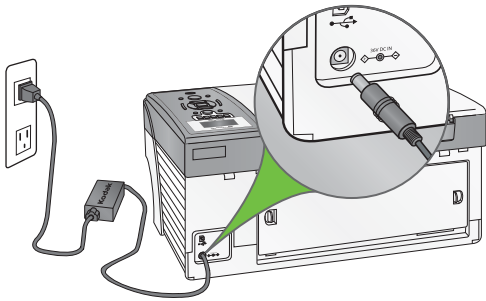

a) Connect the power supply and adapter.

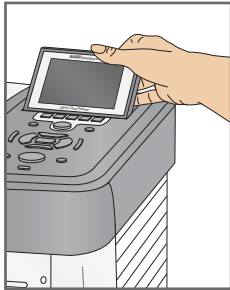

b) Remove the plastic film from the LCD display.
Position the LCD display and press ON.



c) Press ON. If prompted, select your language.
Use the ▼ key to select a region.

6

Calibrate Printer

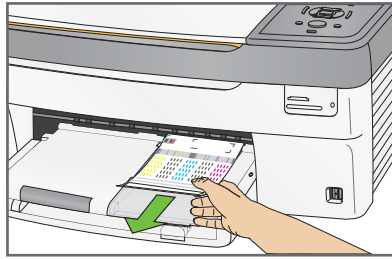

⚠ IMPORTANT: Make sure that the photo tray is pushed in. The photo tray light should be lit.

a) Press Start. Wait two minutes for the calibration sheet to print.

Tip: If the calibration sheet does not print properly, see the Troubleshooting section in this setup guide.

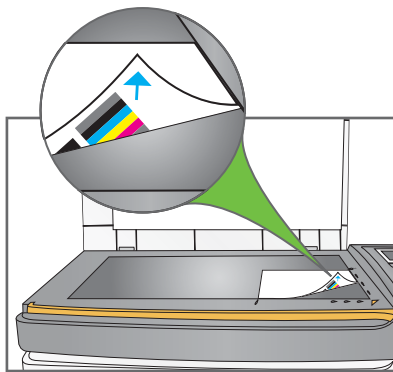

b) Remove the calibration sheet from the output tray. Place it face down and align to the front, right corner of the scanner glass, as shown.

⚠ IMPORTANT: The blue arrow in the corner of the calibration sheet must point to the registration marks as shown.

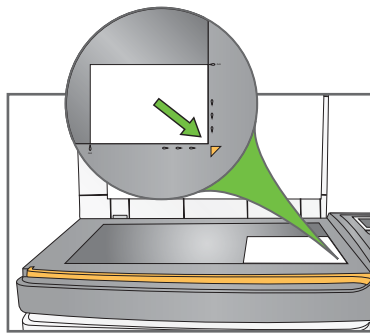

c) Lower the scanner lid and press Start. Remove the sheet from the scanner glass when the calibration is complete.

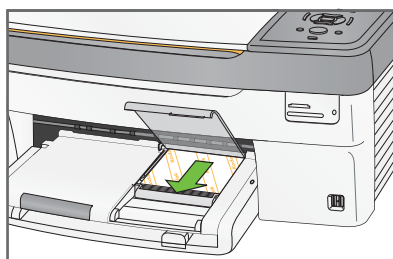

d) Lift the photo tray lid, then slide the photo tray toward you to return to main tray operation. The photo tray light will turn off.

7

Install Software

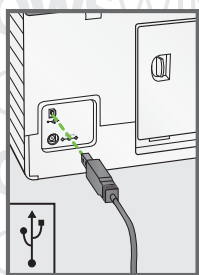

WINDOWS

⚠ IMPORTANT: Do not connect the USB cable to the printer until instructed during software installation.

- a) Load the Kodak AiO Printer Software CD into the CD-ROM drive. Follow the on-screen prompts when the instructions appear.

If instructions do not appear, click **Start**, then **Run**. Select CD-ROM drive and type `setup.exe`, then press **ENTER**.

- b) Connect the USB cable to the printer when instructed. Continue to follow the on-screen prompts until installation is complete.

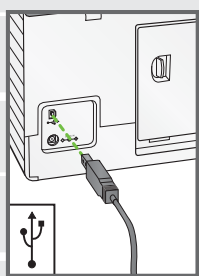

MACINTOSH

- a) Connect the USB cable to the printer and your Macintosh computer.

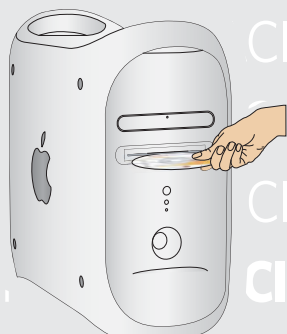

- b) Load the Kodak AiO Printer Software CD into the CD-ROM drive.

The Kodak AiO Printer Software installer window should be displayed. If not, double-click the Kodak AiO Printer Software CD icon on the desktop. Follow the on-screen prompts until installation is complete.

8

Helpful Tips and Getting Started

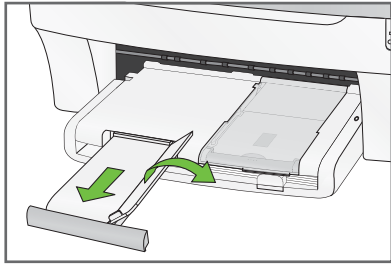

Pull out the output tray extender to help collect your prints.

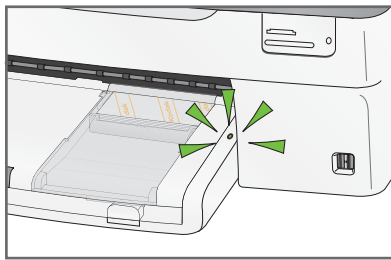

The photo tray light illuminates when the photo tray is pushed in. To use the main paper tray, disengage the photo tray by pulling it towards you

You can access and use the AiO Home Center by double-clicking on the icon on your desktop.



Kodak Home Center Software

You can use Kodak Home Center to browse, print, copy, scan, and configure your AiO Printer from the computer.



EasyShare Software

You can use Kodak EasyShare to transfer, view, and work with your digital pictures and videos, if installed.

Control Panel Features

Display photos, messages, status, and menus.

Rotates the picture on the display.

Zooms in or out in .05X increments.

Displays the Main menu on the LCD screen.

Indicates attention is needed. When illuminated, see LCD screen for further instruction.

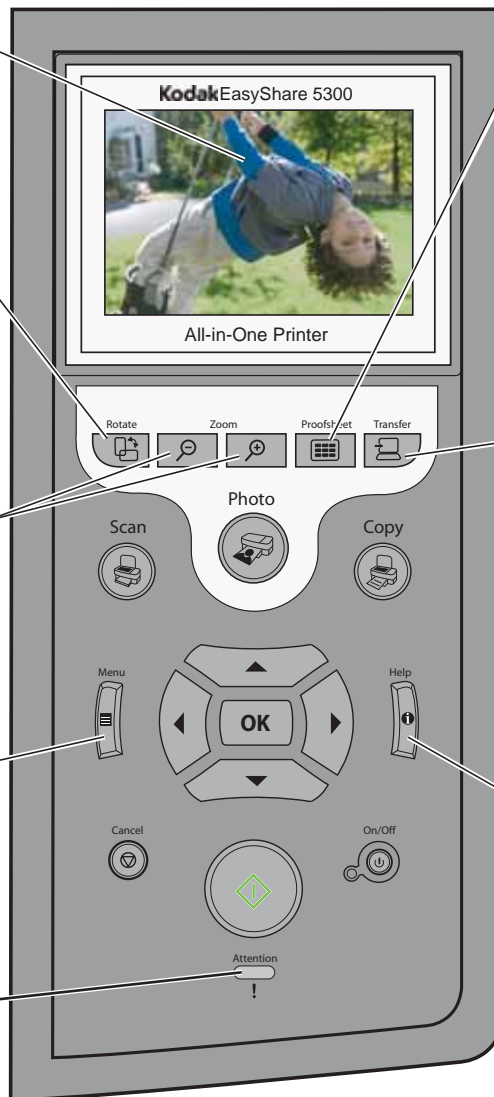

Displays the Proofsheets menu when there are pictures on an inserted memory card or connected USB host device.

Transfers images from a device connected to a USB host port, PictBridge, or (PTP) PictureTransfer Protocol.

Displays the Help menu on the LCD screen.

Troubleshooting

If you have additional questions about troubleshooting this device, please visit www.kodak.com/go/5300aiosupport

PROBLEM:

I cannot get a calibration sheet to print.

SOLUTION:

When necessary, you can force a calibration sheet to print by following these steps:

1. Press Menu, select Calibrate Printer and press OK.
2. Select Print Calibration Page and press OK.
3. When the print comes out, place it at the front, right corner of the scanner glass.
4. Close the scanner lid and press START.

PROBLEM:

My calibration page printed on plain white text paper.

SOLUTION:

Follow the directions as listed in steps 3-4. Calibration will work successfully on both plain white paper and photo paper.

PROBLEM:

I cannot print to my desired paper type.

SOLUTION:

Check to see if the photo tray is pushed in. You can do this by checking if the green photo tray light is illuminated. If it is, all prints will be produced from this tray. If you want to print from the main tray, pull out the photo tray by lifting the photo tray lid and sliding the paper tray toward you.

PROBLEM:

I have a paper jam.

SOLUTION:

1. Press in the tabs on the rear access door to remove the door.
2. Gently pull the paper out of the rollers. **IMPORTANT:** If the paper tears while removing it, check inside the printer for torn pieces of paper and remove them. Additional jams are likely to occur if all of the torn pieces are not removed.
3. Replace the rear access door. Gently push the door forward until it snaps into place.

Is Further Troubleshooting Required?

If you need further information to help answer your questions, please contact Technical Support and have your KSN number ready. Your KSN number can be found on the printer by lifting the printer access door as shown.

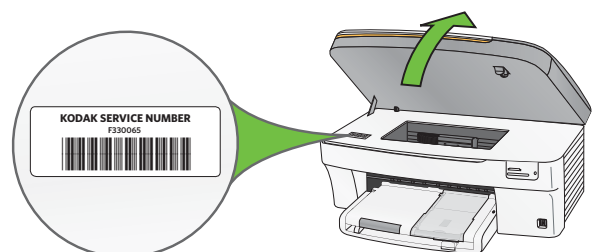

More Accessories

More Options

More Convenience

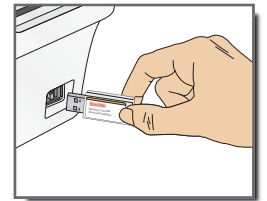

The KODAK EasyShare All-in-One Printer gives you more. Be sure to visit our online store to select from our full line of supplies and accessories at www.kodak.com/go/AiO

Kodak's Inkjet Photo Paper

Get prints that look great the first time with Kodak's unique backprint technology that automatically enables optimized prints.

Value Packs

Save up to 50% on everything you print and pay as low as 10 cents a print with our ink and paper Value Packs.

Two-sided Printing Accessory

It's easy to print both sides of your document with the Kodak EasyShare 5000 Series Two-Sided Printing Accessory.

Wireless Adaptor

Go wireless with the Kodak Wireless 2.0 USB Bluetooth Adaptor.

Note: A USB 2.0 cable is required to connect your Kodak All-in-One Printer to your Windows or Macintosh OS computer. Available in the Kodak online store or see your local retailer.

Safety

- Read and follow these instructions before using KODAK products.
- Always follow basic safety procedures.
- Follow all warnings and instructions marked on the equipment.

WARNING STATEMENTS

- Do not expose this product to liquid, moisture, or extreme temperatures. KODAK AC adapters are intended for indoor use only. The use of controls, adjustments, or procedures other than those specified herein may result in exposure to shock and/or electrical or mechanical hazards.
- Keep ink cartridges out of reach of children. Ink may be harmful if swallowed.
- Do not place your AiO Printer on an unstable cart, stand, bracket, or table. Injury to persons and damage to the equipment may occur.
- The use of an accessory attachment that is not recommended by Kodak, such as an AC adapter, may cause fire, electric shock, or injury.
- Pushing objects through the equipment openings can result in an electric shock or risk of fire.

CAUTIONARY STATEMENTS

- Adjust only those controls covered in the operating instructions.
- Do not disassemble this product; there are no user-serviceable parts inside. Refer servicing to qualified service personnel.
- The AC adapter power supply is equipped with 3-wire grounding type plugs. If you cannot insert the plug into the power outlet, contact an electrician to check or replace the power outlet.
- Do not plug the AC adapter into a household extension cord.
- If the power cord or plug is frayed or damaged, the equipment gets wet, or the equipment does not operate normally when the operating instructions are followed, unplug your AiO Printer from the power outlet and contact Kodak qualified service personnel for further instructions.
- For added protection from damage during a lightning storm, or any time when your AiO Printer and it's associated AC adapter will be left unused for long periods of time, unplug the AC adapter from the power outlet and any attached fax line from the printer.
- To reduce the risk of fire, use only 26 AWG or larger telecommunication line cord.
- To prevent your AiO printer from overheating do not place it near a heat register, or install it in a cabinet without proper ventilation.
- Do not use your AiO Printer near water or spill liquid on it.
- Unplug the equipment from the wall outlet before cleaning.
- Dropping your AiO Printer may damage the housing and result in extensive damage that will require repair by a qualified technician to restore normal operation.
- Excessive dust levels may damage internal parts.

For more information, go to www.kodak.com/go/MSDS

Limited Warranty

Limited Warranty

Kodak warrants Kodak consumer electronic products and accessories ("Products"), excluding batteries, to be free from malfunctions and defects in both materials and workmanship for one year from the date of purchase.

Retain the original dated sales receipt. Proof of the date of purchase will be required with any request for warranty repair.

Limited Warranty Coverage

Warranty service is only available from within the country where the Products were originally purchased. You may be required to send Products, at your expense, to the authorized service facility for the country where the Products were purchased.

Kodak will repair or replace Products if they fail to function properly during the warranty period, subject to any conditions and/or limitations stated herein. Warranty service will include all labor as well as any necessary adjustments and/or replacement parts. If Kodak is unable to repair or replace a Product, Kodak will, at its option, refund the purchase price paid for the Product provided the Product has been returned to Kodak together with proof of the purchase price paid. Repair, replacement, or refund of the purchase price are the sole remedies under this warranty.

If replacement parts are used in making repairs, those parts may be remanufactured. or may contain remanufactured materials. If it is necessary to replace the entire Product, it may be replaced with a remanufactured Product. Remanufactured Products, parts and materials are warranted for the remaining warranty term of the original Product, or 90 days after the date of repair or replacement, whichever is longer.

Limitations

This warranty does not cover circumstances beyond Kodak's control. This warranty does not apply when failure is due to shipping damage, accident, alteration, modification, unauthorized service, misuse, abuse, use with incompatible accessories or attachments (such as third party ink or ink tanks), failure to follow Kodak's operation, maintenance or repacking instructions, failure to use items supplied by Kodak (such as adapters and cables), or claims made after the duration of this warranty.

KODAK MAKES NO OTHER EXPRESS OR IMPLIED WARRANTY FOR THIS PRODUCT, AND DISCLAIMS THE IMPLIED WARRANTIES OF MERCHANTABILITY AND FITNESS FOR A PARTICULAR PURPOSE. In the event that the exclusion of any implied warranty is ineffective under the law, the duration of the implied warranty will be one year from the purchase date or such longer period as required by law.

The option of repair, replacement, or refund is Kodak's only obligation. Kodak will not be responsible for any special, consequential or incidental damages resulting from the sale, purchase, or use of this product regardless of the cause. Liability for any special, consequential or incidental damages (including but not limited to loss of revenue or profit, downtime costs, loss of the use of the equipment, cost of substitute equipment, facilities or services, or claims of your customers for such damages resulting from the purchase use or failure of the Product), regardless of cause or for breach of any written or implied warranty is expressly disclaimed.

Your Rights

Some states or jurisdictions do not allow exclusion or limitation of incidental or consequential damages, so the above limitation or exclusion may not apply to you. Some states or jurisdictions do not allow limitations on how long an implied warranty lasts, so the above limitation may not apply to you.

This warranty gives you specific rights, and you may have other rights which vary from state to state or by jurisdiction. Your statutory rights are not affected.

Outside the United States and Canada

In countries other than the United States and Canada, the terms and conditions of this warranty may be different. Unless a specific Kodak warranty is communicated to the purchaser in writing by a Kodak company, no warranty or liability exists beyond any minimum requirements imposed by law, even though defect, damage, or loss may be by negligence or other act.

Blank

Kodak



REGISTRATION HAS ITS REWARDS—including a terrific offer.

Register your KODAK All-in-One Printer and get great support, expert tips, free software downloads—**plus a phenomenal deal on inkjet supplies to get you started.** Simply register right away when prompted during software installation or on the web at www.kodak.com/go/register

REGISTRATION TAKES A MINUTE—BUT THE REWARDS ARE LASTING.

Inkjet supplies offer valid for U.S. residents only.

Any questions?

Look here for answers:

www.kodak.com/go/5300aiosupport

User's Guide - The User Guide is installed with your Kodak AiOSoftware and is located:

Windows: Program Files ▶ Kodak ▶ Printer ▶ Center ▶ Help

Macintosh: Library ▶ Documentation ▶ Kodak AiO Printers

For printer support, please call 1-800-421-6699

Kodak

Eastman Kodak Company
Rochester, NY 14650 U.S.A.
© Eastman Kodak Company, 2007
MC/MR/TM: Kodak, EasyShare.



1K2682



A

Printed in the U.S.A.

The Bluetooth® trademarks are owned by the Bluetooth SIG, Inc.
Windows® is a registered trademark of Microsoft Corporation
Macintosh® is a registered trademark of Apple Computer, Inc.