

Pioneer *sound.vision.soul*

DVD/CD Receiver

XV-DV323

XV-DV424

Speaker System

S-DV323



S-DV424



Operating Instructions

RW
COMPATIBLE

Location: underside of the unit

<h1>IMPORTANT</h1> 	<div style="border: 1px solid black; padding: 5px;">CAUTION RISK OF ELECTRIC SHOCK DO NOT OPEN</div>	
<p>The lightning flash with arrowhead, within an equilateral triangle, is intended to alert the user to the presence of uninsulated "dangerous voltage" within the product's enclosure that may be of sufficient magnitude to constitute a risk of electric shock to persons.</p>	<p>CAUTION: TO PREVENT THE RISK OF ELECTRIC SHOCK, DO NOT REMOVE COVER (OR BACK). NO USER-SERVICEABLE PARTS INSIDE. REFER SERVICING TO QUALIFIED SERVICE PERSONNEL.</p>	<p>The exclamation point within an equilateral triangle is intended to alert the user to the presence of important operating and maintenance (servicing) instructions in the literature accompanying the appliance.</p>
D3-4-2-1-1_En		

Replacement and mounting of an AC plug on the power supply cord of this unit should be performed only by qualified service personnel.

<h1>IMPORTANT</h1> <h2>FOR USE IN THE UNITED KINGDOM</h2> <p>The wires in this mains lead are coloured in accordance with the following code:</p> <p>Blue : Neutral Brown : Live</p> <p>If the plug provided is unsuitable for your socket outlets, the plug must be cut off and a suitable plug fitted.</p>	<p>The cut-off plug should be disposed of and must not be inserted into any 13 amp socket as this can result in electric shock. The plug or adaptor or the distribution panel should be provided with 5 A fuse. As the colours of the wires in the mains lead of this appliance may not correspond with coloured markings identifying the terminals in your plug, proceed as follows:</p> <p>The wire which is coloured blue must be connected to the terminal which is marked with the letter N or coloured black.</p> <p>The wire which is coloured brown must be connected to the terminal which is marked with the letter L or coloured red.</p>	<p>Do not connect either wire to the earth terminal of a three pin plug.</p> <p>NOTE After replacing or changing a fuse, the fuse cover in the plug must be replaced with a fuse cover which corresponds to the colour of the insert in the base of the plug or the word that is embossed on the base of the plug, and the appliance must not be used without a fuse cover. If lost replacement fuse covers can be obtained from your dealer. Only 5 A fuses approved by B.S.I or A.S.T.A to B.S.1362 should be used.</p>
D3-4-2-1-2_En		

WARNING: The apparatus is not waterproofs, to prevent fire or shocks hazard, do not expose this apparatus to rain or moisture and do not put any water source near this apparatus, such as vase, flower pot, cosmetics container and medicine bottle etc.

D3-4-2-1-3_En

WARNING:
BEFORE PLUGGING IN THE UNIT FOR THE FIRST TIME, READ THE FOLLOWING SECTION CAREFULLY. The voltage of the available power supply differs according to country or region. Be sure that the power supply voltage of the area where this unit will be used meets the required voltage (e.g., 230V or 120V) written on the rear panel.

D3-4-2-1-4_En

WARNING: No naked flame sources, such as lighted candle, should be placed on the apparatus. If naked flame sources accidentally fall down, fire spread over the apparatus then may cause fire.

D3-4-2-1-7a_En

VENTILATION:

European, UK, Australian, New Zealand, Hong Kong and Taiwanese models:

When installing this unit, make sure to leave space around the unit for ventilation to improve heat radiation (at least 10 cm at top, 10 cm at rear, and 10 cm at each side).

All other models:

When installing this unit, make sure to leave space around the unit for ventilation to improve heat radiation (at least 20 cm at top, 15 cm at rear, and 15 cm at each side).

WARNING: Slot and openings in the cabinet are provided for ventilation and to ensure reliable operation of the product and to protect it from overheating, to prevent fire hazard, the openings should never be blocked and covered with items, such as newspapers, table-cloths, curtains, etc. Also do not put the apparatus on the thick carpet, bed, sofa, or fabric having a thick pile.

D3-4-2-1-7b_En

CAUTION

This product contains a laser diode of higher class than 1. To ensure continued safety, do not remove any covers or attempt to gain access to the inside of the product.

Refer all servicing to qualified personnel.

The following caution label appears on your unit.



D3-4-2-1-8_En

CAUTION : USE OF CONTROLS OR ADJUSTMENTS OR PERFORMANCE OF PROCEDURES OTHER THAN THOSE SPECIFIED HEREIN MAY RESULT IN HAZARDOUS RADIATION EXPOSURE.

CAUTION : THE USE OF OPTICAL INSTRUMENTS WITH THIS PRODUCT WILL INCREASE EYE HAZARD. D6-8-2-1_En

This product complies with the Low Voltage Directive (73/23/EEC, amended by 93/68/EEC), EMC Directives (89/336/EEC, amended by 92/31/EEC and 93/68/EEC).

D3-4-2-1-9a_En

For U.S. and Australia Model



C67-7-3_En

Operating Environment

Operating environment temperature and humidity:
+5 °C – +35 °C (+41 °F – +95 °F); less than 85 %RH
(cooling vents not blocked)

Do not install in the following locations

- Location exposed to direct sunlight or strong artificial light
- Location exposed to high humidity, or poorly ventilated location

D3-4-2-1-7c_En

The STANDBY/ON switch is secondary connected and therefore, does not separate the unit from mains power in STANDBY position. Therefore install the unit suitable places easy to disconnect the MAINS plug in case of the accident. The MAINS plug of unit should be unplugged from the wall socket when left unused for a long period of time.

D3-4-2-2a_En

CAUTION

These speaker terminals can be under **HAZARDOUS VOLTAGE**. When you connect or disconnect the speaker cables, to prevent the risk of electric shock, do not touch uninsulated parts before disconnecting the power cord.

D3-4-2-2-3_En

Thank you for buying this Pioneer product.

Please read through these operating instructions so that you will know how to operate your model properly. After you have finished reading the instructions, put them in a safe place for future reference.

Contents

01 Before you start

Features	6
Disc / content format playback compatibility	6
CD-R/RW compatibility	7
DVD-R/RW compatibility	7
PC-created disc compatibility	7
Compressed audio compatibility	7
About WMA	7
JPEG file compatibility	7

02 Controls and displays

Front panel	8
Display	9
Remote control	10

03 Getting started

Switching on and setting up	13
Setting the clock	14
Home theater sound setup	15
Using the Room Setup	15
Setting up the remote to control your TV	16
Using the on-screen displays	16
Playing discs	17
Basic playback controls	17
Resume and Last Memory	18
DVD-Video disc menus	19
Video CD/Super VCD PBC menus	20
Listening to the radio	20
Improving poor FM reception	21
Memorizing stations	21
Listening to station presets	22
Listening to other sources	22

04 Listening to your system

About the listening modes	23
Auto listening mode	23

Listening in surround sound	24
Dolby Pro Logic II Music settings	24
Using the Advanced Surround effects	25
Using Front Surround	25
Adjusting the Advanced and Front Surround effect level	26
Listening in stereo	26
Listening with headphones	26
Enhancing dialogue	27
Listening with a virtual surround back speaker	27
Using Quiet and Midnight listening modes	27
Adjusting the bass and treble	28
Boosting the bass level	28

05 Playing discs

Scanning discs	29
Playing in slow motion	29
Frame advance/frame reverse	29
Using the Disc Navigator to browse the contents of a disc	30
Looping a section of a disc	31
Using repeat play	31
Using random play	32
Creating a program list	33
Using the OSD	33
Other functions available from the program menu	33
Using the front panel display	34
Clearing the program list	34
Searching a disc	34
Switching subtitles	35
Switching the DVD audio language	35
Switching VR format DVD-RW audio channel	36
Switching the Video CD/Super VCD audio channel	36

Zooming the screen	36	Connecting using the component video output	55
Switching camera angles	36	About progressive scan video	55
Displaying disc information	36	Using the SCART AV output	56
OSD disc information	36	Switching the TV audio input from SCART to RCA	57
Front panel display information	37	Using this unit with a Pioneer plasma display	57
06 Viewing JPEG discs		Using the SR+ mode with a Pioneer plasma display	58
Playing a JPEG slideshow	38	13 Additional information	
Using the JPEG Disc Navigator and Photo Browser	38	Optional system settings	59
Zooming the screen	39	System Setup menu options in standby	59
07 More tuner features: RDS		Watching NTSC on a PAL TV (MOD. PAL)	60
An introduction to RDS	40	Resetting the system	60
Displaying RDS information	41	Using and taking care of discs	61
Searching for RDS programs	41	Titles, chapters and tracks	61
08 Using the timer		DVD Video regions	61
Setting the wake-up timer	42	Handling discs	61
Turning the wake-up timer on/off	42	Storing discs	62
Setting the sleep timer	43	Discs to avoid	62
09 Surround sound and other settings		Proper installation and maintenance of this system	62
Using the System Setup menu	44	Hints on installation	62
Surround and sound setup options	44	Cleaning the pickup lens	63
SR+ control options for Pioneer plasma displays	45	Problems with condensation	63
Setting the channel levels	46	Moving the system unit	63
10 Video Adjust menu		Power cord caution	63
Video Adjust	48	Troubleshooting	64
Creating your own presets	48	General	64
11 Initial Settings menu		DVD/CD/Video CD player	65
Using the Initial Settings menu	49	WMA/MP3/JPEG discs	66
Video Output settings	49	Tuner	66
Language settings	50	Error Messages	67
Display settings	51	Screen sizes and disc formats	68
Options	51	Widescreen TV users	68
Parental Lock	51	Standard TV users	68
12 Other connections		Selecting languages using the language code list	68
Connecting external antennas	53	Language code list	69
Connecting auxiliary components	53	Country code list	69
Recording mode	54	Preset code list	70
Connecting using the S-video output	55	Glossary	71
		Specifications	72

Chapter 1

Before you start

Features

- **24-bit/96kHz compatible DAC**

This system is fully compatible with high sampling-rate discs, capable of delivering exceptional sound quality in terms of dynamic range, low-level resolution and high-frequency detail.

- **Surround sound entertainment with Dolby Digital and DTS software**

The built-in Dolby Digital and DTS decoders let you enjoy great surround sound with Dolby Digital and DTS discs.

- **Pure Cinema progressive scan video**

Not applicable to the European model

When connected to a progressive scan-compatible TV or monitor using the component video outputs, you can enjoy extremely stable, flicker free images, with the same frame refresh rate as the original movie.

- **Picture zoom**

See *Zooming the screen* on page 36.

- **MP3 and WMA compatibility**

See *Compressed audio compatibility* on page 7.

- **JPEG compatibility**

See *JPEG file compatibility* on page 7.

- **Graphical on-screen displays**

Setting up and using your DVD home theater system is made very easy using the graphical on-screen displays.

- **Energy saving design**

This system is designed to use 0.5 W of power when in standby.

Disc / content format playback compatibility

This player is compatible with a wide range of disc types (media) and formats. Playable discs will generally feature one of the following logos on the disc and/or disc packaging. Note however that some disc types, such as recordable CD and DVD, may be in an unplayable format—see below for further compatibility information.



DVD-Video DVD-R DVD-RW



Audio CD Video CD CD-R CD-RW



Fujicolor CD

-  is a trademark of Fuji Photo Film Co. Ltd.
- Also compatible with KODAK Picture CD

This player supports the IEC's Super VCD standard for superior picture quality, dual soundtracks, and widescreen support.



Super Video CD (Super VCD)

CD-R/RW compatibility

- Compatible formats: CD-Audio, Video CD/ Super VCD, ISO 9660 CD-ROM* containing MP3, WMA or JPEG files
* ISO 9660 Level 1 or 2 compliant. CD physical format: Mode1, Mode2 XA Form1. Romeo and Joliet file systems are both compatible with this player.
- Multi-session playback: No
- Unfinalized disc playback: Yes

DVD-R/RW compatibility

- Compatible formats: DVD-Video, Video Recording (VR)*
* Edit points may not play exactly as edited; screen may go momentarily blank at edited points.
- Unfinalized playback: No
- WMA/MP3/JPEG file playback on DVD-R/RW: No

PC-created disc compatibility

Discs recorded using a personal computer may not be playable in this unit due to the setting of the application software used to create the disc. In these particular instances, check with the software publisher for more detailed information.

Discs recorded in packet write mode (UDF format) are not compatible with this player.

Check the DVD-R/RW or CD-R/RW software disc boxes for additional compatibility information.

Compressed audio compatibility

- Compatible formats: MPEG-1 Audio Layer 3 (MP3), Windows Media Audio (WMA)
- Sampling rates: 32, 44.1 or 48kHz
- Bit-rates: Any (128Kbps or higher recommended)
- VBR (variable bit rate) MP3 playback: Yes

- VBR WMA playback: No
- WMA lossless encoding compatible: No
- DRM (Digital Rights Management) compatible: Yes (DRM-protected audio files will *not* play in this player). See also DRM in the Glossary on page 71.
- File extensions: .mp3, .wma (these must be used for the player to recognize MP3 and WMA files – do not use for other file types)
- File structure: Up to 999 files per folder

About WMA



The Windows Media[®] logo printed on the box indicates that this player can playback Windows Media Audio content.

WMA is an acronym for Windows Media Audio and refers to an audio compression technology developed by Microsoft Corporation. WMA content can be encoded by using Windows Media[®] Player version 7, 7.1, Windows Media[®] Player for Windows[®] XP, or Windows Media[®] Player 9 Series.

Microsoft, Windows Media, and the Windows logo are trademarks, or registered trademarks of Microsoft Corporation in the United States and/or other countries.

JPEG file compatibility

- Compatible formats: Baseline JPEG and EXIF 2.1* still image files up to 8 megapixels are supported (maximum vertical and horizontal resolution is 5120 pixels).
*File format used by digital still cameras
- File extensions: .jpg (must be used for the player to recognize JPEG files – do not use for other file types)
- File structure: Up to 999 files per folder

Chapter 2

Controls and displays

Front panel

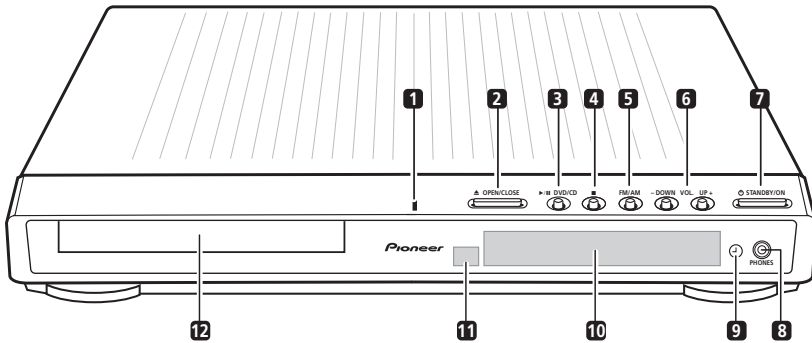
**1 Operation indicator****2 ▲ OPEN/CLOSE**

Press to open/close the disc tray.

3 ►/|| DVD/CD

Press to switch to the **DVD/CD** function. Also press to start/pause/resume playback.

4 ■

Press to stop playback.

5 FM/AM

Press to switch to the tuner function, then to toggle between the FM and AM bands.

6 VOLUME buttons

Use to adjust the volume.

7 ⏻ STANDBY/ON

Press to switch the system on or into standby.

8 PHONES jack

Headphone jack.

9 Timer indicator

Lights when the wake-up timer is set (page 42).

10 Display

See *Display* on page 9 for detailed information.

11 Remote sensor**12 Disc tray**

Display

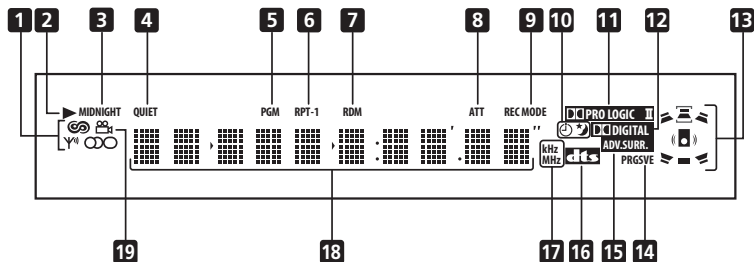

1 Tuner indicators



European model only

Lights when in one of the RDS display or search modes.



Lights when a broadcast is being received.



Lights when a stereo FM broadcast is being received in auto stereo mode.



Lights when FM mono reception is selected.

2 ►

Lights when a disc is playing.

3 MIDNIGHT

Lights when the Midnight mode is selected (page 27).

4 QUIET

Lights when the Quiet mode is selected (page 27).

5 PGM

Lights when a program list has been programmed (page 33).

6 RPT and RPT-1

RPT lights during repeat play. RPT-1 lights during repeat one-track play (page 31).

7 RDM

Lights during random play (page 32).

8 ATT

Lights when the input attenuator is active for the currently selected analog input (page 59).

9 REC MODE

Lights when the Rec Mode is on (page 54).

10 Timer indicators



Lights when the wake-up timer is set (page 42).



Lights when the sleep timer is active (page 43).

11 PRO LOGIC II

Lights during Dolby Pro Logic II decoding (page 24).

12 DIGITAL

Lights during playback of a Dolby Digital source (page 24).

13 Speaker indicators

These show which speakers are being used to output the current source (they are not placement diagrams). The illustrations below show some example displays.



5.1 channel surround sound

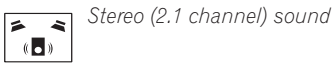

Stereo (2.1 channel) sound

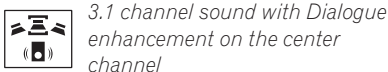

3.1 channel sound with Dialogue enhancement on the center channel

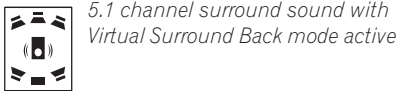

5.1 channel surround sound with Virtual Surround Back mode active

14 PRGSVE

Not applicable to the European model

Lights when progressive scan video output is selected (page 50).

15 ADV.SURR.

Lights when one of the Advanced or Front Surround listening modes is selected (page 25).

16

Lights during playback of a DTS source (page 24).

17 kHz / MHz

Indicates the unit of the frequency shown in the character display (**kHz** for AM, **MHz** for FM).

18 Character display

19

Lights during multi-angle scenes on a DVD disc (page 36).

Remote control

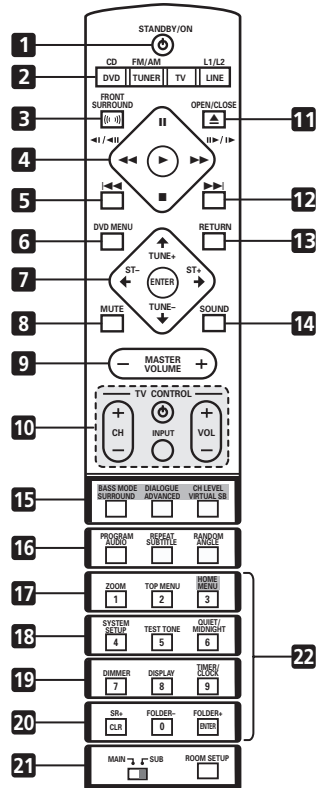

Important

- Functions printed in green on the remote control are accessed by switching the **MAIN/SUB** switch to **SUB**.

1 STANDBY/ON

Press to switch the system on or into standby.

2 Function select buttons

Press to select the source you want to listen to (**DVD (CD)**, **TUNER**, **TV**, **LINE**)

3 FRONT SURROUND

Use to select a Front Surround listening mode (page 25).

4 Disc playback controls



Press to start or resume playback.



Use for reverse slow motion playback, frame reverse and reverse scanning.



Use for forward slow motion playback, frame advance and forward scanning.



Press to pause playback; press again to restart.



Press to stop playback.

5 I◀◀

Press to jump to the beginning of the current chapter/track, then to previous chapters/tracks.

6 DVD MENU

Press to display a DVD disc menu, or the Disc Navigator if a VR format DVD-RW, CD, Video CD/Super VCD, MP3, WMA or JPEG disc is loaded.

7 Cursor buttons, ENTER and tuning buttons

Cursor buttons

Use the cursor buttons (↑/↓/←/→) to navigate on-screen displays and menus.

ENTER

Press to select an option or execute a command.

TUNE +/-

Use to tune the radio.

ST +/-

Use to select station presets when listening to the radio.

8 MUTE

Press to mute all sound from the speakers and headphones (press again to cancel).

9 MASTER VOLUME

Use to adjust the volume.

10 TV CONTROL (page 16)



Press to switch the TV on or into standby.

INPUT

Press to switch the TV input.

CH +/-

Use to select channels on the TV.

VOL +/-

Use to adjust the volume on the TV.

11 ▲ OPEN/CLOSE

Press to open/close the disc tray.

12 ▶▶

Press to jump to the next chapter/track.

13 RETURN

Press to return to a previous menu screen.

14 SOUND

Press to access the sound menu, from which you can adjust the DSP effect level, bass and treble, etc.

15 Surround sound mode/sound enhancement buttons

SURROUND

Use to select a Surround mode (page 24).

ADVANCED

Use to select an Advanced Surround mode (page 25).

VIRTUAL SB

Press to switch the Virtual Surround Back speaker effect on/off (page 27).

BASS MODE

Use to select a Bass Mode (page 28).

DIALOGUE

Use to select a Dialogue mode (page 27).

CH LEVEL

Use to adjust the speaker level (page 46).

16 DVD/CD buttons**AUDIO**

Press to select an audio channel or language (page 35).

SUBTITLE

Press to display/change the DVD subtitle display (page 35).

ANGLE

Press to change camera angle during DVD multi-angle scene playback (page 36).

PROGRAM

Use to program/play a program list (page 33–34).

REPEAT

Use to select a repeat play mode (page 31).

RANDOM

Use to select a random play mode (page 32).

17 ZOOM

Press to change the screen zoom level (page 36).

TOP MENU

Use to display the top menu of a DVD disc in the play position (this may be the same as pressing **DVD MENU**).

HOME MENU

Press to display (or exit) the on-screen menu for Initial Settings, Play Mode functions, etc.

18 SYSTEM SETUP

Use to make various system and surround sound settings (page 44).

TEST TONE

Use to output the test tone (for speaker setup) (page 46).

QUIET/MIDNIGHT

Use to select the Quiet and Midnight modes (page 27).

19 DIMMER

Press to switch between normal and dimmed front panel display.

DISPLAY

Press to display/change disc information shown on-screen (page 36).

TIMER/CLOCK

Press to display the clock and to access the timer menu (page 14 and page 42).

20 SR+

Press to switch the SR+ mode on/off (page 58).

FOLDER –

Press to jump to previous folders.

FOLDER +

Press to jump to the next folder.

CLR

Press to clear an entry.

ENTER

Selects menu options, etc. (works exactly the same as the **ENTER** button in **7** above).

21 MAIN/SUB

Change from **MAIN** to **SUB** to access the functions/commands printed in green on the remote.

ROOM SETUP

Press to start Room Setup (page 15).

22 Number buttons

Use the number buttons for selecting chapters/tracks from a disc directly.

Chapter 3

Getting started

Switching on and setting up

After making sure everything is connected up properly, you're ready to switch on. The first thing to do is to tell the system what kind of TV you're using, standard or widescreen.

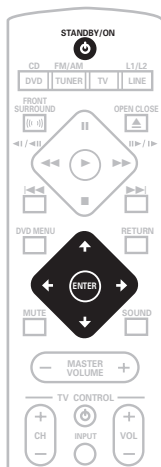

After that you can set up the surround sound for your room, and set the clock so that you can use the timer features.



1 Press  STANDBY/ON (on the remote or the front panel) to switch the system on. Also make sure that your TV is switched on and that the video input is set to this system (for example, if you connected this system to the **VIDEO 1** input on your TV, switch your TV to **VIDEO 1**).

2 Follow the directions that appear on the on-screen display.

European model:

- Use the / (cursor up/down) buttons to choose a language, then press **ENTER**.

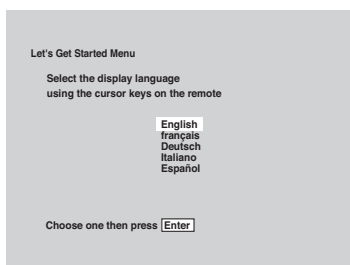

All other models:

- After you're finished reading the welcome screen, press **ENTER** to move on.

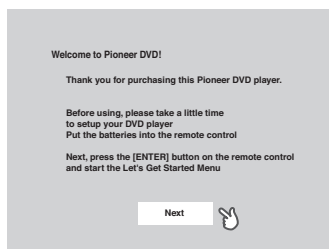

3 Use the **←/→** (cursor left/right) buttons to select either 'Wide screen (16:9)' or 'Standard size screen (4:3)' according to the kind of TV you have, then press **ENTER**.

See also *Screen sizes and disc formats* on page 68 if you're not sure which one to choose.

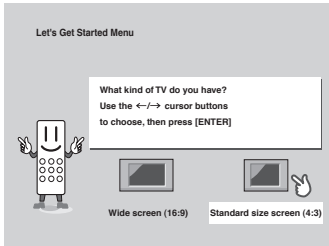

4 Press **ENTER** again to finish setting up.

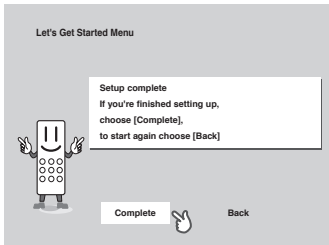

- Use the **→** (cursor right) button to select **Back** then press **ENTER** if you want to go back and change the setting you just made.

Tip

- You can also use the function buttons (**DVD/CD**, **TUNER**, etc.) or the **▲ OPEN/CLOSE** button to switch the system on from standby.

Setting the clock

Setting the clock allows you to use the timer features.

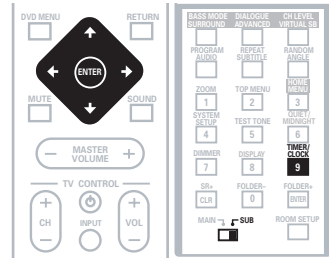

1 Press **TIMER/CLOCK**.

- If you are adjusting the clock, rather than setting it for the first time, press **TIMER/CLOCK** again.

2 If 'Clock ADJ?' isn't already showing in the display, press **←** or **→** (cursor left or right) until you see it.

3 Press **ENTER**.

4 Use the **↑/↓** (cursor up/down) buttons to set the hour.

5 Press **ENTER**.

6 Use the **↑/↓** (cursor up/down) buttons to set the minute.

7 Press **ENTER** to confirm.

The display flashes to indicate the clock is set.

Tip

- Press **TIMER/CLOCK** anytime to display the clock.

Note

- If you unplug the system from the wall outlet, or there is a power outage, you will need to set the clock again.

Home theater sound setup

Depending on the size and characteristics of your room, you can choose to place your speakers in one of two ways using this system:

- **Standard surround 5-spot setup** – This is a standard multichannel surround sound speaker setup for optimal 5.1 channel home theatre sound.

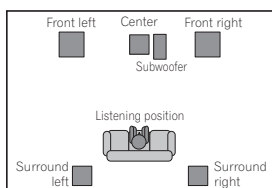

- **Front surround 3-spot setup** – This setup is ideal when rear surround speaker placement isn't possible or you want to avoid running long speaker cables in your listening area. Use this setup together with the Front Surround modes to take advantage of wall and ceiling reflections for a very realistic surround effect.

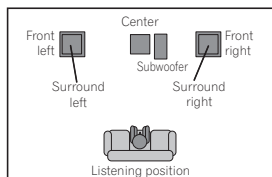

See *About the listening modes* on page 23 for more on using the different listening modes with each speaker setup.

Using the Room Setup

After you have set up your speakers to your liking (see *Home theater sound setup* above), make sure you calibrate your system for surround sound. This is a quick and easy way to get good surround sound for your room.

For a more detailed surround sound setup, see *Using the System Setup menu* on page 44.

- 1 **If the system isn't already on, press \odot STANDBY/ON to switch it on.**
- 2 **Press ROOM SETUP.**
 - If you have previously set up the room type and seating position, the display will show the current room settings.
- 3 **Press ENTER.**
- 4 **Use the \uparrow/\downarrow (cursor up/down) buttons to select a room type then press ENTER.** Choose one of the following depending on your room size:
 - **S** – Smaller than average room
 - **M** – Average room
 - **L** – Larger than average room
- 5 **Use the \uparrow/\downarrow (cursor up/down) buttons to select a seating position setting, then press ENTER.**

Choose one of the following depending on where your main listening position is:

- **Fwd** – If you are nearer to the front speakers than the surround speakers
- **Mid** – If you are equal distance from the front and surround speakers
- **Back** – If you are nearer to the surround speakers than the front speakers

Note

- The Room Setup automatically sets up both channel level and channel delay. If you have already set the channel levels manually (see *Setting the channel levels* on page 46), you will see **Room Set?** in the display when you first press the **ROOM SETUP** button.

Setting up the remote to control your TV

You can set up the supplied remote to control your TV using the **TV CONTROL** buttons.

1 Switch on your TV.

2 Find the name of the manufacturer of your TV in the Preset code list on page 70.

Next to each manufacturer is one or more three digit codes. These tell the remote what kind of TV you have.

If the name of the manufacturer of your TV does not appear in the table, you won't be able to set up this remote to control your TV.

3 Point the remote at your TV, hold down the CLR button, then enter the three digit code for your TV.

The remote transmits an on/off signal to the TV. If you've entered the correct code, your TV should switch off.

If your TV doesn't turn off, repeat the procedure using the next code in the list until your TV switches off successfully. Once set, you can use the individual TV controls shown below.

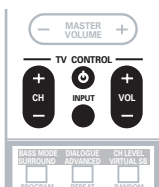

Button	What it does
	Switches your TV on or into standby.
CH +/-	Changes the TV channel.
VOL +/-	Adjusts the volume.
INPUT	Switches the TV's input between the built in TV tuner and an external video source.

Note

- The default setting is for a Pioneer TV.

Using the on-screen displays

For ease of use, this system makes extensive use of graphical on-screen displays (OSDs). You should get used to the way these work as you'll need to use them when setting up the system, using some of the playback features, such as program play, and when making more advanced settings for audio and video.

All the screens are navigated in basically the same way, using the cursor buttons (, , ,) to change the highlighted item and pressing **ENTER** to select it.

Important

- Throughout this manual, 'Select' means use the cursor buttons to highlight an item on-screen, then press **ENTER**.

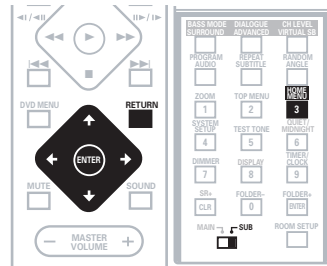

Button	What it does
HOME MENU	Displays/exits the on-screen display
	Changes the highlighted menu item

Button	What it does
ENTER	Selects the highlighted menu item (both ENTER buttons work in exactly the same way)
RETURN	Returns to the main menu without saving changes

**Tip**

- The button guide at the bottom of every OSD screen shows you which buttons you'll need to use for that screen.

Playing discs

The basic playback controls for playing DVD, CD, Video CD/Super VCD and WMA/MP3 discs are covered here. Further functions are detailed in chapter 5.

- 1 If the player isn't already on, press STANDBY/ON to switch it on.**

If you're playing a DVD or Video CD/Super VCD, also turn on your TV and make sure that it is set to the correct video input.

- 2 Press OPEN/CLOSE to open the disc tray.**

- 3 Load a disc.**

Load a disc with the label side facing up, using the disc tray guide to align the disc (if you're loading a double-sided DVD disc, load it with the side you want to play face down).

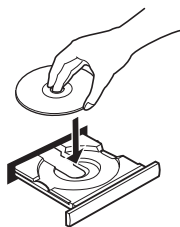

- 4 Press (play) to start playback.**

If you're playing a DVD or Video CD/Super VCD, a menu may appear. See *DVD-Video disc menus* on page 19 and *Video CD/Super VCD PBC menus* on page 20 for how to navigate these.

If you're playing an WMA/MP3 disc, it may take a few seconds before playback starts, depending on the complexity of the file structure on the disc.

If you loaded a CD/CD-R/RW containing JPEGs, a slideshow will start. See *Viewing JPEG discs* on page 38 for more on playing these discs.

- See also *Options* on page 51 if the disc contains both WMA/MP3 audio files and JPEG picture files.

- 5 Use the **MASTER VOLUME - / +** button (or the front panel **VOLUME** buttons) to adjust the volume.**

Basic playback controls

The following table shows the basic controls on the remote for playing discs. You can find other playback features in the chapter 5.

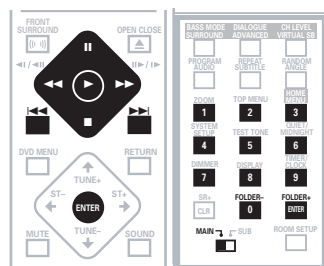

Button	What it does
▶	Starts playback. <i>DVD and Video CD:</i> If the display shows Resume or Last Mem playback starts from the resume or last memory point (see also <i>Resume and Last Memory</i> below.)
	Pauses a disc that's playing, or restarts a paused disc.
■	Stops playback. <i>DVD and Video CD:</i> The display shows Resume . Press ■ again if you want to cancel the resume function. (See also <i>Resume and Last Memory</i> below.)
◀◀	Press to start fast reverse scanning. Press ▶ (play) to resume normal playback.
▶▶	Press to start fast forward scanning. Press ▶ (play) to resume normal playback.
◀◀	Skips to the start of the current track or chapter, then to previous tracks/chapters.
▶▶	Skips to the next track or chapter.
FOLDER +/-	Skips to the next/previous folder when playing an WMA/MP3 disc.

Button	What it does
Numbers	<ul style="list-style-type: none"> • If the disc is stopped, playback starts from the selected title (for DVD) or track number (for CD/Video CD/<i>Super VCD</i>/WMA/MP3) after a few seconds (or after pressing ENTER). • If the disc is playing, playback jumps to the start of the selected chapter or track after a few seconds (or after pressing ENTER).



Note

- You may find with some DVD discs that some playback controls don't work in certain parts of the disc. This is not a malfunction.
- Track skip and number buttons for track selection do not work with unfinalized CD-R/RW discs.

Using the front panel controls

The ▲ **OPEN/CLOSE**, ▶/|| **DVD/CD, FM/AM** and ■ (stop) buttons work the same way as the remote control equivalents.

Resume and Last Memory

When you stop playback of a DVD or Video CD disc, **Resume** shows in the display indicating that you can resume playback from that point. If the disc tray is not opened, the next time you start playback the display shows **Resume** and playback resumes from the resume point. For DVD discs only: If you take the disc out of the player, the play position is stored in memory. When you load the disc next time, the display shows **Last Mem** and you can resume playback (this works for up to five discs). If you want to clear the resume/last memory point, press ■ (stop) while **Resume** or **Last Mem** is displayed.

Note

- When a Video CD is loaded, the Resume point is lost if the system is switched off, or switched to a function other than **DVD (CD)**.
- For the Last Memory function to work, you must press ■ (stop) to stop playback before opening the disc tray.
- The Last Memory function doesn't work with VR format DVD-RW discs.

FAQ

- *After I load a DVD disc, it ejects automatically after a few seconds!*

Most likely, the disc is the wrong region for your system. The region number should be printed on the disc; check it against the region number of the system (which you can find on the rear panel). See also *DVD Video regions* on page 61.

If the region number is OK, it may be that the disc is damaged or dirty. Clean the disc and look for signs of damage. See also *Using and taking care of discs* on page 61.

- *Why won't the disc I loaded play?*

First check that you loaded the disc the right way up (label side up), and that it's clean and not damaged. See *Using and taking care of discs* on page 61 for information on cleaning discs.

If a disc loaded correctly won't play, it's probably an incompatible format or disc type, such as DVD-Audio or DVD-ROM. See *Disc / content format playback compatibility* on page 6 for more on disc compatibility.

- *I have a widescreen TV so why are there black bars at the top and bottom of the screen when I play some discs?*

Some movie formats are such that even when played on a widescreen TV, black bars are necessary at the top and bottom of the screen. This is not a malfunction.

- *I have a standard (4:3) TV and set the system to show widescreen DVDs in pan & scan format, so why do I still get black bars top and bottom with some discs?*

Some discs override the display preferences of the system, so even if you have **4:3 (Pan & Scan)** selected, those discs will still be shown in letterbox format. This is not a malfunction.

DVD-Video disc menus

Many DVD-Video discs contain menus from which you can select what you want to watch. They may give access to additional features, such as subtitle and audio language selection, or special features such as slideshows. See the disc packaging for details.

Sometimes DVD-Video menus are displayed automatically when you start playback; others only appear when you press **DVD MENU** or **TOP MENU**.

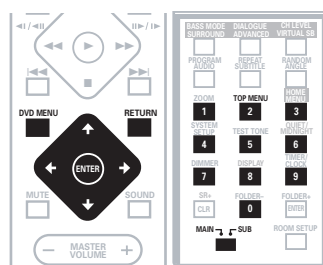

Button	What it does
TOP MENU	Displays the 'top menu' of a DVD disc—this varies with the disc.
DVD MENU	Displays a DVD disc menu—this varies with the disc and may be the same as the 'top menu'.
← ↑ ↓ →	Moves the cursor around the screen.
ENTER	Selects the current menu option.
RETURN	Returns to the previously displayed menu screen.
Numbers	Highlights a numbered menu option (some discs only). Press ENTER to select.

Video CD/Super VCD PBC menus

Some Video CD/Super VCDs have menus from which you can choose what you want to watch. These are called PBC (Playback control) menus.

You can play a PBC Video CD/Super VCD without having to navigate the PBC menu by pressing **■** (stop) then starting playback using a number button to select a track, rather than **▶** (play) (or **▶/||** on the front panel).

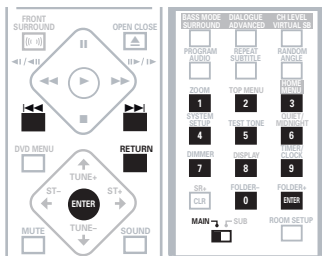

Button	What it does
RETURN	Displays the PBC menu.
Numbers	Selects a numbered menu option.
◀◀	Displays the previous menu page (if there is one).
▶▶	Displays the next menu page (if there is one).
ENTER	Press to select highlighted menu option.

Listening to the radio

The tuner can receive both FM and AM broadcasts, and lets you memorize your favorite stations so you don't have to manually tune in every time you want to listen. For more on using the radio, see *More tuner features: RDS* on page 40.

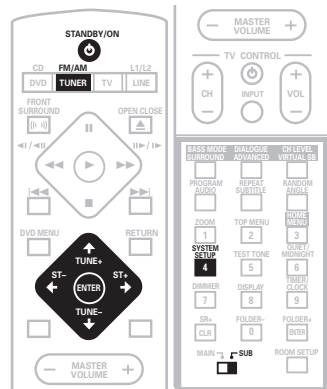

- 1 If the system isn't already on, press **⏻** STANDBY/ON to switch on.

2 Press TUNER to switch to the tuner, then press repeatedly to select the AM or FM band.

The display shows the tuner band and frequency.

- If you're using the front panel controls, the **TUNER** button switches between FM, AM and station presets (see *Memorizing stations* below).

3 Tune to a frequency.

There are three tuning modes—manual, auto, and high-speed:

- **Manual tuning:** Press **TUNE +/-** repeatedly to change the displayed frequency.
- **Auto tuning:** Press and hold **TUNE +/-** until the frequency display starts to move, then release. The tuner will stop on the next station it finds. Repeat to search for other stations.
- **High-speed tuning:** Press and hold **TUNE +/-** until the frequency display starts to move rapidly. Keep the button held down until you reach the frequency you want. If necessary, fine tune the frequency using the manual tuning method.

Improving poor FM reception

If you're listening to an FM station in stereo but the reception is weak, you can improve the sound quality by switching to mono.

- 1 Tune to an FM radio station.
- 2 Press **SYSTEM SETUP**.
- 3 Use the **←/→** (cursor left/right) buttons to choose 'FM Mode?' then press **ENTER**.
- 4 Use the **↑/↓** (cursor up/down) buttons to select 'FM Mono' then press **ENTER**.

The mono indicator (○) lights when the tuner is in mono reception mode.

Select **Auto** above to switch back to auto-stereo mode (the stereo indicator (Ⓢ) lights when receiving a stereo broadcast).

Memorizing stations

You can save up to 30 station presets so that you always have easy access to your favorite stations without having to tune in manually each time.

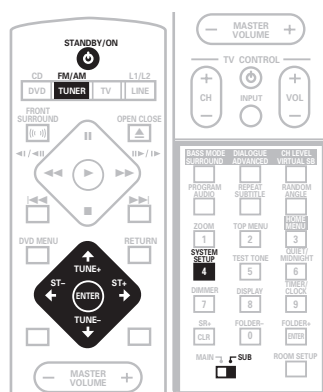

1 Tune to an AM or FM radio station.

For the FM band, select mono or auto-stereo reception as necessary. This setting is saved along with the preset.

2 Press **SYSTEM SETUP**.

3 Use the **←/→** (cursor left/right) buttons to choose 'St. Memory?' then press **ENTER**.

4 Use the **↑/↓** (cursor up/down) buttons to select the station preset you want.

There are 30 preset locations; each can store one station preset.

5 Press **ENTER** to save the station preset.

**Note**

- If the system is unplugged from the power supply completely, saved stations will remain for several days, after which you'll have to save them again.

Listening to station presets

- 1 Make sure the TUNER function is selected.**
- 2 Use the ST +/- buttons to select a station preset.**

Listening to other sources

You can connect up to three external sources (TV, satellite receiver, etc.) to this system, including one digital source. See also *Connecting auxiliary components* on page 53.



- 1 If the system isn't already on, press  STANDBY/ON to switch on.** Also make sure that the external source (TV, satellite receiver, etc.) is switched on.
- 2 Select the source you want to listen to.**
 - If you're using the remote control, press **TV** to select the **TV IN** input, or use the **LINE (L1/L2)** button to select the **LINE 1** or **LINE 2** input.
- 3 If necessary, start playback of the external source.**

Chapter 4

Listening to your system

About the listening modes

As explained in *Home theater sound setup* on page 15, there are two basic surround speaker setup options available. Of course you can select any of the listening modes regardless of how you place your speakers, but you will achieve the best surround effect by using the listening modes in conjunction with your speaker setup:

- **Standard surround 5-spot setup** – Use the Standard (*Listening in surround sound* on page 24) and Advanced (*Using the Advanced Surround effects* on page 25) surround listening modes with this setup.
- **Front surround 3-spot setup** – See *Using Front Surround* on page 25 for the options available with this speaker setup.

Make sure you have completed *Using the Room Setup* on page 15. For a more detailed surround sound setup, see *Using the System Setup menu* on page 44.

 **Note**

- Certain features explained in this section may not be possible depending on the source (for example, 88.2 / 96 kHz sources), or a conflicting system setting. See *Error Messages* on page 67 for more on this.

Auto listening mode

The Auto listening mode is the simplest way to listen to any source as it was mastered: the output from the speakers mirrors the channels in the source material.

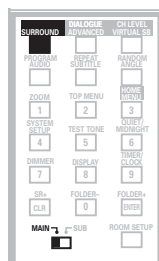

- **Press SURROUND to select the 'Auto' listening mode.**

If the source is Dolby Digital or DTS, the  **DIGITAL** or  **DTS** indicator on the front panel lights.

 **Note**

- Any previously active Dolby Pro Logic or Advanced Surround mode is canceled when Auto listening mode is selected.

Using the Advanced Surround effects

The Advanced Surround effects can be used with any multichannel or stereo source for a variety of additional surround sound effects. The 5-spot setup described in *Home theater sound setup* on page 15 should be used with these effects.

For more options, see *Adjusting the Advanced and Front Surround effect level* below.

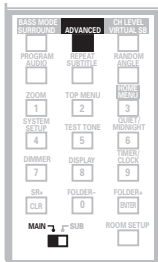

- Press **ADVANCED** to select an Advanced Surround mode (or press **ADVANCED** then use the **↑/↓** buttons).

Press repeatedly to select from:

- **Adv. Movie** – Gives a movie theater-type sound
- **Adv. Music** – Gives a concert hall-type sound
- **Expanded** – Creates an extra wide surround field
- **TV Surr.** – Designed for mono or stereo TV broadcasts and other sources
- **Sports** – Designed for sports and other programs based on commentary
- **Game** – Creates surround sound from video game sources
- **5ch Stereo** – Designed to give powerful surround sound to stereo music sources

Using Front Surround

The Front Surround modes are effective when you are using the Front surround 3-spot speaker setup as described in *Home theater sound setup* on page 15. The surround speakers should be placed on top of the front speakers and oriented either toward the walls, or straight ahead, depending on which mode you are using (see below).

For more options, see *Adjusting the Advanced and Front Surround effect level* below.



- Press **FRONT SURROUND** to select an Front Surround mode (or press **FRONT SURROUND** then use the **↑/↓** buttons).

Press repeatedly to select from:

- **Frnt. Movie** – The Front Surround Movie mode emphasizes directionality, giving you a realistic movie theater-type sound.
- **Frnt. Music** – The Front Surround Music mode provides greater breadth and depth to music sources, enveloping you with a concert hall-type sound.
- **ExtraPower** – The Extra Power mode gives additional energy and depth to a stereo source by using the surround speakers in addition to the front speakers.

If you have selected **Frnt. Movie** or **Frnt. Music**, you will achieve best results by turning each surround speaker about 50° towards the closest wall. With **ExtraPower**, orient the surround speakers in the same direction as the front speakers (towards the listening position).

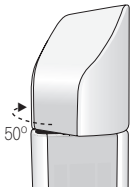

Frnt. Movie / Frnt. Music



Extra Power

- When turning, you will feel the surround speaker snap correctly into place. Do not force the speaker to turn past this point.

Adjusting the Advanced and Front Surround effect level

You can emphasize or reduce the effect of the Advanced and Front Surround modes as you like. You can set the effect level for all modes independently.

- 1 With one of the Advanced or Front Surround modes active, press **SOUND**.
- 2 Use the **←/→** (cursor left/right) buttons to select 'Effect'.
- 3 Use the **↑/↓** (cursor up/down) buttons to adjust the effect level.
The effect level can be adjusted from **10** (min) to **90** (max).
- 4 Press **ENTER** to confirm.

Listening in stereo

You can listen to any source—stereo or multichannel, analog or digital—in stereo. When playing a multichannel source, stereo sound is created by downmixing all channels to the front left/right speakers and the subwoofer.

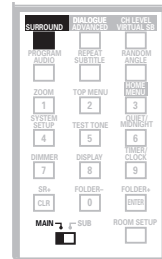

- Press **SURROUND** repeatedly until 'Stereo' shows in the display.

Any active Advanced or Front Surround mode is canceled.

Listening with headphones

When headphones are connected, only the **Stereo** (default) and **Phones Surround** (virtual surround sound for headphones) modes are available.

When you disconnect them it reverts to the previous mode.

- With headphones connected, press **ADVANCED** or **FRONT SURROUND** to select 'Phones Surround' or **SURROUND** to select 'Stereo'.

Enhancing dialogue

- Default setting: **Dialog Off** (European model) / **Dialog Mid** (All other models)

The Dialogue Enhancement feature is designed to make the dialog stand out from other background sounds in a TV or movie soundtrack.

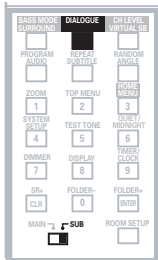

- Press **DIALOGUE** to select the amount dialog enhancement.

Press repeatedly to select from:

- **Dialog Off** – No dialog enhancement
- **Dialog Mid** – Moderate dialog enhancement
- **Dialog Max** – Strong dialog enhancement

Listening with a virtual surround back speaker

- Default setting: **Vir. SB Off**

The Virtual Surround Back feature can be used when listening in surround sound (using the 5-spot setup described in *Home theater sound setup* on page 15) to simulate an added

surround back channel. In a real theater the surround back speaker would be directly behind you, creating more cohesive and realistic surround sound.

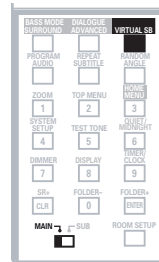

- Press **VIRTUAL SB** repeatedly to switch between 'Vir. SB On' and 'Vir. SB Off'.



Note

- You can't use Virtual Surround Back when using the **Stereo** listening mode (or **Auto** with stereo sources).
- If you are using the The Front surround 3-spot setup (see *Home theater sound setup* on page 15), switch the Virtual Surround Back feature off.
- If there is no surround channel, Virtual Surround Back has no effect.

Using Quiet and Midnight listening modes

- Default setting: **Off**

The Quiet listening feature reduces excessive bass or treble in a sound source. You can use this feature if the music is a little bit harsh and you would like a smoother sound.

The Midnight listening feature allows you to hear effective surround sound of movies at low volume levels. The effect automatically adjusts according to the volume at which you're listening.

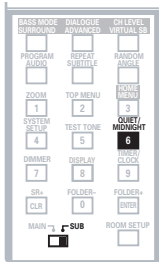

- Press **QUIET/MIDNIGHT** repeatedly to switch between 'Quiet', 'Midnight' and 'Off'.

Adjusting the bass and treble

Use the bass and treble controls to adjust the overall tone. Bass and treble adjustment is not possible when the Quiet or Midnight modes are active.

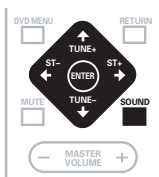

- 1 Press **SOUND**.
- 2 Use the **←/→** (cursor left/right) buttons to select 'Bass' or 'Treble'.
- 3 Use the **↑/↓** (cursor up/down) buttons to adjust the sound.

The bass and treble can be adjusted from **-3** to **+3**.

- 4 Press **ENTER** to confirm.

Boosting the bass level

There are three bass modes you can use to enhance the bass in a source.

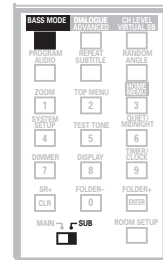

- Press **BASS MODE** repeatedly to choose an option that fits the source you're listening to.
 - **Music** – Can be used with music to give a deeper bass sound
 - **Cinema** – Good for action movies or movies with lots of sound effects
 - **P. Bass** – Can be used with music sources to bring the beat of the music (or soundtrack) to the forefront
 - **Off** – Switch off the bass boost if it causes excessive bass (i.e. it sounds 'boomy') in the source

Chapter 5

Playing discs



Note

- Some DVDs restrict the use of some functions (random or repeat, for example) in some or all parts of the disc. This is not a malfunction.
- When playing Video CD/Super VCDs, some of the functions are not available during PBC playback. If you want to use them, start the disc playing using a number button to select a track.
- Many features are not available when using unfinalized CD-R/RW discs.



Remember

- To access functions printed in green on the remote, move the slider switch from **MAIN** to **SUB**.

Scanning discs

You can fast-scan discs forward or backward at various different speeds.

1 During playback, press ◀◀ or ▶▶ to start scanning.

- There is no sound while scanning DVDs and Video CD/Super VCDs, and no subtitles while scanning DVDs.

2 Press repeatedly to increase the scanning speed.

- The scanning speed is shown on-screen.

3 To resume playback, press ▶ (play).

- When scanning a Video CD/Super VCD or a WMA/MP3 track, playback automatically resumes at the end or beginning of the track.

- Depending on the disc, normal playback may automatically resume when a new chapter is reached on a DVD disc.

Playing in slow motion

You can play DVDs and Video CD/Super VCDs at four different forward slow motion speeds. DVD discs can also be played at two reverse speeds.

1 During playback, press II (pause).

2 Press and hold ◀I/◀II or II/▶I until slow motion playback starts.

- The slow motion speed is shown on-screen.
- There is no sound during slow motion playback.

3 Press repeatedly to change the slow motion speed.

4 To resume normal playback, press ▶ (play).

- Depending on the disc, normal playback may automatically resume when a new chapter is reached.

Frame advance/frame reverse

You can advance or back up DVD discs frame-by-frame. With Video CD/Super VCDs you can only use frame advance.

- 1 During playback, press **II** (pause).
- 2 Press **◀|/◀◀** or **▶|/▶▶** to reverse or advance a frame at a time.
- 3 To resume normal playback, press **▶** (play).
 - Depending on the disc, normal playback may automatically resume when a new chapter is reached.

Using the Disc Navigator to browse the contents of a disc

Use the Disc Navigator to browse through the contents of a disc to find the part you want to play. You can use the Disc Navigator when a disc is playing or stopped (a disc must be loaded).

- 1 Press **HOME MENU** and select 'Disc Navigator' from the on-screen display.



- With most discs, you can also press **DVD MENU** to go directly to the Disc Navigator.

- 2 Select what you want to play.

Depending on the type of disc you have loaded, the Disc Navigator looks slightly different.

The screen for DVD discs shows the titles on the left and the chapters on the right. Select a title, or a chapter within a title.

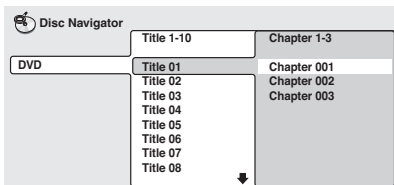

For a VR (Video Recording) mode DVD-RW disc select between the **Playlist** and **Original** areas of the disc, or a title. Press **➡** (cursor right) to preview the title.

- It's not possible to switch between **Original** and **Playlist** during playback.
- Not all VR format DVD-RW discs have a Playlist.

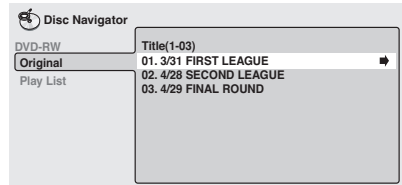

The screen for CDs and Video CD/Super VCDs shows a list of tracks.

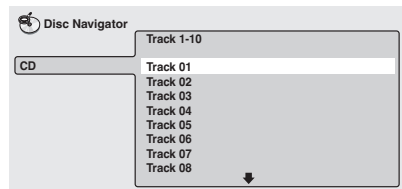

The screen for an WMA/MP3 disc shows the folder names on the left and the track names on the right (note that if there are more than 16 folders or names that contain accented or non-roman characters, tracks and folders may show up with generic names – **F_033**, **T_035**, etc.).

Select a folder, or a track within a folder.

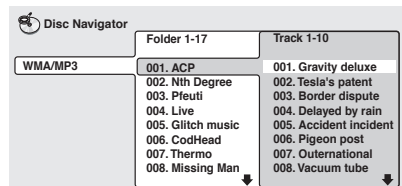

Playback starts after you press **ENTER**.



Tip

- Another way to find a particular place on a disc is to use one of the search modes. See *Searching a disc* on page 34.

Looping a section of a disc

The A-B Repeat function allows you to specify two points (A and B) within a track (CD and Video CD) or title (DVD) that form a loop which is played over and over.

- You can't use A-B Repeat with Super VCD or WMA/MP3 discs.

1 During playback, press HOME MENU and select 'Play Mode'.

2 Select 'A-B Repeat' from the list of functions on the left.

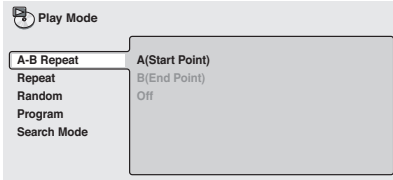

3 Press ENTER on 'A(Start Point)' to set the loop start point.

4 Press ENTER on 'B(End Point)' to set the loop end point.

After pressing **ENTER**, playback jumps back to the start point and plays the loop.

- The minimum loop time is 2 seconds.

5 To resume normal playback, select 'Off' from the menu.

Using repeat play

There are various repeat play options, depending on the kind of disc loaded. It's also possible to use repeat play together with program play to repeat the tracks/chapters in the program list (see *Creating a program list* on page 33). However, note that you can't use repeat and random play at the same time.

1 During playback, press HOME MENU and select 'Play Mode'.

2 Select 'Repeat' from the list of functions on the left.

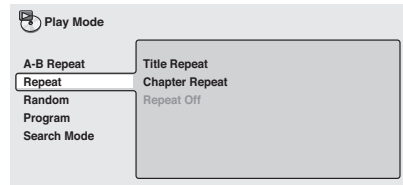

3 Select a repeat play option.

If program play is active, select **Program Repeat** to repeat the program list, or **Repeat Off** to cancel.

- For DVD discs, select **Title Repeat** or **Chapter Repeat** (or **Repeat Off**).

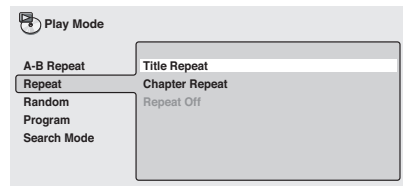

- For CDs and Video CD/Super VCDs, select **Disc Repeat** or **Track Repeat** (or **Repeat Off**).
- For WMA/MP3 discs, select **Disc Repeat**, **Folder Repeat** or **Track Repeat** (or **Repeat Off**).

**Tip**

- You can also use the **REPEAT** button on the remote to select a repeat play option. The repeat mode is indicated in the front panel display and on-screen. The repeat modes available are the same as when choosing from the **Play Mode** menu.
- If you've created a program list, **Program Repeat** is also available.
- During playback, you can cancel repeat play by pressing **CLR**.

Using random play

Use this function to play titles or chapters (DVD-Video) or tracks (CD, Video CD/Super VCD and WMA/MP3 discs) in a random order.

You can set the random play option when a disc is playing or stopped. However, you can't use random play together with program or repeat play.

- You can't use random play with VR format DVD-RW discs, or while a DVD disc menu is being displayed.

1 During playback, press HOME MENU and select 'Play Mode'.

2 Select 'Random' from the list of functions on the left.

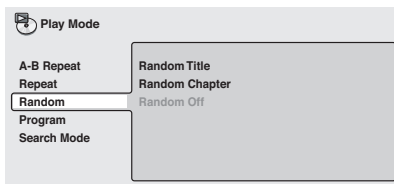

3 Select a random play option.

- For DVD discs, select **Random Title** or **Random Chapter**, (or **Random Off**).

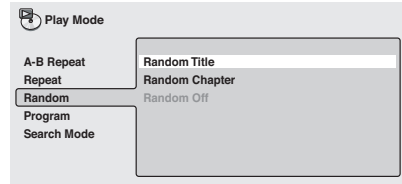

- For CDs and Video CD/Super VCDs, select **On** or **Off** to switch random play on or off.
- For WMA/MP3 discs, select **Random All** (all folders) or **Random Track** (current folder only), (or **Random Off**).

**Tip**

- Use the following controls during random play:

Button	What it does
■	Stop and cancel random play.
▶▶	Selects another track/chapter at random from those remaining.
◀◀	Returns to the beginning of the current track/chapter. You can't go back further than this.

- You can also use the **RANDOM** button on the remote to select a random play mode. The random mode is indicated in the front panel display and on-screen. The random modes available are the same as when choosing from the **Play Mode** menu. Press **ENTER** to start random play.
- To cancel random playback without stopping playback, press **CLR**. The disc will play to the end, then stop.

Creating a program list

This feature lets you program the play order of titles/chapters/folders/tracks on a disc.

- You can't use Program play with VR format DVD-RW discs, or while a DVD disc menu is being displayed.

Using the OSD

1 During playback, press HOME MENU and select 'Play Mode'.

2 Select 'Program' from the list of functions on the left.

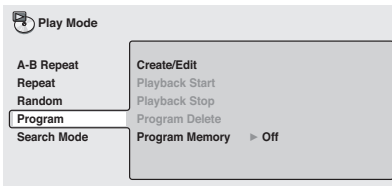

3 Select 'Create/Edit' from the list of program options.

4 Use the cursor buttons and ENTER to select a title, chapter, folder or track for the current step in the program list.

For a DVD disc, you can add a title or a chapter to the program list.

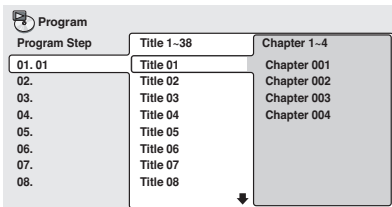

- For a CD or Video CD/Super VCD, select a track to add to the program list.
- For an WMA/MP3 disc, you can add a whole folder, or a track within a folder to the program list.

After pressing **ENTER** to select the title/chapter/folder/track, the step number automatically moves down one.

5 Repeat step 4 to build up a program list.

A program list can contain up to 24 titles/chapters/folders/tracks.

- You can insert steps into the middle of a program list by just highlighting the position where you want the new step to appear and entering a title/chapter/folder/track number.
- To delete a step, highlight it and press **CLR**.

6 To play the program list, press ► (play).

Program play remains active until you turn off program play (see below), erase the program list (see below), eject the disc or switch off the player.



Tip

- Use the following controls during program play:

Button	What it does
HOME MENU	Save the program list and exit the program edit screen without starting playback.
►►	Skip to the next step in the program list.
CLR	Switch off program play. Press while stopped to erase the program list.
RETURN	Exit the program edit screen without saving any changes.

Other functions available from the program menu

There are a number of other options in the program menu in addition to Create/Edit.

- **Playback Start** – Starts playback of a saved program list
- **Playback Stop** – Turns off program play, but does not erase the program list
- **Program Delete** – Erases the program list and turns off program play
- **Program Memory** (DVD only) – Select On to save the program list for the disc loaded. (Select **Off** to cancel the program memory for the disc loaded)

Using the front panel display

Even though the OSD is available for CDs and WMA/MP3 discs, the front panel display provides enough information to make a program list easily. If a disc is playing, stop it first.

1 Press PROGRAM.

You're prompted to enter a track or folder for the first step in the program list.

P - 00 0' 00"

2 Use ↑/↓ (cursor up/down) to select a track or a folder, then press ENTER.

- *For WMA/MP3 discs only:* To select an individual track within a folder, use the ↑/↓ (cursor up/down) buttons to select the folder, then press →, then use ↑/↓ (cursor up/down) to select a track. Press ENTER.

P - 01 5' 37"

Wait for the display to prompt you after completing each selection. If you make a mistake, press **CLR** to delete the last (most recently) programmed track.

3 Repeat step 2 to build up a program list.

A program list can contain up to 24 steps.

4 To play the program list, press ► (play).

Program play remains active until you press ■ (stop), clear the playlist (see below), eject the disc or switch off the player.

Clearing the program list

You must clear the program list to program a new one.

1 If a disc is playing, press ■ (stop).

2 Press CLR.



Note

- Program lists are saved for the DVD disc loaded. When you load a disc with a saved program list, program play is automatically turned on.
- You can save program lists for up to 24 discs. After that, the oldest one is replaced with the new one saved.

Searching a disc

You can search DVD discs by title or chapter number, or by time. CD/Super VCDs can be searched by track number, and Video CDs by track number or time. WMA/MP3 discs can be searched by folder or track number.

1 Press HOME MENU and select 'Play Mode'.

2 Select 'Search Mode' from the list of functions on the left.

The search options that appear depend on the kind of disc loaded. The screen below shows the DVD search options.

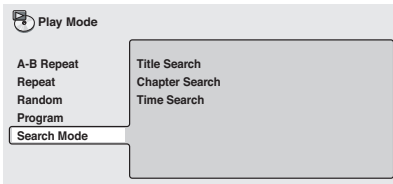

3 Select a search mode.

- The disc must be playing in order to use time search.

4 Use the number buttons to enter a title, chapter, folder or track number, or a time.

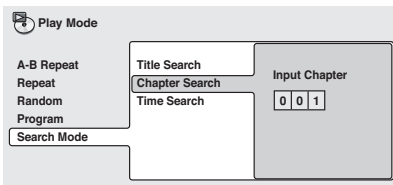

- For a time search, enter the number of minutes and seconds into the currently playing title (DVD) or track (Video CD) you want playback to resume from. For example, press **4, 5, 0, 0** to have playback start from 45 minutes into the disc. For 1 hour, 20 minutes and 30 seconds, press **8, 0, 3, 0**.

5 Press ENTER to start playback.

Switching subtitles

Some DVD discs have subtitles in one or more languages; the disc box will usually tell you which subtitle languages are available. You can switch subtitle language during playback.

- **Press SUBTITLE repeatedly to select a subtitle option.**

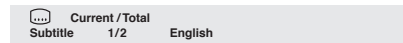

Note

- Some discs only allow you to change subtitle language from the disc menu. Press **TOP MENU** to access.
- To set subtitle preferences, see *Language settings* on page 50.

Switching the DVD audio language

When playing a DVD disc recorded with dialog in two or more languages, you can switch audio language during playback.

- **Press AUDIO repeatedly to select an audio language option.**

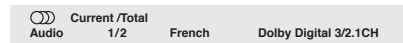

Note

- Some discs only allow you to change audio language from the disc menu. Press **TOP MENU** to access.
- To set audio language preferences, see *Language settings* on page 50.

Switching VR format DVD-RW audio channel

When playing a VR format DVD-RW disc recorded with dual-mono audio, you can switch between the main, sub, and mixed channels during playback.

1 Press **AUDIO** repeatedly to select an audio channel option.

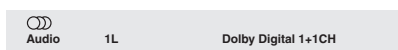

Switching the Video CD/Super VCD audio channel

When playing a Video CD/Super VCD, you can switch between stereo, just the left channel or just the right channel.

Some Super VCDs have two soundtracks. With these discs you can switch between the two soundtracks as well as individual channels in each.

• Press **AUDIO** repeatedly to select an audio channel option.



Zooming the screen

Using the zoom feature you can magnify a part of the screen by a factor of 2 or 4, while watching a DVD or Video CD/Super VCD or playing a JPEG disc.

1 During playback, use the **ZOOM** button to select the zoom factor (Normal, 2x or 4x).

- Since DVD, Video CD/Super VCD and JPEG pictures have a fixed resolution, picture quality will deteriorate, especially at 4x zoom. This is not a malfunction.

2 Use the cursor buttons to change the zoomed area.

You can change the zoom factor and the zoomed area freely during playback.

- If the navigation square at the top of the screen disappears, press **ZOOM** again to display it.

Note

- If you are displaying subtitles, these will disappear when the screen is zoomed. They will reappear when you return the screen to normal.

Switching camera angles

Some DVD discs feature scenes shot from two or more angles—check the disc box for details.

When a multi-angle scene is playing, a  icon appears on screen to let you know that other angles are available (this can be switched off if you prefer—see *Display settings* on page 51).

• During playback (or when paused), press **ANGLE** to switch angle.

Displaying disc information

OSD disc information

Various track, chapter and title information can be displayed on-screen while a disc is playing.

- To show/switch/hide the information displayed, press **DISPLAY** repeatedly.
 - When a disc is playing, the information appears at the top of the screen.

Front panel display information

Limited disc information also appears in the front panel display. Press **DISPLAY** to change the displayed information.

- DVD / DVD-RW displays

2 · 2 · 8' 49" Title no.
Chapter no.
Elapsed title time

2 · TTL · 1 07' 00" Title no.
Remaining title time

2 · 2 · 0' 42" Title no.
Chapter no.
Remaining chapter time

- CD and Video CD/Super VCD displays

4 · 1' 16" Track no.
Elapsed track time

4 · 3' 20" Track no.
Remaining track time
(*CD / Video CD only*)

Disc · 53' 15" Remaining disc time
(*CD / Video CD only*)

- WMA / MP3 disc displays

2 · 0' 35" Track no.
Elapsed track time

EVERYBOD Track name

BEST_OF Folder name

- JPEG disc displays

TIGER_01 File name

ZOO_TRIP Folder name

Chapter 6

Viewing JPEG discs

Playing a JPEG slideshow

After loading a CD/CD-R/RW containing JPEG pictures, press ► to start a slideshow from the first folder/picture on the disc. The player displays the pictures in each folder in alphabetical order.

Pictures are automatically adjusted so that they fill as much of the screen as possible (if the aspect ratio of the picture is different to your TV screen you may notice black bars at the sides, or at the top and bottom of the screen).

While the slideshow is running:

Button	What it does
II	Pauses the slideshow; press again to restart.
◀◀	Displays the previous picture.
▶▶	Displays the next picture.
ANGLE	Pauses the slideshow and rotates the currently displayed picture 90° clockwise. Press ► (play) to restart slideshow.
ZOOM	Pauses the slideshow and zooms the screen (see below). Press ► (play) to restart slideshow.
DVD MENU	Displays the Disc Navigator screen (see below).
FOLDER +/ FOLDER -	Skips to the next/previous folder when playing a JPEG disc.



Note

- The **II**, **ANGLE** and **ZOOM** buttons do not work while the display shows **LOADING**.
- The time it takes for the player to load a file increases with large file sizes.
- Up to 999 files are viewable on a disc. If there are more files than this on a disc, only the first 999 files are viewable.
- If you want to play the WMA/MP3 tracks on a disc that also contains JPEG picture files, you should first set the **Photoviewer** option to **Off**. See *Options* on page 51.

Using the JPEG Disc Navigator and Photo Browser

Use the JPEG Disc Navigator to find a particular folder or picture by filename on the disc in the play position; use the Photo Browser to find a picture within a folder by thumbnail image.

1 Press DVD MENU to display the Disc Navigator screen.

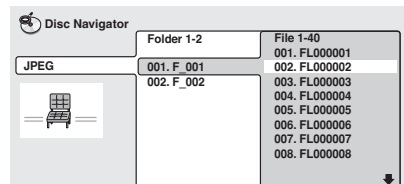

The left column shows the folders on the disc, the right column shows the files in a folder.

2 Use the cursor buttons (↑/↓/←/→) to navigate.

When a file is highlighted, a thumbnail image is displayed.

- When a folder is highlighted you can press **ENTER** to open the Photo Browser screen for that folder. See below for more on using the Photo Browser.

3 To resume the slideshow from the highlighted file, press **ENTER**.

Using the Photo Browser

The Photo Browser displays nine thumbnail images at a time from the current folder.

1 From the Disc Navigator screen, highlight a folder to display then press **ENTER**.

The Photo Browser screen opens with the first nine pictures displayed as thumbnails.

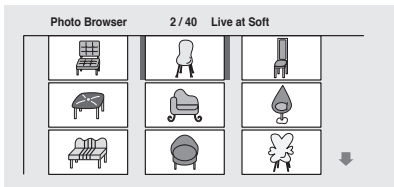

2 Use the cursor buttons (↑/↓/←/→) to highlight a thumbnail picture.

- Use the track skip buttons (◀◀ and ▶▶) to see the previous / next page of thumbnails. Keep the button pressed if you want to skip several pages; release when you reach the page you want.
- To return to the Disc Navigator screen, press **RETURN**.

3 Press **ENTER** to display the selected thumbnail full size on screen.

The slideshow resumes from the selected picture.

Zooming the screen

Using the zoom feature you can magnify a part of the screen by a factor of 2 or 4, while viewing pictures from a JPEG disc.

1 During slideshow playback, use the **ZOOM** button to select the zoom factor.

- **Normal**
- **2x**
- **4x**

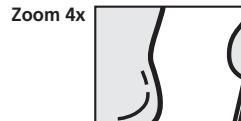
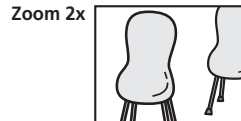
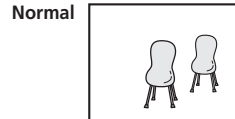

- The slideshow is paused when the screen is zoomed.
- Since JPEG pictures have a fixed resolution, picture quality may deteriorate, especially at 4x zoom. This is not a malfunction.

2 Use the cursor buttons (↑/↓/←/→) to change the zoomed area.

You can change the zoom factor and the zoomed area freely.

3 To resume the slideshow, press **▶** (play).

Chapter 7:

More tuner features: RDS

European model only

An introduction to RDS

Radio Data System, or RDS as it's usually known, is a system used by FM radio stations to provide listeners with various kinds of information—the name of the station and the kind of show they're broadcasting, for example. This information shows up as text on the display, and you can switch between the kind of information shown. Although you don't get RDS information from all FM radio stations, you do with most.

Probably the best feature of RDS is that you can search automatically by type of program. So, if you felt like listening to jazz, you could search for a station that's broadcasting a show with the program type, **Jazz**. There are around 30 such program types, including various genres of music, news, sport, talk shows, financial information, and so on.

The receiver lets you display three different kinds of RDS information: Radio Text, Program Service Name, and Program Type.

Radio Text (**RT**) is messages sent by the radio station. These can be anything the broadcaster chooses—a talk radio station might give out its telephone number as RT, for example.

Program Service Name (**PS**) is the name of the radio station.

Program Type (**PTY**) indicates the kind of program currently being broadcast.

The receiver can search for and display the following program types:

News – News

Affairs – Current affairs

Info – General information

Sport – Sport

Educate – Educational material

Drama – Radio plays or serials

Culture – National or regional culture, theater, etc.

Science – Science and technology

Varied – Usually talk-based material, such as quiz shows or interviews.

Pop M – Pop music

Rock M – Rock music

Easy M – Easy listening music

Light M – 'Light' classical music

Classics – 'Serious' classical music

Other M – Other music not fitting any of the above categories

Weather – Weather reports

Finance – Stock market reports, commerce, trading, etc.

Children – Programs for children

Social – Social affairs

Religion – Programs concerning religion

Phone In – Public expressing their views by phone

Travel – Holiday-type travel rather than traffic announcements

Leisure – Leisure interests and hobbies

Jazz – Jazz

Country – Country music

Nation M – Popular music in a language other than English

Oldies – Popular music from the '50s and '60s

Folk M – Folk music

Document – Documentaries

In addition, there are three other program types, **TEST**, **Alarm!**, and **None**. **Alarm!** and **TEST** are used for emergency announcements. You can't search for these, but the tuner will switch automatically to this RDS broadcast signal. **None** appears when a program type cannot be found.

Displaying RDS information

Use the **DISPLAY** button to display the different types of RDS information available (**RT**, **PS** and **PTY**).

- **Press DISPLAY to select the RDS information display.**

Each press changes the display as follows:

- **RT** – Radio Text display
- **PS** – Program Service display
- **PTY** – Program Type display
- **PTY SEARCH** – see *Searching for RDS programs* below
- Current tuner frequency



Note

- If any noise is picked up while displaying the RT scroll, some characters may be displayed incorrectly.
- If you see **No Data** in the RT display, it means no RT data is transmitted from the broadcast station. If you have entered a name for the station, it is broadcast instead of RT data. If you haven't, the display will automatically switch to the PS data display. If no PS data is transmitted from the station, the frequency will be displayed.
- In the PTY display, there are cases where **No Data** or **None** is shown. If this happens, the PS display is shown after a few seconds.

Searching for RDS programs

One of the most useful features of RDS is the ability to search for a particular kind of radio program. You can search for any of the program types listed on the previous page.

- 1 **Press the TUNER button to select the FM band.**

RDS is only possible in the FM band.

- 2 **Press DISPLAY repeatedly until PTY SEARCH appears in the display.**

- 3 **Use ←/→ (cursor left/right) to select the program type you want to hear.**

- 4 **Press ENTER to search for the program type.**

The system starts searching through the station presets for a match. When it finds one, the search stops and the station plays for five seconds.

- 5 **If you want to keep listening to the station, press ENTER within the 5 seconds.**

If you don't press **ENTER**, searching resumes.

Chapter 8

Using the timer

Setting the wake-up timer

Use the wake-up timer to set the system to switch on at any time and start playing whatever source you want.



Important

- The clock must be set to the correct time for the wake-up timer to work properly (see *Setting the clock* on page 14).

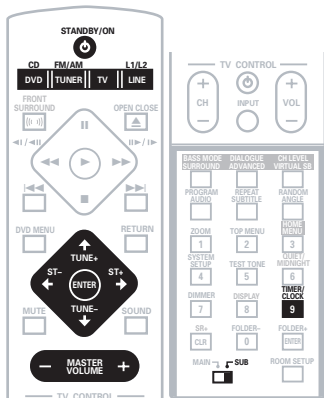

1 Select the source you want played.

For example, press **TUNER** (FM/AM on the front panel) to select the radio as your source.

2 Prepare the source.

For example, tune in the radio station you want to wake up to.

3 Set the volume.

4 Press **TIMER/CLOCK** twice to reach the timer menu.

5 Use the **←/→** (cursor left/right) buttons to select 'Wake-Up?' then press **ENTER**.

6 Use the **←/→** (cursor left/right) buttons to select 'TimerEdit' then press **ENTER**.

7 Set the switch-on time.

Use the **↑/↓** (cursor up/down) buttons to set the hour, then press **ENTER**. Set the minute in the same way, pressing **ENTER** when you're done.

8 Set the switch-off time.

Use the **↑/↓** (cursor up/down) buttons to set the hour, then press **ENTER**. Set the minute in the same way, pressing **ENTER** when you're done.

After pressing **ENTER** this last time, the wake-up indicator lights, and the switch-on, switch-off times, the function (**DVD/CD**, etc.) and volume are confirmed in the display.

9 Switch the system into standby mode.

The wake-up timer will not work if the system is left on!



Tip

- You can check the timer settings in standby by pressing **TIMER/CLOCK** twice. (Press **TIMER/CLOCK** once to display the current time.)

Turning the wake-up timer on/off

If the wake-up timer is on, it will switch on the system everyday at the time you have set.

- 1 Press **TIMER/CLOCK** twice to reach the timer menu.
- 2 Use the **←/→** (cursor left/right) buttons to select 'Wake-Up?' then press **ENTER**.
- 3 Use the **←/→** (cursor left/right) buttons to select 'Timer On?' or 'Timer Off?'.
 - You must have the timer set (see above) to select **ON**. The wake-up timer switches on and off according to your previous settings.
- 4 Press **ENTER**.

Note

- The wake-up timer will automatically be canceled if the clock is reset.

Setting the sleep timer

The sleep timer switches off the system after a specified time so you can fall asleep without worrying about it.

Important

- If you set the sleep timer while either the wake-up timer is active, the earlier switch off time takes priority.

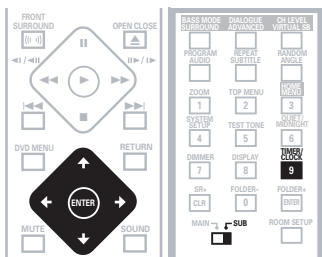

- 1 Press **TIMER/CLOCK** twice to reach the timer menu.
- 2 Use the **←/→** (cursor left/right) buttons to select 'Sleep?' then press **ENTER**.
- 3 Use the **↑/↓** (cursor up/down) buttons to select a switch-off time then press **ENTER**.

Choose between the following options:

- **Sleep Auto** – System switches off automatically after the currently playing CD, Video CD or WMA/MP3 disc has finished.
- **Sleep 90** – System switches off after 90 minutes
- **Sleep 60** – System switches off after an hour
- **Sleep 30** – System switches off after 30 minutes
- **Sleep Off** – cancels the sleep timer

- 4 To check how much time is left, repeat steps 1 and 2.

The remaining time is displayed momentarily.

Note

- **Sleep Auto** will not work with Video CDs during PBC playback or CDs in repeat play.

Chapter 9

Surround sound and other settings

Using the System Setup menu

All the available settings in the setup menu are listed in *Surround and sound setup options* and *SR+ control options for Pioneer plasma displays* below. See the notes in each section for additional information about the settings. Follow the steps below to customize the settings in the System Setup menu.

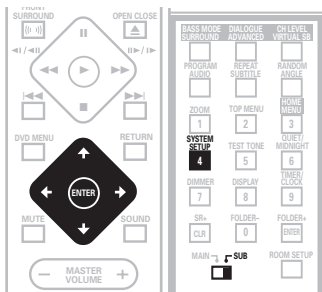

- 1 Press **SYSTEM SETUP**.
- 2 Use the **←/→** (cursor left/right) buttons to choose the setting you want to adjust. The current setting is shown for each option as you cycle through the display. See below for a full list and description of each.
- 3 Use the **↑/↓** (cursor up/down) buttons to adjust the setting.
- 4 Repeat steps 2 and 3 to make other settings.
- 5 When you're done, press **ENTER** to leave the System Setup menu.



Note

- The System Setup menu is exited automatically after 5 minutes of inactivity.

- You can't change the *Surround and sound setup options* with the Recording Mode (page 54) switched on.

Surround and sound setup options

The Room Setup feature (page 15) is designed to give you a basic surround sound setup, however you can make more detailed settings that may improve the surround sound in your listening room. Note that the first setting in each section is the default.

Front speakers distance setting

Specifies the distance from your listening position to the front speakers:

- **Front 0.3 m ~ Front 9 m** – Distance can be set in increments of 0.3 m. The default is 3 m.

Center speaker distance setting

Specifies the distance from your listening position to the center speaker:

- **Center 0.3 m ~ Center 9 m** – Distance can be set in increments of 0.3 m. The default is 3 m.

Surround speakers distance setting

Specifies the distance from your listening position to the surround speakers:

- **Surr. 0.3 m ~ Surr. 9 m** – Distance can be set in increments of 0.3 m. The default is 3 m.

Dynamic Range Control

Specifies the amount of dynamic range adjustment to Dolby Digital or DTS soundtracks:

- **DRC Off** – No dynamic range adjustment (use when listening at higher volume)
- **DRC Mid** – Mid setting
- **DRC High** – Dynamic range is reduced (loud sounds are reduced in volume while quieter sounds are increased)

 **Note**

- This setting works only with Dolby Digital and some DTS soundtracks. For other sources, you can create a similar effect using the Midnight mode (see *Using Quiet and Midnight listening modes* on page 27).

Dual mono setting

Specifies how dual mono encoded Dolby Digital or DTS soundtracks should be played. You can also use this setting to switch the audio channel on DVD-RW discs recorded with two separate soundtracks.

- **L-Ch1 R-Ch2** – Both channels are played through the front speakers
- **Ch1 Mono** – Only channel 1 is played
- **Ch2 Mono** – Only channel 2 is played

 **Note**

- On the **Ch1 Mono** and **Ch2 Mono** settings the sound comes only from the center speaker (or from the front speakers if listening in **STEREO** mode).
- This setting works only with dual mono encoded Dolby Digital or DTS soundtracks. See the disc packaging for channel information.

LFE attenuator setting

Dolby Digital and DTS audio sources include ultra-low bass tones. Set the LFE attenuator as needed to prevent the ultra-low bass from distorting the sound.

- **LFE ATT 0** – The LFE channel is played with no attenuation
- **LFE ATT 10** – LFE channel is attenuated by 10dB
- **LFE OFF** – LFE channel is not played

SR+ control options for Pioneer plasma displays

You only need to make the following settings if you have connected a Pioneer plasma display to this unit using an SR+ cable (not supplied). Note that in the function settings below, the number of video inputs may change depending on your display. See also *Using this unit with a Pioneer plasma display* on page 57.

Control mode setting

- **SR+ Off** – Switches SR+ off (this unit and the plasma display work independently)
- **SR+ On** – Switches SR+ on (this unit sends control signals to the plasma display)

The following settings are only available if the Control mode setting (above) is switched on.

Volume control setting

- **Vol C.Off** – This unit does not control the volume of the plasma display
- **Vol C.On** – When this unit is switched to an input that used the plasma display (DVD, for example), the volume on the plasma display is muted so only sound from this unit is heard.

Function setting for DVD input

- **DVD -> OFF/PDP1-5/PDPTV** – Matches the **DVD** function of this unit with a numbered video input on the plasma display. For example, **DVD -> PDP2** matches the **DVD** input with video input 2 on the plasma display.

Function setting for TV input

- **TV -> OFF/PDP1-5/PDPTV** – Matches the **TV** function of this unit with a numbered video input on the plasma display. For example, **TV -> PDP1** matches the **TV** input with video input 1 on the plasma display.

Function setting for L1 input

- **LINE1 -> OFF/PDP1-5/PDPTV** – Matches the **LINE (L1)** function of this unit with a numbered video input on the plasma display. For example, **LINE1 -> PDP3** matches the **LINE1** input with video input 3 on the plasma display.

Function setting for L2 input

- **LINE2 -> OFF/PDP1-5/PDPTV** – Matches the **LINE (L2)** function of this unit with a numbered video input on the plasma display. For example, **LINE2 -> PDP3** matches the **LINE2** input with video input 3 on the plasma display.

Setting the channel levels

You can set the relative channel levels from your main listening position for all of the listening modes independently. However, the **SURROUND** modes are divided into two independent groups: multichannel listening modes and stereo listening modes only.

If you used the Room Setup feature (page 15), the channel levels for each listening mode will already be set. However, you can still fine-tune the levels here if you need to.

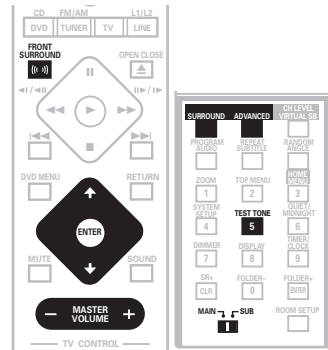

1 Select a listening mode.

Press **SURROUND**, **ADVANCED** or **FRONT SURROUND** repeatedly to select the listening mode you want.

2 Switch the remote control to SUB, then press TEST TONE to hear the test tone.

The test tone is output in the following order (from the speakers active in the current listening mode):

- **L** – Front left speaker
- **C** – Center speaker
- **R** – Front right speaker
- **RS** – Right surround speaker
- **LS** – Left surround speaker
- **SW** – Subwoofer

3 Use the **MASTER VOLUME +/-** button to adjust the volume to an appropriate level.

Turn down the volume to **40** or less to ensure you have adequate headroom.

4 Use the **↑/↓** (cursor up/down) buttons to adjust the speaker levels in turn.

You should hear the test tone at the same volume from each speaker when seated in the main listening position. The channel level range is ± 10 dB.

5 When you're done, press **ENTER** to exit test tone setup.



Tip

- The speaker volume can be adjusted while listening to any sound source you want by pressing **CH LEVEL** and then using the **↑/↓** (cursor up/down) buttons to adjust the channel levels. After you're finished with one channel, use the **←/→** (cursor left/right) buttons to move to the next.



Note

- When the **Auto** listening mode is selected, using the test tone method will adjust levels for multichannel sources only. Use **CH LEVEL** and the **↑/↓** (cursor up/down) buttons (see tip above) to set levels for the **Auto** listening mode with two channel sources.
- Since the subwoofer produces ultra-low frequencies its sound may seem quieter than it actually is.

Chapter 10

Video Adjust menu

Video Adjust

- Default setting: **Standard**

From the Video Adjust screen you can select the standard video presentation or define presets of your own.

- 1 Press **HOME MENU** and select 'Video Adjust' from the on-screen display.



- 2 Use the **←/→** (cursor left/right) buttons to select a preset.

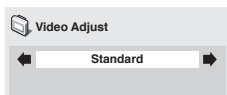

- **Standard** – Normal
- **Memory1–2** – Use for saving your own presets (see below)

- 3 Press **ENTER** to make the setting and exit the Video Adjust screen.

Note

- Depending on the disc and the TV/monitor, you may not see the effect clearly.

Creating your own presets

You can create up to three presets of your own.

- 1 Select one of the Memory presets (see above).

- 2 Press **↓** (cursor down) to select 'Detailed Settings' then press **ENTER**.

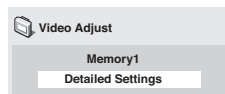

- 3 Adjust the picture quality settings.

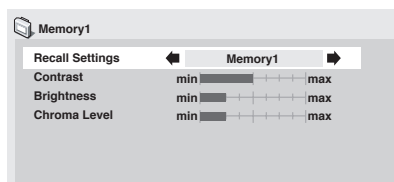

- Use the **↑/↓** (cursor up/down) buttons to select a setting.
- Use the **←/→** (cursor left/right) buttons to adjust the current setting.
- Press **DISPLAY** to switch between full and single view.
- You can change the preset number from the **Recall Settings** menu item.

You can adjust any or all of the following picture quality settings:

- **Contrast** – Adjusts the contrast between light and dark.
- **Brightness** – Adjusts the overall brightness.
- **Chroma Level** – Adjusts how saturated colors appear.

- 4 Press **ENTER** to save the preset and exit the Video Adjust screen.

Chapter 11

Initial Settings menu

Using the Initial Settings menu

The Initial Settings menu provides audio and video output settings, parental lock settings, and display settings, among others.

If an option is grayed out it means that it cannot be changed at the current time. This is usually because a disc is playing. Stop the disc, then change the setting.

1 Press HOME MENU and select 'Initial Settings'.



2 Use the cursor buttons and ENTER to select the setting and option you want to set.

All the settings and options are explained on the following pages.

Note

- In the table below, the default setting is shown in **bold**; other settings are shown in *italics*.
- Some settings, such as **TV Screen**, **Audio Language** and **Subtitle Language** may be overridden by the DVD disc. Often these settings can also be made from the DVD disc menu.
- *European model only* – The **AV Connector Out** setting only needs to be set if you have connected this player to your TV using a SCART cable (See *Using the SCART AV output* on page 56).

Video Output settings

Setting	Option	What it means
TV Screen <i>(See also Screen sizes and disc formats on page 68.)</i>	4:3 (Letter Box)	Set if you have a conventional 4:3 TV. Widescreen movies are shown with black bars top and bottom.
	<i>4:3 (Pan & Scan)</i>	Set if you have a conventional 4:3 TV. Widescreen movies are shown with the sides cropped so that the image fills the screen.
	<i>16:9 (Wide)</i>	Set if you have a widescreen TV.
AV Connector Out <i>European model only (See also Using the SCART AV output on page 56.)</i>	Video	Standard video, compatible with all TVs.
	<i>S-Video</i>	Higher quality, but check your TV for compatibility.
	<i>RGB</i>	Best quality, but check your TV for compatibility.

Setting	Option	What it means
Component Out <i>Not applicable to the European model (See also Connecting using the component video output on page 55.)</i>	Interlace	Set if your TV is not compatible with progressive scan video.
	<i>Progressive</i>	Set if your TV is compatible with progressive scan video (see your TV's instruction manual for details). Press ENTER once more to confirm (or RETURN to cancel). <i>Note that progressive scan video is only output from the component video jacks and that there is no output from the composite and S-video jacks when this setting is selected.</i>
S-Video Out <i>Not applicable to the European model (See also Connecting using the S-video output on page 55.)</i>	S2	Standard setting.
	<i>S1</i>	If you find that the picture is stretched or distorted on the default S2 setting, try changing it to this setting.

Language settings

Setting	Option	What it means
Audio Language	English	If there is an English soundtrack on the disc then it will be played.
	<i>Languages as displayed</i>	If there is the language selected on the disc, then it will be played.
	<i>Other Language</i>	Select to choose a language other than the ones displayed (see <i>Selecting languages using the language code list</i> on page 68).
Subtitle Language	English	If there is are English subtitles on the disc then they will be displayed.
	<i>Languages as displayed</i>	If there is the subtitle language selected on the disc, then it will be displayed.
	<i>Other Language</i>	Select to choose a language other than the ones displayed (see <i>Selecting languages using the language code list</i> on page 68).
DVD Menu Language	w/Subtitle Lang.	DVD disc menus will be displayed in the same language as your selected subtitle language, if possible.
	<i>Languages as displayed</i>	DVD disc menus will be displayed in the selected language, if possible.
	<i>Other Language</i>	Select to choose a language other than the ones displayed (<i>Selecting languages using the language code list</i> on page 68).
Subtitle Display	On	Subtitles are displayed according to your selected subtitle language (see above).
	<i>Off</i>	Subtitles are always off by default when you play a DVD disc (note that some discs override this setting).

Display settings

Setting	Option	What it means
OSD Language	English	On-screen displays of the player are in English.
	<i>Languages as displayed</i>	On-screen displays are shown in the language selected.
On Screen Display	On	Operation displays (Play , Resume , Scan , and so on) are shown on-screen.
	Off	Operation displays are not shown.
Angle Indicator	On	A camera icon is displayed on-screen during multi-angle scenes on a DVD disc.
	Off	No multi-angle indication is shown.

Options

Setting	Option	What it means
Parental Lock	See below	See <i>Parental Lock</i> below.
Photo Viewer	On	Only the JPEG files are shown on discs that contains both WMA/MP3 audio files and JPEG picture files.
	Off	WMA/MP3 audio file playback is possible.

Parental Lock

- Default level: **Off**; Default password: *none*;
Default Country code: **us (2119)**

To give you some control over what your children watch on your DVD player, some DVD-Video discs feature a Parental Lock level. If your player is set to a lower level than the disc, the disc won't play.

Some discs also support the Country Code feature. The player does not play certain scenes on these discs, depending on the Country Code you set.

Note

- Not all discs use Parental Lock, and will play without requiring the password first.

- If you forget your password, you'll need to reset the player to register a new password. (see *Resetting the system* on page 60)

Registering a new password

You must register a password before you can change the Parental Lock level or enter a Country code.

1 Select 'Password'.

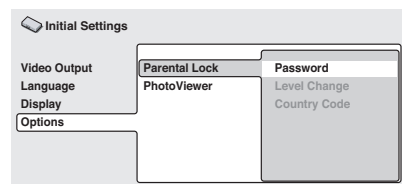

2 Use the number buttons to enter a 4-digit password.

The numbers you enter show up as asterisks (*) on-screen.

3 Press ENTER to register the password.

You will return to the Options menu screen.

Changing your password

To change your password, confirm your existing password then enter a new one.

1 Select 'Password Change'.

2 Use the number buttons to enter your existing password, then press ENTER.

3 Enter a new password and press ENTER.

This registers the new password and you will return to the Options menu screen.

Setting/changing the Parental Lock

1 Select 'Level Change'.

2 Use number buttons to enter your password, then press ENTER.

3 Select a new level and press ENTER.

- Press ← (cursor left) repeatedly to lock more levels (more discs will require the password); press → (cursor right) to unlock levels. You can't lock level 1.

This sets the new level and you will return to the Options menu screen.

Setting/changing the Country code

You can find the *Country code list* on page 69.

1 Select 'Country Code'.

2 Use number buttons to enter your password, then press ENTER.

3 Select a Country code and press ENTER.

There are two ways you can do this:

- Select by code letter: Use ↑/↓ (cursor up/down) to change the Country code.

- Select by code number: Press → (cursor right) then use the number buttons to enter the 4-digit Country code.

The new Country code is set and you will return to the Options menu screen. Note that the new Country code doesn't take effect until the next disc is loaded (or the current disc is reloaded).

Chapter 12

Other connections

Connecting external antennas

External AM antenna

Use 5–6 meters of vinyl-insulated wire and set up either indoors or outdoors. Leave the AM loop antenna connected.

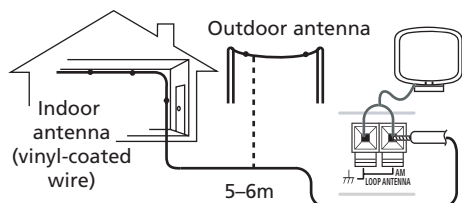

External FM antenna

Use a PAL connector to hook up an external FM antenna.

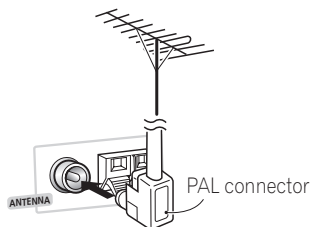

Connecting auxiliary components

This system has both stereo analog inputs and outputs, as well as an optical digital input. Use these to connect external components, such as your VCR, MD or CD-R recorder.

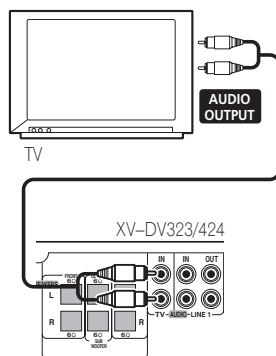

- **Connect the TV (IN) jacks to the audio outs of your TV (or VCR).**

This will enable you to hear the TV (or VCR) through this system. Connect using RCA pin-plug stereo cables.

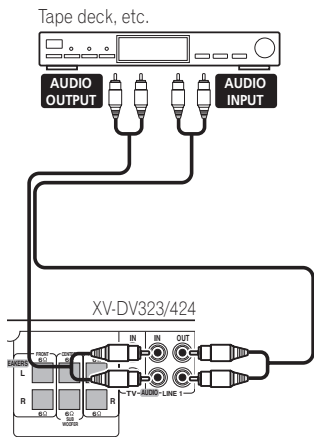

- **Connect the LINE 1 (IN) jacks to the analog outputs of an external playback component.**

These include components such as a VCR or cassette deck. Connect using RCA pin-plug stereo cables.

- **Connect the LINE 1 (OUT) jacks to the analog inputs of an external recording component.**

These include components such as a cassette deck, VCR, MD, or another recorder with analog inputs. Connect using RCA pin-plug stereo cables.

- **Connect the LINE 2 (OPTICAL IN) jack on the rear panel to the optical digital output of an external playback component.**

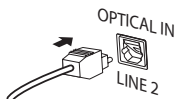

These include digital components such as an MD player, digital satellite, or a game system. Connect using an optical digital cable (not supplied).

Tip

- If you're playing a high signal level source which is producing unpleasant distortion from the speakers, you can reduce the signal level of the auxiliary source (connected to the **TV** or **LINE 1** analog inputs) by switching on the attenuator. See *Optional system settings* on page 59 to do this.

Recording mode

The Recording mode allows you to make surround-compatible analog recordings from the **LINE 1 (OUT)** jacks. Dolby multichannel sources will be downmixed to stereo for improved playback with systems that can provide matrix-decoding (like Dolby Pro Logic).

- 1 Press **SOUND**.
- 2 Use the **←/→** (cursor left/right) buttons to select '**Rec Mode?**'.
- 3 Press **ENTER**.
- 4 Use the **↑/↓** (cursor up/down) buttons to select '**R.Mode On**' or '**R.Mode Off**'.
 - **R.Mode On** – A surround-compatible downmix (left-total/right-total, or Lt/Rt) of Dolby multichannel sources is output, (suitable for Dolby Surround Pro Logic or other matrix decoding).
 - **R.Mode Off** – A simple stereo downmix (left-only/right-only, or Lo/Ro) is output (suitable for playback on a two-channel stereo system or on headphones).

Note

- When Recording mode is on, most surround sound-related functions cannot be used. The display will briefly blink **RecMode On** if you try and use a prohibited function while Recording mode is on.

- When Recording mode is off, the audio from the analog output may be interrupted, depending on the operation.
- The Recording mode automatically switches off if you change the input function (DVD/CD, TUNER, etc.) or switch the power off.

Connecting using the S-video output

Not applicable to the European model

If your TV has an S-video input, you can use this instead of the standard video output for a better quality picture.

- Use an S-video cable (not supplied) to connect the S-VIDEO OUT to an S-video input on your TV.

Line up the small triangle above the jack with the same mark on the plug before plugging in.

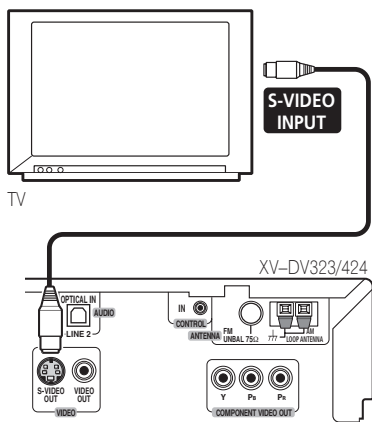

Note

- The S-video output is switchable between S1 and S2 formats for compatibility with all TVs. See *Video Output settings* on page 49 to change this setting.

Connecting using the component video output

Not applicable to the European model

If your TV has component video inputs, you can use these instead of the standard video output to connect this system to your TV. This should give you the best quality picture from the three types of video output available.

- Use a component video cable (not supplied) to connect the COMPONENT VIDEO OUT to a set of component inputs on your TV.

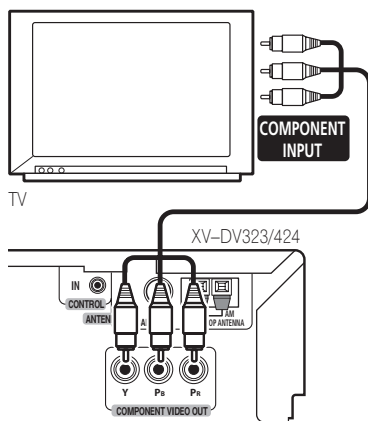

Note

- The component video output is switchable between interlaced and progressive formats. See *Video Output settings* on page 49 for more on this.

About progressive scan video

Compared to interlace video, progressive scan video effectively doubles the scanning rate of the picture, resulting in a very stable, flicker-free image. Progressive scan video is available only from the component video output.



Important

- If you connect a TV that is not compatible with a progressive scan signal and switch the system to progressive, you will not be able to see any picture at all. In this case, press **⏻ STANDBY/ON** to put the system in standby, then press and hold the front panel **■ (stop)** button for about 8 seconds until the display shows **Mem.Clr.?** Press the front panel **VOLUME – (DOWN)** or **+ (UP)** button so that the display shows **Interlace?** Press the front panel **▶/||** button to set to interlace and switch the system back on.

When TV format is set to **AUTO** or **NTSC**:

- When set to **Progressive**, PAL and NTSC discs are both output as progressive NTSC video. See also *TV format setting* on page 60
- When *Component Out* (above) is set to **Progressive**, there is no video output from the **VIDEO** and **S-VIDEO** jacks. If you want to display video on more than one monitor simultaneously, make sure that it is set to **Interlace**. See also *TV format setting* on page 60.

When TV format is set to **PAL**:

- Progressive** cannot be selected. See also *TV format setting* on page 60.

Compatibility of this player with progressive-scan and high-definition TVs.

This player is compatible with progressive video Macro Vision System Copy Guard.

Consumers should note that not all high-definition television sets are fully compatible with this product and may cause artifacts to be displayed in the picture. In case of 525 progressive scan picture problems, it is recommended that the user switch the

connection to the 'standard definition' output (Interlace). If there are questions regarding our TV set compatibility with this model, please contact our customer service center.

This system is compatible with the following Pioneer displays and monitors: PDP-503HDG, PDP-504HDG, PDP-433HDG, PDP-434HDG.

Using the SCART AV output

European model only

There are two different kinds of video outputs you can use to connect this system to your TV. The SCART output should give you better picture quality than the standard composite video output. The SCART AV connector functions as both a video and audio output.

- Use a commercially available SCART cable to connect the AV CONNECTOR to your TV.**

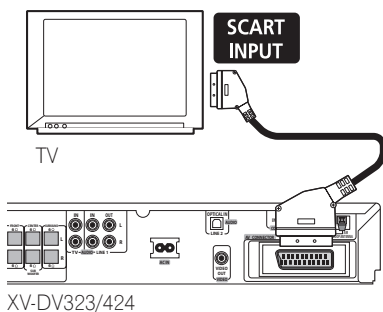

Note

- SCART cables are available in several configurations. Make sure that the one you get will work with this system and your TV/monitor. You can find the pin assignments below.

Switching the TV audio input from SCART to RCA

You can set the TV audio input to RCA or SCART.

- 1 Press **TV**.
- 2 Press **SYSTEM SETUP**.
- 3 Use the **←/→** (cursor left/right) buttons to select 'TV Audio?'
- 4 Press **ENTER**.
- 5 Use the **↑/↓** (cursor up/down) buttons to select **SCART** or **RCA**.
- 6 Press **ENTER**

SCART pin assignment

The diagram below shows the SCART 21-pin connector assignment. This connector provides the video and audio signals for connection to a compatible color TV or monitor.

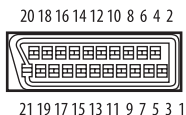

Pin No.	Assignment	Pin No.	Assignment
1	Audio R OUT	12	No connection
2	Audio R IN	13	GND (video)
3	Audio L OUT	14	GND (video)
4	GND (audio)	15	R or C OUT
5	GND (video)	16	BLANK OUT
6	Audio L IN	17	GND (video)
7	B OUT	18	GND (video)

Pin No.	Assignment	Pin No.	Assignment
8	Status	19	Video or Y OUT
9	GND (video)	20	No connection
10	No connection	21	GND (video)
11	G OUT		

Using this unit with a Pioneer plasma display

If you have a Pioneer plasma display (models PDP-504HDG and PDP-434HDG or (European model only) PDP-504HDE and PDP-434 HDE), you can use an SR+ cable (see note below) to connect it to this unit and take advantage of various convenient features, such as automatic video input switching of the plasma display when the input is changed.

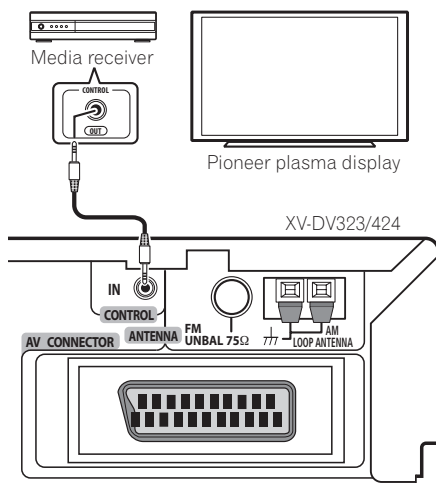

The illustration above shows the European model.

- Use a 3-ringed miniplug SR+ cable to connect the **CONTROL IN** jack of this unit through a media receiver to the **CONTROL OUT** jack of your plasma display.

Before you can use the extra SR+ features, you need to make a few settings in the unit. See *SR+ control options for Pioneer plasma displays* on page 45 for detailed instructions.

Using the SR+ mode with a Pioneer plasma display

When connected using an SR+ cable, a number of features (such as automatic video input switching and volume muting on the plasma display) become available to make using this unit with your Pioneer plasma display even easier.

See also *SR+ control options for Pioneer plasma displays* on page 45 for information on setting up the unit.

1 Make sure that the plasma display and this unit are switched on and that they are connected with an SR+ cable.

See *Using this unit with a Pioneer plasma display* above for more on connecting these components.

2 To switch SR+ mode on/off, press SR+ (SHIFT + 7).

The front panel display shows the new setting; **SR+ ON** or **SR+ OFF**.

- If **SR+ Error** shows in the display, it means there is a communication problem between the unit and the plasma display. Check all connections and retry.



Note

- The 3-ringed SR+ cable from Pioneer is commercially available under the part number ADE7095. Contact the Pioneer Customer Support division for more information on obtaining an SR+ cable.

- You won't be able to use the remote sensor of this unit with the **CONTROL IN** jack of this unit connected to the **CONTROL OUT** jack of your plasma display. You can use the remote sensor of the plasma display (even in standby) as long as the power isn't switched off.
- The automatic volume muting feature is enabled separately; see *SR+ control options for Pioneer plasma displays* on page 45. (You can also use the System Setup menu to switch the SR+ mode of this unit.)
- If you disconnect the SR+ cable or switch the plasma display off while SR+ is on, the setting automatically reverts to **SR+ OFF**. This displays an error if you switch the input of the unit with the plasma display switched off. Likewise, if this unit is switched off, the link with the plasma display will be terminated.

Chapter 13

Additional information

Optional system settings

These settings are accessed by using the System Setup menu while in standby.

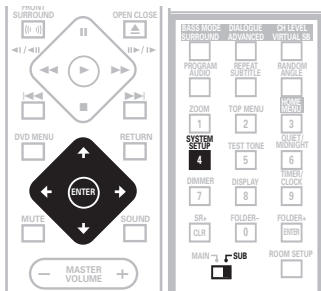

- 1 Switch the system into standby.
- 2 Press **SYSTEM SETUP**.
- 3 Use the **←/→** (cursor left/right) buttons to choose the setting you want to adjust then press **ENTER**.
The current setting is shown for each option as you cycle through the display. See below for a full list and description of each.
- 4 Use the **↑/↓** (cursor up/down) buttons to adjust the setting.
- 5 Repeat steps 2 and 3 to make other settings.
- 6 Press **ENTER** to confirm.

System Setup menu options in standby

Below are all the available settings in the setup menu. The first setting in each section is the default. See also the notes in each section for additional information about the settings.

Child lock setting

The Child Lock feature is useful when you've set the wake-up timer and don't want the system switched on before it activates.

- **Lock On** – Makes the front panel buttons and controls inoperative.
- **Lock Off** – Restores regular use of the front panel buttons and controls.

Clock format setting

Specifies how the clock is displayed:

- **12-Hour** – Sets the clock to show in 12-hour format in the display.
- **24-Hour** – Sets the clock to show in 24-hour format in the display.

TV attenuator setting

If the source connected to the **TV** analog input is producing distortion through the speakers, the attenuator will reduce the signal level.

- **ATT 6dB** – Reduces the signal level by 6dB.
- **ATT 10dB** – Reduces the signal level by 10dB.
- **ATT Off** – No attenuation

Line attenuator setting

If the source connected to the **LINE** analog input is distorting, the attenuator can reduce the signal level.

- **ATT 6dB** – Reduces the signal level by 6dB.
- **ATT 10dB** – Reduces the signal level by 10dB.
- **ATT Off** – No attenuation

Frequency step setting

Not applicable to the European model

If you find that you can't tune into stations successfully, the frequency step may not be suitable for your country/region.

- **FM50. AM9**
- **FM100. AM10**

TV format setting

The default setting of this system is **AUTO**, and unless you notice that the picture is distorted when playing some discs, you should leave it set to **AUTO**. If you experience picture distortion with some discs, set the TV system to match your country or region's system. Doing this, however, may restrict the kinds of disc you can watch. The table below shows what kinds of disc are compatible with each setting (**AUTO**, **PAL** and **NTSC**).

Disc		Player setting		
Type	Format	NTSC	PAL	AUTO
DVD	NTSC	NTSC	MOD.PAL	NTSC
/Super VCD	PAL	NTSC	PAL	PAL
Video CD	NTSC	NTSC	MOD.PAL	NTSC
	PAL	NTSC	PAL	PAL
CD/no disc	—	NTSC	PAL	NTSC or PAL

System demo setting

Switches the automatic demo feature on or off (this starts when the system is plugged in for the first time):

- **Demo On** – Switches the demo feature on.
- **Demo Off** – Switches the demo feature off.



Note

- After setting the clock, the demo mode switches off automatically. However, if you unplug the system from the wall outlet, the demo mode will revert to **Demo On** (and the clock will be reset).

Watching NTSC on a PAL TV (MOD. PAL)



Most models of the newly developed count-down PAL TV system detect 50 Hz (PAL)/60 Hz (NTSC) and automatically switch vertical amplitude, resulting in a display without vertical shrinkage. However, in some cases, the image may appear without color.

If your PAL TV does not have a V-Hold control, you may not be able to watch NTSC discs because of picture roll. If the TV has a V-Hold control, adjust it until the picture stops rolling.

On some TVs, the picture may shrink vertically, leaving black bands at the top and bottom of the screen. This is not a malfunction; it is caused by the NTSC to PAL conversion.

Resetting the system

Use this procedure to reset all system settings to the factory default.

- 1 Switch the system into standby.**
- 2 Press and hold the front panel  (stop) button for about 8 seconds until the display shows 'Mem.Clr.?'**
- 3 Press the front panel  button.**
All the system's settings are now reset, and you should see the 'Let's Get Started' screen.

Using and taking care of discs

Titles, chapters and tracks

DVD discs are generally divided into one or more titles. Titles may be further subdivided into chapters.

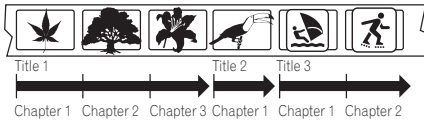

CDs and Video CD/Super VCDs are divided into tracks.

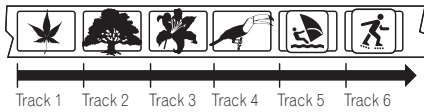

CD-ROMs contain folders and files. MP3 and WMA files are referred to as tracks. Folders may contain further folders.

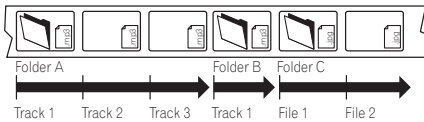

DVD Video regions

All DVD Video discs carry a region mark on the case somewhere that indicates which region(s) of the world the disc is compatible with. Your DVD system also has a region mark, which you can find on the rear panel. Discs from incompatible regions will not play in this player. Discs marked **ALL** will play in any player.

The diagram below shows the various DVD regions of the world.

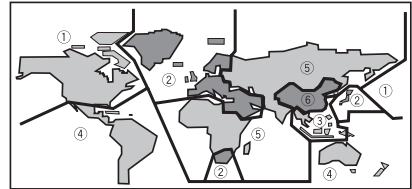

Handling discs

When holding discs of any type, take care not to leave fingerprints, dirt or scratches on the disc surface. Hold the disc by its edge or by the center hole and edge.

Damaged or dirty discs can affect playback performance. Take care also not to scratch the label side of the disc. Although not as fragile as the recorded side, scratches can still result in a disc becoming unusable.

Should a disc become marked with fingerprints, dust, etc., clean using a soft, dry cloth, wiping the disc lightly from the center to the outside edge as shown in the diagram below.

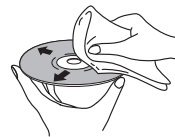

Wipe lightly from the center of the disc using straight strokes.



Don't wipe the disc surface using circular strokes.

If necessary, use a cloth soaked in alcohol, or a commercially available CD/DVD cleaning kit to clean a disc more thoroughly. Never use benzine, thinner or other cleaning agents, including products designed for cleaning vinyl records.

Storing discs

Although CDs and DVD discs are more durable than vinyl records, you should still take care to handle and store discs correctly. When you're not using a disc, return it to its case and store upright. Avoid leaving discs in excessively cold, humid, or hot environments (including under direct sunlight).

Don't glue paper or put stickers onto the disc, or use a pencil, ball-point pen or other sharp-tipped writing instrument. These could all damage the disc.



For more detailed care information see the instructions that come with discs.

Do not load more than one disc into the player at a time.

Discs to avoid

Discs spin at high speed inside the player. If you can see that a disc is cracked, chipped, warped, or otherwise damaged, don't risk using it in your player—you could end up damaging the unit.

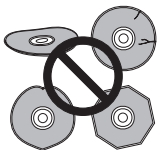

This unit is designed for use with conventional, fully circular discs only. Use of shaped discs is not recommended for this product. Pioneer disclaims all liability arising in connection with the use of shaped discs.

Proper installation and maintenance of this system

Hints on installation

We want you to enjoy using this system for years to come, so please bear in mind the following points when choosing a suitable location for it:

Do...

- ✓ Use in a well-ventilated room.
- ✓ Place on a solid, flat, level surface, such as a table, shelf or stereo rack.

Don't...

- ✗ Use in a place exposed to high temperatures or humidity, including near radiators and other heat-generating appliances.
- ✗ Place on a window sill or other place where the system will be exposed to direct sunlight.
- ✗ Use in an excessively dusty or damp environment.
- ✗ Place directly on top of an amplifier, or other component in your stereo system that becomes hot in use.
- ✗ Use near a television or monitor as you may experience interference—especially if the television uses an indoor antenna.
- ✗ Use in a kitchen or other room where the system may be exposed to smoke or steam.
- ✗ Use on a thick rug or carpet, or cover with cloth—this may prevent proper cooling of the system.

- ✗ Place on an unstable surface, or one that is not large enough to support all four of the unit's feet.

Cleaning the pickup lens

The DVD player's lens should not become dirty in normal use, but if for some reason it should malfunction due to dust or dirt, consult your nearest Pioneer authorized service center. Although lens cleaners are commercially available, we do not recommend using them since some may damage the lens.

Problems with condensation

Condensation may form inside the player if it is brought into a warm room from outside, or if the temperature of the room rises quickly. Although the condensation won't damage the player, it may temporarily impair its performance. For this reason you should leave it to adjust to the warmer temperature for about an hour before switching on and using.

Moving the system unit

If you need to move the main unit, first remove a disc if there's one in the player, then press **⏻** **STANDBY/ON** on the front panel to turn the system off. Wait for **Good Bye** to disappear from the display, then unplug the power cord. Never lift or move the unit during playback—discs rotate at a high speed and may be damaged.

Note

- Unplugging the unit before **Good Bye** disappears from the display may cause the system to return to the factory settings.

Power cord caution

Handle the power cord by the plug. Do not pull out the plug by tugging the cord and never touch the power cord when your hands are wet as this could cause a short circuit or an electric shock. Do not place this unit, a piece of furniture, etc., on the power cord, or pinch the cord. Never make a knot in the cord or tie it with other cords. The power cords should be routed such that they are not likely to be stepped on. A damaged power cord can cause a fire or give you an electrical shock.

Check the power cord once in a while. When you find it damaged, ask your nearest Pioneer authorized service center or your dealer for a replacement.

Troubleshooting

Incorrect operations are often mistaken for trouble and malfunctions. If you think that there is something wrong with this component, check the points below. Sometimes the trouble may lie in another component. Investigate the other components and electrical appliances being used. If the trouble cannot be rectified even after exercising the checks listed below, ask your nearest Pioneer authorized service center or your dealer to carry out repair work.



Important

- If the system does not operate normally due to external effects such as static electricity disconnect the power plug from the outlet and insert again to return to normal operating conditions.

General

Problem	Remedy
The power does not turn on.	<ul style="list-style-type: none"> • Connect the power plug to the wall outlet. • Disconnect the power plug from the outlet, and insert again. • Make sure there are no loose strands of speaker wire touching the rear panel. This could cause the system to shut off automatically.
No sound is output when a function is selected.	<ul style="list-style-type: none"> • If you're using the line input, make sure the component is connected correctly (see <i>Connecting auxiliary components</i> on page 53). • Press MUTE on the remote control to turn muting off. • Adjust the VOLUME. • If you're using the TV input, make sure you've selected the RCA audio input (see <i>Switching the TV audio input from SCART to RCA</i> on page 57).
No image is output when playing discs.	<ul style="list-style-type: none"> • Make sure the TV is connected correctly (refer to the Setup Guide). • <i>Not applicable to the European model</i> – Reset the video output to interlace (see <i>Video Output settings</i> on page 49).
No sound from surround or center speakers.	<ul style="list-style-type: none"> • Refer to <i>Setting the channel levels</i> on page 46 to check the speaker levels. • Check that you haven't selected the STEREO sound mode (see <i>Listening in surround sound</i> on page 24). • Connect the speakers properly (refer to the Setup Guide).
Can't operate the remote control.	<ul style="list-style-type: none"> • Replace the batteries (refer to the Setup Guide). • Operate within 7 m, 30° of the remote sensor on the front panel (refer to the Setup Guide). • Remove any obstacles or operate from another position. • Avoid exposing the remote sensor on the front panel to direct light. • You won't be able to use the remote sensor of this unit with the CONTROL IN jack of this unit connected to the CONTROL OUT jack of your plasma display. You can use the remote sensor of the plasma display (even in standby) as long as the power isn't switched off.

Problem	Remedy
Sound Demo shows in the display and the unit can't be controlled.	<ul style="list-style-type: none"> Press and hold ■ (stop) on the front panel for about five seconds. The disc tray ejects automatically to indicate the Sound Demo mode is disabled.
Timer indicator is blinking and the system will not switch on.	<ul style="list-style-type: none"> Unplug the unit, then plug back in. Wait for one minute then switch on. Make sure the fan at the rear of the unit is not being blocked. Check that the speakers are connected correctly. Make sure the voltage of the mains power source is correct for the model. If the problem persists, take it to your nearest Pioneer authorized service center or your dealer for servicing.

DVD/CD/Video CD player

Problem	Remedy
The disc is ejected automatically after loading.	<ul style="list-style-type: none"> Clean the disc. Align the disc properly in the disc guide. If the region number on a DVD-video disc does not match the number on the player, the disc cannot be used (see <i>DVD Video regions</i> on page 61). Allow time for any condensation inside the player to evaporate. Avoid using the player near an air-conditioning unit.
Playback is not possible.	<ul style="list-style-type: none"> If the disc is loaded upside down, reload the disc with the label side face up.
Picture playback stops and the operation buttons cannot be used.	<ul style="list-style-type: none"> Press ■ (stop), then ► (play) to start playback again. Switch the power off once, then on again using the front panel ⏻ STANDBY/ON button.
Settings are canceled.	<ul style="list-style-type: none"> When the power is cut due to power failure or by unplugging the power cable, settings will be canceled.
No picture/No color.	<ul style="list-style-type: none"> Check that connections are correct and that plugs are inserted fully. Check the instruction manual of the TV/monitor to make sure the TV/monitor settings are incorrect.
Screen is stretched or aspect does not change.	<ul style="list-style-type: none"> The TV Screen setting is incorrect. Set the TV Screen option to match the TV/monitor you're using (see <i>Video Output settings</i> on page 49).
When recorded on a VCR or passed through an AV selector, there is disturbance in the playback picture.	<ul style="list-style-type: none"> This system uses copy-protection technology which may prevent recording or cause picture problems when connected through a VCR or AV selector. This is not a malfunction.

Problem	Remedy
CD won't play	<ul style="list-style-type: none"> Set the PhotoViewer menu option in the Initial Settings menu to Off to be able to play some copy-protected CDs. See <i>Options</i> on page 51.
Picture disturbance during playback or dark.	<ul style="list-style-type: none"> This player is compatible with Macro-Vision System copy guard. Some discs include a copy prevention signal, and when this type of disc is played back, stripes etc., may appear on some sections of the picture depending on the TV. This is not a malfunction. Discs respond differently to particular player functions. This may result in the screen becoming black for a brief instant or shaking slightly when the function is executed. These problems are largely due to differences between discs and disc content and are not malfunctions of this player.
Noticeable difference in DVD and CD volume.	<ul style="list-style-type: none"> DVDs and CDs use different recording methods. This is not a malfunction.

WMA/MP3/JPEG discs

Problem	Remedy
CD-ROM disc is not recognized by the system.	<ul style="list-style-type: none"> Make sure that the CD-ROM was recorded using the ISO 9660 disc format. See <i>Disc / content format playback compatibility</i> on page 6 for other disc compatibility information.
Files don't show up in the Disc Navigator/ Photo Browser.	<ul style="list-style-type: none"> The files on the disc must be named with the correct file extension: .mp3 for MP3 files; .wma for WMA files; .jpg for JPEG files (upper or lower-case is OK). See <i>Disc / content format playback compatibility</i> on page 6 for other disc compatibility information.
Can play JPEG files, but not WMA/MP3 files on the same disc (or vice versa).	<ul style="list-style-type: none"> Set the PhotoViewer menu option in the Initial Settings menu to Off to be able to access the WMA/MP3 files. Set to On to be able to play the JPEG files. See <i>Options</i> on page 51.
Can't play WMA files.	<ul style="list-style-type: none"> The files were recorded using DRM (digital rights management). This is not a malfunction. See <i>DRM</i> in the <i>Glossary</i> on page 71.

Tuner

Problem	Remedy
Considerable noise in radio broadcasts.	<ul style="list-style-type: none"> Connect the antenna (refer to the Setup Guide) and adjust the direction and position for best reception. Fully extend the FM wire antenna, position for best reception, and secure to a wall.

Problem	Remedy
Considerable noise in radio broadcasts (continued).	<ul style="list-style-type: none"> • Connect an outdoor FM antenna (see <i>Connecting external antennas</i> on page 53). • Connect an additional internal or external AM antenna (refer to the Setup Guide and <i>Connecting external antennas</i> on page 53). • Turn off any other equipment that may be causing the noise or move it away from the main unit. • <i>Not applicable to the European model</i> – The tuning interval is incorrect for your country or region. Try switching the tuning interval (frequency step) (see <i>Frequency step setting</i> on page 60).
Auto tuning does not pick up some stations.	<ul style="list-style-type: none"> • The radio signal is weak. Auto tuning will only detect radio stations with a good signal. For more sensitive tuning, connect an outdoor antenna.
Sound is mono only.	<ul style="list-style-type: none"> • Check that the tuner is not set to FM mono (see <i>Improving poor FM reception</i> on page 21).

Error Messages

Message	Description
Child Lock	<ul style="list-style-type: none"> • This message appears when the front panel buttons are pressed when the child lock feature is active. See <i>Child lock setting</i> on page 59 for more on switching on/off the child lock.
Rec Mode On	<ul style="list-style-type: none"> • Blinks rapidly for 2 seconds when an operation is prohibited because the Recording Mode is on (see <i>Recording mode</i> on page 54).
Phones In	<ul style="list-style-type: none"> • Blinks rapidly for 2 seconds when an operation is prohibited because headphones are connected.
96k Stereo	<ul style="list-style-type: none"> • Blinks rapidly for 2 seconds when an operation is prohibited because the source is digital 88.2 or 96kHz PCM.
No Surr. SP	<ul style="list-style-type: none"> • Blinks rapidly for 2 seconds when an operation is prohibited because there is no surround speaker output.
Muting	<ul style="list-style-type: none"> • Blinks rapidly for 2 seconds when an operation is prohibited because the sound is muted (press the MUTE button to turn the sound on).
Exit	<ul style="list-style-type: none"> • Appears briefly when a menu is automatically exited after a set period of inactivity.
SR+ Error	<ul style="list-style-type: none"> • Appears when there is a communication problem between the unit and the plasma display. Check all connections and retry.

Screen sizes and disc formats

DVD-Video discs come in several different screen aspects, ranging from TV programs, which are generally 4:3, to CinemaScope widescreen movies, with an aspect ratio of up to about 7:3.

Televisions also come in different aspect ratios; 'standard' 4:3 and widescreen 16:9.

Widescreen TV users

If you have a widescreen TV, the **TV Screen** setting (see *Video Output settings* on page 49) of this system should be set to **16:9 (Wide)**.

When you watch discs recorded in 4:3 format, you can use the TV controls to select how the picture is presented. Your TV may offer various zoom and stretch options; see the instructions that came with your TV for details.

Please note that some movie aspect ratios are wider than 16:9, so even though you have a widescreen TV, these discs will still play in a 'letterbox' style with black bars at the top and bottom of the screen.

Standard TV users

If you have a standard TV, the **TV Screen** setting (see *Video Output settings* on page 49) of this system should be set to **4:3 (Letter Box)** or **4:3 (Pan&Scan)**, depending on which you prefer.

Set to **4:3 (Letter Box)**, widescreen discs are shown with black bars top and bottom.



Set to **4:3 (Pan&Scan)**, widescreen discs are shown with the left and right sides cropped. Although the picture looks larger, you don't actually see the whole picture.



Please note that many widescreen discs override the system's settings so that the disc is shown in letterbox format regardless of the setting.



Tip

- Using the **16:9 (Wide)** setting with a standard 4:3 TV, or either of the **4:3** settings with a widescreen TV, will result in a distorted picture.

Selecting languages using the language code list

Some of the language options (see *Language settings* on page 50) allow you to set your preferred language from any of the 136 languages listed in the *Language code list* on page 69.

- 1 **Select 'Other Language'.**
- 2 **Use the ←/→ (cursor left/right) buttons to select either a code letter or a code number.**
- 3 **Use the ↑/↓ (cursor up/down) buttons to select a code letter or a code number.** See the *Language code list* (next page) for a complete list of languages and codes.

Language code list

Language (Language code letter), **Language code**

Japanese (ja), 1001	Estonian (et), 0520	Lingala (ln), 1214	Slovak (sk), 1911
English (en), 0514	Basque (eu), 0521	Laothian (lo), 1215	Slovenian (sl), 1912
French (fr), 0618	Persian (fa), 0601	Lithuanian (lt), 1220	Samoan (sm), 1913
German (de), 0405	Finnish (fi), 0609	Latvian (lv), 1222	Shona (sn), 1914
Italian (it), 0920	Fiji (fj), 0610	Malagasy (mg), 1307	Somali (so), 1915
Spanish (es), 0519	Faroese (fo), 0615	Maori (mi), 1309	Albanian (sq), 1917
Dutch (nl), 1412	Frisian (fy), 0625	Macedonian (mk), 1311	Serbian (sr), 1918
Russian (ru), 1821	Irish (ga), 0701	Malayalam (ml), 1312	Siswati (ss), 1919
Chinese (zh), 2608	Scots-Gaelic (gd), 0704	Mongolian (mn), 1314	Sesotho (st), 1920
Korean (ko), 1115	Galician (gl), 0712	Moldavian (mo), 1315	Sundanese (su), 1921
Greek (el), 0512	Guarani (gn), 0714	Marathi (mr), 1318	Swedish (sv), 1922
Afar (aa), 0101	Gujarati (gu), 0721	Malay (ms), 1319	Swahili (sw), 1923
Abkhazian (ab), 0102	Hausa (ha), 0801	Maltese (mt), 1320	Tamil (ta), 2001
Afrikaans (af), 0106	Hindi (hi), 0809	Burmese (my), 1325	Telugu (te), 2005
Amharic (am), 0113	Croatian (hr), 0818	Nauru (na), 1401	Tajik (tg), 2007
Arabic (ar), 0118	Hungarian (hu), 0821	Nepali (ne), 1405	Thai (th), 2008
Assamese (as), 0119	Armenian (hy), 0825	Norwegian (no), 1415	Tigrinya (ti), 2009
Aymara (ay), 0125	Interlingua (ia), 0901	Occitan (oc), 1503	Turkmen (tk), 2011
Azerbaijani (az), 0126	Interlingue (ie), 0905	Oromo (om), 1513	Tagalog (tl), 2012
Bashkir (ba), 0201	Inupiak (ik), 0911	Oriya (or), 1518	Setswana (tn), 2014
Byelorussian (be), 0205	Indonesian (in), 0914	Panjabi (pa), 1601	Tonga (to), 2015
Bulgarian (bg), 0207	Icelandic (is), 0919	Polish (pl), 1612	Turkish (tr), 2018
Bihari (bh), 0208	Hebrew (iw), 0923	Pashto, Pushto (ps), 1619	Tsonga (ts), 2019
Bislama (bi), 0209	Yiddish (ji), 1009	Portuguese (pt), 1620	Tatar (tt), 2020
Bengali (bn), 0214	Javanese (jw), 1023	Quechua (qu), 1721	Twi (tw), 2023
Tibetan (bo), 0215	Georgian (ka), 1101	Rhaeto-Romance (rm), 1813	Ukrainian (uk), 2111
Breton (br), 0218	Kazakh (kk), 1111	Kirundi (rn), 1814	Urdu (ur), 2118
Catalan (ca), 0301	Greenlandic (kl), 1112	Romanian (ro), 1815	Uzbek (uz), 2126
Corsican (co), 0315	Cambodian (km), 1113	Kinyarwanda (rw), 1823	Vietnamese (vi), 2209
Czech (cs), 0319	Kannada (kn), 1114	Sanskrit (sa), 1901	Volapük (vo), 2215
Welsh (cy), 0325	Kashmiri (ks), 1119	Sindhi (sd), 1904	Wolof (wo), 2315
Danish (da), 0401	Kurdish (ku), 1121	Sangho (sg), 1907	Xhosa (xh), 2408
Bhutani (dz), 0426	Kirghiz (ky), 1125	Serbo-Croatian (sh), 1908	Yoruba (yo), 2515
Esperanto (eo), 0515	Latin (la), 1201	Sinhalese (si), 1909	Zulu (zu), 2621

Country code list

Country, Country code, **Country code letter**



Argentina, 0118, ar	Hong Kong, 0811, hk	Philippines, 1608, ph
Australia, 0121, au	India, 0914, in	Portugal, 1620, pt
Austria, 0120, at	Indonesia, 0904, id	Russian Federation, 1821, ru
Belgium, 0205, be	Italy, 0920, it	Singapore, 1907, sg
Brazil, 0218, br	Japan, 1016, jp	Spain, 0519, es
Canada, 0301, ca	Korea, Republic of, 1118, kr	Switzerland, 0308, ch
Chile, 0312, cl	Malaysia, 1325, my	Sweden, 1905, se
China, 0314, cn	Mexico, 1324, mx	Taiwan, 2023, tw
Denmark, 0411, dk	Netherlands, 1412, nl	Thailand, 2008, th
Finland, 0609, fi	New Zealand, 1426, nz	United Kingdom, 0702, gb
France, 0618, fr	Norway, 1415, no	United States of America, 2119, us
Germany, 0405, de	Pakistan, 1611, pk	

Preset code list

Please note that there are cases where only certain functions may be controllable after assigning the proper preset code, or the codes for the manufacturer in the list will not work for the model that you are using.

ACURA 644	FRONTECH/PROTECH 632	MANESTH 639, 646	SAMBERS 649
ADMIRAL 631	FUJITSU 648, 629	MARANTZ 607	SAMSUNG 607, 638, 644, 646
AIWA 660	FUNAI 640, 646, 658	MARK 607	SANYO 635, 645, 648, 621, 614
AKAI 632, 635, 642	GBC 632, 642	MATSUI 607, 639, 640, 642, 644, 647, 648	SBR 607, 634
AKURA 641	GE 601, 608, 607, 610, 617, 602, 628, 618	MEDIATOR 607	SCHAUB LORENZ 642
ALBA 607, 639, 641, 644	GEC 607, 634, 648	MEMOREX 644	SCHNEIDER 607, 641, 647
AMSTRAD 642, 644, 647	GELOSO 632, 644	METZ 631	SEG 642, 646
ANITECH 644	GENEXXA 631, 641	MINERVA 631, 653	MCMICHAEL 634
ASA 645	GOLDSTAR 610, 623, 621, 602, 607, 650	MITSUBISHI 609, 610, 602, 621, 631	SEI 632, 640, 649
ASUKA 641	GOODMANS 607, 639, 647, 648, 656	MULTITECH 644, 649	SELECO 631, 642
AUDIOGONIC 607, 636	GORENJE 638	NEC 659	SHARP 602, 619, 627
BASIC LINE 641, 644	GPM 607	NECKERMANN 631, 607	SIAREM 632, 649
BAUR 631, 607, 642	GRATZ 631, 642	NEI 607, 642	SIEMENS 631
BEKO 638	GRANADA 607, 635, 642, 643, 648	NIKKAI 605, 607, 641, 646, 648	SINUDYNE 632, 639, 640, 649
BEON 607	GRADIENTE 630, 657	NOBLIKO 649	SKANTIC 643
BLAUPUNKT 631	GRANDIN 618	NOKIA 632, 642, 652	SOLOVAX 631
BLUE SKY 641	GRUNDIG 631, 653	NORDMENDE 632, 636, 651, 652	SONOKO 607, 644
BLUE STAR 618	HANSEATIC 607, 642	ORION 632, 607, 639, 640	SONOLOR 631, 635
BPL 618	HCM 618, 644	OSAKI 641, 646, 648	SONTEC 607
BRANDT 636	HINARI 607, 641, 644	OSO 641	SONY 604
BTC 641	HISAWA 618	OSUME 648	SOUNDWAVE 607
BUSH 607, 641, 642, 644, 647, 656	HITACHI 631, 633, 634, 636, 642, 643, 654, 606, 610, 624, 625, 618	OTTO VERSAND 631, 632, 607, 642	STANDARD 641, 644
CASCADE 644	HUANYU 656	PALLADIUM 638	STERN 631
CATHAY 607	HYPSON 607, 618, 646	PANAMA 646	SUSUMU 641
CENTURION 607	ICE 646, 647	PANASONIC 631, 607, 608, 642, 622	SYSLINE 607
CGB 642	IMPERIAL 638, 642	PATHO CINEMA 642	TANDY 631, 641, 648
CIMLINE 644	INDIANA 607	PAUSA 644	TASHIKO 634
CLARIVOX 607	INGELEN 631	PHILCO 632, 642	TATUNG 607, 648
CLATRONIC 638	INTERFUNK 631, 632, 607, 642	PHILIPS 631, 607, 634, 656	TEC 642
CONDOR 638	INTERVISION 646, 649	PHOENIX 632	TELEAVIA 636
CONTEC 644	ISUKAI 641	PHONOLA 607	TELEFUNKEN 636, 637, 652
CROSLEY 632	ITC 642	PROFEX 642, 644	TELETECH 644
CROWN 638, 644	ITT 631, 632, 642	PROTECH 607, 642, 644, 646, 649	TENSAI 640, 641
CRYSTAL 642	JEC 605	QUELLE 631, 632, 607, 642, 645, 653	THOMSON 636, 651, 652, 663
CYBERTRON 641	JVC 613, 623	R-LINE 607	THORN 631, 607, 642, 645, 648
DAEWOO 607, 644, 656	KAISUI 618, 641, 644	RADIOLA 607	TOMASHI 618
DAINICHI 641	KAPSCH 631	RADIOSHACK 610, 623, 621, 602	TOSHIBA 605, 602, 626, 621, 653
DANSAI 607	KENDO 642	RBM 653	TOWADA 642
DAYTON 644	KENNEDY 632, 642	RCA 601, 610, 615, 616, 617, 618, 661, 662, 609	ULTRAVOX 632, 642, 649
DECCA 607, 648	KORPEL 607	REDIFFUSION 632, 642	UNIVERSUM 631, 607, 638, 642, 645, 646, 654, 655
DIXI 607, 644	KOYODA 644	REX 631, 646	VESTEL 607
DUMONT 653	LEYCO 607, 640, 646, 648	ROADSTAR 641, 644, 646	VICTOR 613
ELIN 607	LIESENKÄTTER 607	SABA 631, 636, 642, 651	VOXSON 631
ELITE 641	LOEWE 607	SAISHO 639, 644, 646	WALTHAM 643
ELTA 644	LUXOR 632, 642, 643	SALORA 631, 632, 642, 643	WATSON 607
EMERSON 642	M-ELECTRONIC 631, 644, 645, 653, 654, 655		WATT RADIO 632, 642, 649
ERRES 607	MAGNADYNE 632, 649		WHITE
FERGUSON 607, 636, 651	MAGNAFON 649		WESTINGHOUSE 607
FINLANDIA 635, 643, 655	MAGNAVOX 607, 610, 603, 612, 629		YOKO 607, 642, 646
FINLUX 632, 607, 645, 648, 653, 654, 655			ZENITH 603, 620
FIRSTLINE 640, 644			PIONEER 600, 631, 632, 607, 636, 642, 651
FISHER 632, 635, 638, 645			
FORMENTI 632, 607, 642			
FRONTECH 631, 642, 646			

Glossary

Analog audio	Direct representation of sound by an electrical signal. See also <i>Digital audio</i> .
Aspect ratio	The width of a TV screen relative to its height. Conventional TVs are 4:3; widescreen models are 16:9.
Digital audio	Indirect representation of sound using numbers. See also <i>Sampling frequency</i> and <i>Analog audio</i> .
Dolby Digital 	A multi-channel audio encoding system developed by Dolby Laboratories that enables far more audio to be stored on a disc than PCM encoding. See also <i>PCM (Pulse Code Modulation)</i> .
DRM copy protection	DRM (digital rights management) copy protection is a technology designed to prevent unauthorized copying by restricting playback, etc. of material on devices other than the PC (or other WMA recording equipment) used to record it. For detailed information, please see the instruction manuals or help files that came with your PC (or other WMA recording equipment) and/or software.
DTS 	A multi-channel audio encoding system developed by Digital Theater Systems that enables far more audio to be stored on a disc than PCM encoding. See also <i>PCM (Pulse Code Modulation)</i> .
Dynamic range	The difference between the quietest and loudest sounds possible in an audio signal.
EXIF (Exchangeable Image File)	A file format developed by Fuji Photo Film for digital still cameras. Digital cameras from various manufacturers use this compressed file format which carries date, time and thumbnail information, as well as the picture data.
File extension	A tag added to the end of a filename to indicate the type of file. For example, ".mp3" indicates an MP3 file.
ISO 9660 format	International standard for the volume and file structure of CD-ROM discs.

JPEG	A standard file format used for still images. JPEG files are identified by the file extension ".jpg".
MP3	MP3 (MPEG1 audio layer 3) is a compressed stereo audio file format. Files are recognized by their file extension ".mp3".
MPEG audio	An audio format used on Video CD/ Super VCDs and some DVD discs.
MPEG video	A video format used on Video CD/Super VCDs and DVD discs.
PBC (PlayBack Control)	A system of navigating a Video CD/ Super VCD through on-screen menus recorded onto the disc.
PCM (Pulse Code Modulation)	Digital audio encoding system found on CDs. Good quality, but requires a lot of data compared to Dolby Digital, DTS and MPEG encoded audio. See also <i>Digital audio</i> .
Progressive scan video	All the lines that make up a video picture are updated in one pass (compared to interlace which takes two passes to update the whole picture).
Regions	These associate DVD-Video discs and players with particular areas of the world. See <i>DVD Video regions</i> on page 61 for more information.
Sampling frequency	The rate at which sound is measured to be turned into digital audio data. The higher the rate, the better the sound quality. CD is 44.1 kHz; DVD can be up to 96 kHz. See also <i>Digital audio</i> .
WMA	WMA is short for Windows Media Audio and refers to an audio compression technology developed by Microsoft Corporation. Files are recognized by their file extension ".wma".

Manufactured under license from Dolby Laboratories. "Dolby", "Pro Logic" and the double-D symbol are trademarks of Dolby Laboratories. "DTS" and "DTS Digital Surround" are registered trademarks of Digital Theater Systems, Inc.

Specifications

Amplifier section

Continuous Power Output (RMS):

Argentina and Brazil models:

Front, Center, Surround . . . 90 W per channel
(1 kHz, 10 % T.H.D., 6 Ω)

Subwoofer . . . 90 W (100 Hz, 10 % T.H.D., 6 Ω)

All other models:

Front, Center, Surround . . . 100 W per channel
(1 kHz, 10 % T.H.D., 6 Ω)

Subwoofer . . . 100 W (100 Hz, 10 % T.H.D., 6 Ω)

Continuous Power Output:

Argentina and Brazil models:

Front, Center, Surround . . . 68 W per channel
(1 kHz, 1 % T.H.D., 6 Ω)

Subwoofer . . . 68 W (100 Hz, 1 % T.H.D., 6 Ω)

All other models:

Front, Center, Surround . . . 75 W per channel
(1 kHz, 1 % T.H.D., 6 Ω)

Subwoofer . . . 75 W (100 Hz, 1 % T.H.D., 6 Ω)

Disc section

Digital audio

characteristics DVD fs: 96 kHz, 24-bit

Type DVD system, video CD system and
compact disc digital audio system

Total harmonic distortion 0.004%

Frequency

response 4 Hz to 44 kHz (96kHz sampling) /
4 Hz to 22 kHz (48kHz sampling)

Wow and Flutter Limit of measurement
(± 0.001 % W.PEAK) or less (JEITA)

FM tuner section

Frequency range 87.5 – 108 MHz

Antenna 75 Ω , unbalanced

AM tuner section

Frequency range

With 9kHz step 531 kHz to 1,602 kHz

With 10kHz step (*Not applicable to
the European model*) . . . 530 kHz to 1,700 kHz

Antenna Loop antenna

Miscellaneous

Power requirements

European/Singapore/South African

models AC 220-230 V, 50/60 Hz

U.K. model AC 230 V, 50/60 Hz

Australian/New Zealand/Malaysian

models AC 240 V, 50/60 Hz

Argentina/Brazil models . . AC 220 V, 50/60 Hz

Hong Kong model AC 220-230 V, 50 Hz

Taiwan model AC 110-120 V, 60 Hz

Mexican model AC 127 V, 50/60 Hz

Power consumption 175W

Power consumption in standby 0.5 W

Dimensions 420 (W) x 70 (H) x 396 (D) mm

Weight 7.0 kg

Accessories (DVD/CD receiver)

Remote control 1

AA/R6 dry cell batteries 2

Video cable (yellow plugs) 1

AM loop antenna 1

FM antenna 1

Power cord 1

Setup Guide 1

These operating instructions 1

Warranty Card (*European, Australian and New*

Zealand models only) 1

Speaker System (S-DV323/424)

(*Front speakers x2, surround speakers x2, center
speaker x1, subwoofer x1*)

Front speakers (S-DV323)

Enclosure Closed-box bookshelf type
(magnetically shielded)

System 10x7 cm 1-way system

Speakers 10x7 cm cone type

Nominal impedance 6 Ω

Frequency range 90 Hz to 20 kHz

Maximum Input Power 100 W

Dimensions 105 (W) x 158 (H) x 83 (D) mm

Weight 0.8 kg

Front speakers (S-DV424)

Enclosure	Closed-box bookshelf type (magnetically shielded)
System	2-way system
Woofer	10x7cm cone-type
Tweeter	2.6cm dome-type
Nominal impedance	6 Ω
Frequency range	90 Hz to 20 kHz
Maximum Input Power	100 W
Dimensions	240 (W) x 240 (H) x 962 (D) mm
Weight	3.6 kg

Center speaker

Enclosure	Closed-box bookshelf type (magnetically shielded)
System	10x7 cm 1-way system
Speakers	10x7 cm cone type
Nominal impedance	6 Ω
Frequency range	78 Hz to 20 kHz
Maximum Input Power	100 W
Dimensions	240 (W) x 87 (H) x 79 (D) mm
Weight	0.85 kg

Surround speakers

Enclosure	Closed-box bookshelf type (magnetically shielded)
System	7cm 1-way system
Speakers	7cm cone type
Nominal impedance	6 Ω
Frequency range	90 Hz to 20 kHz
Maximum Input Power	100 W
Dimensions	105 (W) x 139 (H) x 83 (D) mm
Weight	0.55 kg

Subwoofer

Enclosure	Bass-reflex floor type (magnetically shielded)
System	16 cm 1-way system
Speaker	16 cm cone type
Nominal impedance	6 Ω
Frequency range	35 Hz to 2.8 kHz
Maximum Input Power	100 W
Dimensions	108 (W) x 420 (H) x 390 (D) mm
Weight	5 kg

Accessories (Speaker system)

Speaker cables	6
Speaker setup guide	1
Non-slip pads (small)	20
Non-slip pads (large)	9
Subwoofer stands	3
Front speaker covers	2
Surround speaker bases	2
<i>S-DV323 only:</i>	
Wall mounts	2



Note

- Specifications and design subject to possible modification without notice, due to improvements.

This product includes FontAvenue® fonts licenced by NEC corporation. FontAvenue is a registered trademark of NEC Corporation.

This product incorporates copyright protection technology that is protected by method claims of certain U.S. patents and other intellectual property rights owned by Macrovision Corporation and other rights owners. Use of this copyright protection technology must be authorized by Macrovision Corporation, and is intended for home and other limited uses only unless otherwise authorized by Macrovision Corporation. Reverse engineering or disassembly is prohibited.

This product is intended for household purposes. Any failure due to use for other than household purposes (such as long-term use for business purposes in a restaurant or use in a car or ship) and which requires repair will be charged for even in the warranty period.

K041_En

AFTER-SALES SERVICE FOR PIONEER PRODUCTS

Please contact the dealer or distributor from where you purchased the product for its after-sales service (including warranty conditions) or any other information. In case the necessary information is not available, please contact the Pioneer's subsidiaries (regional service headquarters) listed below:

PLEASE DO NOT SHIP YOUR PRODUCT TO THE COMPANIES at the addresses listed below for repair without advance contact, for these companies are not repair locations.

AMERICA

PIONEER ELECTRONICS (USA) INC.
CUSTOMER SUPPORT DIVISION
P.O. BOX 1760, LONG BEACH, CA 90801-1760, U.S.A.
CUSTOMER SERVICE HOTLINE : (800) 421-1404

EUROPE

PIONEER EUROPE NV
EUROPEAN SERVICE DIVISION
HAVEN 1087, KEETBERGLAAN 1, B-9120 MELSELE, BELGIUM

ASEAN

PIONEER ELECTRONICS ASIACENTRE PTE. LTD.
SERVICE DEPARTMENT
253, ALEXANDRA ROAD #04-01 SINGAPORE 159936

JAPAN AND OTHERS

PIONEER CORPORATION (HEAD OFFICE)
CUSTOMER SUPPORT CENTER
4-1, MEGURO 1-CHOME, MEGURO-KU, TOKYO 153-8654 JAPAN

S0160_en

Published by Pioneer Corporation
Copyright ©2004 Pioneer Corporation
All rights reserved

PIONEER CORPORATION

4-1, Meguro 1-Chome, Meguro-ku, Tokyo 153-8654, Japan

PIONEER ELECTRONICS (USA) INC.

P.O. BOX 1540, Long Beach, California 90810-1540, U.S.A. TEL: (800) 421-1404

PIONEER ELECTRONICS OF CANADA, INC.

300 Allstate Parkway, Markham, Ontario L3R 0P2, Canada TEL: (905) 479-4411

PIONEER EUROPE NV

Haven 1087, Keetberglaan 1, B-9120 Melsele, Belgium TEL: 03/570.05.11

PIONEER ELECTRONICS ASIACENTRE PTE. LTD.

253 Alexandra Road, #04-01, Singapore 159936 TEL: 656-472-1111

PIONEER ELECTRONICS AUSTRALIA PTY. LTD.

178-184 Boundary Road, Braeside, Victoria 3195, Australia, TEL: (03) 9586-6300

PIONEER ELECTRONICS DE MEXICO S.A. DE C.V.

Blvd.Manuel Avila Camacho 138 10 piso Col.Lomas de Chapultepec, Mexico,D.F. 11000 TEL: 55-9178-4270