

# SMT Power Inductor

## SIW75 Type

### Features

- RoHS compliant.
- Small size (7.3mm\*7.3mm), low profile (5.2mm max. height) SMD type.
- Suitable for high density mounting.
- High energy storage and low DCR.
- Provided with embossed carrier tape packing.
- Ideal for power source circuits, DC-DC converter, DC-AC inverters inductor application.
- In addition to the standard versions shown here, customized inductors are available to meet your exact requirements.

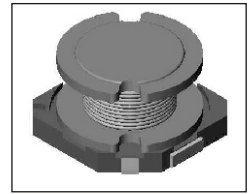

### Mechanical Dimension:

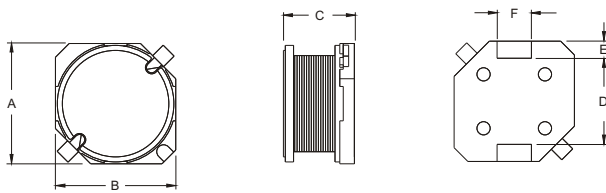

### RECOMMENDED PAD PATTERNS

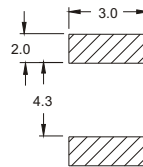

UNIT:mm/inch  
 A = 7.6 / 0.299 Max.  
 B = 7.6 / 0.299 Max.  
 C = 5.2 / 0.205 Max.  
 D = 5.3±0.1 / 0.209±0.004  
 E = 1.0±0.1 / 0.039±0.004  
 F = 2.0 / 0.079

### Electrical Characteristics: 25°C: 100KHz, 0.1V

PART NO.	L <sup>1</sup> (uH)	DCR (mΩ) MAX	I <sub>rated</sub> <sup>2</sup> (A dc)
SIW75 - 1R0	1.0	0.023	2.90
SIW75 - 1R5	1.5	0.028	2.60
SIW75 - 2R2	2.2	0.032	2.40
SIW75 - 3R3	3.3	0.038	2.20
SIW75 - 4R7	4.7	0.049	1.90
SIW75 - 6R8	6.8	0.060	1.70
SIW75 - 100	10.0	0.070	1.60
SIW75 - 120	12.0	0.080	1.50
SIW75 - 150	15.0	0.090	1.40
SIW75 - 180	18.0	0.100	1.30
SIW75 - 220	22.0	0.120	1.20
SIW75 - 270	27.0	0.140	1.10
SIW75 - 330	33.0	0.160	1.00
SIW75 - 390	39.0	0.190	0.91
SIW75 - 470	47.0	0.220	0.84
SIW75 - 560	56.0	0.290	0.72
SIW75 - 680	68.0	0.340	0.66
SIW75 - 820	82.0	0.460	0.58
SIW75 - 101	100.0	0.550	0.51
SIW75 - 121	120.0	0.670	0.42
SIW75 - 151	150.0	0.900	0.37
SIW75 - 181	180.0	1.050	0.35
SIW75 - 221	220.0	1.350	0.29
SIW75 - 271	270.0	1.550	0.28
SIW75 - 331	330.0	2.050	0.23
SIW75 - 391	390.0	2.300	0.21
SIW75 - 471	470.0	2.600	0.19

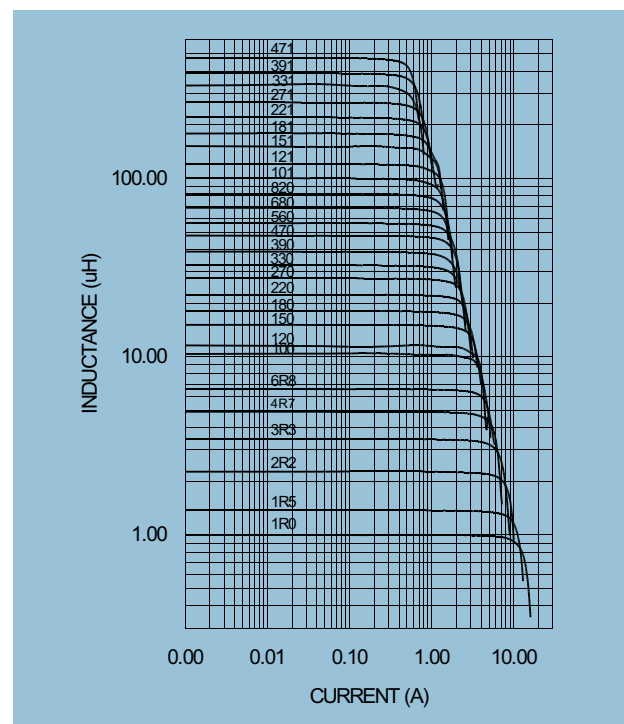

1. Tolerance of inductance: ±20% for 1.0~6.8uH, ±10% for 10~470uH.
2. I<sub>rated</sub> is the DC current which cause the inductance drop 10% typical of its nominal inductance without current and the surface temperature of the part increase less than 45°C.
3. Operating temperature : -20°C to 105°C (including self-temperature rise).



DELTA ELECTRONICS, INC.

(TAOYUAN PLANT CPBG) 252, SAN YING ROAD, KUEISAN INDUSTRIAL ZONE, TAOYUAN SHIEN, 333, TAIWAN, R.O.C.

TEL: 886-3-3591968; FAX: 886-3-3591991

<http://www.deltawww.com>