

KitchenAid® Side by Side Refrigerator

PRODUCT MODEL NUMBERS

KSBP25FK KSCS25FK
 KSBS25FK KSFS25FK

Electrical: A 115 Volt, 60 Hz., AC only 15 or 20 amp fused, grounded electrical supply is required. It is recommended that a separate circuit serving only your refrigerator be provided. Use an outlet that cannot be turned off by a switch. Do not use an extension cord.

Water: A cold water line with water pressure between 30 and 120 psi is required for the water dispenser and ice maker.

OVERALL DIMENSIONS

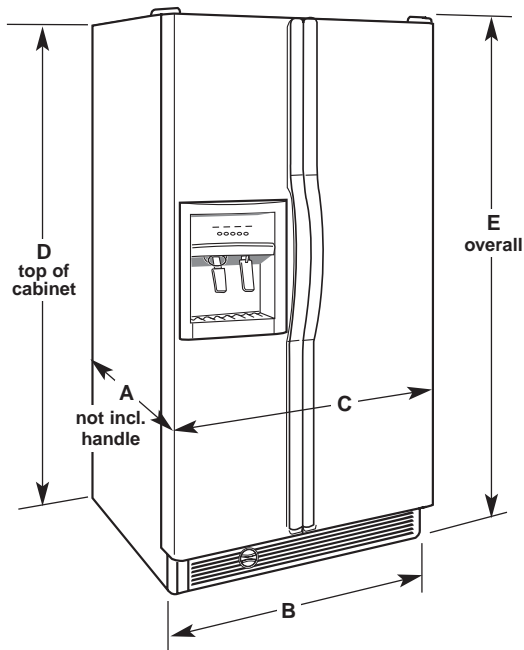

Handle and door style will vary with model.

Dimensions "D" and "E" include rollers extended the minimum 1/4".

Model size	Depth "A"	Cab. Width "B"	Door Width "C"	Cab. Height "D"	Overall Height "E"
STANDARD and ARCHITECT® MODELS					
25 cu.ft.	27"	35 1/2"	35 3/8"	71 1/2"	71 7/8"
EXTRUDED HANDLE MODEL					
25 cu.ft.	27 1/2"	35 1/2"	35 3/8"	71 1/2"	71 7/8"

LOCATION REQUIREMENTS

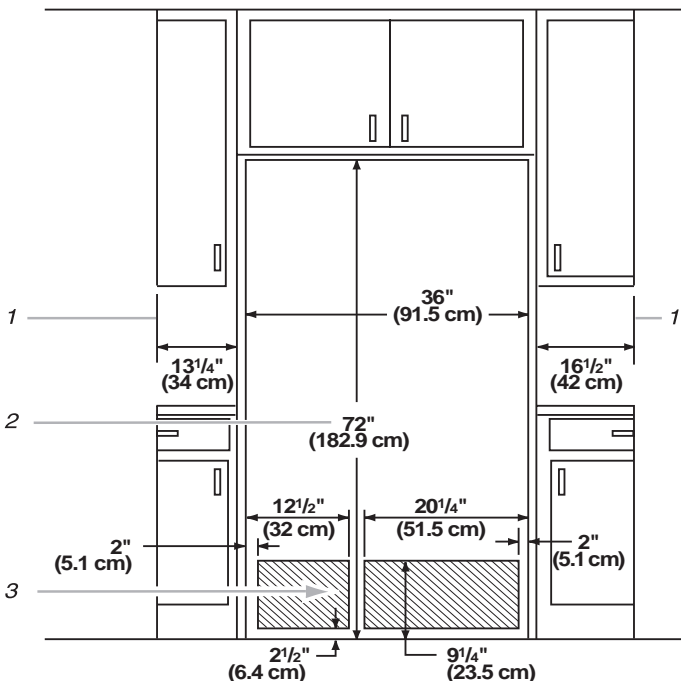

- If you are installing the refrigerator to fit flush with the front of the base cabinets, all shoe molding and baseboards must be removed from the rear of the refrigerator opening.
- The water hookup and electrical hookup must be placed near the bottom of the refrigerator.
- A trim kit is available for those installations where the refrigerator will not fit flush.
- Refrigerator can be installed into a recessed opening, at the end of cabinets or as a freestanding refrigerator.

NOTE: Do not install the refrigerator near an oven, radiator, or other heat source, nor in a location where the temperature will fall below 55°F (13°C).

1. Minimum fixed wall position.
2. For full-overlay cabinet doors and a trim kit, the height of the opening must be 72 1/8 in. (183.2 cm).
3. Recommended locations for electrical and water