

- Package contents
- Wii U controller charge station
  - AC adapter

- Wii remote rechargeable batteries (2)
  - Quick Setup Guide

- Cautions
- You must use the included AC adapter to power the charge station.
  - Do not disassemble any of the components. Refer all services to qualified personnel only.
  - Do not place or store the product in a humid area and do not expose it to water or rain.
  - Use the product only as instructed. Read all instructions before operating the product.
  - Failure to follow these directions may void the warranty.
  - For use with Wii U controllers and peripherals.

- Features
- Designed to charge all Wii U controllers, including the Wii U GamePad, Pro Controller, and Wii Remotes.
  - LED Indicators provide charging status notification. Red indicates charging in process, green indicates charging complete.

- Installing the batteries into the Wii™ Remotes:
- 1 Remove all silicone skins or jackets on the Wii remotes in order to access the battery compartment, then remove any batteries in the compartment.

2 Insert the battery pack into the battery compartment with the front end first, then snap the battery pack into the battery compartment.

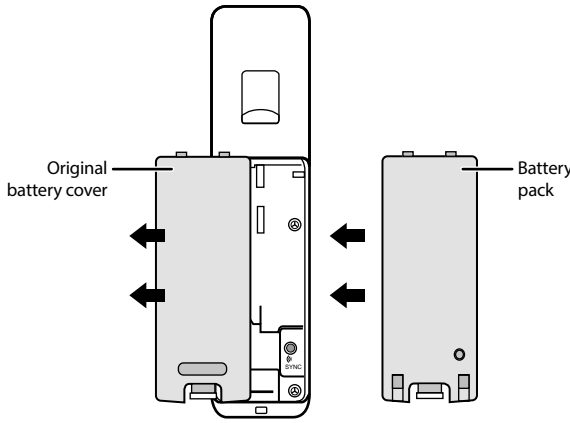

- Setting up the Wii U Controller Charge Station:
- 1 Connect the supplied AC adapter into an appropriate electrical outlet.

2 Insert the AC adapter DC plug into the DC IN 5V jack on the back of the Wii U Controller Charge Station (see below):

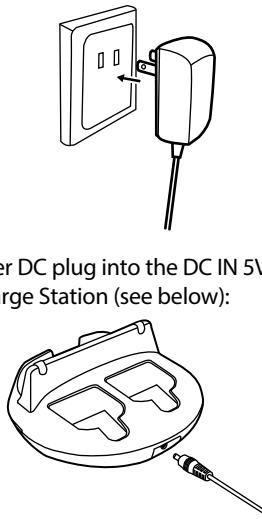

- 3 Place the Wii U Controller Charge Station on a flat and stable surface and start charging the controllers.

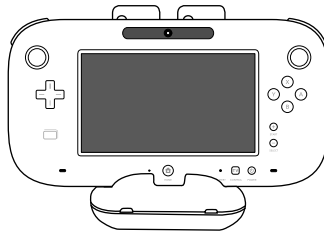

- Using the Wii U Controller Charge Station
- Wii Remotes:

1 Remove all jackets, silicone skins, and the Motion Plus adapters from the remotes. The remotes will not charge with these on. Align the Wii Remote hand strap with the groove in the charge station to prevent the hand strap from interfering with charging.

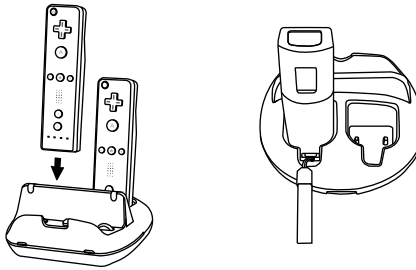

- 2 When inserting the Wii Remote into the charge station, the charge status indicator glows red while the battery pack is recharging. When recharging is complete, the charge status indicator glows green.

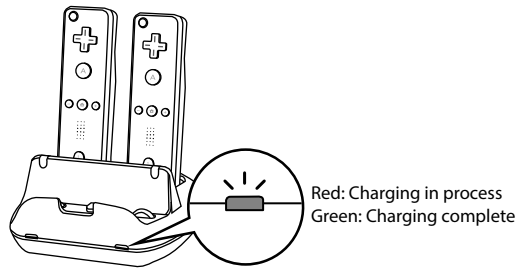

**Wii U GamePad:**

- 1 Place the Wii U GamePad into the front charging port on the station as shown below.

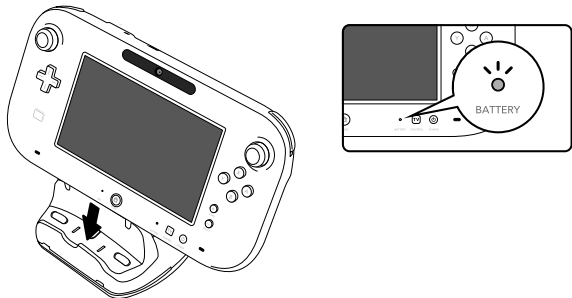

- 2 The Battery LED on the Wii U GamePad lights up orange during charging and will turn off when the battery is fully charged.

**Wii U Pro Controller:**

- 1 Locate the mini USB charge cable on the bottom of the Wii U Controller Charge Station.

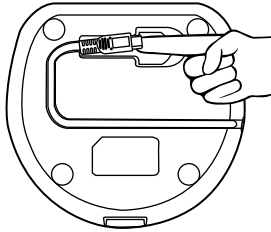

- 2 Insert the mini USB charge connector into the Wii U Pro Controller.
- 3 The charge status indicator LED will light up (orange) on the Pro Controller while charging and turn off when fully charged.

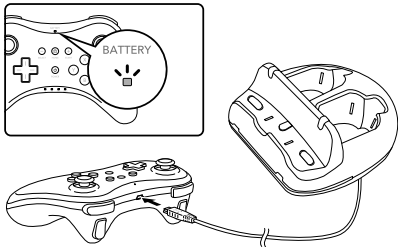

**Specifications**

Battery pack: Ni-MH battery pack × 2

AC Adapter: input 110V-220V

AC adapter: output DC 5V 2A

AC adapter cable length: 1 meter

Input voltage: 100-220V ~ 60Hz

Output power: 5V at 2A

**Legal notices**

**FCC Statement**

This device complies with Part 15 of the FCC Rules. Operation is subject to the following two conditions: (1) this device may not cause harmful interference, and (2) this device must accept any interference received, including interference that may cause undesired operation. This equipment has been tested and found to comply with the limits for a Class B digital device, pursuant to Part 15 of the FCC Rules. These limits are designed to provide reasonable protection against harmful interference in a residential installation. This equipment generates, uses and can radiate radio frequency energy and, if not installed and used in accordance with the instructions, may cause harmful interference to radio communications. However, there is no guarantee that interference will not occur in a particular installation. If this equipment does cause harmful interference to radio or television reception, which can be determined by turning the equipment off and on, the user is encouraged to try to correct the interference by one or more of the following measures:

- Reorient or relocate the receiving antenna.
- Increase the separation between the equipment and receiver.
- Connect the equipment into an outlet on a circuit different from that to which the receiver is connected.
- Consult the dealer or an experienced radio/TV technician for help.

**Warning:** Changes or modifications not expressly approved by the party responsible for compliance could void the user's authority to operate the equipment.

**IC Statement**

This device complies with Industry Canada licence-exempt RSS standard(s).

Operation is subject to the following two conditions: (1) this device may not cause interference, and (2) this device must accept any interference, including interference that may cause undesired operation of the device.

“Le présent appareil est conforme aux CNR d'Industrie Canada applicables aux appareils radio exempts de licence. L'exploitation est autorisée aux deux conditions suivantes : (1) l'appareil ne doit pas produire de brouillage, et (2) l'utilisateur de l'appareil doit accepter tout brouillage radioélectrique subi, même si le brouillage est susceptible d'en compromettre le fonctionnement.”

This equipment complies with IC radiation exposure limits set forth for an uncontrolled environment.

“Cet équipement est conforme à l'exposition aux rayonnements IC limites établies pour un environnement non contrôlé.”

**One-year limited warranty**

Visit [www.insigniaproducts.com](http://www.insigniaproducts.com) for details.

**Contact Insignia:**

For customer service, call 1-877-467-4289 (U.S. and Canada) or 01-800-926-3000 (Mexico)

[www.insigniaproducts.com](http://www.insigniaproducts.com)

Wii and Wii U are trademarks of Nintendo of America, Inc.

INSIGNIA is a trademark of Best Buy and its affiliated companies. Registered in some countries.

Distributed by Best Buy Purchasing, LLC  
7601 Penn Ave South, Richfield, MN 55423 U.S.A.

©2014 Best Buy. All rights reserved.

Made in China